

43309

26154

Return to:  
Pacific Power  
PO Box 728  
Klamath Falls, OR  
97601-0321

'97 AUG -8 P3:31

RC:41360 WO:01196158

UNDERGROUND DISTRIBUTION RIGHT OF WAY EASEMENT

For value received, Lyle Smith (Grantor) hereby grants to PacificCorp, an Oregon corporation, its successors and assigns (Grantee), an easement for a right of way ten (10) feet in width for the construction, reconstruction, operations, maintenance, repair, replacement, enlargement, and removal of underground electric power distribution lines, communication lines and all necessary or desirable accessories and appurtenances thereto, including without limitation: wires, fibers, cables and other conductors and conduits therefor; and pads, transformers, switches, vaults and cabinets; and the right to excavate and refill trenches therefor; along the general course now located by Grantee on, over or under the surface of the real property of Grantor in Klamath County, State of Oregon, more particularly described as follows or as more particularly described and/or shown on Exhibit(s) A attached hereto and by this reference made a part hereof:

Said property generally located in The Northeast Quarter (NE1/4) of Section 30, Township 39 South, Range 11 East of the Willamette Meridian, and more specifically described in Volume M97, Page 2144, in the Official Records of Klamath County.

Assessor's Map No. 39-11-30 Tax Parcel No. TL 200

Together with the right of access to the right of way from adjacent lands of Grantor for all activities in connection with the purposes for which this easement has been granted; and together with the present and (without payment therefor) the future right to keep the right of way and adjacent lands clear of all brush, trees, timber, structures and other hazards which might endanger Grantee's facilities or impede Grantee's activities.

At no time shall Grantor erect or permit the erection of any buildings or structures of any kind or nature within the right of way without the prior written consent of Grantee, or light any fires, or place or store any flammable materials (other than agricultural crops), on or within the boundaries of the right of way. Subject to the foregoing limitations, the surface of the right of way may be used for roads, agricultural crops and other purposes not inconsistent with the purposes for which this easement has been granted.

The rights and obligations of the parties hereto shall be binding upon and shall benefit their respective heirs, successors and assigns; and this easement shall terminate if and when Grantee shall have abandoned all use of the right of way and no longer has any future need therefor.

20

Signed this 1ST day of JULY, 19 97.

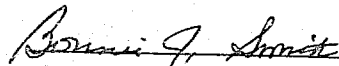
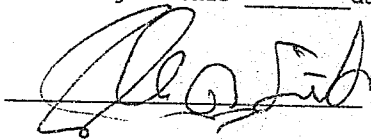

State Of Oregon

County Of KLAMATH

This instrument was acknowledged before me on JULY 1 1997  
by LYLE R SMITH AND BONNIE J SMITH.

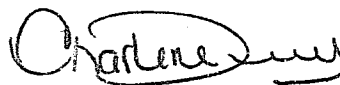
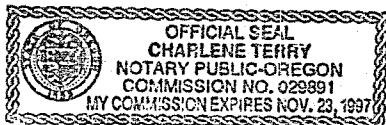

Notary Public

My Commission Expires 11-23-97

# "EXHIBIT A"

26156

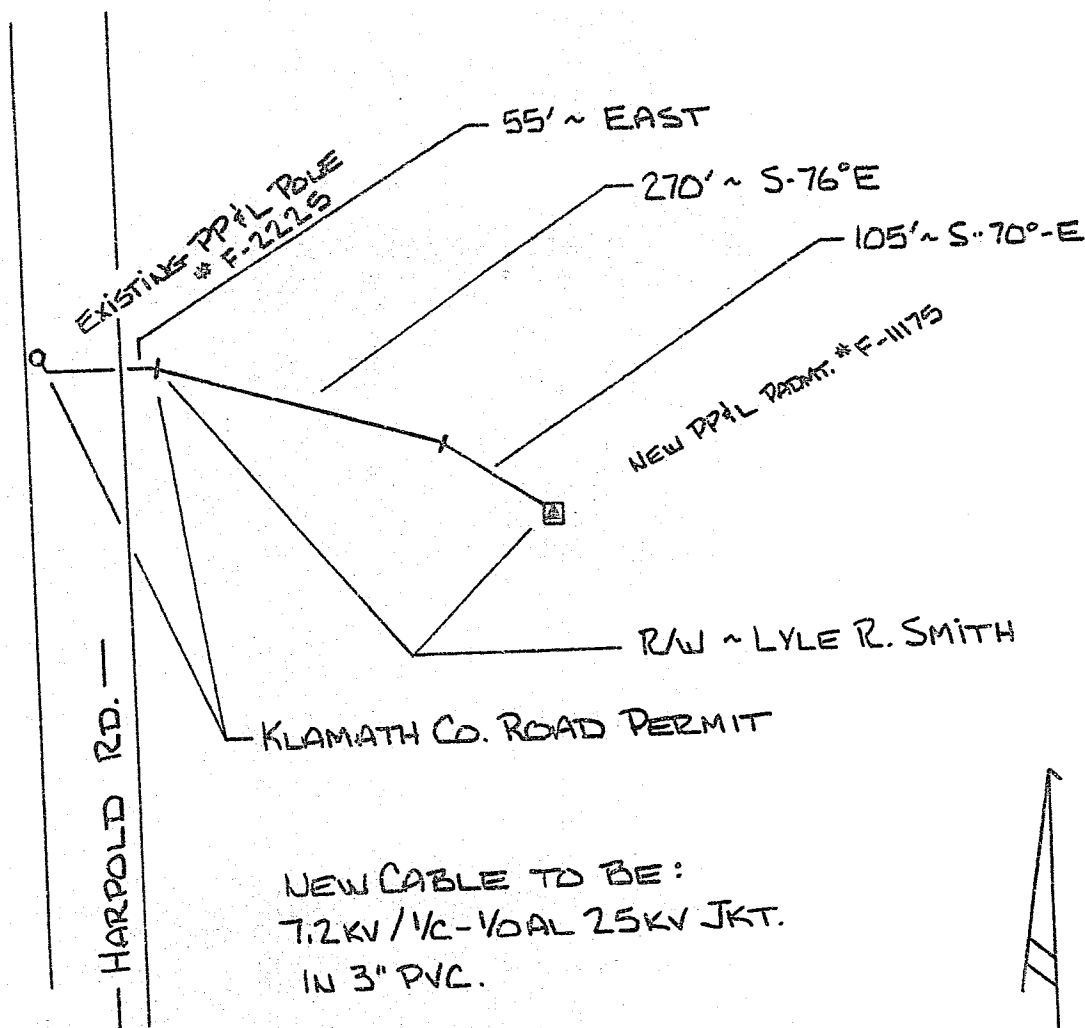

DISTRICT <u>KLAMATH FALLS, OR.</u>	
NAME <u>LYLE SMITH</u>	<u>HARPOLD RD.</u>
CIRCUIT NUMBER <u>567</u>	R.C. <u>41360</u>
MAP NO. <u>136 F-126-9</u>	W.O. <u>01196153</u>
DRAWN <u>PAUL SMITH</u> 10 <u>97</u>	

PACIFIC POWER  
E R SKETCH

SCALE

NONE

FORM 2703 - 490

STATE OF OREGON: COUNTY OF KLAMATH: ss.

Filed for record at request of Pacific Power the 8th day  
of August A.D., 19 97 at 3:31 o'clock P. M., and duly recorded in Vol. M97  
of Deeds on Page 26154

Bernetha G. Letsch, County Clerk

By Kathleen Ross

FEE

\$20.00