

46388 47977  
Return to: 97 DCI 31 P3:26  
Pacific Power  
PO Box 728  
Klamath Falls, OR  
97601-0321

Vol. M97 Page 36234  
Vol. M97 Page 32635

RC:41360 WO:01194854

UNDERGROUND DISTRIBUTION RIGHT OF WAY EASEMENT

97 DCI -3 P2:40  
For value received, Carrie Nevin Trust (Grantor) hereby grants to PacificCorp, an Oregon corporation, its successors and assigns (Grantee), an easement for a right of way ten (10) feet in width for the construction, reconstruction, operations, maintenance, repair, replacement, enlargement, and removal of underground electric power distribution lines, communication lines and all necessary or desirable accessories and appurtenances thereto, including without limitation: wires, fibers, cables and other conductors and conduits therefor; and pads, transformers, switches, vaults and cabinets; and the right to excavate and refill trenches therefor; along the general course now located by Grantee on, over or under the surface of the real property of Grantor in Klamath County, State of Oregon, more particularly described as follows or as more particularly described and/or shown on Exhibit(s) A attached hereto and by this reference made a part hereof:

Said property generally located in The West Half (W 1/2) of Section 19, Township 38 South, Range 11 1/2 East of the Willamette Meridian and more specifically described in Volume M88, Page 22264, in the Official Records of Klamath County  
Assessor's Map No. 38 11V & Index Tax Parcel No. 3800

and

property generally located in Section 13, Township 38 South, Range 10 East of the Willamette Meridian and more specifically described in Volume M94, Page 36642 in the Official Records of Klamath County.  
Assessor's Map No. 38 10 & index Tax Parcel Number: 2700

Together with the right of access to the right of way from adjacent lands of Grantor for all activities in connection with the purposes for which this easement has been granted; and together with the present and (without payment therefor) the future right to keep the right of way and adjacent lands clear of all brush, trees, timber, structures and other hazards which might endanger Grantee's facilities or impede Grantee's activities.

At no time shall Grantor erect or permit the erection of any buildings or structures of any kind or nature within the right of way without the prior written consent of Grantee, or light any fires, or place or store any flammable materials (other than agricultural crops), on or within the boundaries of the right of way. Subject to the foregoing limitations, the surface of the right of way may be used for roads, agricultural crops and other purposes not inconsistent with the purposes for which this easement has been granted.

The rights and obligations of the parties hereto shall be binding upon and shall benefit their respective heirs, successors and assigns; and this easement shall terminate if and when Grantee shall have abandoned all use of the right of way and no longer has any future need therefor.

de  
15  
2000

100006

700000

TTETA

36235

RECORDED 32636

Signed this 13<sup>th</sup> day of August, 1997.

Carrie Nevin  
Carrie Nevin, Trustee for the Carrie Nevin Trust

STATE OF OREGON )

County of Klamath ) ss.

This instrument was acknowledged before me on August 13, 1997,  
by Carrie Nevin as Trustee  
of The Carrie Nevin Trust.

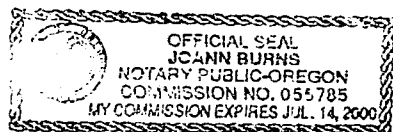

1s.

Joann Burns  
Notary Public  
My Commission Expires 7-14-2000

STATE OF OREGON: COUNTY OF KLAMATH: ss.

Filed for record at request of Pacific Power the 3rd day  
of October at 2:40 o'clock P. M., and duly recorded in Vol. M97  
on Page 32635

FEE \$15.00



By Berneiha G. Letsch, County Clerk  
Kathleen Ross

INDEXED  
D-LLX

"EXHIBIT A"

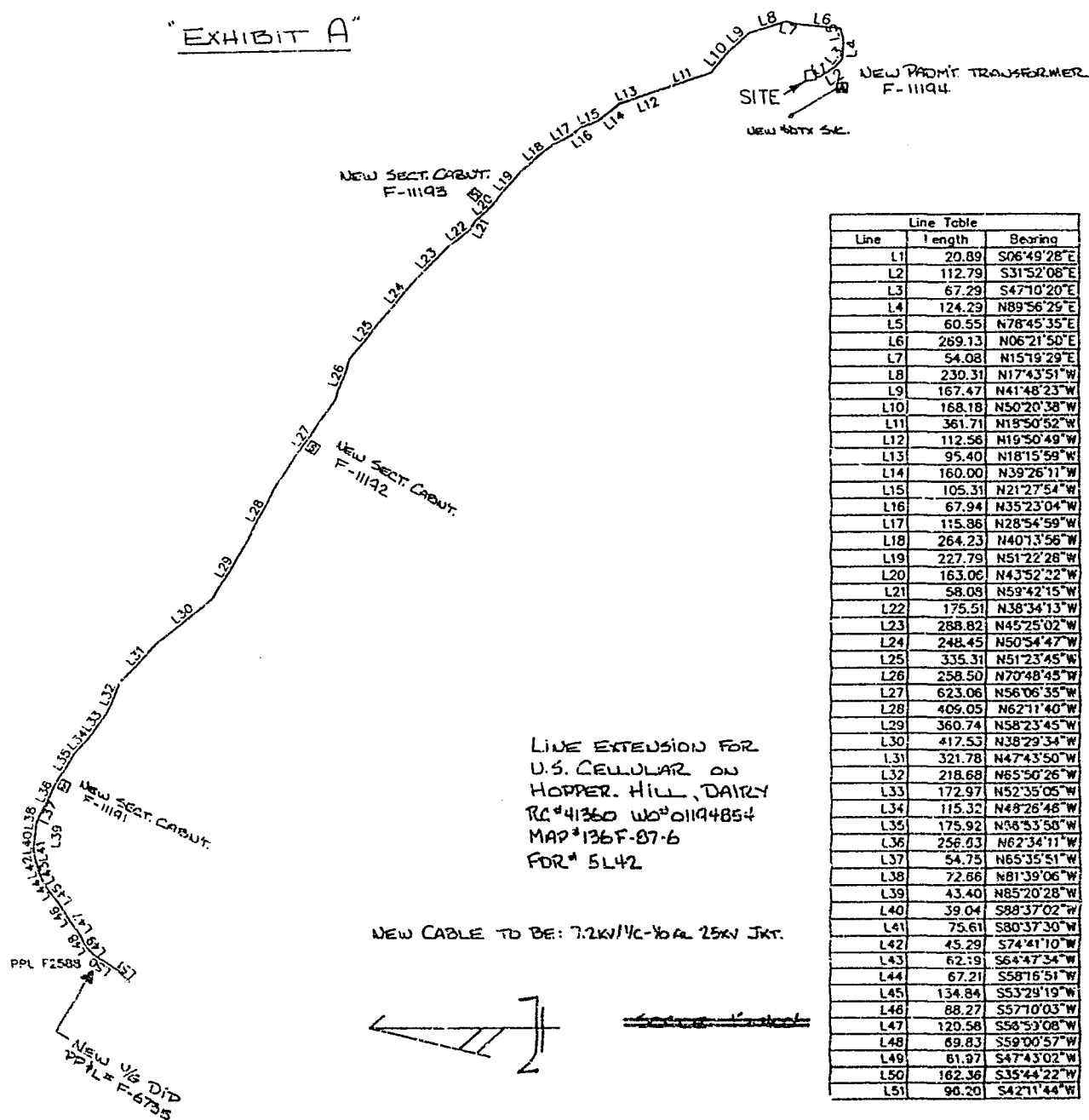

Line	Length	Bearing
L1	20.89	S06°49'28"E
L2	112.79	S31°52'08"E
L3	67.29	S47°10'20"E
L4	124.29	N89°56'29"E
L5	60.55	N78°45'35"E
L6	269.13	N06°21'50"E
L7	54.08	N15°19'29"E
L8	230.31	N17°43'51"W
L9	167.47	N41°48'23"W
L10	168.18	N50°20'38"W
L11	361.71	N19°50'52"W
L12	112.58	N19°50'49"W
L13	95.40	N18°15'59"W
L14	160.00	N39°26'11"W
L15	105.31	N21°27'54"W
L16	67.94	N35°23'04"W
L17	115.86	N28°54'59"W
L18	264.23	N40°13'56"W
L19	227.79	N51°22'28"W
L20	163.06	N43°52'22"W
L21	58.08	N59°42'15"W
L22	175.51	N38°34'13"W
L23	288.82	N45°25'02"W
L24	248.45	N50°54'47"W
L25	335.31	N51°23'45"W
L26	258.50	N70°48'45"W
L27	623.06	N56°06'35"W
L28	409.05	N62°11'40"W
L29	360.74	N58°23'45"W
L30	417.53	N38°29'34"W
L31	321.78	N47°43'50"W
L32	218.68	N65°50'26"W
L33	172.97	N52°35'05"W
L34	115.32	N48°28'48"W
L35	175.92	N56°53'55"W
L36	256.03	N62°34'11"W
L37	54.75	N65°35'51"W
L38	72.66	N81°39'06"W
L39	43.40	N85°20'28"W
L40	39.04	S88°37'02"W
L41	75.61	S80°37'30"W
L42	45.29	S74°41'10"W
L43	62.19	S64°47'34"W
L44	67.21	S58°16'51"W
L45	134.84	S53°29'19"W
L46	88.27	S57°10'03"W
L47	120.58	S58°53'08"W
L48	69.83	S59°00'57"W
L49	61.97	S47°43'02"W
L50	162.36	S35°44'22"W
L51	96.20	S42°11'44"W

2000

36237

STATE OF OREGON: COUNTY OF KLAMATH: ss.

Filed for record at request of Pacific Power the 31st day  
of October A.D., 19 97 at 3:26 o'clock P. M., and duly recorded in Vol. M97,  
of Deeds on Page 36234.

FEE \$20.00 Re-record

By Bernetha G. Letsch, County Clerk  
Kathleen Ross