

Return to:
Pacific Power
PO Box 728
Klamath Falls, OR
97601-0321

98 JAN 16 P3:02

Vol. 1198 Page 1531

RC:41360 WO:01183776

UNDERGROUND DISTRIBUTION RIGHT OF WAY EASEMENT

For value received, Danny Simpson and Deborah Simpson (Grantor) hereby grants to PacifiCorp, an Oregon corporation, its successors and assigns (Grantee), an easement for a right of way twenty (20) feet in width for the construction, reconstruction, operations, maintenance, repair, replacement, enlargement, and removal of underground electric power distribution lines, communication lines and all necessary or desirable accessories and appurtenances thereto, including without limitation: wires, fibers, cables and other conductors and conduits therefor; and pads, transformers, switches, vaults and cabinets; and the right to excavate and refill trenches therefor; along the general course now located by Grantee on, over or under the surface of the real property of Grantor in Klamath County, State of Oregon, more particularly described as follows or as more particularly described and/or shown on Exhibit(s) A attached hereto and by this reference made a part hereof:

Said property generally located in The Northwest Quarter (NW 1/4) of The Northwest Quarter (NW 1/4) of Section 23, Township 34 South, Range 8 East of the Willamette Meridian, and more specifically described in Volume 97, Page 8878 in the Official Records of Klamath County.

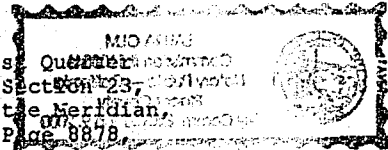

Assessor's Map No. 34 08 23 Tax Parcel No. 1100

Together with the right of access to the right of way from adjacent lands of Grantor for all activities in connection with the purposes for which this easement has been granted; and together with the present and (without payment therefor) the future right to keep the right of way and adjacent lands clear of all brush, trees, timber, structures and other hazards which might endanger Grantee's facilities or impede Grantee's activities.

At no time shall Grantor erect or permit the erection of any buildings or structures of any kind or nature within the right of way without the prior written consent of Grantee, or light any fires, or place or store any flammable materials (other than agricultural crops), on or within the boundaries of the right of way. Subject to the foregoing limitations, the surface of the right of way may be used for roads, agricultural crops and other purposes not inconsistent with the purposes for which this easement has been granted.

The rights and obligations of the parties hereto shall be binding upon and shall benefit their respective heirs, successors and assigns; and this easement shall terminate if and when Grantee shall have abandoned all use of the right of way and no longer has any future need therefor.

1532

DEC 10 1997

1532

Signed this 8 day of December, 1997.

Danny B. Simpson
 Danny Simpson

Deborah Simpson
 Deborah Simpson

STATE OF OREGON California)County of Placer)This instrument was acknowledged before me on December 8, 1997.by Danny B. Simpson & Deborah Simpson.

Laura Olin
 Notary Public

My Commission Expires 6-9-2000

Is.

EXHIBIT A

1533

PACIFIC POWER & LIGHT COMPANY

OWNER Simpson, Danny and Deborah

E.R./W.O. 41360-01183776

NW1 NW1 SEC. 23, T. 34S., R. 8E., W.M.

MAP 136A-64-6

KLAMATH COUNTY, OREGON

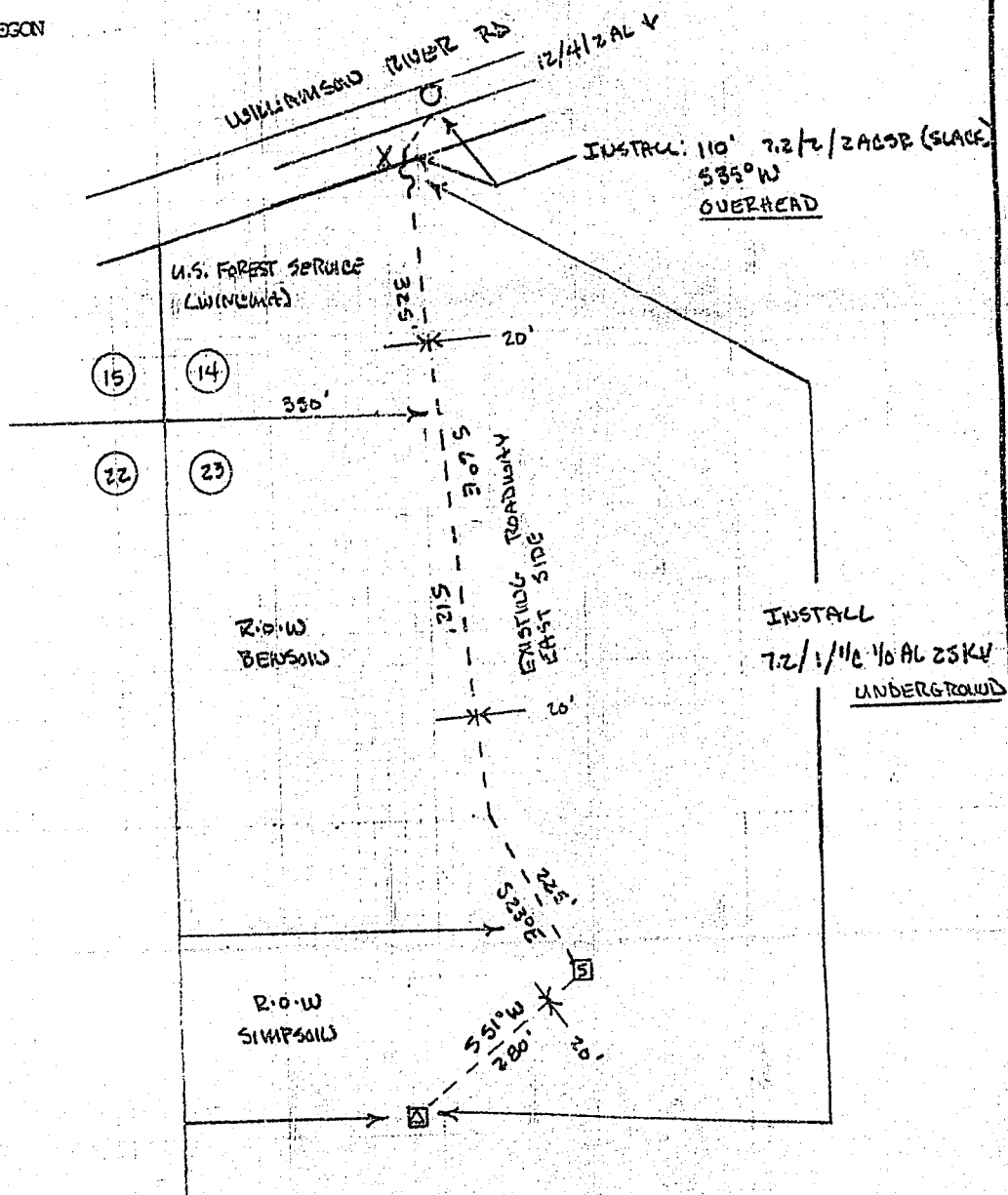

DISTRICT KLAMATH	
NAME <u>DAN SIMPSON</u>	
CIRCUIT NUMBER <u>5637</u>	
MAP NO. <u>136A-64-6</u>	
DRAWN _____	
R.C. <u>41360</u>	W.O. <u>01183776</u>

PACIFIC POWER
E R SKETCH

SCALE 1" = 200'

FORM 2705 - 400

STATE OF OREGON: COUNTY OF KLAMATH: ss.

Filed for record at request of Pacific Power the 16th day
of January A.D., 19 98 at 3:02 o'clock P.M., and duly recorded in Vol. M98
of Deeds on Page 1531

FEE \$20.00

By Bernetha G. Letsch, County Clerk
Kathleen Ross