

Return to:

Pacific Power

PO Box 728

Klamath Falls, OR

97601-0321

RC: 41360 WO: 01338469

DISTRIBUTION RIGHT OF WAY EASEMENT

For value received Lois and Leon Darron (Grantor) hereby grants to PacifiCorp, an Oregon corporation, its successors and assigns (Grantee), an easement for a right of way 20 feet in width for the construction, reconstruction, operation, maintenance, repair, replacement, enlargement, and removal of electric power distribution lines and communication lines and all necessary or desirable accessories and appurtenances thereto, including without limitation: supporting towers, poles, props, guys and anchors, including guys and anchors outside of the right of way; wires, fibers, cables and other conductors and conduits therefor; and pads, transformers, switches, vaults and cabinets, along the general course now located by Grantee on, over or under the surface of the real property of Grantor in Klamath County, State of Oregon, more particularly described as follows or as more particularly described and/or shown on Exhibit(s) A attached hereto and by this reference made a part hereof:

Said property generally located in The S1/2, SE1/4 of Sec 19 Township 40S, Range 12E, of the Willamette Meridian, and more specifically described in Volume M-80 Page 17638 in the Official Records of Klamath County.

Assessor's Map No. R4012-01900-00600 Tax Parcel No. 600

Together with the right of access to the right of way from adjacent lands of Grantor for all activities in connection with the purposes for which this easement has been granted; and together with the present and (without payment therefor) the future right to keep the right of way and adjacent lands clear of all brush, trees, timber, structures and other hazards which might endanger Grantee's facilities or impede Grantee's activities.

At no time shall Grantor erect or permit the erection of any buildings or structures of any kind or nature, or place or use or permit any equipment or material of any kind that exceeds 12 feet in height, or light any fires, or place or store any flammable material (other than agricultural crops), on or within the boundaries of the right of way. Subject to the foregoing limitations, the surface of the right of way may be used for roads, agricultural crops and other purposes not inconsistent with the purposes for which this easement has been granted.

98 JUL 30 P 3:18

23110

23110

The rights and obligations of the parties hereto shall be binding upon and shall benefit their heirs, successors and assigns; and this easement shall terminate if and when Grantee shall have abandoned all use of the right of way and no longer has any future need therefor.

Signed this 06 day of May, 1998.

Linda L. Barron

Linda L. Barron

STATE OF OREGON)

SS.

County of Klamath)

This instrument was acknowledged before me on 5/26/ 1998
by _____

Linda L. Terry

Notary Public

My Commission Expires 9-1-01

Is.

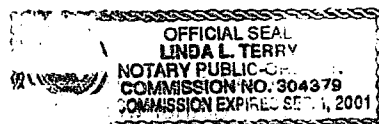
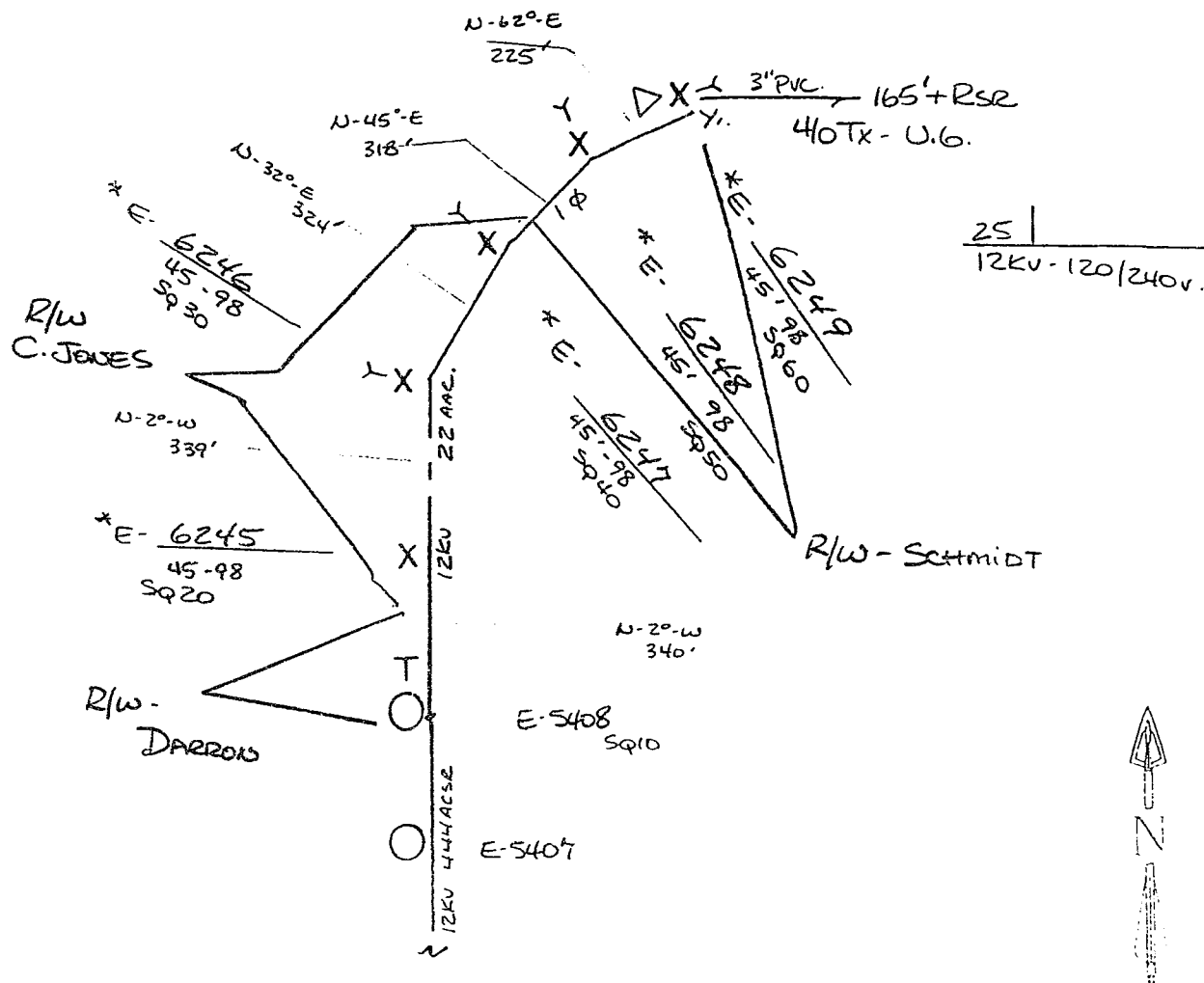

EXHIBIT A

Grantors: Darron, Lois and Leon Work Order No. 41360-01338469



STATE OF OREGON: COUNTY OF KLAMATH: ss.

Filed for record at request of Pacific Power the 30th day
of June A.D., 19 98 at 3:18 o'clock P M., and duly recorded in Vol. M98
of Deeds on Page 23109.

FEE \$20.00

By Bernetha G. Letsch, County Clerk
Kathleen Rosen