



62988

MTC 45212

Vol. 1998 Page 26328

Klamath County - Public Works Department

ROAD DEPARTMENT - PARK DIVISION - SOLID WASTE DIVISION - WEED CONTROL DIVISION - FAX 541-882-3046
3735 SHASTA WAY - KLAMATH FALLS, OREGON 97603 - 541-883-4696

October 12, 1996

98 JUL 20 AM 11:41
Mr. Larry R. Lewis
178 Crest Drive
Myrtle Creek, Oregon 97457

Re: Encroachment Permit - Lot 11, Block 1, Latakomie Shores

Dear Mr. Lewis:

Your home located on the above referenced lot encroaches into the right-of-way of Palouse Circle and across set-back lines as shown on the attached map.

On November 8, 1996 the Board of County Commissioners agreed to grant you an encroachment permit with the following conditions:

1. Additions to the home that increase the encroachments will not be approved.
2. If the home is removed or destroyed this permit is null and void and the replacement structure must conform to all set-back lines.

Please sign and return this letter at your earliest convenience. The permit is not valid until we receive your acknowledgment.

Terms of the permit accepted
this 14th day of November, 1996

Larry R. Lewis
Larry R. Lewis

Thomas Rosetta
Director of Public Works
Carl Shuck
Planning Director

cc: Bob Veatch, Klamath County Title

15

26329

LOT 11 BLOCK 1 LATAKOMIE SHORES

MAIDU WAY

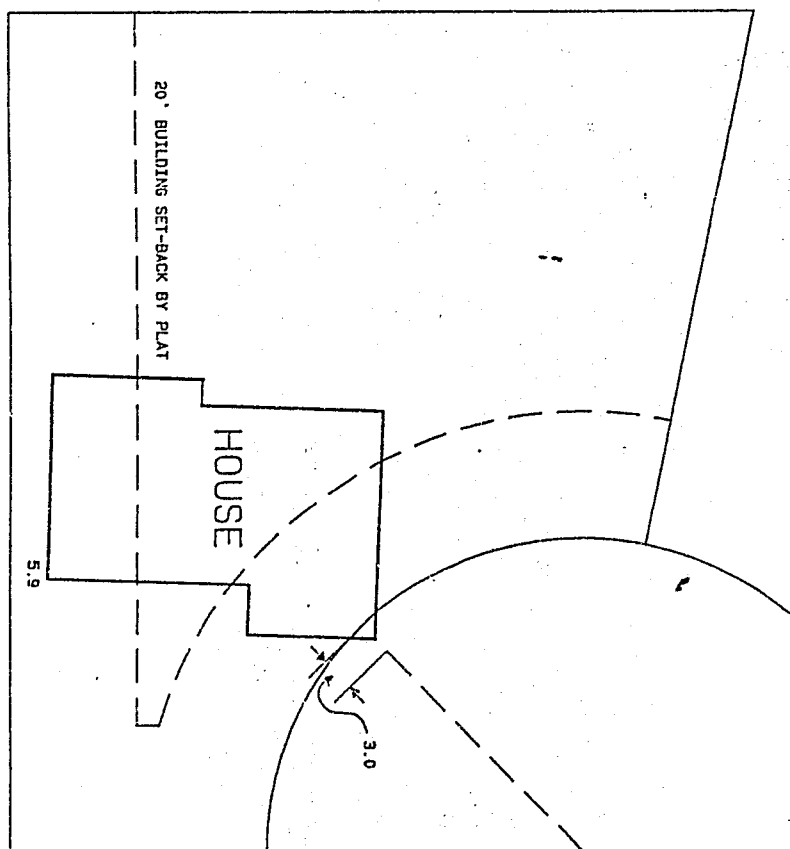

PALOUSE WAY

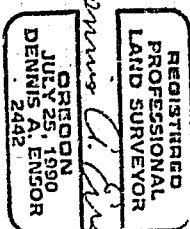

STATE OF OREGON: COUNTY OF KLAMATH: ss.

Filed for record at request of Amerititle the 20th day
 of July A.D., 19 98 at 11:41 o'clock A.M., and duly recorded in Vol. M98
 of Deeds on Page 26328.

FEE \$15.00

Return: Larry Lewis

178 E. Crest

Myrtle Creek, Or. 97457

By

Bernetha G. Letsch, County Clerk

Kathleen Roes