

Return to: Pacific Power  
 PO Box 728  
 Klamath Falls, OR  
 97601-0321

RC:41360 WO:01379949

### UNDERGROUND DISTRIBUTION RIGHT OF WAY EASEMENT

For value received, Roman Catholic Bishop of Baker a Corporation  
 Sole(Grantor) hereby grants to PacificCorp, an Oregon corporation, its successors and  
 assigns (Grantee), an easement for a right of way Ten (10) feet in width for the  
 construction, reconstruction, operations, maintenance, repair, replacement,  
 enlargement, and removal of underground electric power distribution lines,  
 communication lines and all necessary or desirable accessories and appurtenances  
 thereto, including without limitation: wires, fibers, cables and other conductors and  
 conduits therefor; and pads, transformers, switches, vaults and cabinets; and the right  
 to excavate and refill trenches therefor; along the general course now located by  
 Grantee on, over or under the surface of the real property of Grantor in Klamath  
 County, State of Oregon, more particularly described as follows or as more particularly  
 described and/or shown on Exhibit(s) A attached hereto and by this reference made a  
 part hereof:

Said property generally located in The SW  $\frac{1}{4}$  /SW  $\frac{1}{4}$  of Section 11CA  
 Township 39, Range 9EWM, of the Willamette Meridian, and more specifically  
 described in Volume 284 Page 485 in the Official Records of Klamath County.

Assessor's Map No. 6900 Tax Parcel No. 3909-11CA-6900

Together with the right of access to the right of way from adjacent lands of  
 Grantor for all activities in connection with the purposes for which this easement has  
 been granted; and together with the present and (without payment therefor) the future  
 right to keep the right of way and adjacent lands clear of all brush, trees, timber,  
 structures and other hazards which might endanger Grantee's facilities or impede  
 Grantee's activities.

At no time shall Grantor erect or permit the erection of any buildings or  
 structures of any kind or nature within the right of way without the prior written consent  
 of Grantee, or light any fires, or place or store any flammable materials (other than  
 agricultural crops), on or within the boundaries of the right of way. Subject to the  
 foregoing limitations, the surface of the right of way may be used for roads, agricultural  
 crops and other purposes not inconsistent with the purposes for which this easement  
 has been granted.

The rights and obligations of the parties hereto shall be binding upon and shall benefit their respective heirs, successors and assigns; and this easement shall terminate if and when Grantee shall have abandoned all use of the right of way and no longer has any future need therefor.

Signed this 30<sup>th</sup> day of August, 1998

Roman Catholic Bishop of Baker + Thomas J. Bonnelly  
 Roman Catholic Bishop of Baker Bishop of Baker Diocese  
 a Corporation Sole

For value received, Roman Catholic Bishop of Baker, an Oregon corporation, its successors and assigns, hereby grants to PacificCorp, an Oregon corporation, its successors and assigns, an easement for a right of way 10 feet in width for the

STATE OF OREGON  
 County of Deschutes

This instrument was acknowledged before me on 30<sup>th</sup> August, 1998,  
 by Thomas J. Bonnelly as Bishop  
 of Baker

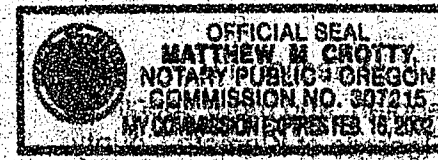

Matthew M. Crotty  
 Notary Public  
 My Commission Expires 2/16/00

Assessor's Map No. 0900 Tax Parcel No. 3009-110A-0000

to all activities in connection with the purposes for which this easement has been granted and together with the present and (whether owned or leased) the future right to keep the right of way and adjacent lands clear of all brush, trees, timber, structures and other hazards which might endanger Grantee's facilities or impede Grantee's activities.

At no time shall Grantee erect or permit the erection of any building or structures of any kind or nature within the right of way without the prior written consent of Grantee or light any fires or place or store any flammable materials (other than agricultural crops) on or within the boundaries of the right of way. Subject to the foregoing limitations, the surface of the right of way may be used for roads, agricultural roads and other purposes not inconsistent with the purposes for which this easement has been granted.

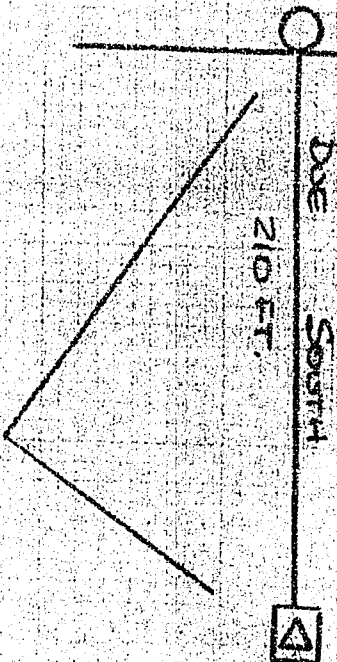

EXHIBIT A

44489

BRISTOL AVE.  
D-5395 (POLE)

R/W -  
ST. PIOUS  
CHURCH



D-17862  
(3 PHASE VAULT KEMIE)

CABLE = 3 X #10 AL. - 25KV. - JCT'D

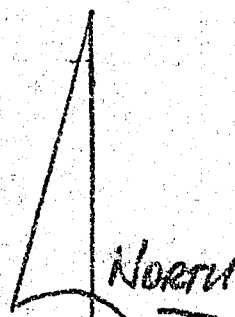

DISTRICT <u>KLAMATH</u>	
NAME <u>ST. PIOUS CHURCH</u>	<u>612</u>
CIRCUIT NUMBER <u>5644</u>	
MAP NO. <u>D-69-1-C-3</u>	R.C. <u>41360</u>
DRAWN <u>CBS</u> 19 <u>98</u>	W.O. <u>01379949</u>

PACIFIC POWER  
E R SKETCH

SCALE DTG

STATE OF OREGON: COUNTY OF KLAMATH: ss.

Filed for record at request of Pacific Power  
of December A.D., 19 98 at 3:49 o'clock P. M., and duly recorded in Vol. M98  
of Deeds on Page 44497

FEE \$20.00

By Bernetha G. Letsch, County Clerk  
Ruth Ann Rose