

NS

71435

98 DEC 14 P3:20 Vol. m98 Page 45671

Northwest Pipeline Corporation
 Grantor's Name and Address
 The Washington Water Power Company
 Grantee's Name and Address
 After recording, return to (Name, Address, Zip):
 The Washington Water Power Company
 P. O. Box 3727
 Spokane, Washington 99220-3727
 Until requested or series, send all tax statements to (Name, Address, Zip):
 The Washington Water Power Company
 P. O. Box 3727
 Spokane, Washington 99220-3727

SPACE RESERVED
FOR
RECORDER'S USE

STATE OF OREGON,
 County of _____ } ss.
 I certify that the within instrument
 was received for record on the _____ day
 of _____, 19____, at
 _____ o'clock _____ M., and recorded in
 book/reel/volume No. _____ on page
 _____ and/or as fee/file/instru-
 ment/microfilm/reception No. _____,
 Records of said County.
 Witness my hand and seal of County
 affixed.

NAME _____ TITLE _____
 By _____, Deputy

R-50445

SPECIAL WARRANTY DEED

KNOW ALL BY THESE PRESENTS that Northwest Pipeline Corporation, a Delaware Corp.
 who took title as El Paso Natural Gas Company
 hereinafter called grantor, for the consideration hereinafter stated, to grantor paid by
 The Washington Water Power Company
 hereinafter called grantee, does hereby grant, bargain, sell and convey unto the grantee and grantee's heirs, successors and assigns,
 that certain real property, with the tenements, hereditaments and appurtenances thereunto belonging or in any way appertaining,
 situated in _____ Klamath _____ County, State of Oregon, described as follows, to-wit:

"See attached description on Exhibit A"

together with a right-of-way and easement to access, construct, maintain, repair, replace
 protect, inspect and operate its natural gas pipeline and associated facilities as
 generally shown on "Exhibit B" which is attached hereto and by the reference made a part
 hereof.

The Washington Water Power Company shall indemnify and hold Northwest Pipeline Corporation
 harmless from and against any and all loss, damage, or injury which may result from the
 construction, operation and maintenance of the facilities; provided, however, that said loss,
 damage, or injury does not arise out of or result from the actions of Northwest Pipeline
 Corporation, its agents or employees.

The terms, conditions and provisions of this agreement shall extend to and be binding
 upon the successors and assigns of the parties.

(IF SPACE INSUFFICIENT, CONTINUE DESCRIPTION ON REVERSE SIDE)

To Have and to Hold the same unto grantee and grantee's heirs, successors and assigns forever.

And grantor hereby covenants to and with grantee and grantee's heirs, successors and assigns, that the real property is free
 from encumbrances created or suffered thereon by grantor and that grantor will warrant and defend the same and every part and
 parcel thereof against the lawful claims and demands of all persons claiming by, through, or under the grantor.

The true and actual consideration paid for this transfer, stated in terms of dollars, is \$~~other than money~~ ^⓪ However, the
 actual consideration consists of or includes other property or value given or promised which is ☐ the whole ☐ part of the (indicate
 which) consideration. ^⓪ (The sentence between the symbols ^⓪, if not applicable, should be deleted. See ORS 93.030.)

In construing this deed, where the context so requires, the singular includes the plural, and all grammatical changes shall be
 made so that this deed shall apply equally to corporations and to individuals.

In witness whereof, the grantor has executed this instrument this 8th day of December, 1998; if grantor
 is a corporation, it has caused its name to be signed and its seal, if any, affixed by an officer or other person duly authorized to do
 so by order of its board of directors.

THIS INSTRUMENT WILL NOT ALLOW USE OF THE PROPERTY DESCRIBED IN
 THIS INSTRUMENT IN VIOLATION OF APPLICABLE LAND USE LAWS AND REGU-
 LATIONS. BEFORE SIGNING OR ACCEPTING THIS INSTRUMENT, THE PERSON
 ACQUIRING FEE TITLE TO THE PROPERTY SHOULD CHECK WITH THE APPRO-
 PRIATE CITY OR COUNTY PLANNING DEPARTMENT TO VERIFY APPROVED USES
 AND TO DETERMINE ANY LIMITS ON LAWSUITS AGAINST FARMING OR FOREST
 PRACTICES AS DEFINED IN ORS 30.930.

Northwest Pipeline Corporation

By: Jan B. Camp, Attorney-in-fact

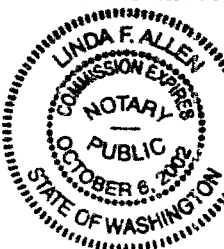

WASHINGTON
 STATE OF ~~OREGON~~, County of Clark) ss.

This instrument was acknowledged before me on _____, 19____,

by _____

This instrument was acknowledged before me on December 8, 1998,

by Jan B. Camp, as Attorney-in-fact for

for Northwest Pipeline Corporation

Linda F. Allen
 Notary Public for ~~OREGON~~ Washington
 My commission expires 10/6/02

Exhibit A

DESCRIPTION OF PROPERTY

The following described real property situate in Klamath County, Oregon.

PARCEL 1:

The North sixty (60) feet of the N $\frac{1}{2}$ N $\frac{1}{2}$ NW $\frac{1}{4}$ NW $\frac{1}{4}$ of Section 34, Township 38 South, Range 9 East of the Willamette Meridian, Klamath County, Oregon.
Account No. 3809-34BB-100

PARCEL 2:

A strip of land 60 feet wide, the centerline of which begins at a point in the SW $\frac{1}{4}$ NE $\frac{1}{4}$ of Section 36, Township 38 South, Range 9 East of the Willamette Meridian, which point bears North 87°18' East a distance of 2809.3 feet from the west quarter corner of said Section 36; thence North 0°15' West a distance of 33.4 feet; thence North 34°41' West a distance of 368.1 feet; thence North 38°19' West a distance of 1355.5 feet; thence North 45°26' West a distance of 1556.7 feet; thence North 88°48' West a distance of 3343.3 feet to a point on the west boundary of the Northeast Quarter (NE $\frac{1}{4}$) of Section 35, Township 38 South, Range 9 East of the Willamette Meridian, which point bears South a distance of 30.0 feet from the North quarter corner of said Section 35.
Account No. 3809-3500-100 and Account No. 3809-3600-300

"Exhibit C"

45673



NOT TO SCALE AND NOT TO BE USED FOR CONSTRUCTION

SCALE: 1" = 20'

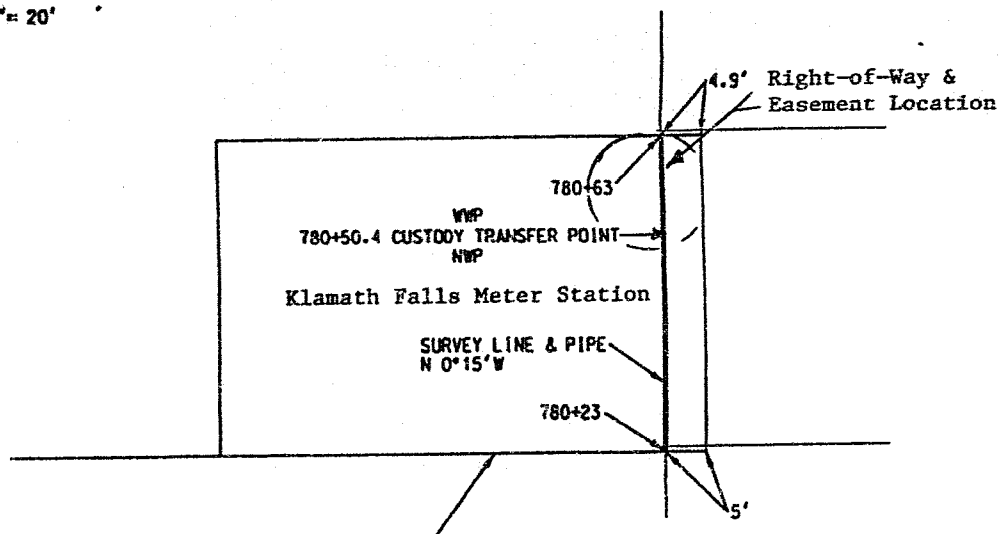

NORTHWEST PIPELINE CORPORATION
Property - Warranty Deed (dated 9/30/1961)
Recorded 10/12/1961 in Vol. 333, of Deeds
at Page 145

					NORTHWEST PIPELINE CORPORATION <i>Williams</i> GAS PIPELINES - WEST 8 5/8" O.D. KLAMATH FALLS LINE X-ING NORTHWEST PIPELINE PROPERTY SEC. 26, T-38, R-9-E, W.M. KLAMATH COUNTY, OREGON		
					SCALE 1" = 20'	DATE 9-26-98	APP:
NO.	REVISION DESCRIPTION	BY	DATE	APP.	DRAWN BY:	CHECKED BY:	DWG. NO.: 2441.1-X0013

STATE OF OREGON: COUNTY OF KLAMATH: ss.

Filed for record at request of First American Title the 14th day
of December A.D., 1998 at 3:20 o'clock P. M., and duly recorded in Vol. M98,
of Deeds on Page 45671.

FEE \$40.00

By Bernetha G. Letsch, County Clerk
Ruth Ann Rose