

71993

Vol. M98 Page 46956

Return to: 98 Dec 23 11:29

Pacific Power

PQ Box 728

Klamath Falls, OR

97601-0321

RC:41360 WO:01483350

**UNDERGROUND DISTRIBUTION RIGHT OF WAY EASEMENT**

For value received, Gary D Crouch and Christopher J Miller(Grantor) hereby grants to PacifiCorp, an Oregon corporation, its successors and assigns (Grantee), an easement for a right of way 10 feet in width for the construction, reconstruction, operations, maintenance, repair, replacement, enlargement, and removal of underground electric power distribution lines, communication lines and all necessary or desirable accessories and appurtenances thereto, including without limitation: wires, fibers, cables and other conductors and conduits therefor; and pads, transformers, switches, vaults and cabinets; and the right to excavate and refill trenches therefor; along the general course now located by Grantee on, over or under the surface of the real property of Grantor in Klamath County, State of Oregon, more particularly described as follows or as more particularly described and/or shown on Exhibit(s) A attached hereto and by this reference made a part hereof:

Said property generally located in The SE ¼ NE ¼ of Section 4 Township 39 S, Range 9 E, of the Willamette Meridian, and more specifically described in Volume 97 Page 13709 in the Official Records of Klamath County.

Assessor's Map No. 39 09 04AD Tax Parcel No. 405

Together with the right of access to the right of way from adjacent lands of Grantor for all activities in connection with the purposes for which this easement has been granted; and together with the present and (without payment therefor) the future right to keep the right of way and adjacent lands clear of all brush, trees, timber, structures and other hazards which might endanger Grantee's facilities or impede Grantee's activities.

At no time shall Grantor erect or permit the erection of any buildings or structures of any kind or nature within the right of way without the prior written consent of Grantee, or light any fires, or place or store any flammable materials (other than agricultural crops), on or within the boundaries of the right of way. Subject to the foregoing limitations, the surface of the right of way may be used for roads, agricultural crops and other purposes not inconsistent with the purposes for which this easement has been granted.

20-

20-

83091

8146957

The rights and obligations of the parties hereto shall be binding upon and shall benefit their respective heirs, successors and assigns; and this easement shall terminate if and when Grantee shall have abandoned all use of the right of way and no longer has any future need therefor.

Signed this 27<sup>th</sup> day of NOVEMBER 1998.

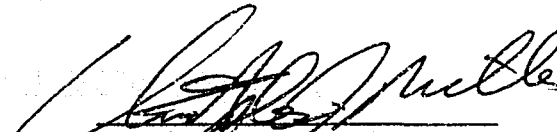
  
CHRISTOPHER J. MILLER

STATE OF OREGON )  
County of Lane ) SS.

This instrument was acknowledged before me on November 27, 1998  
by Chris Miller

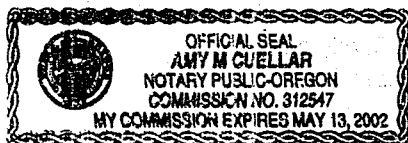

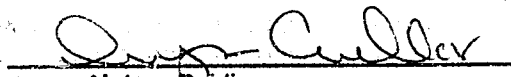
  
Notary Public  
My Commission Expires May 13, 2002  
Is:

# EXHIBIT A

46958

PACIFIC POWER & LIGHT COMPANY

OWNER Gary D. Crouch & Christopher J. Miller E.R./W.O. 41360-01483350

SE 1/4 NE 1/4 SEC. 4, T. 39S, R. 9E, W.M. MAP 39 09 04 AD

KLAMATH COUNTY, OREGON

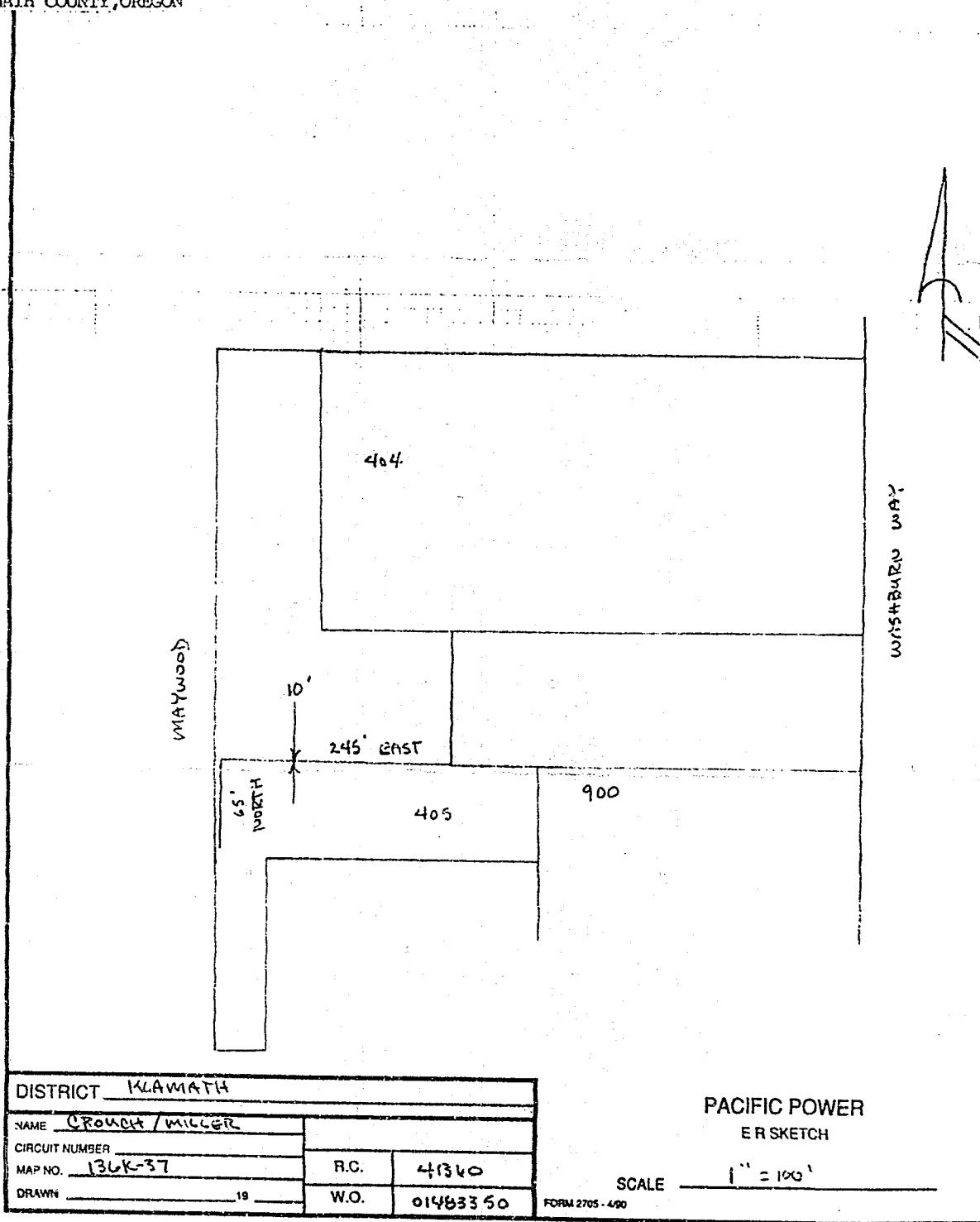

STATE OF OREGON: COUNTY OF KLAMATH: ss.

Filed for record at request of Pacific Power the 23rd day of December A.D., 1998 at 11:29 o'clock A. M., and duly recorded in Vol. M98 of Deeds on Page 46956.

FEE 20.00

By Bernetha G. Letsch, County Clerk  
*Kathleen Ross*

Return to: a record, granted to said person and to any person or persons who may hereafter acquire the same, to the Pacific Power and Light Company, its successors and assigns, for the purpose of constructing, operating, maintaining, repairing, replacing, enlarging, and removing electric power transmission, distribution, and communication lines and all necessary or desirable accessories and appurtenances thereto, including without limitation: supporting towers, poles, props, guys and anchors, including guys and anchors outside of the right of way; wires, fibers, cables and other conductors and conduits therefor; and pads, transformers, switches, vaults and cabinets, along the general course now located by Grantee on, over or under the surface of the real property of Grantor in Klamath County, State of Oregon, more particularly described as follows or as more particularly described and/or shown on Exhibit(s) A attached hereto and by this reference made a part hereof:

RC: 41360 WO: 01497836

### RIGHT OF WAY EASEMENT

For value received Grant and Krysti Haigh (Grantor) hereby grants to PacifiCorp, an Oregon corporation, its successors and assigns (Grantee), an easement for a right of way 10 feet in width and 310 feet in length, more or less, for the construction, reconstruction, operation, maintenance, repair, replacement, enlargement, and removal of electric power transmission, distribution, and communication lines and all necessary or desirable accessories and appurtenances thereto, including without limitation: supporting towers, poles, props, guys and anchors, including guys and anchors outside of the right of way; wires, fibers, cables and other conductors and conduits therefor; and pads, transformers, switches, vaults and cabinets, along the general course now located by Grantee on, over or under the surface of the real property of Grantor in Klamath County, State of Oregon, more particularly described as follows or as more particularly described and/or shown on Exhibit(s) A attached hereto and by this reference made a part hereof:

Said property generally located in The SE  $\frac{1}{4}$  SW  $\frac{1}{4}$  of Section 7 Township 40 Range 10E, of the Willamette Meridian, and more specifically described in Volume M74 Page 8982 in the Official Records of Klamath County.

Assessor's Map No. 164 Tax Parcel No. 02500

Together with the right of access to the right of way from adjacent lands of Grantor for all activities in connection with the purposes for which this easement has been granted; and together with the present and (without payment therefor) the future right to keep the right of way and adjacent lands clear of all brush, trees, timber, structures, buildings and other hazards which might endanger Grantee's facilities or impede Grantee's activities.

At no time shall Grantor place, use or permit any equipment or material of any kind that exceeds 12 feet in height, light any fires, or place or store any flammable material (other than agricultural crops), on or within the boundaries of the right of way. Subject to the foregoing limitations, the surface of the right of way may be used for roads, agricultural crops and other purposes not inconsistent with the purposes for which this easement has been granted.

120000

146960

The rights and obligations of the parties hereto shall be binding upon and shall benefit their heirs, successors and assigns; and this easement shall terminate if and when Grantee shall have abandoned all use of the right of way and no longer has any future need therefor.

Signed this 14 day of December, 1998.

Grant Carl Haigh Jr

THIS PAGE YAW TO PAGE

STATE OF Oregon

SS.

County of Klamath

This instrument was acknowledged before me on December 14, 1998  
by Grant Carl Haigh Jr.

Deborah Torrie

Notary Public

My Commission Expires Oct. 14, 2001

Is.

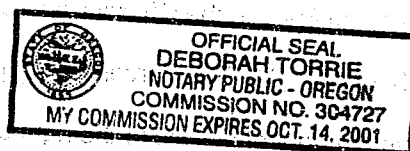
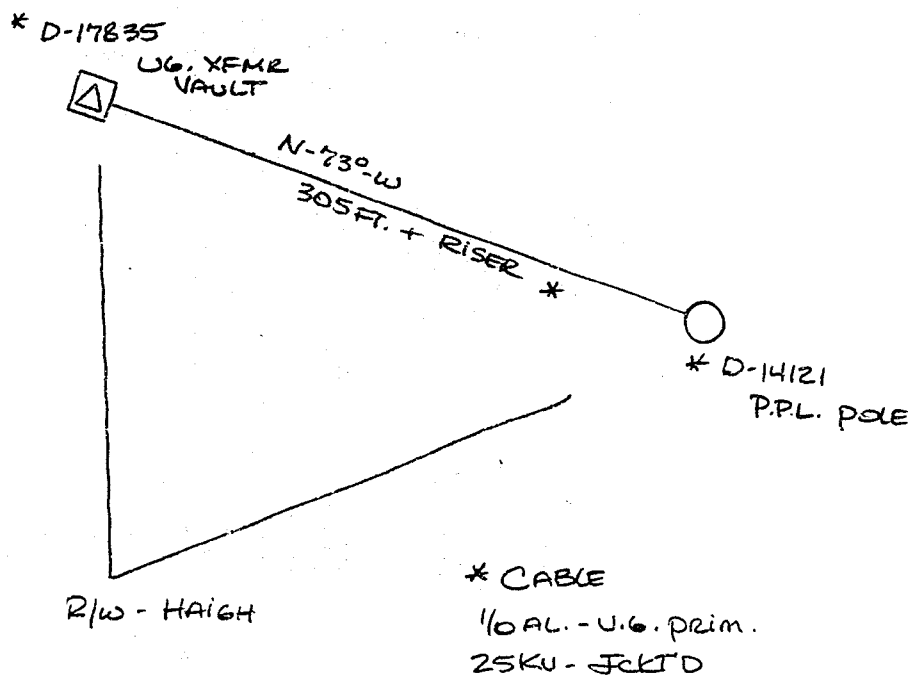

EXHIBIT "A"

46961



STATE OF OREGON,  
County of Klamath ss.

Filed for record at request of:

Pacific Power  
on this 23rd day of December A.D., 1998  
at 11:29 o'clock A.M. and duly recorded  
in Vol. M98 of Deeds Page 46959

Bernetha G. Letsch, County Clerk

By Kathleen Ross  
Fee, \$20.00 Deputy.

GRANT HAIGH  
8080 ELLIOT RD. KF  
5L58  
WO. 01497836  
611 E.R.