

Return to:  
Pacific Power  
PO Box 728  
Klamath Falls, OR  
97601-0321

Vol M99 Page 30265

1999 JUL 29 PM 3:16

RC:41360 WO:01407726

### UNDERGROUND DISTRIBUTION RIGHT OF WAY EASEMENT

For value received, Borggrebe Family Trust, John Borggrebe Trustee, Wilma K. Borggrebe Trustee(Grantor) hereby grants to PacifiCorp, an Oregon corporation, its successors and assigns (Grantee), an easement for a right of way 10 feet in width for the construction, reconstruction, operations, maintenance, repair, replacement, enlargement, and removal of underground electric power distribution lines, communication lines and all necessary or desirable accessories and appurtenances thereto, including without limitation: wires, fibers, cables and other conductors and conduits therefor, and pads, transformers, switches, vaults and cabinets; and the right to excavate and refill trenches therefor, along the general course now located by Grantee on, over or under the surface of the real property of Grantor in Klamath County, State of Oregon, more particularly described as follows or as more particularly described and/or shown on Exhibit(s) A attached hereto and by this reference made a part hereof:

Said property generally located in The NE ¼, NE ¼ of Section 36 Township 35S, Range 12E, of the Willamette Meridian, and more specifically described in Volume M97 Page 15727 in the Official Records of Klamath County.

Assessor's Map No. 35-12-36 Tax Parcel No. 100

Together with the right of access to the right of way from adjacent lands of Grantor for all activities in connection with the purposes for which this easement has been granted, and together with the present and (without payment therefor) the future right to keep the right of way and adjacent lands clear of all brush, trees, timber, structures and other hazards which might endanger Grantee's facilities or impede Grantee's activities.

At no time shall Grantor erect or permit the erection of any buildings or structures of any kind or nature within the right of way without the prior written consent of Grantee, or light any fires, or place or store any flammable materials (other than agricultural crops), on or within the boundaries of the right of way. Subject to the foregoing limitations, the surface of the right of way may be used for roads, agricultural

crops and other purposes not inconsistent with the purposes for which this easement has been granted.

The rights and obligations of the parties hereto shall be binding upon and shall benefit their respective heirs, successors and assigns; and this easement shall terminate if and when Grantee shall have abandoned all use of the right of way and no longer has any future need therefor.

Signed this 16 day of February, 1999.

John Borggrebe  
John Borggrebe Trustee

Wilma K. Borggrebe  
Wilma K. Borggrebe Trustee

STATE OF California  
~~OREGON~~ )  
County of Los Angeles )  
SS.

This instrument was acknowledged before me on 2-16, 1999,  
by Mary J. Mercado, Notary Public



Mary J. Mercado  
Notary Public  
My Commission Expires March 31, 2001  
Is.

# EXHIBIT "A"

30267

PROP. OWNER:

JELD-WEN TIMBER & RANCHES

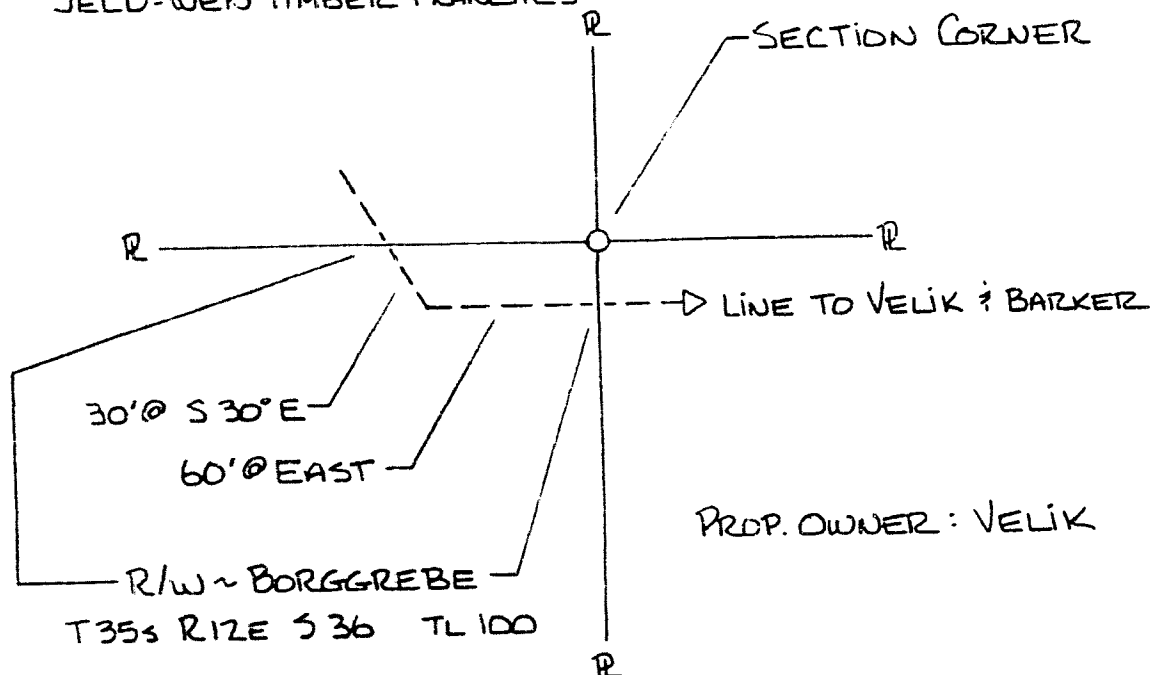

NEW CABLE TO BE:

7.2KV/1/C - 1/0AL 25KV EPR JKT.

DIRECT BURIED AT  $\pm$  3 FT.

State of Oregon, County of Klamath  
Recorded 7/29/99, at 3:16 p. m.  
In Vol. M99 Page 30265  
Linda Smith.  
County Clerk Fee \$ 20.00



DISTRICT KLAMATH FALLS, OR.	
NAME VELIK-BARKER	SYCAN SHOP RD.
CIRCUIT NUMBER 541	R.C. 41360
MAP NO B-131-7 & B-140-9	W.O. 01407726
DRAWN A. FARNSWORTH 98	

PACIFIC POWER  
E R SKETCH

SCALE NONE

FORM 2705-490