

After Recording Return to:
Crown Pacific Limited Partnership
805 S. W. Industrial Way, Suite 4
Bend, OR 97702

All Tax Statements should be sent to:
Crown Pacific Limited Partnership
121 S. W. Morrison Street, Suite 1500
Portland, OR 97204

Consideration: \$0.00

MTC 45253
BARGAIN AND SALE DEED

IN CONSIDERATION of the exchange of land and other valuable consideration, Bell "A" Land and Cattle Company, Inc., an Oregon Corporation, Grantor, does hereby grant, bargain, sell and convey unto Crown Pacific Limited Partnership, Grantee that certain real property in Klamath County, State of Oregon described in the attached Schedule 2 with all tenements, hereditaments and appurtenances thereunto belonging or in any way appertaining.

See attached Schedule 2

TO HAVE AND TO HOLD, the same unto Grantee and Grantee's heirs, successors and assigns forever.

GRANTOR HEREBY COVENANTS to and with Grantee and Grantee's heirs, successors and assigns, that Grantor is lawfully seized in fee simple the above premises, free from all encumbrances except those of record and those apparent upon the land, if any, as of the date of this deed.

IN WITNESS WHEREOF, the Grantor executed this instrument on the 24th day of February, 2000.

THIS INSTRUMENT WILL NOT ALLOW USE OF THE PROPERTY DESCRIBED IN THIS INSTRUMENT IN VIOLATION OF APPLICABLE LAND USE LAWS AND REGULATIONS. BEFORE SIGNING OR ACCEPTING THIS INSTRUMENT, THE PERSON ACQUIRING FEE TITLE TO THE PROPERTY SHOULD CHECK WITH THE APPROPRIATE CITY OR COUNTY PLANNING DEPARTMENT TO VERIFY APPROVED USES AND TO DETERMINE ANY LIMITS ON LAWSUITS AGAINST FARMING OR FOREST PRACTICES AS DEFINED IN ORS 30.930.

BELL A LAND AND CATTLE COMPANY, INC.

By: [Signature]

STATE OF OREGON, County of Lake
This instrument was acknowledged before me this 24th day of February, 2000, by Theresa Cliffe, of BELL A LAND AND CATTLE COMPANY, INC.



Janet L. Curtis-Roofener
Notary Public for Oregon
Commission expires: 3/19/02

200 MAR -7 AM 11:46

56.00 m

SCHEDULE 2

BELL A LAND & CATTLE COMPANY to CROWN PACIFIC

IN TOWNSHIP 23 SOUTH, RANGE 9 EAST, W. M.

SECTION 35 That portion of the NW1/4NW1/4 lying southeasterly of a line that is defined as follows:

Beginning at a point in the West line of Section 35, Township 23 South, Range 9 East which is in, or in the extension of, a line marked by a 5/8" iron rod projecting 12" above the ground approximately 66 feet north of the West quarter corner of Section 35 and another similar iron rod N 45 degrees E 326 feet distant;

Thence (from the point of beginning) to the second (northernmost) of the two iron rod markers mentioned above

Thence N 16 degrees E approximately 405 feet to a 5/8" iron rod projecting 12" above the ground

Thence N 48 degrees E approximately 388 feet to a 5/8" iron rod projecting 12" above the ground

Thence N 57 degrees E approximately 423 feet to a point in the south line of the NW1/4NW1/4 of Section 35

Thence continuing N 57 degrees E approximately 16 feet to a 5/8" iron rod projecting 12" above the ground

Thence N 53 degrees E approximately 412 feet to a 5/8" iron rod projecting 12" above the ground

Thence N 36 degrees E approximately 350 feet to a point in the east line of the NW1/4NW1/4 of Section 35

Thence continuing N 36 degrees E approximately 44 feet to a 5/8" iron rod projecting 12" above the ground

Thence N 18 degrees E approximately 398 feet to a 5/8" iron rod projecting 12" above the ground

Thence N 31 degrees E approximately 366 feet to a 5/8" iron rod projecting 12" above the ground near the North line of Section 35

Thence N 7 degrees W approximately 432 feet to a 5/8" iron rod projecting 12" above the ground

Thence N 25 degrees E approximately 401 feet to a 5/8" iron rod projecting 12" above the ground

Thence N 30 degrees E approximately 623 feet to a 5/8" iron rod projecting 12" above the ground

Terminating at a point in the north line of the SE1/4SW1/4 of Section 26 which is in, or in the extension of, the final course described above, approximately 512 feet west of the North-South centerline of the Section

as shown on the attached Exhibit B

Bell A Ranches to Crown Pacific
Exhibit B

Twp. 23 S Rge. 9E
Section 26 & 35

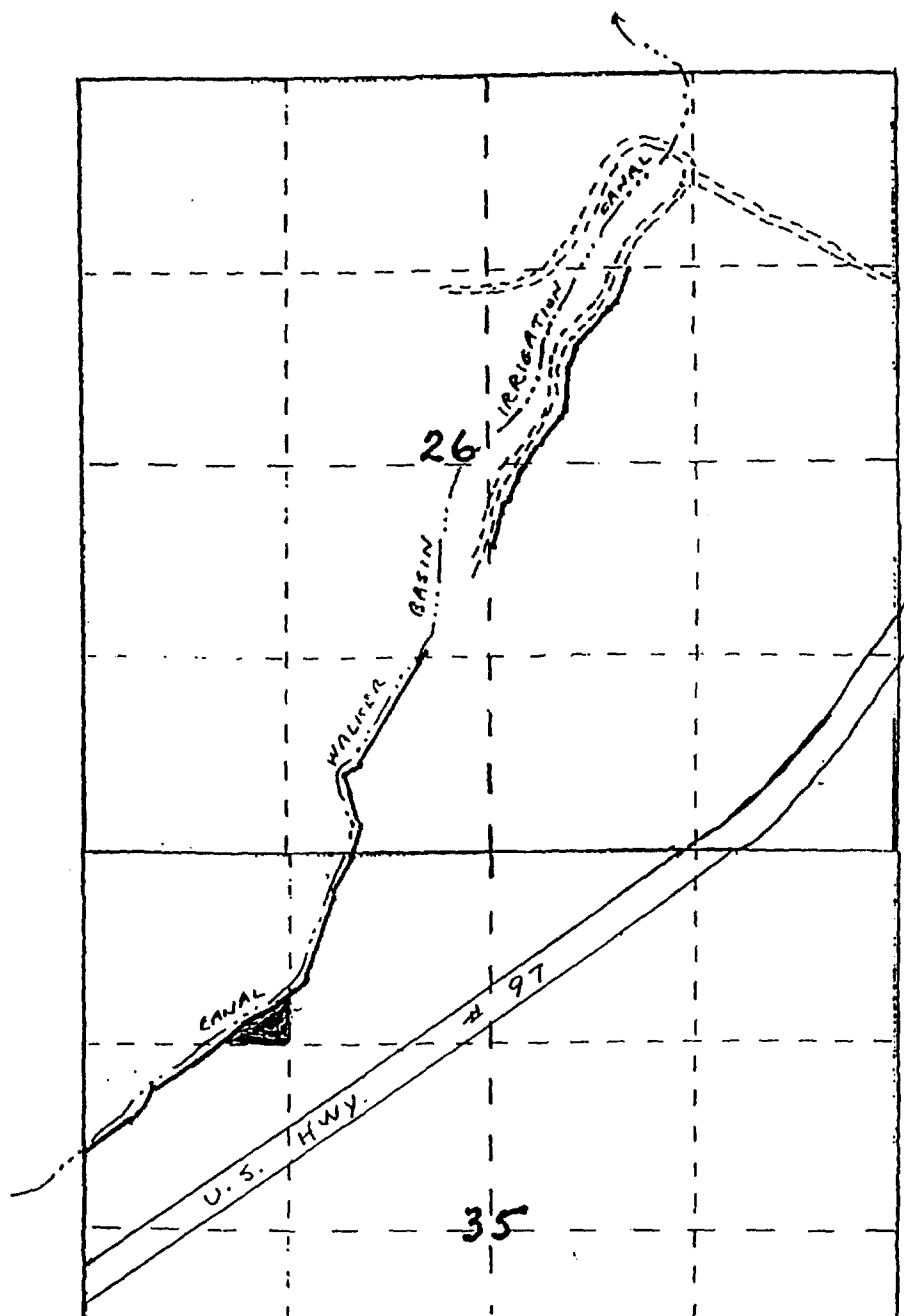

SCALE: 4 inches = 1 mile

SCHEDULE 2 (cont'd)

BELL A LAND & CATTLE COMPANY to CROWN PACIFIC

IN TOWNSHIP 23 SOUTH, RANGE 9 EAST, W. M.

SECTION 34 Those portions of the SE1/4NE1/4, NW1/4SE1/4 and S1/2SW1/4 lying southeasterly of a line running from a point in the East line of Section 34, Township 23 South, Range 9 East which is in, or in the extension of, a line marked by a 5/8" iron rod projecting 12" above the ground driven approximately 1.5 feet east from the north post of a board gate in a wood rail fence approximately 66 feet north of the East quarter corner of Section 34 and a similar iron rod S 35 degrees W 770 feet distant, and another line to a point in the West line of Section 3, Township 24 South, Range 9 East which is in, or in the extension of, a line from the second (southernmost) iron rod mentioned above to a 5/8" iron rod projecting 12" above the ground in a fence line approximately 5,530 feet S 60 degrees W distant and approximately 688 feet south from the Northwest corner of Section 3

as shown on the attached Exhibit A

IN TOWNSHIP 24 SOUTH, RANGE 9 EAST, W. M.

SECTION 5 The South Half of the Southwest Quarter of the Southeast Quarter

SECTION 7 That portion of the NE1/4NE1/4 lying southeasterly of a line running from the southwest corner to the northeast corner of that subdivision of Section 7

AND

Those portions of the S1/2NW1/4 and SW1/4NE1/4 that lie southeasterly of a line running from the southeast corner of the SW1/4SW1/4NW1/4 to the northeast corner of the SW1/4NE1/4 of Section 7

as shown on the attached Exhibit C

Bell A Ranches to Crown Pacific
Exhibit A

Twp. 23 & 24 S Rge. 9E

Section 34 & 3

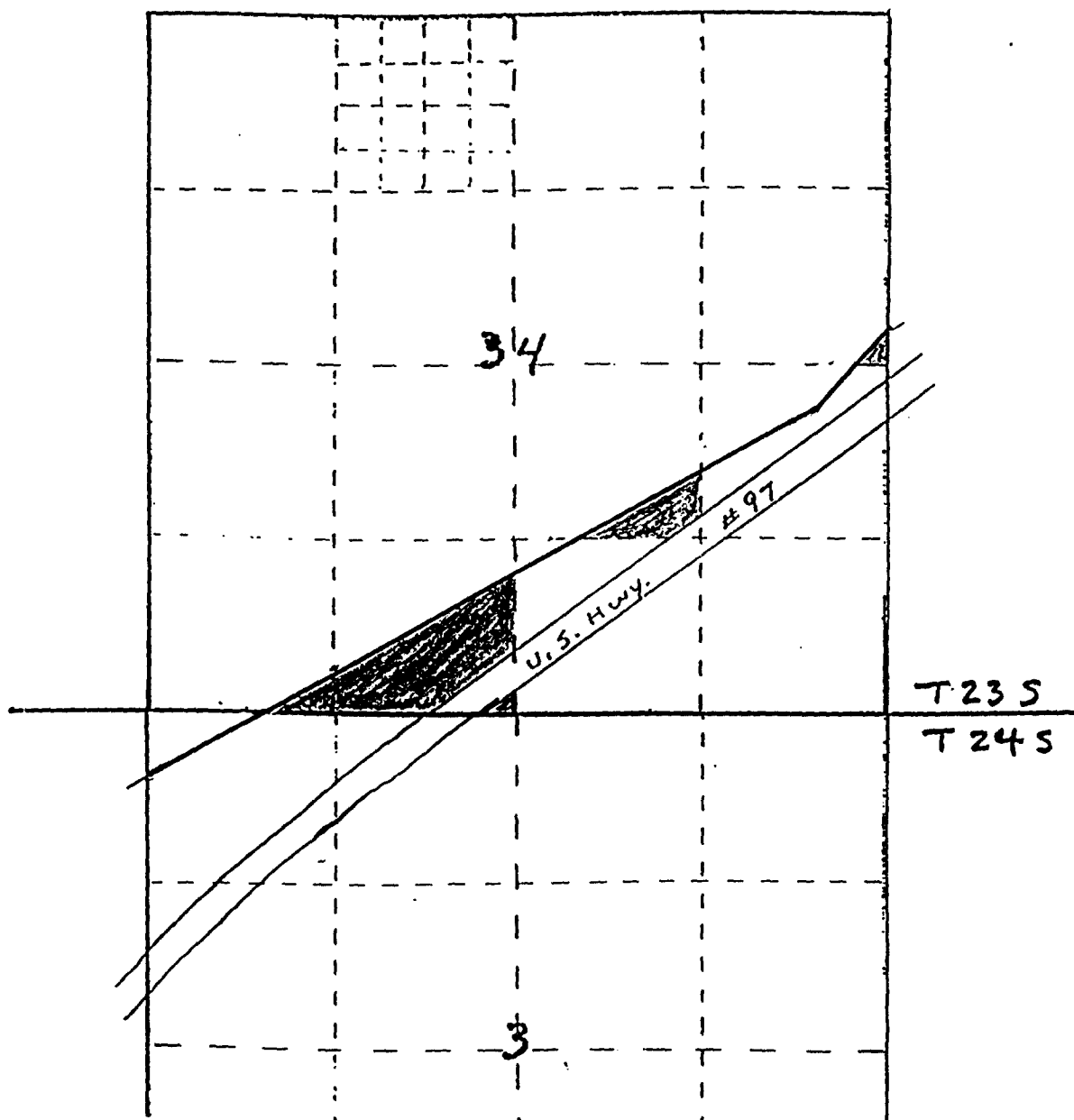

SCALE: 4 inches = 1 mile

Bell A Ranches to Crown Pacific
Exhibit C

Twp. 24 S Rge. 9 E
Section 7

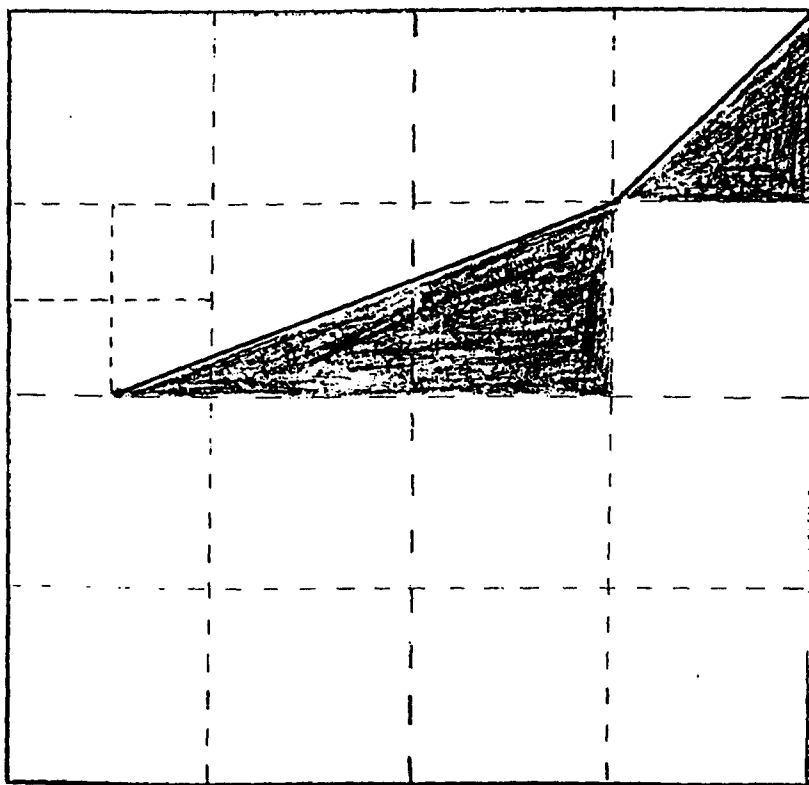

SCALE: 4 inches = 1 mile

SCHEDULE 2 (cont'd)

BELL A LAND & CATTLE COMPANY to CROWN PACIFIC

IN TOWNSHIP 24 SOUTH, RANGE 8 EAST, W. M.

SECTION 12 Those portions of the SE1/4NE1/4 and NW1/4SE1/4 lying northwesterly of a line that is defined as follows:

Beginning at a point in the East line of Section 12 which is in, or in the extension of, a line marked by a 5/8" iron rod projecting 12" above the ground approximately 615 feet south of the northeast corner of that Section 12 and another similar iron rod S 45 degrees W approximately 495 feet distant

Thence (from the point of beginning) to the second (southernmost) of the two iron rod markers mentioned above

Thence S 64 degrees W approximately 377 feet to a 5/8" iron rod projecting 12" above the ground

Thence S 59 degrees W approximately 78 feet to a point in the south line of the NE1/4NE1/4 of Section 12

Thence continuing S 59 degrees W approximately 241 feet to a 5/8" iron rod projecting 12" above the ground

Thence S 60 degrees W approximately 370 feet to a point in the west line of the SE1/4NE1/4 of Section 12

Thence continuing S 60 degrees W approximately 89 feet to a 5/8" iron rod projecting 12" above the ground

Thence S 42 degrees W approximately 290 feet to a 5/8" iron rod projecting 12" above the ground

Thence S 29 degrees W approximately 263 feet to a 5/8" iron rod projecting 12" above the ground

Thence S 21 degrees W approximately 742 feet to a 5/8" iron rod projecting 12" above the ground

Thence S 26 degrees W approximately 123 feet to a point in the south line of the SW1/4NE1/4 of Section 12

Thence continuing S 26 degrees W approximately 88 feet to a 5/8" iron rod projecting 12" above the ground

Thence S 37 degrees W approximately 150 feet to a 5/8" iron rod projecting 12" above the ground

Thence S 53 degrees W approximately 282 feet to a 5/8" iron rod projecting 12" above the ground

Thence S 60 degrees W approximately 446 feet to a 5/8" iron rod projecting 12" above the ground

Terminating at a point in the North-South centerline of Section 12 which is in, or in the extension of, the final course described above, approximately 690 feet south of the center of the Section

as shown on the attached Exhibit D

Bell A Ranches to Crown Pacific
Exhibit D

7261

Twp. 24 S Rge. 8 E
Sections 11 to 14

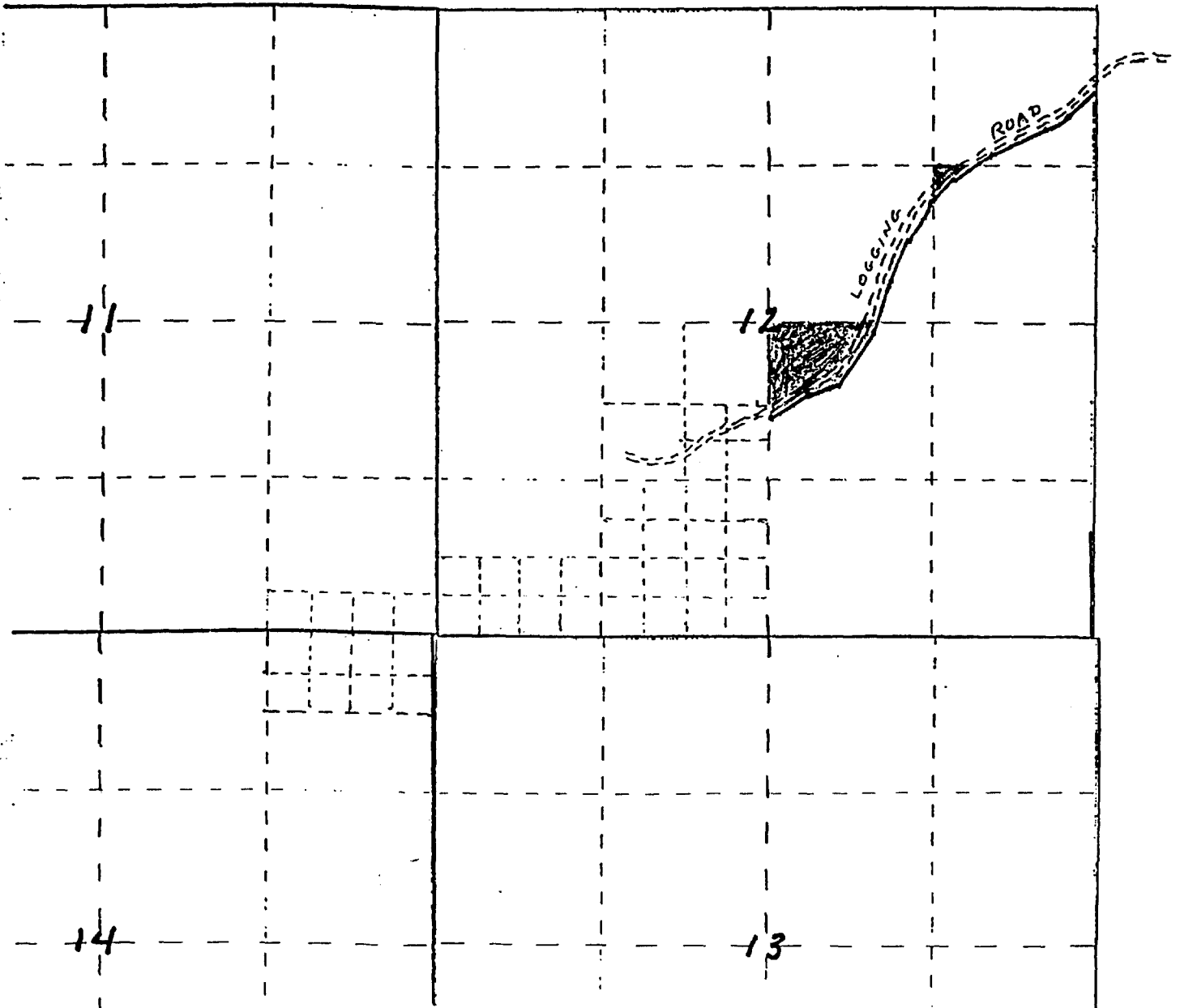

SCALE: 4 inches = 1 mile

State of Oregon, County of Klamath
Recorded 3/07/00, at 11:46 a. m.
In Vol. M00 Page 7254
Linda Smith,
County Clerk Fee \$ 56.00