

88
Return to:
Pacific Power
PO Box 728
Klamath Falls, OR
97601-0321

200 AUG -8 AM 8: 54

Vol M00 Page 28905

RC:11176 WO:01579859

UNDERGROUND DISTRIBUTION RIGHT OF WAY EASEMENT

For value received, Patrick Cahill and Susan Cahill(Grantors) hereby grants to PacificCorp, an Oregon corporation, its successors and assigns (Grantee), an easement for a right of way 10 feet in width for the construction, reconstruction, operations, maintenance, repair, replacement, enlargement, and removal of underground electric power distribution lines, communication lines and all necessary or desirable accessories and appurtenances thereto, including without limitation: wires, fibers, cables and other conductors and conduits therefor; and pads, transformers, switches, vaults and cabinets; and the right to excavate and refill trenches therefor; along the general course now located by Grantee on, over or under the surface of the real property of Grantor in Klamath County, State of Oregon, more particularly described as follows or as more particularly described and/or shown on Exhibit(s) A attached hereto and by this reference made a part hereof:

Said property generally located in The SE ¼ of the SW ¼ of Section 1
Township 39S, Range 9E of the Willamette Meridian, and more specifically
Described in volume M99 Page 23246 in the Official Records of Klamath County.

Assessor's Map No. Parcel #1: 3909-1CD-6404, Parcel #2: 3909-1CD-6403,
Parcel #3: 3909-1CD-6400 Tax Parcel No. R-886100/R-886099/R-509211.

Together with the right of access to the right of way from adjacent lands of Grantor for all activities in connection with the purposes for which this easement has been granted; and together with the present and (without payment therefor) the future right to keep the right of way and adjacent lands clear of all brush, trees, timber, structures and other hazards which might endanger Grantee's facilities or impede Grantee's activities.

At no time shall Grantor erect or permit the erection of any buildings or structures of any kind or nature within the right of way without the prior written consent of Grantee, or light any fires, or place or store any flammable materials (other than agricultural crops), on or within the boundaries of the right of way. Subject to the foregoing limitations, the surface of the right of way may be used for roads, agricultural crops and other purposes not inconsistent with the purposes for which this easement has been granted.

The rights and obligations of the parties hereto shall be binding upon and shall benefit their respective heirs, successors and assigns; and this easement shall terminate if and when Grantee shall have abandoned all use of the right of way and no longer has any future need therefor.

Signed this 25 day of May, 192000.

Patrick W. Cahill
Patrick Cahill

Susan Cahill
Susan Cahill

STATE OF OREGON

County of Klamath)
SS.)

This instrument was acknowledged before me on May 25, 192000
by Patrick Cahill & Susan Cahill

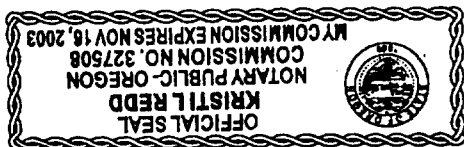

Kristin L. Redd
Notary Public
My Commission Expires 11/16/2003

Is.

EXHIBIT "A"

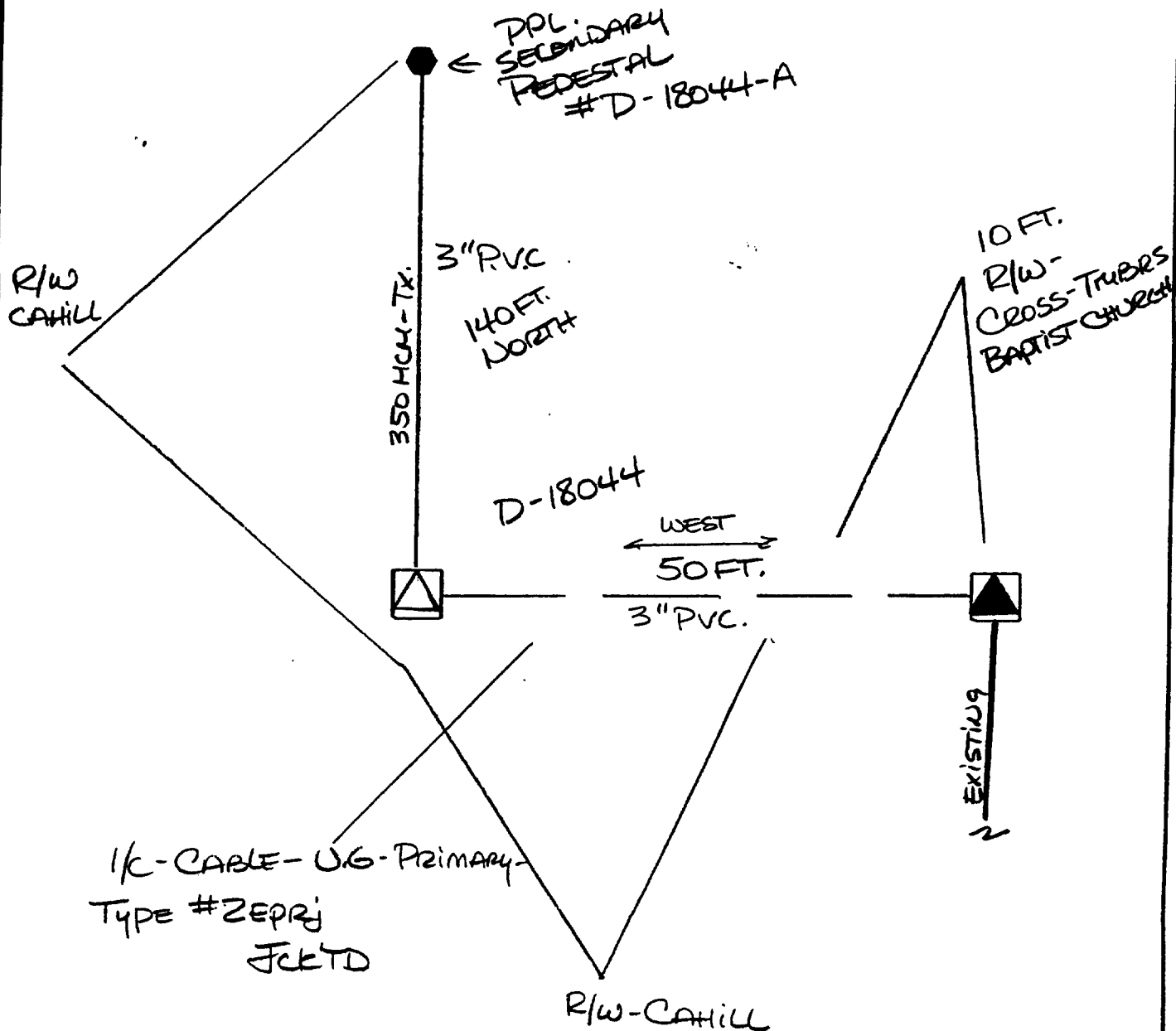

State of Oregon, County of Klamath
 Recorded 08/08/00, at 8:54 a. m.
 In Vol. M00 Page 28905
 Linda Smith,
 County Clerk Fee \$ 31.00

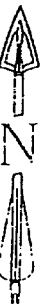

DISTRICT <u>Klamath</u>	
NAME <u>PAT CAHILL</u>	
CIRCUIT NUMBER <u>5L2</u>	
MAP NO. <u>136D-69-1-D-2</u>	R.C. <u>11176</u>
DRAWN <u>CTB 2000</u>	W.O. <u>01579859</u>

PACIFIC POWER
 E R SKETCH

SCALE NOT - TO SCALE