

Return to: Pacific Power
1950 Mallard Ln
Klamath Falls, OR 97601

CC#: 11176 WO#: 01916086

RIGHT OF WAY EASEMENT

Vol M01 Page 41570

For value received, Steve Berger & Sandy Berger, ("Grantor"), hereby grants to PacifiCorp, an Oregon corporation, its successors and assigns, ("Grantee"), an easement for a right of way 10 feet in width and 430 feet in length, more or less, for the construction, reconstruction, operation, maintenance, repair, replacement, enlargement, and removal of electric power distribution and communication lines and all necessary or desirable accessories and appurtenances thereto, including without limitation: wires, fibers, cables and other conductors and conduits therefor; and pads, transformers, switches, vaults and cabinets, along the general course now located by Grantee on, over or under the surface of the real property of Grantor in Klamath County, State of Oregon, more particularly described as follows and as more particularly described and/or shown on Exhibit(s) A attached hereto and by this reference made a part hereof.

Said property generally located in The SW ¼ of Section 28, Township 37S, Range 9E, of the Willamette Meridian, and more specifically described in Volume 01 Page 35826 on the Official Records of Klamath County.

Assessor's Map No. 37 09 28

Tax Parcel No. 700

Together with the right of access to the right of way from adjacent lands of Grantor for all activities in connection with the purposes for which this easement has been granted; and together with the present and (without payment therefor) the future right to keep the right of way and adjacent lands clear of all brush, trees, timber, structures, buildings and other hazards which might endanger Grantee's facilities or impede Grantee's activities.

At no time shall Grantor place, use or permit any equipment or material of any kind that exceeds twelve (12) feet in height, light any fires, place or store any flammable materials (other than agricultural crops), on or within the boundaries of the right of way. Subject to the foregoing limitations, the surface of the right of way may be used for agricultural crops and other purposes not inconsistent, as determined by Grantee, with the purposes for which this easement has been granted.

The rights and obligations of the parties hereto shall be binding upon and shall benefit their respective heirs, successors and assigns.

DATED this 25th day of July, 2001.

[Signature]
Grantor(s) Steve Berger

[Signature]
Grantor(s) Sandy Berger

INDIVIDUAL ACKNOWLEDGMENT

STATE OF Oregon ss.
County of Klamath

This instrument was acknowledged before me on this 25th day of July, 2001, by

Pam Mathes
Pam Mathes

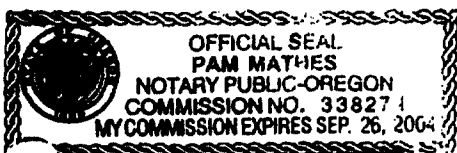

Notary Public

My commission expires: Sept 26, 2004

EXHIBIT A

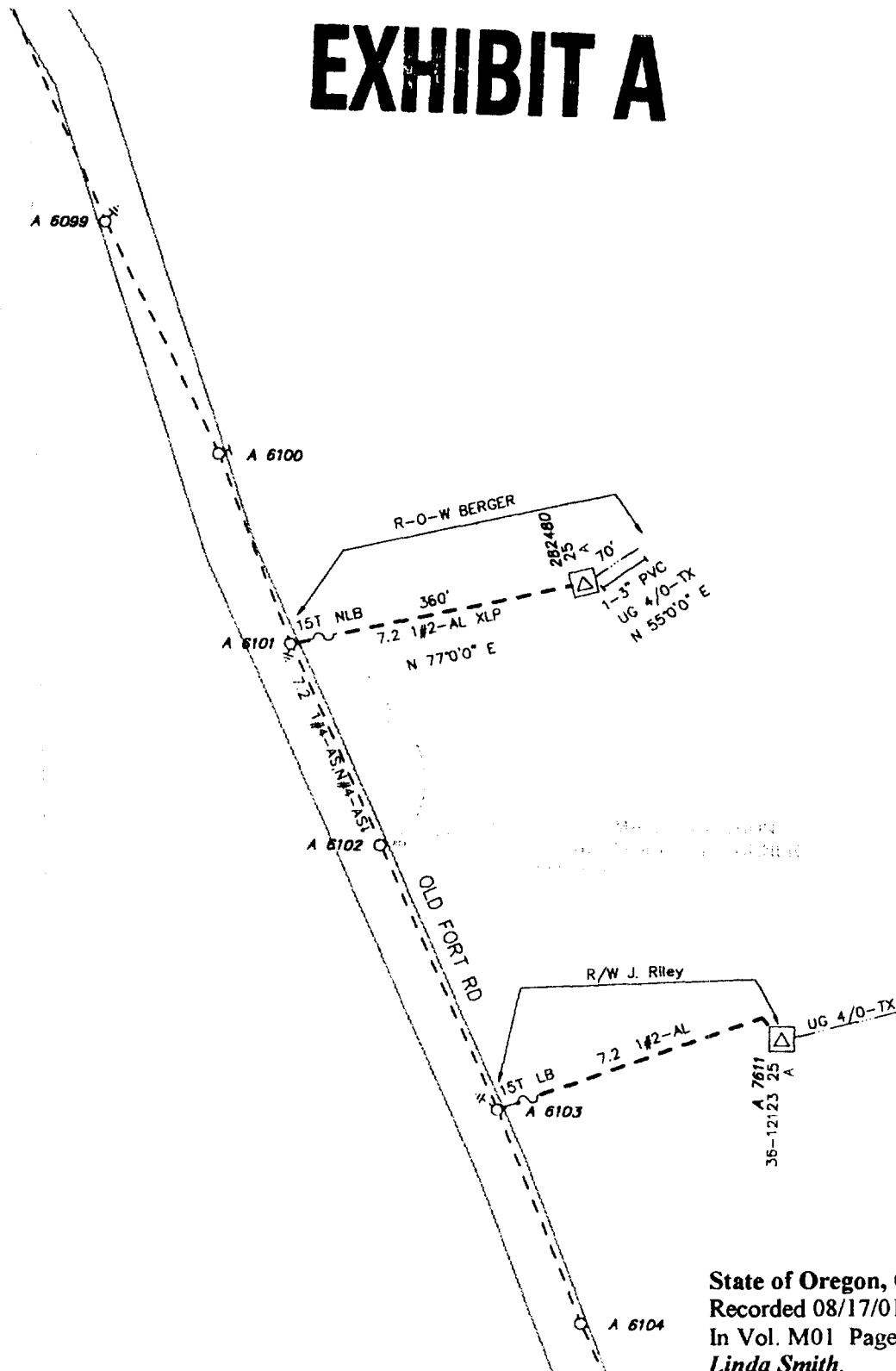

State of Oregon, County of Klamath
 Recorded 08/17/01 at 10:29 a.m.
 In Vol. M01 Page 41570
 Linda Smith,
 County Clerk Fee\$ 26.00

Foreman		Emp #	Job Start Date	
CC#	WO# / REQ#	Map String	Job Comp Date	
11176	001916086	01437009.0		
CUSTOMER : R-O-W BERGER ADDRESS : 10401 OLD FORT RD			Circuit 5L49	Post Jobs <input type="checkbox"/> RQII <input type="checkbox"/> Posted <input type="checkbox"/>
EST ID# 24872		Print Date 06/12/01		Scale 1=200' 1 OF 1



PACIFIC