

Return to: Pacific Power
1950 Mallard Ln.
6^c Klamath Falls, OR. 97601

CC#: 11176 WO#: 02068183

'02 JUN 3 PM 1:24

RIGHT OF WAY EASEMENT

For value received, David and Kim Clem, ("Grantor"), hereby grants to PacifiCorp, an Oregon corporation, its successors and assigns, ("Grantee"), an easement for a right of way 10 feet in width and 560 feet in length, more or less, for the construction, reconstruction, operation, maintenance, repair, replacement, enlargement, and removal of electric power distribution and communication lines and all necessary or desirable accessories and appurtenances thereto, including without limitation: wires, fibers, cables and other conductors and conduits therefor; and pads, transformers, switches, vaults and cabinets, along the general course now located by Grantee on, over or under the surface of the real property of Grantor in Klamath County, State of Oregon, more particularly described as follows and as more particularly described and/or shown on Exhibit(s) "A" attached hereto and by this reference made a part hereof:

Said property generally located in the NorthWest 1/4 of Klamath Falls Forest Estates, Section 23B0, Township 38, Range 11, of the Willamette Meridian, and more specifically described in Volume M02, Page 18933 in the Official Records of Klamath County.

Assessor's Map No. r-3811-23B Tax Parcel No. 1100

Together with the right of access to the right of way from adjacent lands of Grantor for all activities in connection with the purposes for which this easement has been granted; and together with the present and (without payment therefor) the future right to keep the right of way and adjacent lands clear of all brush, trees, timber, structures, buildings and other hazards which might endanger Grantee's facilities or impede Grantee's activities.

At no time shall Grantor place, use or permit any equipment or material of any kind that exceeds twelve (12) feet in height, light any fires, place or store any flammable materials (other than agricultural crops), on or within the boundaries of the right of way. Subject to the foregoing limitations, the surface of the right of way may be used for agricultural crops and other purposes not inconsistent, as determined by Grantee, with the purposes for which this easement has been granted.

The rights and obligations of the parties hereto shall be binding upon and shall benefit their respective heirs, successors and assigns.

DATED this 31 day of May, 2002

David Clem
Grantor(s) David Clem

Kim Clem
Grantor(s) Kim Clem

INDIVIDUAL ACKNOWLEDGMENT

STATE OF Oregon)
County of Klamath)
ss.

This instrument was acknowledged before me on this 31 day of May, 2002, by David Clem & Kim Clem

Pamela Kay Walton
Notary Public

My commission expires: 8-8-04

State of Oregon, County of Klamath
Recorded 06/03/2002 1:24 P
Vol M02, Pg 32554-55
Linda Smith, County Clerk
Fee \$ 26 # of Pgs 2



26✓

32555

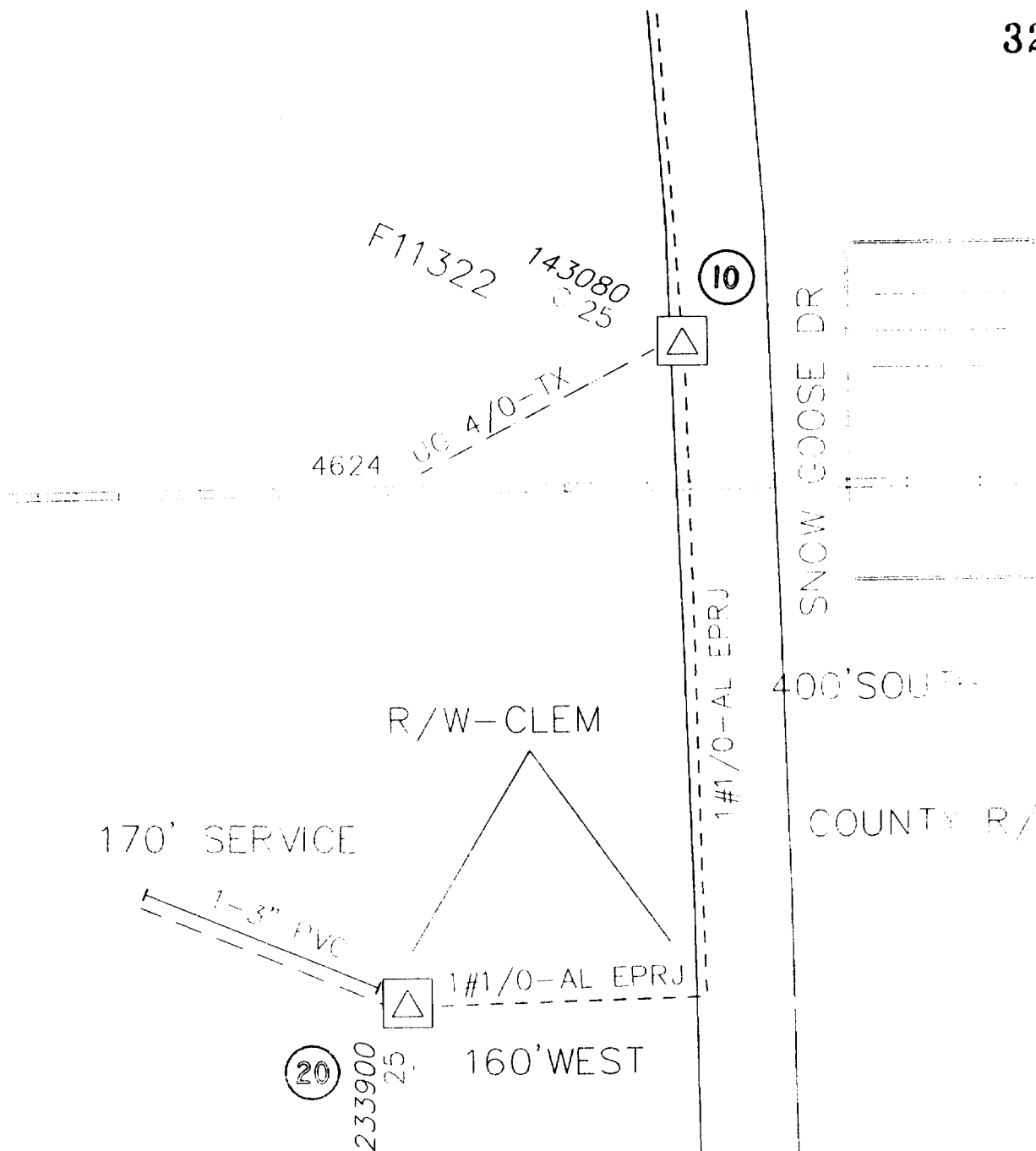

This drawing is preliminary and should be used only as a representation of the location of the easement being conveyed. The exact location of all structures, lines and appurtenances is subject to change.

EXHIBIT A

SCALE:

SHEET

OF

ROW #

Foreman

Emp #

Job Start Date

CC#

WO# / REQ#

Map String

Job Comp Date

11176

002068183

01438011.0

CUSTOMER : DAVID CLEM

ADDRESS : 4738 SNOWGOOSE DR.

Circuit

4L16

Post Jobs ☐

RQII ☐

Posted ☐



PACIFICORP

1 OF 1

EST ID#

12950

Print Date

05/13/02

Scale

1=100'