

Return to: Pacific Power  
1950 Mallard Ln  
Klamath Falls, OR 97601

CC# 11176 WO# 02064449

Vol M02 Page 32558

'02 JUN 3 PM 1:25

State of Oregon, County of Klamath  
Recorded 06/03/2002 1:25 p.m.  
Vol M02, Pg 32558-60  
Linda Smith, County Clerk  
Fee \$ 31.00 # of Pgs 3

RIGHT OF WAY EASEMENT

For value received, Charles W. Schubert and Margaret Schubert, ("Grantor"), hereby grants to PacifiCorp, an Oregon corporation, its successors and assigns, ("Grantee"), an easement for a right of way 20 feet in width and 280 feet in length, more or less, for the construction, reconstruction, operation, maintenance, repair, replacement, enlargement, and removal of electric power transmission, distribution and communication lines and all necessary or desirable accessories and appurtenances thereto, including without limitation: supporting towers, poles, props, guys and anchor, including guys and anchors outside of the right of way; wires, fibers, cables and other conductors and conduits therefor; and pads, transformers, switches, vaults and cabinets, along the general course now located by Grantee on, over or under the surface of the real property of Grantor in Klamath County, State of Oregon, more particularly described as follows and as more particularly described and/or shown on Exhibit(s) A attached hereto and by this reference made a part hereof:

Said property generally located in The NE of Section 8 Township 35N, Range 7E, of the Willamette Meridian, and more specifically described in Volume 01 Page 64761 in the Official Records of Klamath County.

Assessor's Map No. 35 07 8 Tax Parcel No. 500

Together with the right of access to the right of way from adjacent lands of Grantor for all activities in connection with the purposes for which this easement has been granted; and together with the present and (without payment therefor) the future right to keep the right of way and adjacent lands clear of all brush, trees, timber, structures, buildings and other hazards which might endanger Grantee's facilities or impede Grantee's activities.

At no time shall Grantor place, use or permit any equipment or material of any kind that exceeds twelve (12) feet in height, light any fires, place or store any flammable materials (other than agricultural crops), on or within the boundaries of the right of way. Subject to the foregoing limitations, the surface of the right of way may be used for agricultural crops and other purposes not inconsistent, as determined by Grantee, with the purposes for which this easement has been granted.

31✓

32559

The rights and obligations of the parties hereto shall be binding upon and shall benefit their respective heirs, successors and assigns.

DATED this 5 day of 21, 20 02

Charles W. Schubert  
Grantor(s) Charles W. Schubert

Margaret Schubert  
Margaret Schubert

INDIVIDUAL ACKNOWLEDGMENT

STATE OF Oregon )

County of Klamath ) SS.

This instrument was acknowledged before me on this 21 day of  
May, 2002, by Amy G. Wortham

Notary Public

My commission expires: 4-28-06

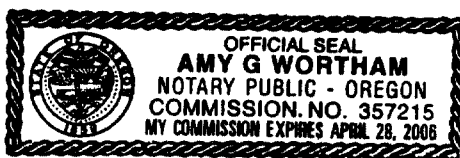



This drawing is preliminary and should be used only as a representation of the location of the easement being conveyed. The exact location of all structures, lines and appurtenances is subject to change.

# EXHIBIT A

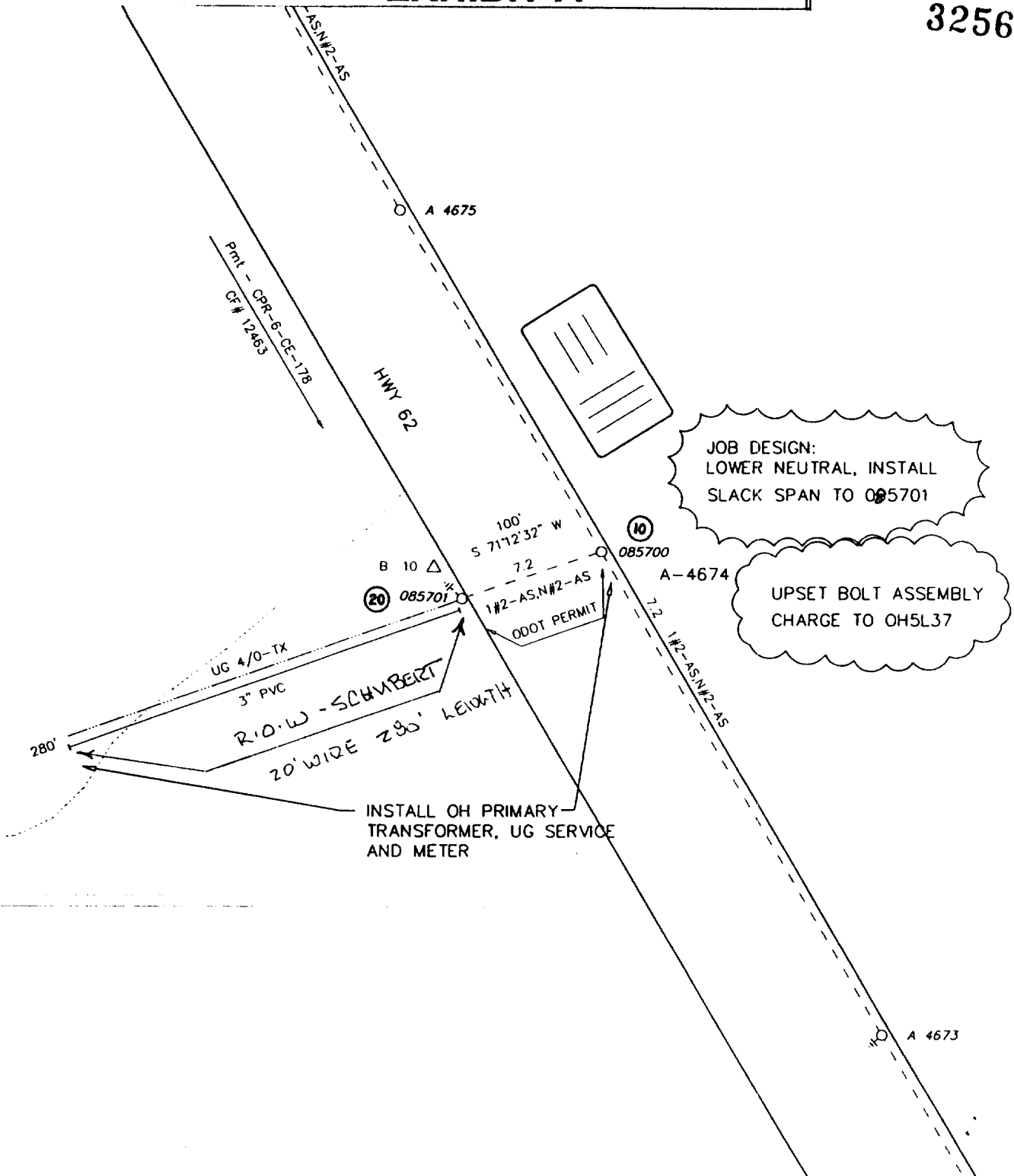
32560



Foreman		Emp #	Job Start Date		 
CC#	WO# / REQ#	Map String	Job Comp Date		
11176	002064449	01435007.0			1 OF 1
CUSTOMER : CHARLES SCHUBERT ADDRESS : 36550 HWY 62			Circuit 5L37	Post Jobs <input type="checkbox"/> RQII <input type="checkbox"/> Posted <input type="checkbox"/>	EST ID# 24872 Print Date 05/13/02 Scale 1=100'