

Return to: Pacific Power
1950 Mallard Ln
Klamath Falls, OR. 97601

CC: 11176 WO: 02063439

'02 AUG 26 AMB:20

RIGHT OF WAY EASEMENT

Vol M02 Page 47848

For value received, QwestCorp., ("Grantor"), hereby grants to PacifiCorp, an Oregon corporation, its successors and assigns, ("Grantee"), an easement for a right of way 10 feet in width and 25 feet in length, more or less, for the construction, reconstruction, operation, maintenance, repair, replacement, enlargement, and removal of electric power transmission, distribution and communication lines and all necessary or desirable accessories and appurtenances thereto, including without limitation: supporting towers, poles, props, guys and anchor, including guys and anchors outside of the right of way; wires, fibers, cables and other conductors and conduits therefor; and pads, transformers, switches, vaults and cabinets, along the general course now located by Grantee on, over or under the surface of the real property of Grantor in Klamath County, State of Oregon, as more particularly described and/or shown on Exhibit(s) "A" attached hereto and by this reference made a part hereof:

Situated in a portion of the said property generally located in the NE 1/4 of Section 32, Township 38S, Range 09E, of the Willamette (OR) Meridian, and more specifically described in Volum M-70 Page 1790 in the Official Records of Klamath County.

Assessor's Map No. Partial lots 5 & 6, all of lots 7 & 8, Block 14, "linkville" Klamath County Oregon
Tax Parcel No. R-3809-032AB-03500-000

Together with the right of access to the right of way from adjacent lands of Grantor for all activities in connection with the purposes for which this easement has been granted; and together with the present and (without payment therefor) the future right to keep the right of way and adjacent lands clear of all brush, trees, timber, structures, buildings and other hazards which might endanger Grantee's facilities or impede Grantee's activities.

At no time shall Grantor place, use or permit any equipment or material of any kind that exceeds twelve (12) feet in height, light any fires, place or store any flammable materials (other than agricultural crops), on or within the boundaries of the right of way. Subject to the foregoing limitations, the surface of the right of way may be used for agricultural crops and other purposes not inconsistent, as determined by Grantee, with the purposes for which this easement has been granted.

The rights and obligations of the parties hereto shall be binding upon and shall benefit their respective heirs, successors and assigns.

DATED this 18th day of July, 2 002.

QWEST CORPORATION, a Colorado corporation
BY Qwest Business Resources, Inc., as agent

Attest:

(Secretary)

By:

Marshall J. Cochrane

Authorized Signatory

REPRESENTATIVE ACKNOWLEDGMENT

STATE OF COLORADO
CITY AND _____
County of DENVER

ss.

State of Oregon, County of Klamath
Recorded 08/26/2002 8:20 a. m.
Vol M02, Pg 47848-49
Linda Smith, County Clerk
Fee \$ 26.00 # of Pgs 2

This instrument was acknowledged before me on this 18th day of July, 2 002, by
Marshall J. Cochrane Authorized Signatory for Qwest Business Resources, Inc.,
as agent for Qwest Corporation, a Colorado corporation.

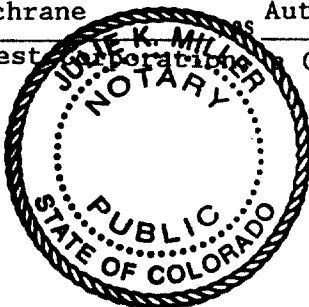

Notary Public

My Commission Expires: Nov. 22, 2004

My Commission Expires Nov. 22, 2004

06/14/02 15:50 FAX 5418837838

PP&L SVC KFALLS

003

47849

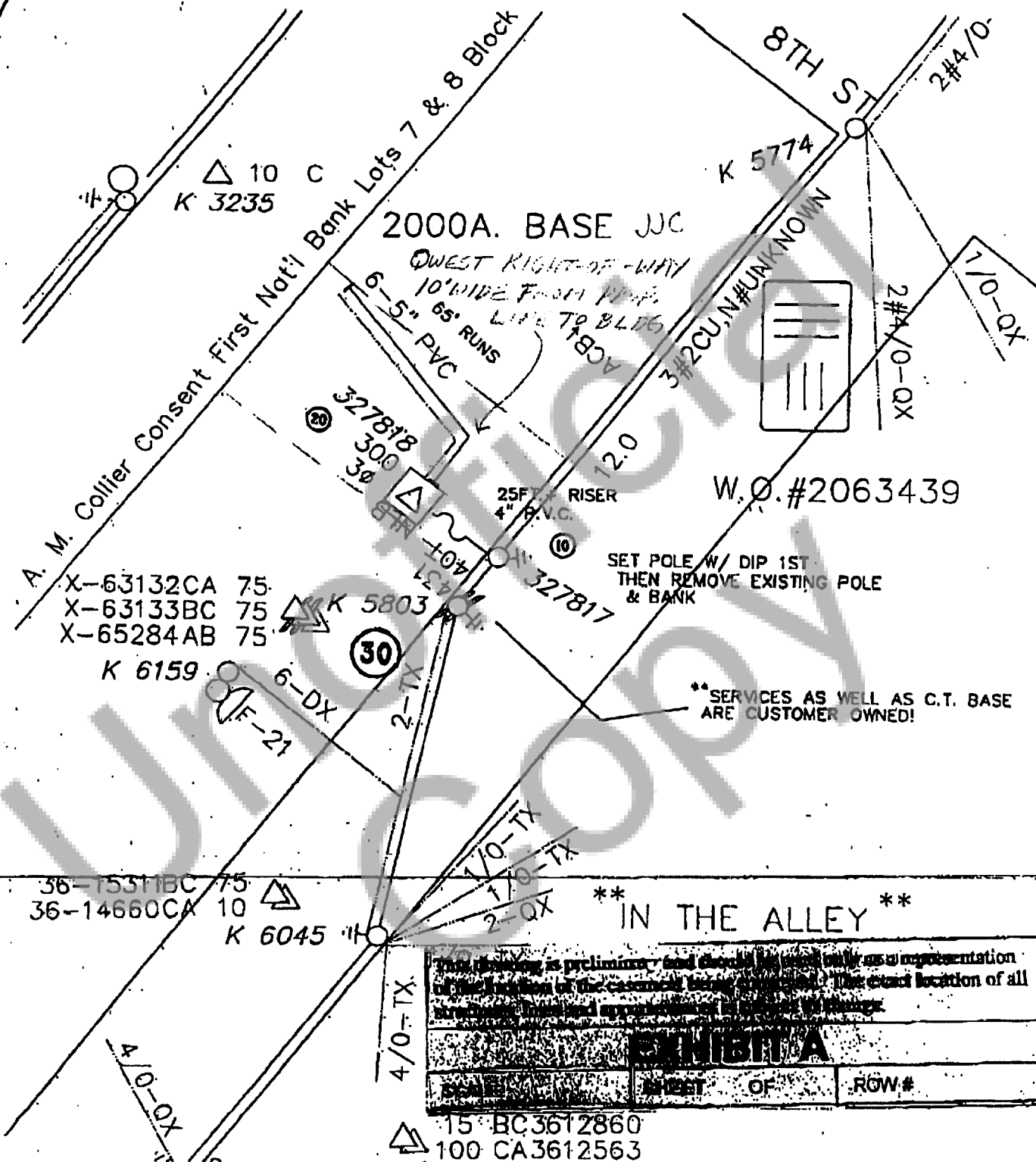

This drawing is preliminary and should be used only as a representation of the location of the proposed work. The exact location of all structures, lines and appurtenances is subject to change.

EXHIBIT A

DATE: 06/14/02 PROJECT: 002063439 ROW#: 01438009.0

15 BC3612860
100 CA3612563

Foreman		Emp. #	Job Start Date
CC#	WO# / REQ#	Map String	Job Comp Date
11176	002063439	01438009.0	



PACIFICORP

T-706 P.03/03 F-846

+50932426852