

02 SEP 3 AM 8:29

Harold Elliot
PO Box 413
La Pine, OR 97739

Vol M02 Page 49716
STATE OF OREGON, } ss.

Jeanine Keller
2552 Pat Ken Circle
La Pine, OR 97739

SPACE RESERVED
FOR
RECORDER'S USE

After recording, return to (Name, Address, Zip):

Harold Elliot
PO Box 413
La Pine OR 97739

State of Oregon, County of Klamath
Recorded 09/03/2002 8:29 a.m.
Vol M02, Pg 49716
Linda Smith, County Clerk
Fee \$ 21.00 # of Pgs 1
500 opa

Until requested otherwise, send all tax statements to (Name, Address, Zip):

Jeanine Keller
2552 Pat Ken Circle
La Pine OR 97739

BARGAIN AND SALE DEED

KNOW ALL BY THESE PRESENTS that

Harold Elliot

hereinafter called grantor, for the consideration hereinafter stated, does hereby grant, bargain, sell and convey unto

Jeanine Keller

hereinafter called grantee, and unto grantee's heirs, successors and assigns, all of that certain real property, with the tenements, hereditaments and appurtenances thereunto belonging or in any way appertaining, situated in Klamath County, State of Oregon, described as follows, to-wit:

Lot 7 Block 1
Little River Ranch
Plot 1204

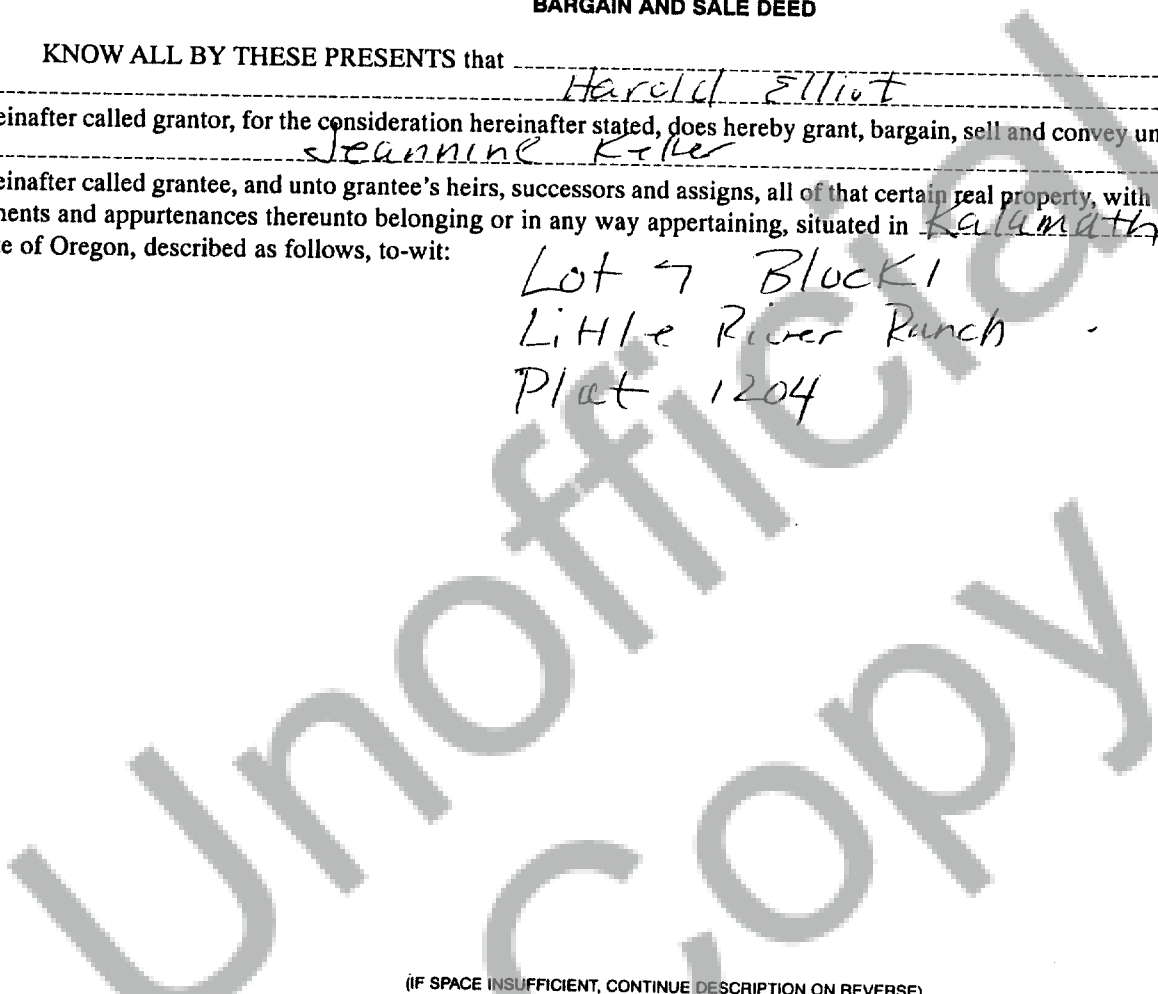

(IF SPACE INSUFFICIENT, CONTINUE DESCRIPTION ON REVERSE)

To Have and to Hold the same unto grantee and grantee's heirs, successors and assigns forever

The true and actual consideration paid for this transfer, stated in terms of dollars, is \$ Other. However, the actual consideration consists of or includes other property or value given or promised which is part of the the whole (indicate which) consideration. (The sentence between the symbols, if not applicable, should be deleted. See ORS 93.030.)

In construing this deed, where the context so requires, the singular includes the plural, and all grammatical changes shall be made so that this deed shall apply equally to corporations and to individuals.

IN WITNESS WHEREOF, the grantor has executed this instrument on August 6 2002; if grantor is a corporation, it has caused its name to be signed and its seal, if any, affixed by an officer or other person duly authorized to do so by order of its board of directors.

Harold Elliot
HAROLD ELLIOT

THIS INSTRUMENT WILL NOT ALLOW USE OF THE PROPERTY DESCRIBED IN THIS INSTRUMENT IN VIOLATION OF APPLICABLE LAND USE LAWS AND REGULATIONS. BEFORE SIGNING OR ACCEPTING THIS INSTRUMENT, THE PERSON ACQUIRING FEE TITLE TO THE PROPERTY SHOULD CHECK WITH THE APPROPRIATE CITY OR COUNTY PLANNING DEPARTMENT TO VERIFY APPROVED USES AND TO DETERMINE ANY LIMITS ON LAWSUITS AGAINST FARMING OR FOREST PRACTICES AS DEFINED IN ORS 30.930.

STATE OF OREGON, County of Deschutes, ss.

This instrument was acknowledged before me on 8/14/02 by Harold Elliot

This instrument was acknowledged before me on

by

as

of

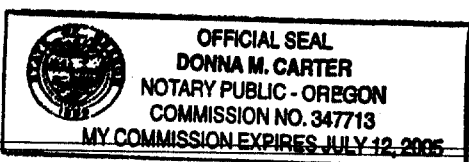

Donna M Carter
Notary Public for Oregon
My commission expires 7/12/05

21
500 opa