

Return to: Pacific Power
1950 Mallard Ln
Klamath Falls, OR 97601

CC: 11176 WO: 02084862

RIGHT OF WAY EASEMENT

Vol M02 Page 70802

'02 DEC 6 AM 10:47

For value received, Oregon State Parks & Recreation Department/OC&E Woods Line State Trail, ("Grantor"), hereby grants to PacificCorp, an Oregon corporation, its successors and assigns, ("Grantee"), an easement for a right of way 10 feet in width and 71 feet in length, more or less, for the construction, reconstruction, operation, maintenance, repair, replacement, enlargement, and removal of electric power transmission, distribution and communication lines and all necessary or desirable accessories and appurtenances thereto, including without limitation: supporting towers, poles, props, guys and anchor, including guys and anchors outside of the right of way; wires, fibers, cables and other conductors and conduits therefor; and pads, transformers, switches, vaults and cabinets, along the general course now located by Grantee on, over or under the surface of the real property of Grantor in Klamath County, State of Oregon, as more particularly described and/or shown on Exhibit(s) "A" attached hereto and by this reference made a part hereof:

Situated in a portion of the SE 1/2, NE 1/4 of Section 4 Township 39S, Range 9E, of the Willamette Meridian, and more specifically described in Volume 39 09 Page 04AD in the Official Records of Klamath County.

Assessor's Map No. 39 09 04AD Tax Lot No. 500

Together with the right of access to the right of way from adjacent lands of Grantor for all activities in connection with the purposes for which this easement has been granted; and together with the present and (without payment therefor) the future right to keep the right of way and adjacent lands clear of all brush, trees, timber, structures, buildings and other hazards which might endanger Grantee's facilities or impede Grantee's activities.

At no time shall Grantor place, use or permit any equipment or material of any kind that exceeds twelve (12) feet in height, light any fires, place or store any flammable materials (other than agricultural crops), on or within the boundaries of the right of way. Subject to the foregoing limitations, the surface of the right of way may be used for agricultural crops and other purposes not inconsistent, as determined by Grantee, with the purposes for which this easement has been granted.

The rights and obligations of the parties hereto shall be binding upon and shall benefit their respective heirs, successors and assigns.

DATED this 14th day of October, 2002.

BY: Michael Carrier
(President) DIRECTOR

Attest: _____
(Secretary)

REPRESENTATIVE ACKNOWLEDGMENT

STATE OF Marietta Oregon)
County of Marietta) ss.

This instrument was acknowledged before me on this 14th day of October, 2002, by Michael Carrier, as Director of Oregon State Parks and Recreation Department,
David W. Wright
Notary Public
My commission expires: 3-29-05

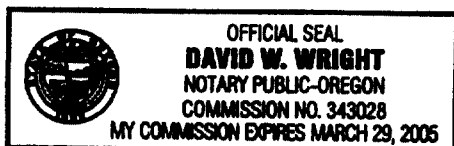

State of Oregon, County of Klamath
Recorded 12/06/2002 10:47 a. m.
Vol M02, Pg 70802-03
Linda Smith, County Clerk
Fee \$ 26.00 # of Pgs 2

96
CK

This drawing is preliminary and should be used only as a guide to the location of the easement being conveyed. The exact location of all structures, lines and appurtenances is subject to change.

70803

EXHIBIT A

SCALE:

SHEET

OF

ROW #

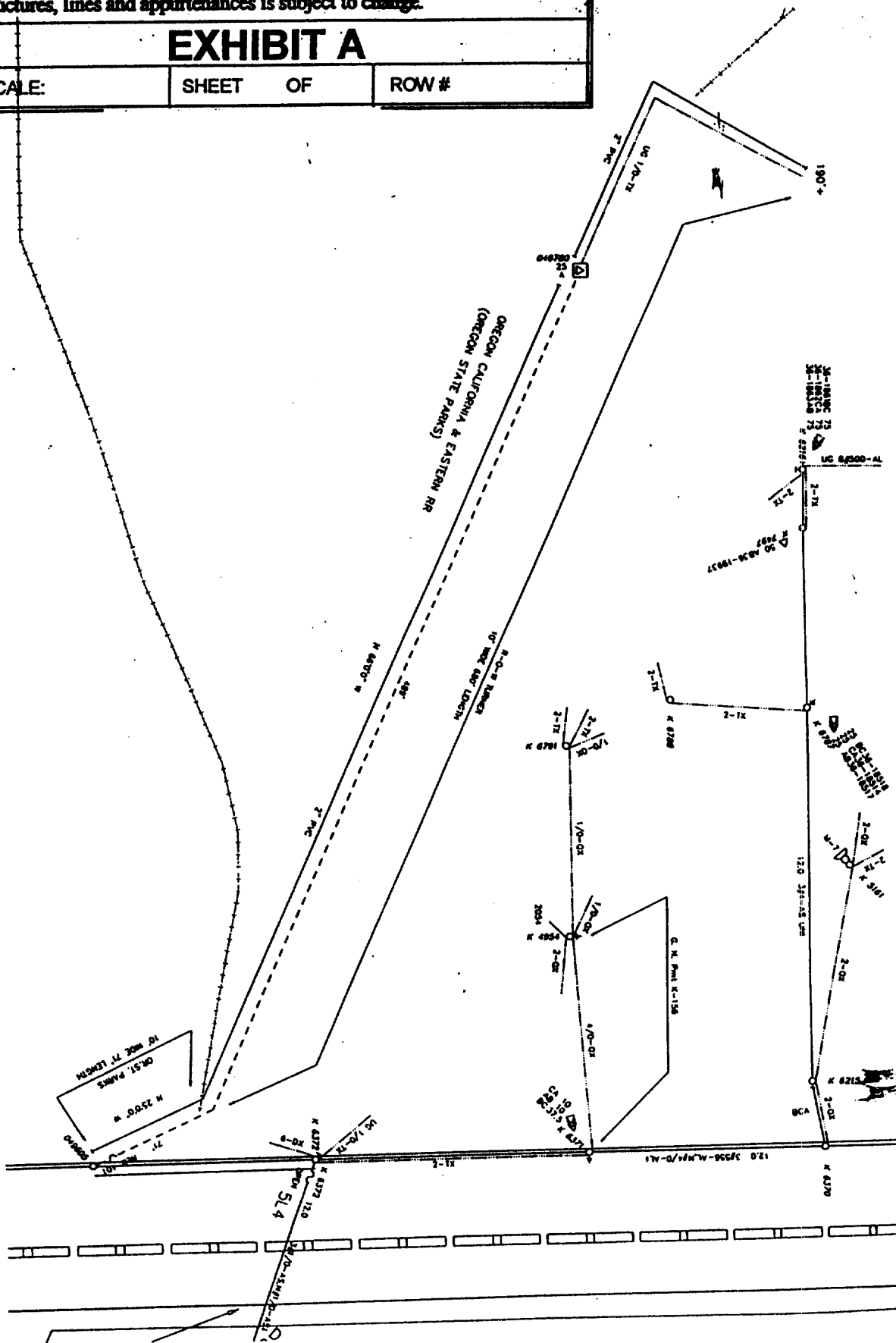

Foreman		Emp #	Job Start Date		 1 of 1
CC#	WO# / REQ#	Map String	Job Complete Date		
11176	002084862	01439009.0			
CUSTOMER: R-O-W TURNER/ OR.STATE PARKS ADDRESS: 2054 WASHBURN WAY			Circuit SL 4	Post Jobs <input type="checkbox"/> ROR <input type="checkbox"/> Posted <input type="checkbox"/>	EST #/ 24872 Print Date 06/22/02 Scale 1"=50'