

09 SEP 17 AM 11:15

Vol M03 Page 69209

After Recording Return To:
DSK, LLC
5534 South 6th Street PMB 125
Klamath Falls, OR 97603

State of Oregon, County of Klamath
Recorded 09/17/03 11:15 A m
Vol M03 Pg 69209-14
Linda Smith, County Clerk
Fee \$ 46.00 # of Pgs 6

WARRANTY DEED

STATE OF OREGON
COUNTY OF KLAMATH

THIS WARRANTY DEED is made this 30 day of August, 2003, by and between M & M Enterprises, (hereinafter referred to as "Grantor"), and DSK, LLC, (hereinafter referred to as "Grantee"):

WITNESSETH: The Grantor, for and in consideration of the sum of Ten and no/100 Dollars (\$ 10.00) and other valuable consideration, receipt of which is hereby acknowledged, hereby grants, bargains, sells, remises, releases, transfers and conveys to the Grantee, all that certain land situate in Klamath County, State of Oregon to wit:

See Attached Exhibit "A"

TOGETHER with all the tenements, hereditaments and appurtenances thereto belonging or in anywise appertaining, to have and to hold in fee simple forever.

The Grantor hereby covenants with said Grantee that the Grantor is lawfully seized of said land in fee simple, has good right and lawful authority to sell and convey said land, hereby fully warrants the title to said land and will defend the same against the lawful claims of all persons whomsoever, and that said land is free and clear of all encumbrances, except taxes accruing subsequent to December 31, 2003, conditions, restrictions, easements, limitations and zoning ordinances of record, if any, and the following described mortgage(s), which Grantee herein takes title to Property subject to:

IN WITNESS WHEREOF, the said Grantor has signed and sealed these presents the day and year first above written.

Signed, sealed and delivered in the presence of:

Witness (Seal)

Bryan D Marsh (Seal)
Grantor:
Kevin D Marsh (Seal)
Grantor:
Larry E Marsh (Seal)
Grantor:

STATE OF ARIZONA
COUNTY OF MARICOPA

On This 11 Day of SEPT, 2003, before me personally appeared BRYAN MARSH

whose identity was proved to me on the basis of satisfactory evidence to be the person whose name is subscribed to this document, and who acknowledged that he/she signed the above/attached document.

Sworn and subscribed before me this 11 day of SEPT, 2003.



NOTARY PUBLIC

commission expires: 2-10-07

STATE OF **NEVADA**)
 :SS.
COUNTY OF **CLARK**)

This Instrument was acknowledged before me on
September 15, 2003 by
Kevin S. Marsh

Notary Public
(My commission expires: April 13, 2007)

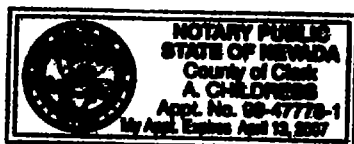

69211

STATE OF Oregon)
COUNTY OF Clatsop)ss.

This instrument was acknowledged before me on
September 17, 2003 by
Gary E. Marsh

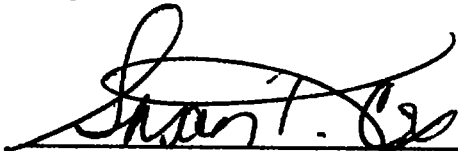

NOTARY PUBLIC

My commission expires 2/19/04

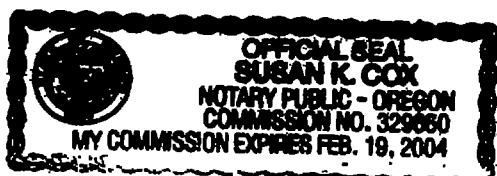

PARCEL 5:

69212

Lot 718 in Block 129 of MILLS ADDITION to the City of Klamath Falls, according to the official plat thereof on file in the office of the County Clerk of Klamath County, Oregon.

	2400	2300	2200	2100	2000	1900	1800	1700	1600
								69213	
35	634	633	632	631	630	629	628	627	626
								50'	51.8'

AVE.

130	712	711	710	709	708	707	706	705	704
	5600	5500	5400	5300	5200	5100	5000	4900	4800
								50'	51.8'

129

	7000	6900	6800	6700	6600	6500	6400	6300	6200
	SEE CS 2475								
17	726	725	724	723	722	721	720	719	718
								50'	50.7'

ADD.

AVE.

100	8400	8300	8200	8100	8000	7900	7800	7700	7600
	9	8	7	6	5	4	3	2	1
								50'	52.5'

301

0	9700	9800	9900	10000	10100	10200	10300
---	------	------	------	-------	-------	-------	-------

Amerititle
THIS SKETCH IS MADE SOLELY FOR THE PURPOSE OF ASSISTING IN LOCATING CERTAIN PREMISES AND NO LIABILITY IS ASSUMED FOR VARIATIONS IF ANY, IN DIMENSIONS AND LOCATIONS ASCERTAINED BY ACTUAL SURVEY.

SEBURN

THIS MAP WAS PREPARED FOR
ASSESSMENT PURPOSE ONLY.

NE1/4 SE1/4 SEC. 33 T.38S. R.09E. W.M.
KLAMATH COUNTY

1"=100'

69214

38 09 33
KLAMATH FALLS

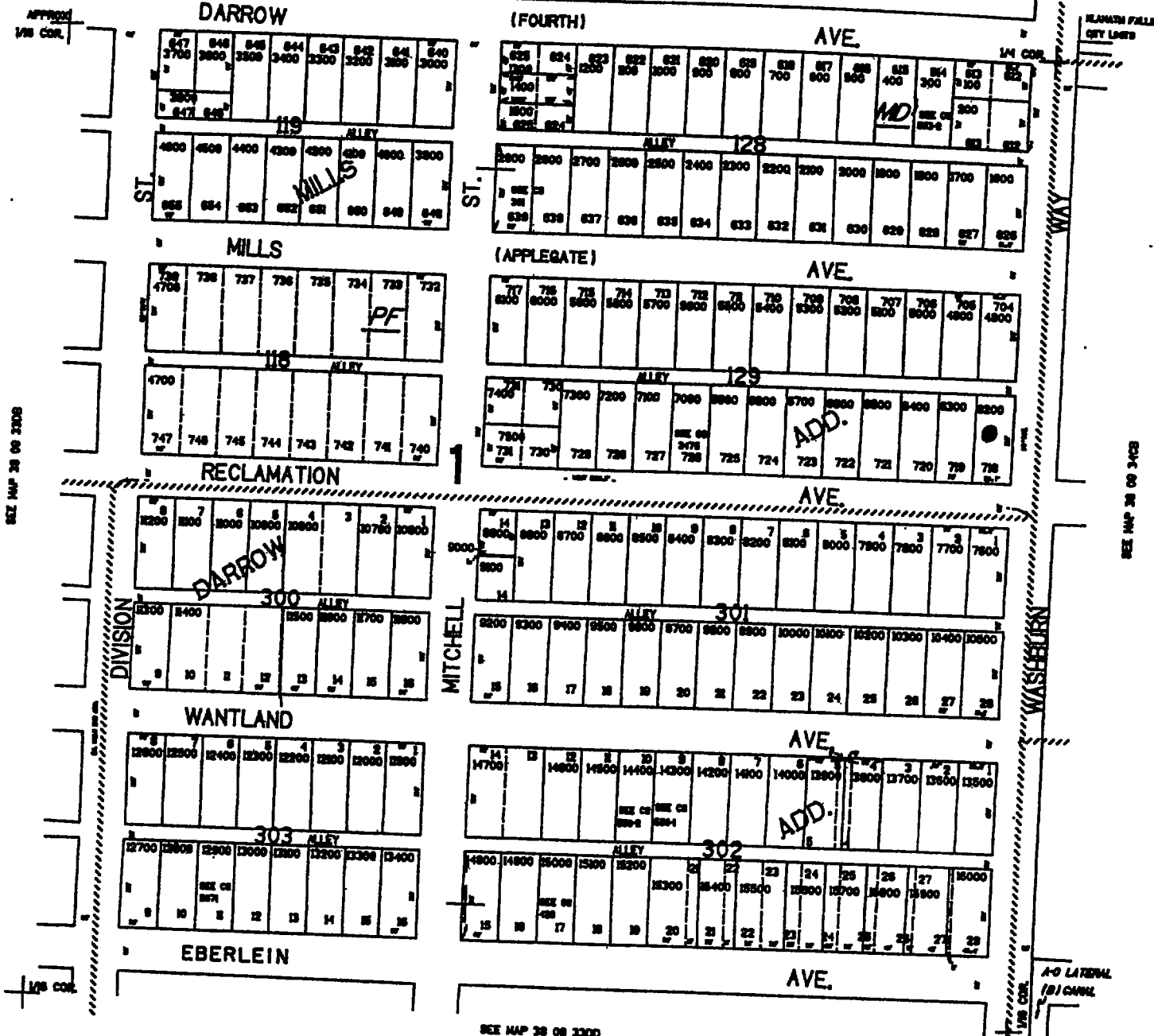

AmeriTitle
THIS SKETCH IS MADE SOLELY FOR THE
PURPOSE OF ASSISTING IN LOCATING
CERTAIN PREMISES AND NO LIABILITY IS
ASSUMED FOR VARIATIONS IF ANY, IN
DIMENSIONS AND LOCATIONS ASCERTAINED
BY ACTUAL SURVEY.