

**AFFIDAVIT OF CORRECTION**

I, Keith R. Rhine, P.L.S. No. 58985, being duly sworn, depose and say that I am the surveyor who surveyed the property as depicted in Partition Plat 10-03, recorded in Plat Volume 5 Page 10-03 in Klamath County Plat Records.

The following correction to said plat is necessary and is as follows:

1. The distance along the Westerly line of Parcel 1, between the Southwest corner of said Parcel 1 and the Initial Point of Partition Plat 10-03, was omitted and should be 791.86'.

The present fee owner of the property materially affected by this affidavit is as follow:  
Regional Disposal Company.

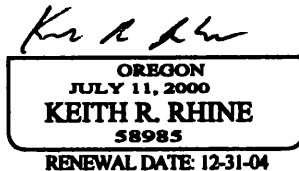
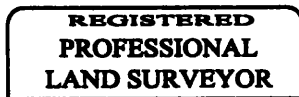

**NOTARY STATEMENT:**

STATE OF OREGON  
COUNTY OF KLAMATH

Subscribed and sworn to before me on this 29th day of JANUARY, 2004.

Notary Public for the State of Oregon

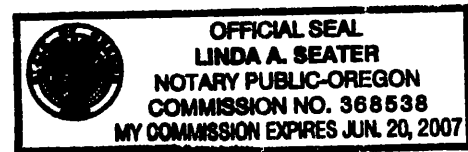

**APPROVAL:**

I, Mike Markus, Klamath County Surveyor, do hereby certify that said Affidavit of Corrections for Partition Plat 10-03 has been examined by me and that it complies with the requirements of ORS 93.

Mike Markus  
Klamath County Surveyor

1/29/04  
Date

State of Oregon, County of Klamath  
Recorded 01/30/2004 11:01 a m  
Vol M04 Pg 5878  
Linda Smith, County Clerk  
Fee \$ 21.00 # of Pgs 1

21V oc: Mike Marcus