

'04 JUN 1 PM 3:50

Vol M04 Page 35141

State of Oregon, County of Klamath
Recorded 06/01/2004 3:50 p m
Vol M04 Pg 35141-43
Linda Smith, County Clerk
Fee \$ 4/00 # of Pgs 5

GENERAL WARRANTY DEED - STATUTORY FORM

Floyd L. Wynne and Barbara J. Wynne (Grantors), conveys and warrants to Wynne Enterprises, LLC (Grantee), the real property described on Exhibit A attached hereto and by this reference incorporated herein, free of encumbrances except as specifically set forth on Exhibit B attached hereto and by this reference incorporated herein.

The true consideration for this conveyance is \$1 (one) dollar and other considerations.

THIS INSTRUMENT WILL NOT ALLOW USE OF THE PROPERTY DESCRIBED IN THIS INSTRUMENT IN VIOLATION OF APPLICABLE LAND USE LAWS AND REGULATIONS. BEFORE SIGNING OR ACCEPTING THIS INSTRUMENT, THE PERSON ACQUIRING FEE TITLE TO THE PROPERTY SHOULD CHECK WITH THE APPROPRIATE CITY OR COUNTY PLANNING DEPARTMENT TO VERIFY APPROVED USES AND TO DETERMINE ANY LIMITS ON LAWSUITS AGAINST FARMING OR FOREST PRACTICES AS DEFINED IN ORS 30.930.

Dated this 1st day of June, 2004.

By: Floyd L. Wynne
Its: Barbara J. Wynne

Returned @ Counter

Floyd L. Wynne
1504 Eldorado Ave.
41 ca Klamath Falls, OR 97601

35142

Exhibit A
Legal description of property

The following described real property in Klamath County, Oregon:

PARCEL 1

Lots 1, 2 and 3 in Block 19 FAIRVIEW ADDITION #2 TO THE CITY OF KLAMATH FALLS,

TOGETHER WITH the $\frac{3}{4}$ of vacated alley adjoining the North boundary of Lot 1. ALSO TOGETHER WITH the following described property:

Beginning at a point on the center line of vacated portion of Donald Street, said point being 60 feet, 6 inches West of West line of Oregon Avenue; thence continuing West along said center line 49 feet, 6 inches to the East line of a alley; thence North along the East line of said alley 6 feet, 6 inches; thence East parallel to said center line 49 feet, 6 inches; thence South 6 feet, 6 inches to the point of beginning. Same being a portion of the North $\frac{1}{4}$ of vacated Donald Street in the City of Klamath Falls, Oregon, which adjoins Lot 6 Block 12, Fairview Addition No. 2 to the City of Klamath Falls, Oregon.

PARCEL 2

Lots 4 and 5 in Block 19 FAIRVIEW ADDITION #2 TO THE CITY OF KLAMATH FALLS.

PARCEL 3

Lot 6 in Block 19, FAIRVIEW ADDITION #2 TO THE CITY OF KLAMATH FALLS.

Exhibit B

35143

Encumbrances

**Subject to an easement to United States of America for
tunnel below the surface of the ground as shown in deed to
Martin Harold Clark and Marcia L. Clark, recorded
October 12, 1956 in Book 287 at page 259, Deed Records.
(Affects lots 2,3,4 and 5 Blk 19)**

35144

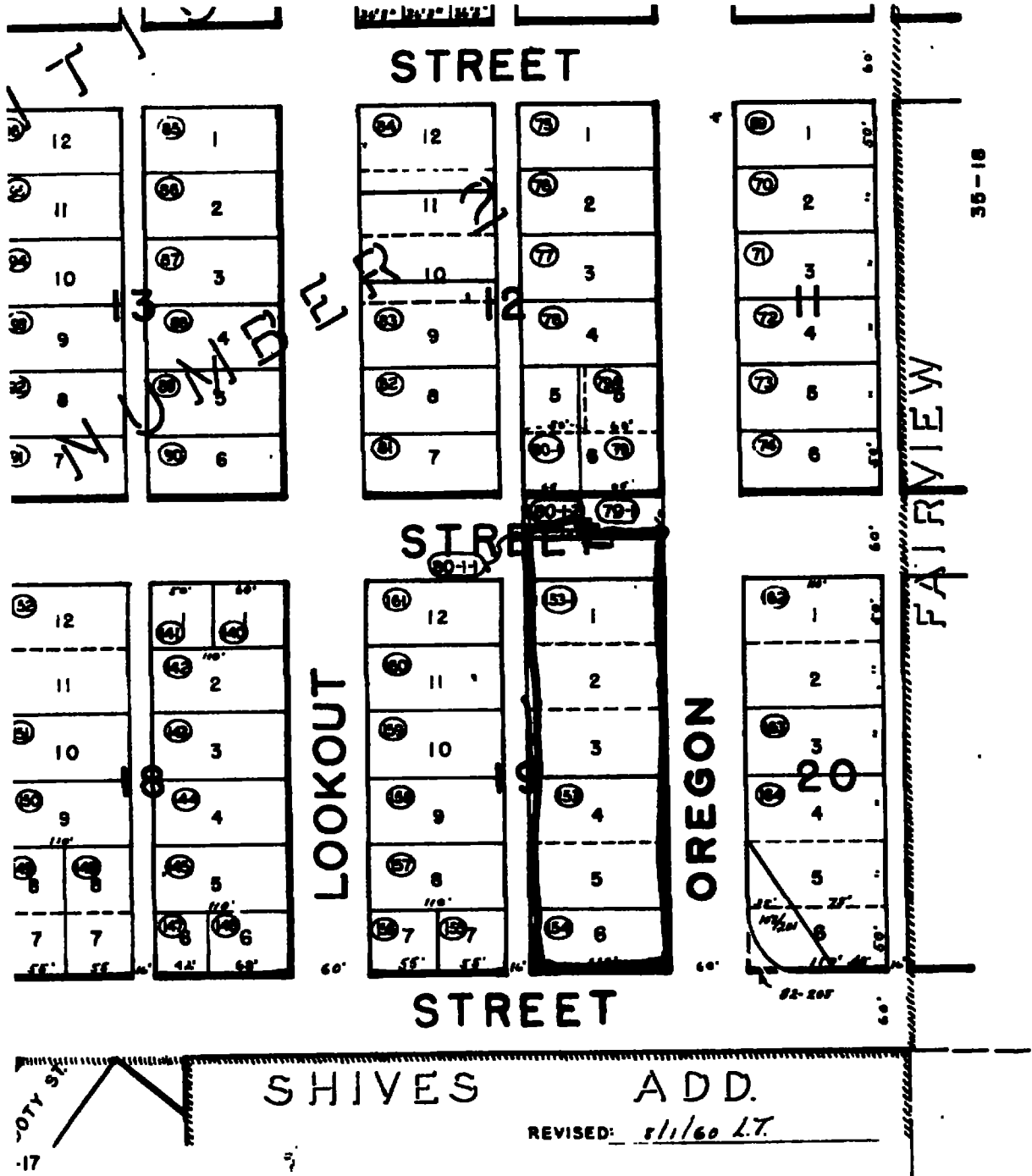

38-12018

Do not show the location of any improvements and since it is furnished as an

State of Oregon)
) ss.
County of Klamath)

35145

This instrument was acknowledged before me on this 1st day of June,
2004, by _____ as _____ of _____, a(n) _____
_____.

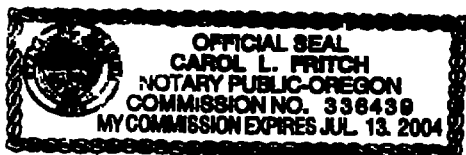

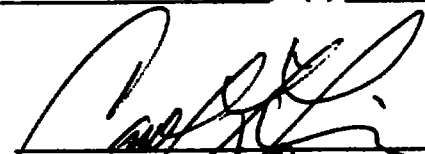

Notary Public for Oregon
My Commission Expires: July 13, 2004