

'04 OCT 7 AM 10:00

Vol M04 Page 67956

RECORDING REQUESTED BY:

GRANTOR: David W. Clowes  
GRANTOR:

GRANTEE: PACIFICORP

RETURN TO:

*RX*  
PACIFIC POWER  
1950 MALLARD LANE  
KLAMATH FALLS, OR 97601

State of Oregon, County of Klamath  
Recorded 10/07/04 10:00 a m  
Vol M04 Pg 67956-61  
Linda Smith, County Clerk  
Fee \$ 46.00 # of Pgs 6

---

## RIGHT OF WAY EASEMENT

---

*4/6*

Return to: Pacific Power  
1950 Mallard Lane  
Klamath Falls, Oregon 97601

CC#: 11176 WO#: 02406396

UNDERGROUND RIGHT OF WAY EASEMENT

For value received, David W. Clowes ("Grantor"), hereby grants to PacifiCorp, an Oregon corporation, its successors and assigns, ("Grantee"), a non-exclusive easement for a right of way 10 feet in width and 120 feet in length, more or less, for the construction, reconstruction, operation, maintenance, repair, replacement, enlargement, and removal of an underground electric distribution and communication lines and all necessary or desirable accessories and appurtenances thereto, including without limitation: fibers, cables and other conductors and conduits therefor; and pads, transformers, switches, vaults on, across, or under the surface of the real property of Grantor in Klamath County, State of Oregon, more particularly described as follows and as more particularly described and/or shown on Exhibit(s) A attached hereto and by this reference made a part hereof:

Said property generally located in the NE 1/4 of Section 04, Township 38S, Range 11E of the Willamette Meridian, and more specifically described in Volume M02 Page 75317 in the official records of Klamath County

Assessor's Map No.

Tax Parcel No. 300

Together with the right of access to the right of way from adjacent lands of Grantor for all activities in connection with the purposes for which this easement has been granted; and together with the present and (without payment therefor) the future right to keep the right of way clear of all brush, trees, timber, structures, buildings and other hazards which might endanger Grantee's facilities or impede Grantee's activities.

At no time shall Grantor place, light any fires, place or store any flammable materials (other than agricultural crops), on or within the boundaries of the right of way. Subject to the foregoing limitations, the surface of the right of way may be used for agricultural crops and other purposes not inconsistent, as determined by Grantee, with the purposes for which this easement has been granted.

The rights and obligations of the parties hereto shall be binding upon and shall benefit their respective heirs, successors and assigns.

DATED this 19 day of June, 2 004

  
(Grantor)

\_\_\_\_\_  
(Grantor)

INDIVIDUAL ACKNOWLEDGMENTSTATE OF Oregon )  
County of Klamath )

ss.

This instrument was acknowledged before me on this 14 day of  
June, 2004, by David W. Clowes.Rita F. Collins

Notary Public

My commission expires: 12-12-06



MR 58671-LW

THIS SPACE RESERVED FOR RECORDER'S USE

After recording return to:

DAVID W. CLOWES

P.O. BOX 1247

FERNDALE, CA 95336

Until a change is requested all  
tax statements shall be sent to  
the following address:

DAVID W. CLOWES

P.O. BOX 1247

FERNDALE, CA 95336

Escrow No. MT58671-LW

Title No.

Vol M02 Page 75317

State of Oregon, County of Klamath

Recorded 12/24/2002 11:39 A.M.

Vol M02, Pg 75317-18

Linda Smith, County Clerk

Fee \$ 26.00 # of Pgs 2

'02 DEC 24 AM 11:39

## WARRANTY DEED

LEE BARRETT AND MICHELE MAY-BARRETT, AS TENANTS BY THE ENTIRETY, AS TO AN  
UNDIVIDED 1/2 INTEREST AND ROBIN BARRETT AND MARVEL BARRETT, AS TENANTS BY  
THE ENTIRETY, AS TO AN UNDIVIDED 1/2 INTEREST, AS TO PARCEL 1 LEE BARRETT AND  
MICHELE MAY-BARRETT, AS TENANTS BY THE ENTIRETY, AS TO PARCEL 2 LEE BARRETT  
AND MICHELE BARRETT, AS TENANTS IN COMMON, AS TO PARCEL 3,  
Grantor(s) hereby grant, bargain, sell, warrant and convey to:  
DAVID W. CLOWES  
Grantee(s) and grantee's heirs, successors and assigns the following described  
real property, free of encumbrances except as specifically set forth herein in  
the County of KLAMATH and State of Oregon, to wit:

EXHIBIT A"  
LEGAL DESCRIPTION

## PARCEL 1:

Lot 16, Block 64, KLAMATH FALLS FOREST ESTATES, HIGHWAY 66 UNIT, PLAT NO. 3,  
according to the official plat thereof on file in the office of the County  
Clerk of Klamath County, Oregon.

## PARCEL 2

Lot 17 Block 64, KLAMATH FALLS FOREST ESTATES, HIGHWAY 66 UNIT, PLAT NO. 3,  
according to the official plat thereof on file in the office of the County  
Clerk of Klamath County, Oregon.

## PARCEL 3

Lot 3, Block 26, KLAMATH FALLS FOREST ESTATES, HIGHWAY 66 UNIT, PLAT NO. 2  
according to the official plat thereof on file in the office of the County  
Clerk of Klamath County, Oregon.

3811-003B0-03400-000	459202
3811-003B0-03500-000	459211
3811-004A0-00300-000	460012
M-162503	64030

SUBJECT TO: all those items of record and those apparent upon the land, if  
any, as of the date of this deed and those shown below, if any:  
and the grantor will warrant and forever defend the said premises and every  
part and parcel thereof against the lawful claims and demands of all persons  
whomsoever, except those claiming under the above described encumbrances.

The true and actual consideration for this conveyance is \$ 86,000.00.

THIS INSTRUMENT WILL NOT ALLOW USE OF THE PROPERTY DESCRIBED IN THIS INSTRUMENT  
IN VIOLATION OF APPLICABLE LAND USE LAWS AND REGULATIONS. BEFORE SIGNING OR  
ACCEPTING THIS INSTRUMENT, THE PERSON ACQUIRING FEE TITLE TO THE PROPERTY  
SHOULD CHECK WITH THE APPROPRIATE CITY OR COUNTY PLANNING DEPARTMENT TO VERIFY  
APPROVED USES AND TO DETERMINE ANY LIMITS ON LAWSUITS AGAINST FARMING OR FOREST  
PRACTICES AS DEFINED IN ORS 30.930.

Dated this 6 day of December 2002

Robin Barrett  
ROBIN BARRETT

Marvel Barrett  
MARVEL BARRETT

Lee Barrett  
LEE BARRETT

BY: Robin Barrett

ROBIN BARRETT, HIS ATTORNEY IN FACT

Michele May-Barrett  
MICHELE MAY-BARRETT

BY: Robin Barrett

ROBIN BARRETT, HER ATTORNEY IN FACT

2610

67960

75318

State of Oregon  
County of

This instrument was acknowledged before me on December 06, 2002 by  
MARVEL BARRETT AND ROBIN BARRETT FOR HIMSELF AND AS ATTORNEY IN FACT FOR LEE  
BARRETT AND NICHELE MAY-BARRETT.

Angela Davis  
(Notary Public for Oregon)  
My commission expires Jan 9, 2006



67961

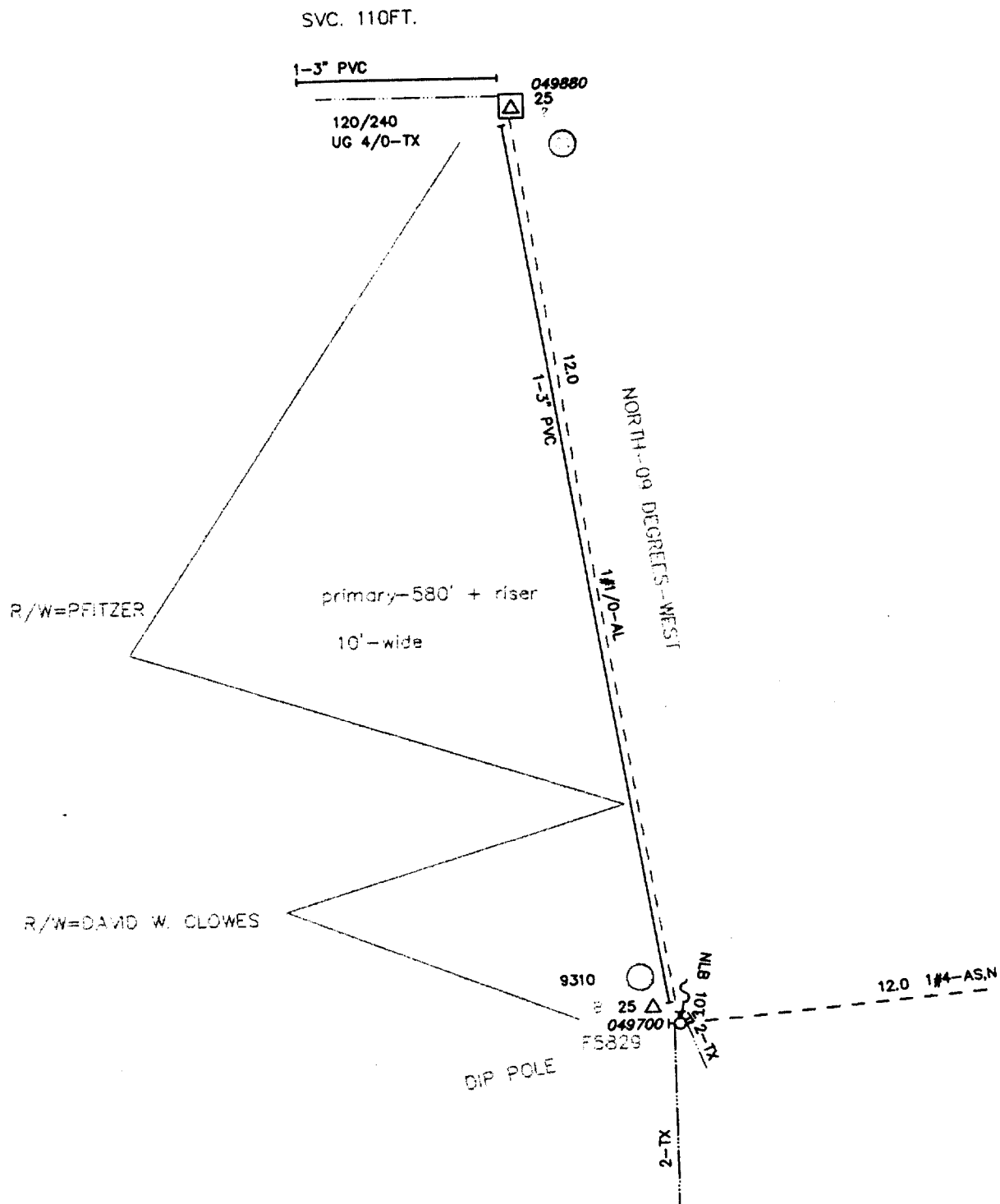

Foreman		Emp #	Job Start Date		 <b>PACIFICORP</b> 1 OF 1
CC#	WO# / REQ#	Map String	Job Comp Date		
11176	002406396	01438011.0			
CUSTOMER : PFITZER-EXHIBIT ADDRESS : PARAKEET DR.-BLY MT.			Circuit 4L16	Post Jobs <input type="checkbox"/> RQII <input type="checkbox"/> Posted <input type="checkbox"/>	EST ID# 12950 Print Date 06/11/04 Scale 1=100'