

04DEC10 PM12:19

Vol M04 Page 84833

**After recording, return to:**

*over the counter:*  
American Forest Resources, LLC  
6400 Highway 66  
Klamath Falls, OR 97601  
Attention: Cathy Gray

State of Oregon, County of Klamath  
Recorded 12/10/04 12:19 p m  
Vol M04 Pg 84833 48  
Linda Smith, County Clerk  
Fee \$ 96<sup>00</sup> # of Pgs 16

**Until a change is requested, all  
severance and harvest tax state-  
ments shall be sent to Grantee  
at the following address:**

BC Timber Properties, Inc.  
Attn: Richard Friedman, President  
78 Canterbury Court  
Goshen, CT. 06756

**TIMBER DEED  
(Oct 04 Camp 6 AFR Deed)**

AMERICAN FOREST RESOURCES, LLC, a Delaware limited liability company ("Grantor"), for and in consideration of Ten Dollars (\$10) and other good and valuable consideration in hand paid, receipt of which is hereby acknowledged, conveys to BC TIMBER PROPERITES, INC, a Delaware corporation ("Grantee"), all of the "Conveyed Timber" (as defined below) located on the land situated in Klamath County, Oregon, described on Exhibit A (the "Land") and more specifically, within the areas depicted on the maps marked Exhibit B. Exhibits A and B are attached hereto and incorporated herein.

The true and actual cash consideration for this conveyance is: \$400,000.00.

As used herein, the term "Conveyed Timber" shall mean all timber now standing, growing, lying or being on the Land within the areas depicted on Exhibit B which, as of the date of this Deed, or through growth, during the term hereof, meets the specifications for "Covered Products" set forth in the Lump Sum Timber Sale Agreement dated October 28, 2004 between Grantor and Grantee.

Grantee shall have until October 28, 2007 (the "Termination Date") to cut and remove the Conveyed Timber. On the Termination Date, all right, title and interest in and to any remaining Conveyed Timber shall revert automatically to the Grantor herein, it successors and assigns, without the requirement of notice, deed or any other action by any party hereto. Provided however, in the event Grantee's harvest or

removal of the Covered Products is delayed or prevented due to causes beyond Grantee's reasonable control, the Termination Date may be extended on the terms and conditions set forth in Section 1.6 of the Agreement.

To the extent necessary, Grantee may use the road system on the Land and construct and improve the same for the purposes referenced above, provided that Grantee shall maintain the roads in serviceable, usable condition. Grantee shall abide by all laws applicable to its activities on the Land, except, however, Grantor shall satisfy any reforestation obligations and pay all timber taxes that arise by virtue of the cutting and removal of Conveyed Timber from the Land.

THIS INSTRUMENT WILL NOT ALLOW USE OF THE PROPERTY DESCRIBED IN THIS INSTRUMENT IN VIOLATION OF APPLICABLE LAND USE LAWS AND REGULATIONS. BEFORE SIGNING OR ACCEPTING THIS INSTRUMENT, THE PERSON ACQUIRING FEE TITLE TO THE PROPERTY SHOULD CHECK WITH THE APPROPRIATE CITY OR COUNTY PLANNING DEPARTMENT TO VERIFY APPROVED USES AND TO DETERMINE ANY LIMITS ON LAWSUITS AGAINST FARMING OR FOREST PRACTICES AS DEFINED IN ORS 30.930.

Dated this 28<sup>th</sup> day of October, 2004.

GRANTOR:

AMERICAN FOREST RESOURCES, LLC

By TIMBER RESOURCE SERVICES, LLC,  
its Sole Manager

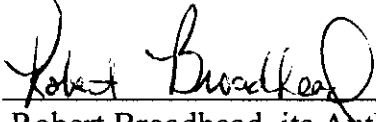
By   
Robert Broadhead, its Authorized  
Representative

STATE OF OREGON       )  
                                  ) ss.  
COUNTY OF KLAMATH)

This instrument was acknowledged before me on October 28, 2004, by Robert Broadhead as Authorized Representative of American Forest Resources, LLC.



*Catherine Gray*  
\_\_\_\_\_  
NOTARY PUBLIC FOR OREGON  
My Commission Expires: 5/6/08

(Seal)

84836

## Oct 04 Camp 6 AFR Deed

## Exhibit A

**Setting: 33600**                      **Acres: 109**                      **Estimated Mbft: 261**

Portions of:	SW1/4NW1/4	Section 19	T35S, R14E
	NE1/4SW1/4	"	"
	NW1/4SW1/4	"	"
	SE1/4SW1/4	"	"

**Setting: 34303**                      **Acres: 321**                      **Estimated Mbft: 465**

Portions of:	NE1/4SE1/4	Section 23	T34S, R14E
	SE1/4SE1/4	"	"
	SE1/4NE1/4	Section 24	T34S, R14E
	SE1/4NW1/4	"	"
	NE1/4SW1/4	"	"
	NW1/4SW1/4	"	"
	SW1/4SW1/4	"	"
	SE1/4SW1/4	"	"
	NE1/4SE1/4	"	"
	NW1/4SE1/4	"	"
	SW1/4SE1/4	"	"
	NE1/4NW1/4	Section 25	T34S, R14E
	NW1/4NW1/4	"	"
	SW1/4NW1/4	"	"
	NE1/4NE1/4	Section 26	T34S, R14E
	NW1/4NE1/4	"	"
	SW1/4NE1/4	"	"
	SE1/4NE1/4	"	"

**Setting: 34380**                      **Acres: 70**                      **Estimated Mbft: 314**

Portions of:	SW1/4SE1/4	Section 3	T34S, R14E
	SE1/4SE1/4	"	"
	NE1/4NE1/4	Section 10	T34S, R14E
	NW1/4NE1/4	"	"
	SW1/4NE1/4	"	"
	SE1/4NE1/4	"	"

**Setting: 34380 (cont'd)**

**84837**

NW1/4NW1/4  
SW1/4NW1/4

Section 11  
“

T34S, R14E  
“

**Setting: 34438**

**Acres: 55**

**Estimated Mbft: 409**

Portions of:

SW1/4SW1/4

Section 26

T33S, R14E

SE1/4SE1/4

Section 27

T33S, R14E

NE1/4NE1/4

Section 34

T33S, R14E

NW1/4NE1/4

“

“

NE1/4NW1/4

“

“

NW1/4NW1/4

“

“

**Setting: 34604**

**Acres: 287**

**Estimated Mbft: 646**

Portions of:

NW1/4NE1/4

Section 3

T34S, R14E

NE1/4NW1/4

“

“

NW1/4NW1/4

“

“

SW1/4NW1/4

“

“

SE1/4NW1/4

“

“

NE1/4SW1/4

“

“

NW1/4SW1/4

“

“

NE1/4NE1/4

Section 4

T34S, R14E

NW1/4NE1/4

“

“

SW1/4NE1/4

“

“

SE1/4NE1/4

“

“

NW1/4SE1/4

“

“

NE1/4SE1/4

“

“

**Setting: 34617**

**Acres: 151**

**Estimated Mbft: 152**

Portions of:

NE1/4SW1/4

Section 3

T34S, R14E

NW1/4SW1/4

“

“

SW1/4SW1/4

“

“

SE1/4SW1/4

“

“

NE1/4SE1/4

Section 4

T34S, R14E

NW1/4SE1/4

“

“

SW1/4SE1/4

“

“

SE1/4SE1/4

“

“

Setting: 34617 (cont'd)NE1/4NE1/4  
NW1/4NE1/4Section 9  
"T34S, R14E  
"Setting: 35463Acres: 281Estimated Mbft: 842

Portion of:

NW1/4NW1/4  
SW1/4NW1/4  
NW1/4SW1/4  
SW1/4SW1/4  
SE1/4SW1/4  
SW1/4SE1/4

Section 28

"

"

"

"

"

"

T34S, R14E

"

"

"

"

"

"

SE1/4NE1/4  
NE1/4SE1/4  
NW1/4SE1/4  
SW1/4SE1/4  
SE1/4SE1/4

Section 29

"

"

"

"

"

T34S, R14E

"

"

"

"

"

NE1/4NE1/4  
NW1/4NE1/4  
SW1/4NE1/4  
SE1/4NE1/4

Section 32

"

"

"

"

T34S, R14E

"

"

"

"

NW1/4NE1/4  
SW1/4NE1/4  
NE1/4NW1/4  
SE1/4NW1/4  
NE1/4SW1/4  
NW1/4SE1/4

Section 33

"

"

"

"

"

"

T34S, R14E

"

"

"

"

"

"

Setting: 34579Acres: 479Estimated Mbft: 909

Portions of:

SW1/4SE1/4

Section 4

T34S, R14E

NE1/4NE1/4  
NW1/4NE1/4  
SW1/4NE1/4  
SE1/4NE1/4  
NE1/4SE1/4  
NW1/4SE1/4  
SW1/4SE1/4  
SE1/4SE1/4

Section 9

"

"

"

"

"

"

"

"

T34S, R14E

"

"

"

"

"

"

"

"

NW1/4NE1/4

Section 10

T34S, R14E

84839

SW1/4NE1/4	“	“
SE1/4NW1/4	“	“
SW1/4NW1/4	“	“
SE1/4NW1/4	“	“
NE1/4SE1/4	“	“
NW1/4SE1/4	“	“
NE1/4SW1/4	“	“
NW1/4SW1/4	“	“
SW1/4SW1/4	“	“
SE1/4SW1/4	“	“

84840

**EXHIBIT B**

**Maps**



State: Oregon  
County: Klamath  
Tract: East District

Operator: \_\_\_\_\_

Start Date: \_\_\_\_\_

Written Plan Req'd: NO

Laid Out by: BH Date Laid Out: 05/04

Plan # 33600  
Project: 2004 Harvest Units  
Setting Number : \_\_\_\_\_

Scale 1:12,000

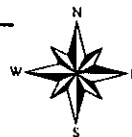

Land Own: AFR  
Timb Own: AFR  
Township: 35S  
Range: 14E  
Section: 19  
Date: 5/20/2004  
By: D. VanDusen

Note On Ribbon Color:  
Outside Boundary of Harvest Units = PINK RIBBON  
P.Cut Only = PINK RIBBON  
C.Cut Only = PINK & LIME GLO RIBBON  
P.C. and C.C. = The C.Cut WILL BE SURROUNDED BY  
LIME GLO AND WILL HAVE PINK/LIME AT  
EXTERIOR HARVEST BOUNDARY;  
INTERIOR BOUNDARY BETWEEN P.C. AND  
C.C. IS LIME GLO ONLY

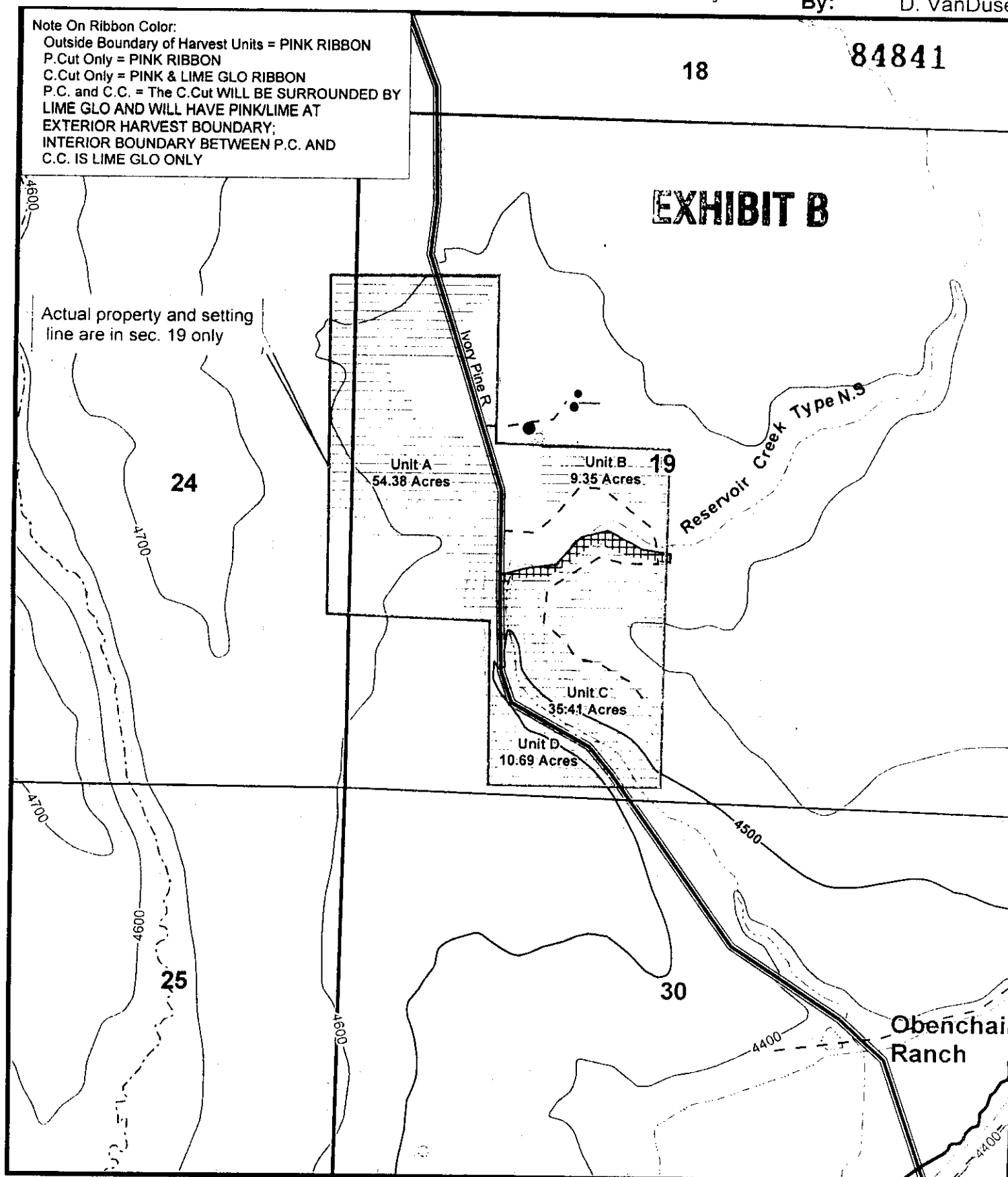

Imagery Info: 1997 IRS; Photo 01-181-3

### Unit# Acres Harvest Prescription

"A"	54 ac.	C.Cut-- Cut all species to minimum specs.; PROTECT all sub-RX trees
"B"	9 ac	C.Cut-- Cut all species to minimum specs.; PROTECT all sub-RX trees
"C"	35 ac.	C.Cut-- Cut all species to minimum specs.; PROTECT all sub-RX trees
"D"	11 ac.	C.Cut-- Cut all species to minimum specs.; PROTECT all sub-RX trees

Total Ac: 109 ac.

FPA Requirements: Two Up: Within WHA for Unit "A&C"  
Two Down: Two per acre req'd for unit "A&C"  
Other: Protect All Sub-Rx Trees  
B & D No WHA required under 25 acres

Setting	
HTYPE	
ClearCut	Edited Ownership
Partial Cut	Townships
WHA's - Blue Ribbon	Sections
Road	USGSContours
Surface	Minor
Dirt	100
Improved	500
Paved	Existing WHAs
Streams	Protected
SIZE	Sig. Wetland
Large	WMA
Medium	Strm Assoc Wld
Small	RMA
Unknown	Spring
PowerLines	Forested Wetland
GasLines	

State: Oregon  
County: Klamath  
Tract: East District

Operator: \_\_\_\_\_

Start Date: \_\_\_\_\_

Written Plan Req'd: NO

Laid Out by: Glass Date Laid Out: 05/20/04

Plan # 34303  
Project: 2004 Harvest Units  
Setting Number : \_\_\_\_\_

Scale 1:12,000

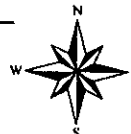

Land Own: AFR  
Timb Own: AFR  
Township: 34S  
Range: 14E  
Section: 23, 24, 25, 26  
Date: 4/28/2004  
By: D. VanDusen

**Note On Ribbon Color:**

Outside Boundary of Harvest Units = PINK RIBBON  
P.Cut Only = PINK RIBBON  
C.Cut Only = PINK & LIME GLO RIBBON  
P.C. and C.C. = The C.Cut WILL BE SURROUNDED BY  
LIME GLO AND WILL HAVE PINK/LIME AT  
EXTERIOR HARVEST BOUNDARY;  
INTERIOR BOUNDARY BETWEEN P.C. AND  
C.C. IS LIME GLO ONLY

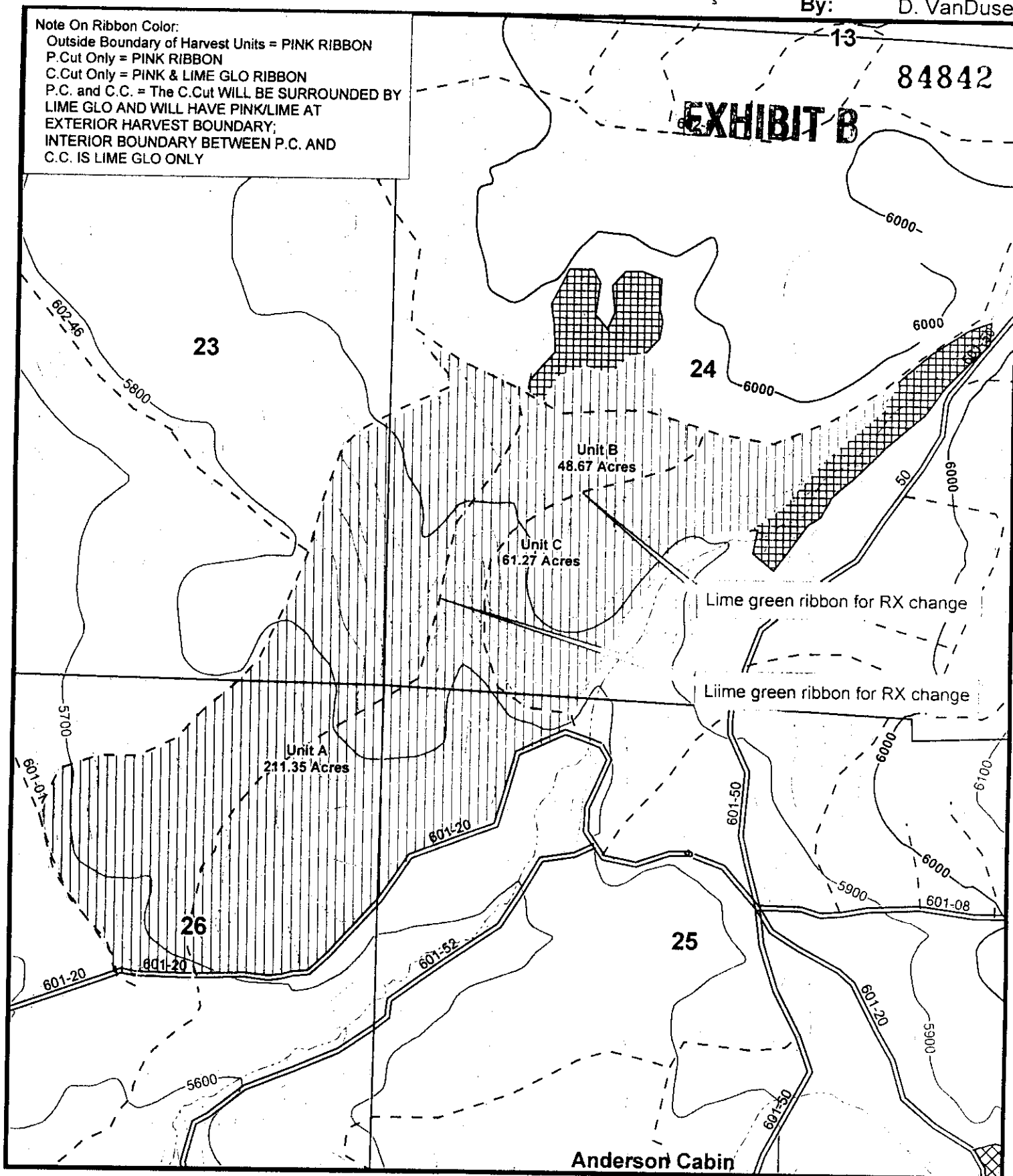

Imagery Info: 1997 IRS; Photo 03-158-14 & 03-186-12

**Unit# Acres Harvest Prescription**

"A"	211 ac.	P.Cut-- Overstory Removal Type II Harvest -- Min Merch All Species
"B"	49 ac.	P.Cut-- 12" + DBH All Species
"C"	61 ac.	P.Cut-- Overstory Removal Type II Harvest -- Min. Merch All Species

Total Ac: 321 ac.

FPA Requirements: Two Up: Within WHA for Unit "A"  
Two Down: Two per acre req'd for unit "A"  
Other: Protect All Sub-Rx Trees

Setting	Edited Ownership
HTYPE	Townships
Clearcut	Sections
Partial Cut	USGSContours
WHA's - Blue Ribbon	Minor
Road	100
Surface	500
Dirt	Existing WHAs
Improved	Protected
Paved	Sig. Wetland
Streams	WMA
SIZE	Strm Assoc Wld
Large	RMA
Medium	Spring
Small	Forested Wetland
Unknown	
PowerLines	
GasLines	

State: Oregon  
County: Klamath  
Tract: East District

Plan # 34380  
Project: 2004 Harvest Units  
Setting Number : \_\_\_\_\_

Land Own: AFR  
Timb Own: AFR  
Township: 34S  
Range: 14E  
Section: 3,10,11  
Date: 6/14/2004  
By: D. VanDusen

Operator: \_\_\_\_\_  
Start Date: \_\_\_\_\_  
Written Plan Req'd: NO  
Laid Out by: BH Date Laid Out: 06/04

Scale 1:12,000

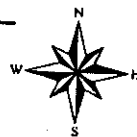

**Note On Ribbon Color:**

Outside Boundary of Harvest Units = PINK RIBBON  
P.Cut Only = PINK RIBBON  
C.Cut Only = PINK & LIME GLO RIBBON  
P.C. and C.C. = The C.Cut WILL BE SURROUNDED BY  
LIME GLO AND WILL HAVE PINK/LIME AT  
EXTERIOR HARVEST BOUNDARY;  
INTERIOR BOUNDARY BETWEEN P.C. AND  
C.C. IS LIME GLO ONLY

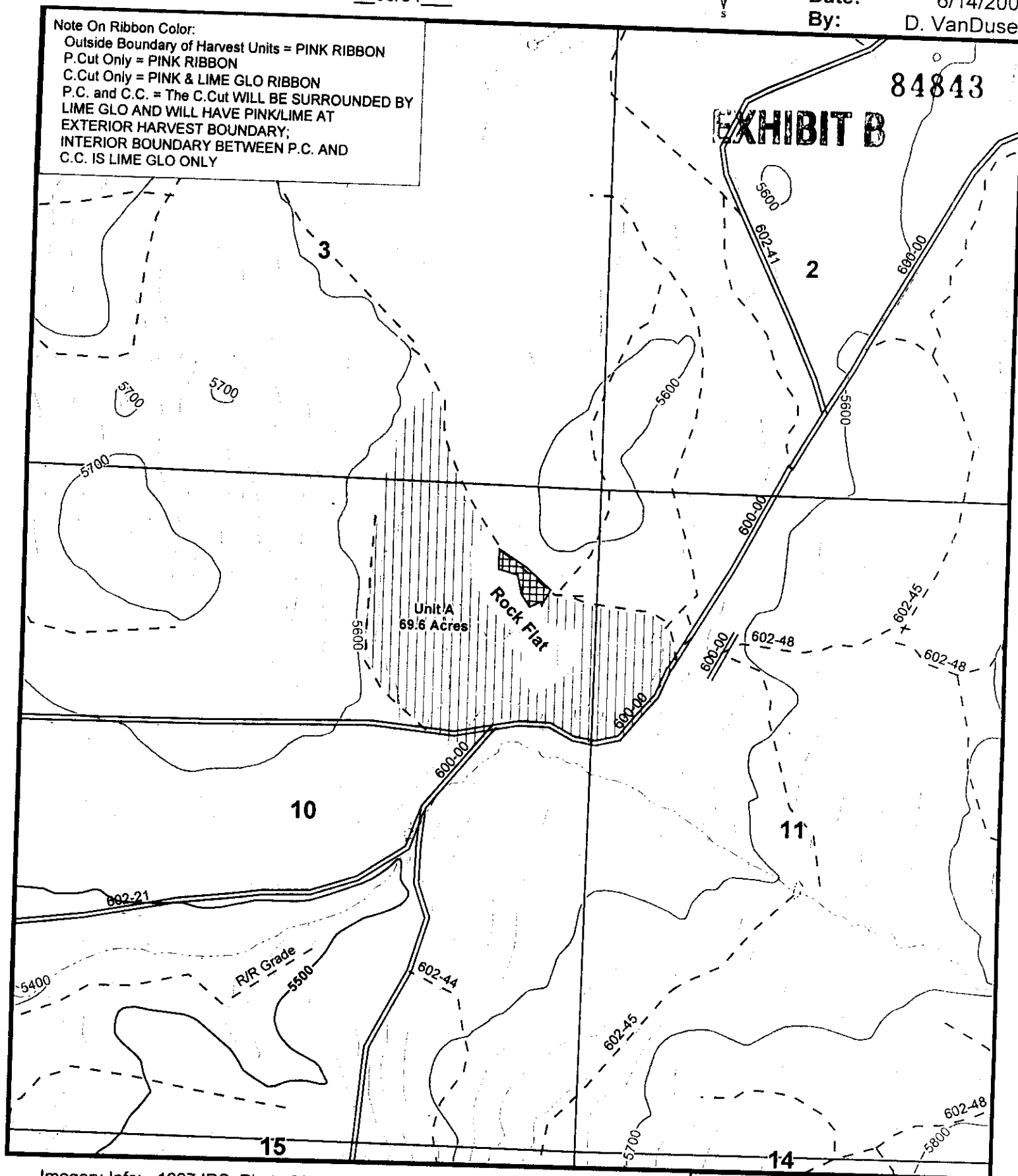

Imagery Info: 1997 IRS; Photo 03-184-15

**Unit# Acres Harvest Prescription**

"A" 70 ac. P.Cut-- Overstory Removal Type II Harvest --  
Min Merch All Species

Total Ac: 70 ac.

FPA Requirements: Two Up: Within WHA for Unit "A"  
Two Down: Two per acre req'd for unit "A"  
Other: Protect All Sub-Rx Trees

Setting		
HTYPE		Edited Ownership
Clearcut		Townships
Partial Cut		Sections
WHA's - Blue Ribbon		USGSContours
Road		Minor
Surface		100
Dirt		500
Improved		Existing WHAs
Paved		Protected
Streams		Sig. Wetland
SIZE		WMA
Large		Sirm Assoc Wild
Medium		RMA
Small		Spring
Unknown		Forested Wetland
PowerLines		
GasLines		

State: Oregon  
County: Klamath  
Tract: East District

Plan # 34438  
Project: 2004 Harvest Units  
Setting Number : \_\_\_\_\_

Operator: \_\_\_\_\_  
Start Date: \_\_\_\_\_

Written Plan Req'd: NO

Laid Out by: Bervie Date Laid Out: 6/04

Scale 1:12,000



Land Own: AFR  
Timb Own: AFR  
Township: 33S  
Range: 14E  
Section: 26, 27, 34  
Date: 10/13/2004  
By: D. VanDusen

**Note On Ribbon Color:**

Outside Boundary of Harvest Units = PINK RIBBON  
P.Cut Only = PINK RIBBON  
C.Cut Only = PINK & LIME GLO RIBBON  
P.C. and C.C. = The C.Cut WILL BE SURROUNDED BY  
LIME GLO AND WILL HAVE PINK/LIME AT  
EXTERIOR HARVEST BOUNDARY;  
INTERIOR BOUNDARY BETWEEN P.C. AND  
C.C. IS LIME GLO ONLY

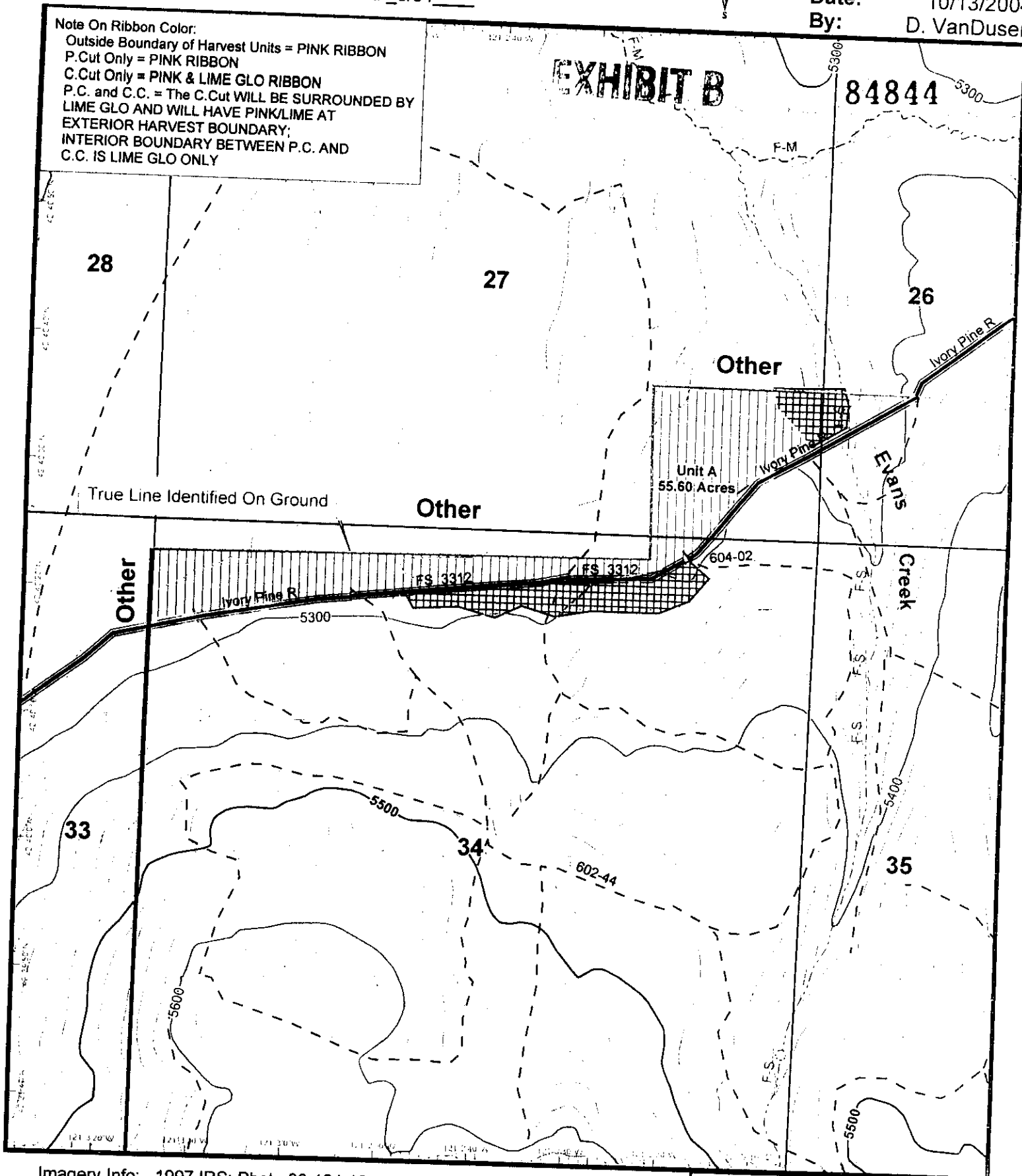

Imagery Info: 1997 IRS; Photo 03-184-19

**Unit# Acres Harvest Prescription**

"A" 55 ac. P.Cut-- Overstory Removal: Min Merch All Species

Total Ac: 55ac.

FPA Requirements: Two Up: Within WHA for Unit "A"  
Two Down: Two per acre req'd for unit "A"  
Other: Protect All Sub-Rx Trees

Setting	HTYPE	Edited Ownership
Clearcut	---	Townships
Partial Cut	---	Sections
WHA's - Blue Ribbon	---	USGS Contours
Road	---	Minor
Surface	---	100
---	---	500
Improved	---	Existing WHAs
Paved	---	Protected
Streams	---	Sig. Wetland
SIZE	---	WMA
Large	---	Stim Assoc Wld
Medium	---	RMA
Small	---	Spring
Unknown	---	Forested Wetland
PowerLines	---	
GasLines	---	

State: Oregon  
County: Klamath  
Tract: East District

Plan # 34579  
Project: 2004 Harvest Units  
Setting Number : \_\_\_\_\_

Land Own: AFR  
Timb Own: AFR  
Township: 34S  
Range: 14E  
Section: 4,9,10  
Date: 9/23/2004  
By: D. VanDusen

Operator: \_\_\_\_\_  
Start Date: \_\_\_\_\_

Written Plan Req'd: NO

Laid Out by: Benvie Date Laid Out: 6/03

Scale 1:12,000

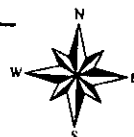

84845

Note On Ribbon Color:  
Outside Boundary of Harvest Units = PINK RIBBON  
P.Cut Only = PINK RIBBON  
C.Cut Only = PINK & LIME GLO RIBBON  
P.C. and C.C. = The C.Cut WILL BE SURROUNDED BY  
LIME GLO AND WILL HAVE PINK/LIME AT  
EXTERIOR HARVEST BOUNDARY;  
INTERIOR BOUNDARY BETWEEN P.C. AND  
C.C. IS LIME GLO ONLY

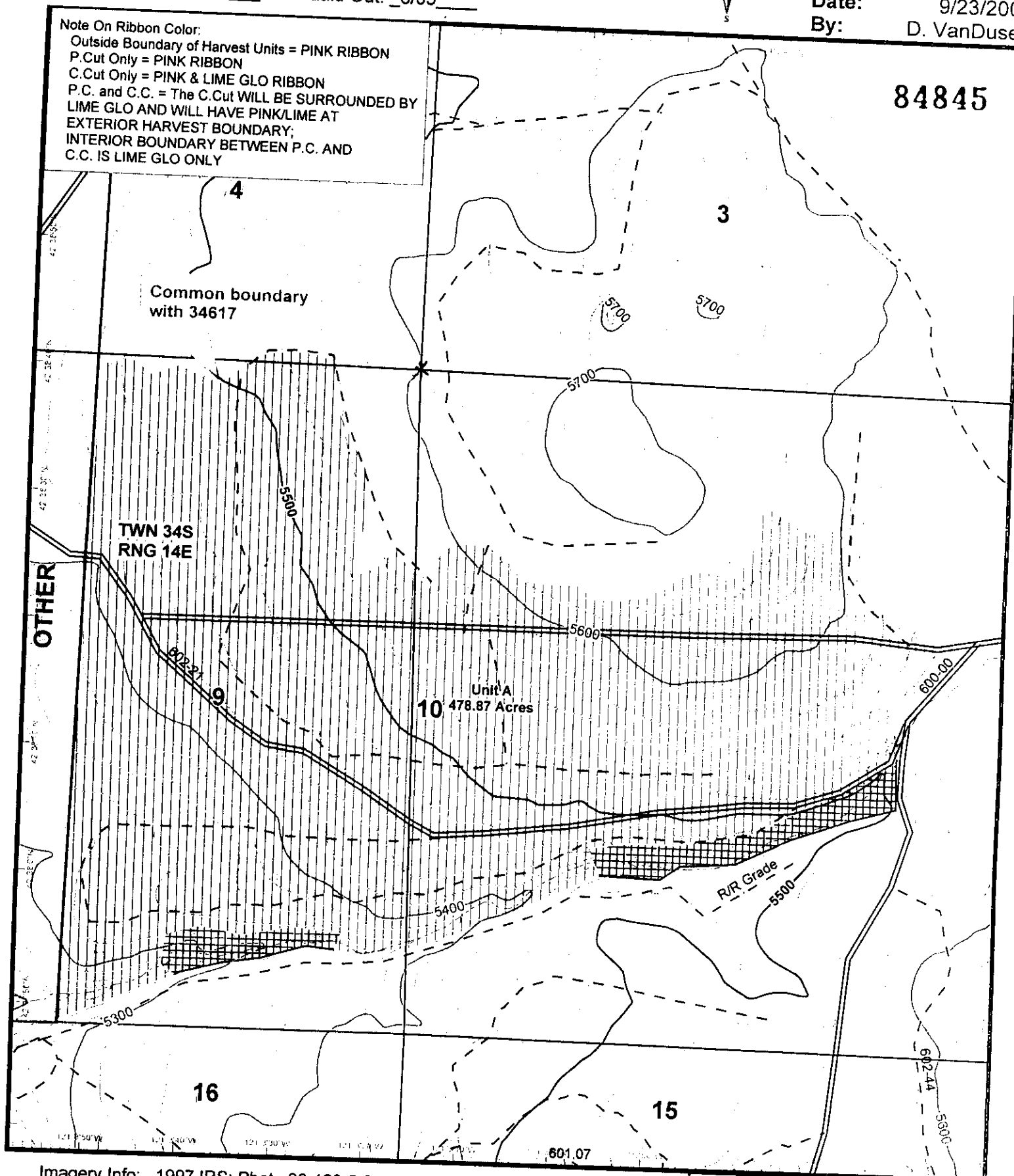

Imagery Info: 1997 IRS; Photo 03-183-5 & 03-184-15

**Unit# Acres Harvest Prescription**

"A" 479 ac. P.Cut-- Overstory Removal: Min Merch All Species

Total Ac: 479 ac.

FPA Requirements: Two Up: Within WHA for Unit "A"  
Two Down: Two per acre req'd for unit "A"  
Other: Protect All Sub-Rx Trees

Setting	
HTYPE	
Clearcut	Edited Ownership
Partial Cut	Townships
WHA's - Blue Ribbon	Sections
Road	USGSContours
Surface	Minor
— Dirt	100
— Improved	500
— Paved	Existing WHAs
Streams	Protected
SIZE	— Sig. Wetland
— Large	— WMA
— Medium	— Strm Assoc Wild
— Small	— RMA
— Unknown	— Spring
— PowerLines	— Forested Wetland
— GasLines	

State: Oregon  
County: Klamath  
Tract: East District

Plan # 34604  
Project: 2004 Harvest Units  
Setting Number : \_\_\_\_\_

Land Own: AFR  
Timb Own: AFR  
Township: 34S  
Range: 14E  
Section: 3, 4  
Date: 6/11/2004  
By: D. VanDusen

Operator: \_\_\_\_\_  
Start Date: \_\_\_\_\_  
Written Plan Req'd: NO  
Laid Out by: Benvie Date Laid Out: 06/04

Scale 1:13,961

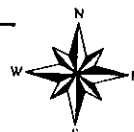

Note On Ribbon Color:  
Outside Boundary of Harvest Units = PINK RIBBON  
P.Cut Only = PINK RIBBON  
C.Cut Only = PINK & LIME GLO RIBBON  
P.C. and C.C. = The C.Cut WILL BE SURROUNDED BY  
LIME GLO AND WILL HAVE PINK/LIME AT  
EXTERIOR HARVEST BOUNDARY;  
INTERIOR BOUNDARY BETWEEN P.C. AND  
C.C. IS LIME GLO ONLY

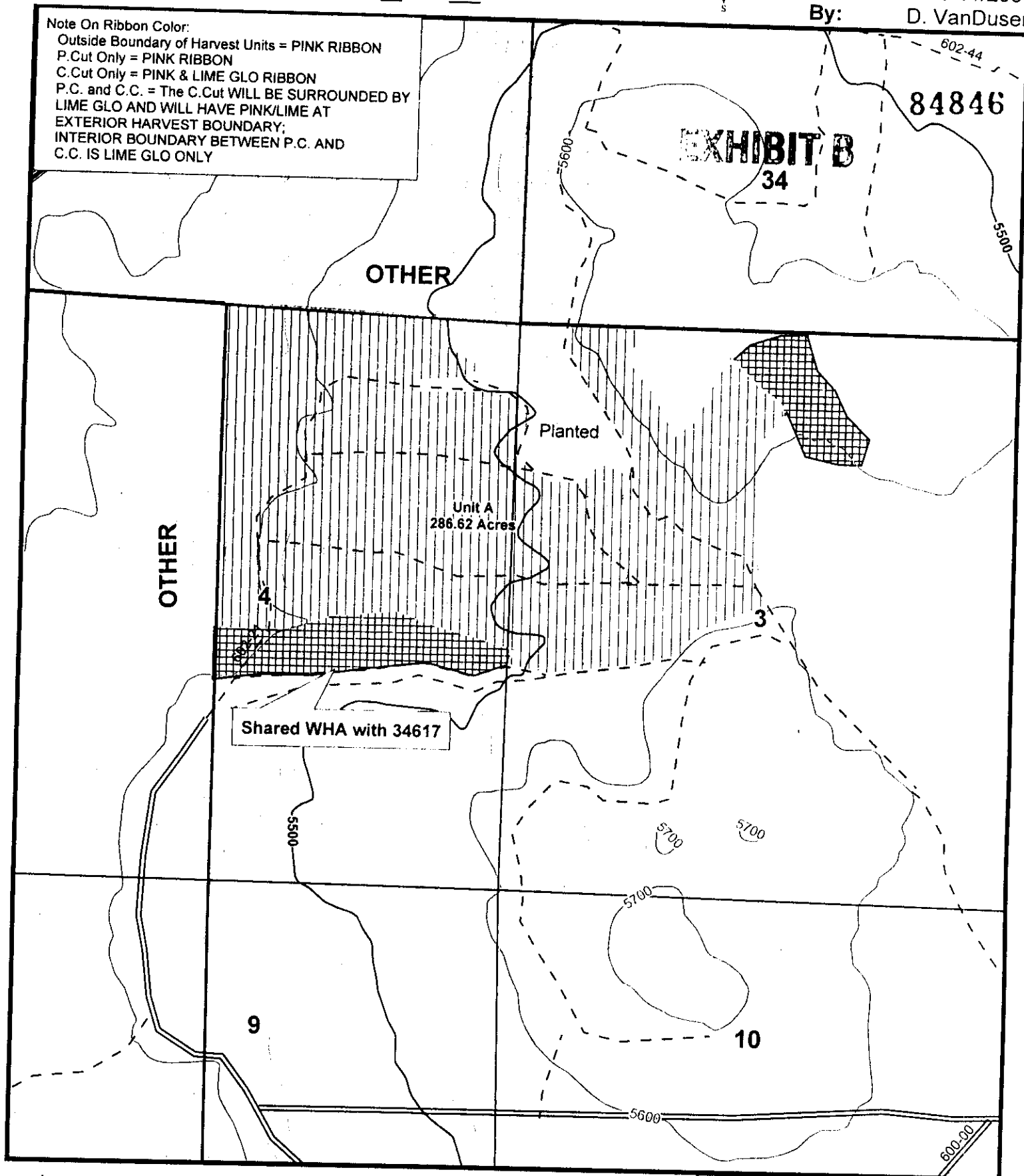

Imagery Info: 1997 IRS; Photo 03-183-16 & 03-184-16

**Unit# Acres Harvest Prescription**

"A" 287 ac. P.Cut-- Overstory Removal Type II Harvest --  
Min. Merch All Species

Total Ac: 287 ac.

FPA Requirements: Two Up: Within WHA for Unit "A"  
Two Down: Two per acre req'd for unit "A"  
Other: Protect All Sub-Rx Trees

<b>Setting</b>	Edited Ownership
<b>HTYPE</b>	Townships
Clearcut	Sections
Partial Cut	<b>USGSContours</b>
WHA's - Blue Ribbon	Minor
<b>Road</b>	100
<b>Surface</b>	500
Dirt	Existing WHAs
Improved	<b>Protected</b>
Paved	Sig Wetland
<b>Streams</b>	WMA
<b>SIZE</b>	Strm Assoc Wild
Large	RMA
Medium	Spring
Small	Forested Wetland
Unknown	
PowerLines	
GasLines	

State: Oregon  
 County: Klamath  
 Tract: East District  
 Operator: \_\_\_\_\_  
 Start Date: \_\_\_\_\_  
 Written Plan Req'd: NO  
 Laid Out by: Bervie Date Laid Out: 06/04

Plan # 34617  
 Project: 2004 Harvest Units  
 Setting Number : \_\_\_\_\_

Scale 1:12,000

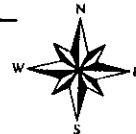

Land Own: AFR  
 Timb Own: AFR  
 Township: 34S  
 Range: 14E  
 Section: 3,4,9  
 Date: 6/11/2004  
 By: D. VanDusen

**Note On Ribbon Color:**

Outside Boundary of Harvest Units = PINK RIBBON  
 P.Cut Only = PINK RIBBON  
 C.Cut Only = PINK & LIME GLO RIBBON  
 P.C. and C.C. = The C.Cut WILL BE SURROUNDED BY  
 LIME GLO AND WILL HAVE PINK/LIME AT  
 EXTERIOR HARVEST BOUNDARY;  
 INTERIOR BOUNDARY BETWEEN P.C. AND  
 C.C. IS LIME GLO ONLY

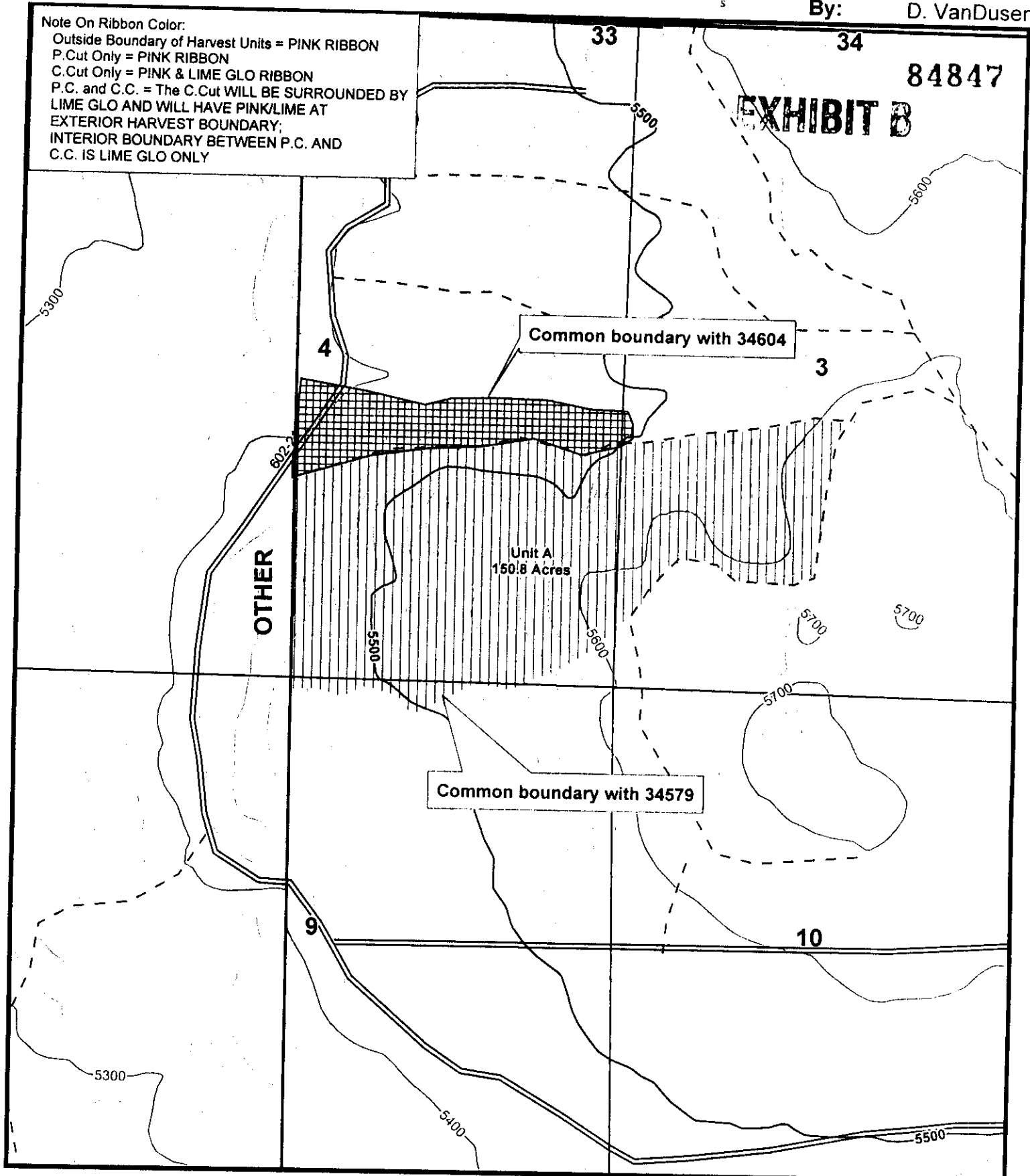

Imagery Info: 1997 IRS; Photo 03-183-15 & 03-184-15

**Unit# Acres Harvest Prescription**

"A" 151 ac. P.Cut-- Overstory Removal Type II Harvest --  
 Min. Merch All Species

Total Ac: 151 ac.

FPA Requirements: Two Up: Within WHA for Unit "A"  
 Two Down: Two per acre req'd for unit "A"  
 Other: Protect All Sub-Rx Trees

<b>Setting</b>	Edited Ownership
<b>HTYPE</b>	Townships
Clearcut	Sections
Partial Cut	<b>USGSContours</b>
WHA's - Blue Ribbon	Minor
<b>Road</b>	500
<b>Surface</b>	Existing WHAs
Dirt	<b>Protected</b>
Improved	Sig. Wetland
Paved	WMA
<b>Streams</b>	Strm Assoc Wild
<b>SIZE</b>	RMA
Large	Spring
Medium	Forested Wetland
Small	
Unknown	
PowerLines	
GasLines	

**Land Own:** AFR  
**Timb Own:** AFR  
**Township:** 34S  
**Range:** 14E  
**Section:** 28, 29, 32, 33  
**Date:** 6/11/2004  
**By:** D. VanDusen

**Scale 1:12,000**

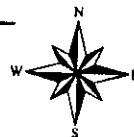

Laid Out by: Glass Date Laid Out: 6/04

Outside Boundary of Harvest Units = PINK RIBBON  
P.Cut Only = PINK RIBBON  
C.Cut Only = PINK & LIME GLO RIBBON  
P.C. and C.C. = The C.Cut will be surrounded by  
LIME GLO and will have PINK/LIME AT  
EXTERIOR HARVEST BOUNDARY;  
INTERIOR BOUNDARY BETWEEN P.C. AND  
C.C. IS LIME GLO ONLY

21

84848

**EXHIBIT-3**

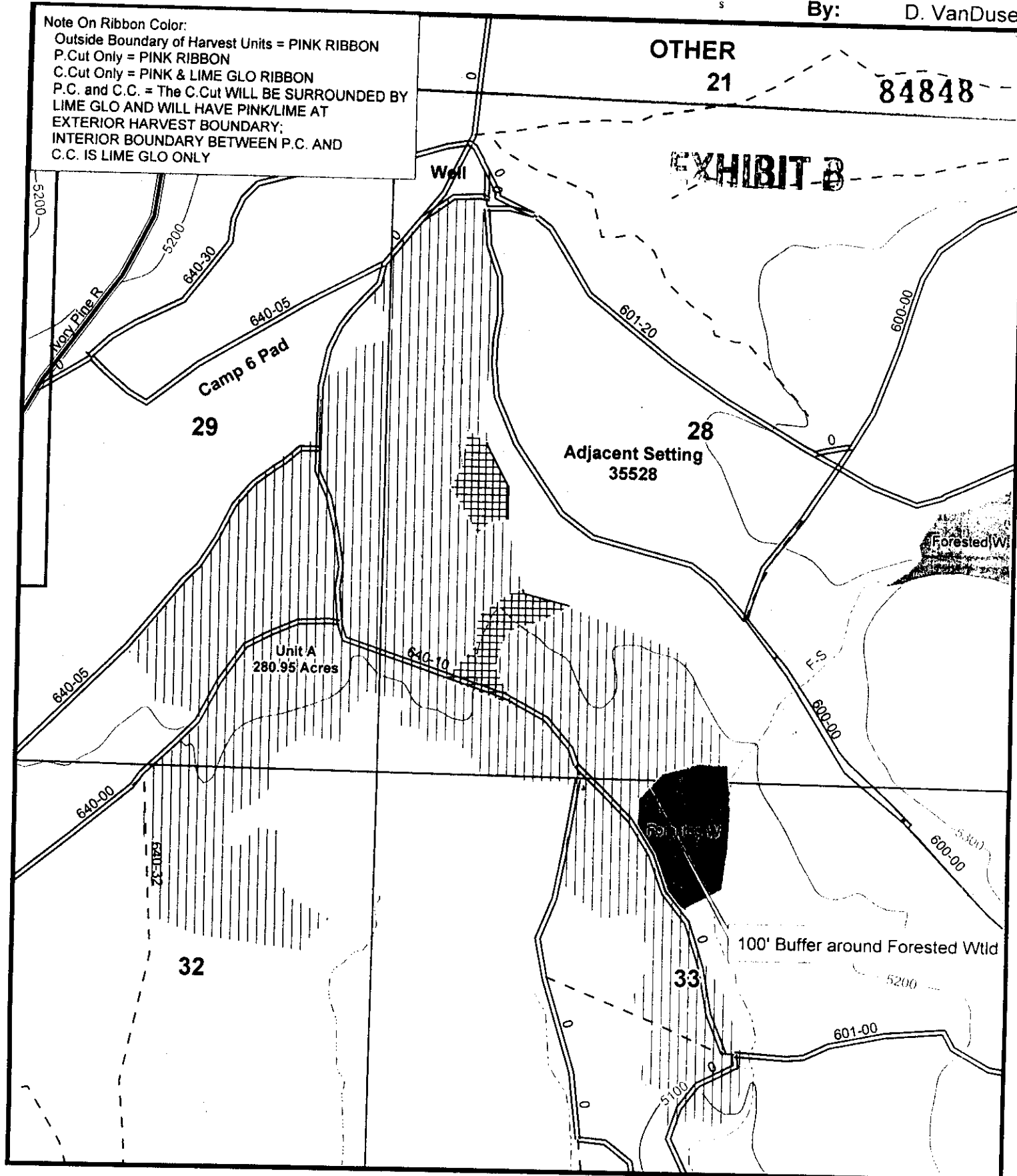

Imagery info: 1997 IRS; Photo 03-183-9

<u>Unit#</u>	<u>Acres</u>	<u>Harvest</u>	<u>Prescription</u>
1	10	1000	1000
2	10	1000	1000
3	10	1000	1000
4	10	1000	1000
5	10	1000	1000
6	10	1000	1000
7	10	1000	1000
8	10	1000	1000
9	10	1000	1000
10	10	1000	1000
11	10	1000	1000
12	10	1000	1000
13	10	1000	1000
14	10	1000	1000
15	10	1000	1000
16	10	1000	1000
17	10	1000	1000
18	10	1000	1000
19	10	1000	1000
20	10	1000	1000
21	10	1000	1000
22	10	1000	1000
23	10	1000	1000
24	10	1000	1000
25	10	1000	1000
26	10	1000	1000
27	10	1000	1000
28	10	1000	1000
29	10	1000	1000
30	10	1000	1000
31	10	1000	1000
32	10	1000	1000
33	10	1000	1000
34	10	1000	1000
35	10	1000	1000
36	10	1000	1000
37	10	1000	1000
38	10	1000	1000
39	10	1000	1000
40	10	1000	1000
41	10	1000	1000
42	10	1000	1000
43	10	1000	1000
44	10	1000	1000
45	10	1000	1000
46	10	1000	1000
47	10	1000	1000
48	10	1000	1000
49	10	1000	1000
50	10	1000	1000
51	10	1000	1000
52	10	1000	1000
53	10	1000	1000
54	10	1000	1000
55	10	1000	1000
56	10	1000	1000
57	10	1000	1000
58	10	1000	1000
59	10	1000	1000
60	10	1000	1000
61	10	1000	1000
62	10	1000	1000
63	10	1000	1000
64	10	1000	1000
65	10	1000	1000
66	10	1000	1000
67	10	1000	1000
68	10	1000	1000
69	10	1000	1000
70	10	1000	1000
71	10	1000	1000
72	10	1000	1000
73	10	1000	1000
74	10	1000	1000
75	10	1000	1000
76	10	1000	1000
77	10	1000	1000
78	10	1000	1000
79	10	1000	1000
80	10	1000	1000
81	10	1000	1000
82	10	1000	1000
83	10	1000	1000
84	10	1000	1000
85	10	1000	1000
86	10	1000	1000
87	10	1000	1000
88	10	1000	1000
89	10	1000	1000
90	10	1000	1000
91	10	1000	1000
92	10	1000	1000
93	10	1000	1000
94	10	1000	1000

"A" 281 ac. P.Cut-- Overstory Removal Type II Harvest --  
Min. Merch All Species

Total Ac: 281 ac.

FPA Requirements: Two Up: Within WHA for Unit "A"  
Two Down: Two per acre req'd for unit "A"  
Other: Protect All Sub-Rx Trees

**Setting**  
**HTYPE**  
 --- Clearcut  
 ||| Partial Cut  
 |||| WHA's - Blue Ribbon  
**Road**  
**Surface**  
 - - Dirt  
 == Improved  
 == Paved  
**Streams**  
**SIZE**  
 --- Large  
 --- Medium  
 --- Small  
 --- Unknown  
 ●● PowerLines  
 ● Gas lines

**Edited Ownership**  
**Townships**  
**Sections**  
**USGSContours**  
 --- Minor  
 --- 100  
 --- 500  
**Existing WHAs**  
**Protected**  
 Sig. Wetland  
 WMA  
 Strm Assoc Wtld  
 RMA  
 Spring  
 Forested Wetland