

BOARD OF COUNTY COMMISSIONERS

KLAMATH COUNTY, OREGON

RECEIVED

MAY 10 1994

COUNTY CLERK

'05 FEB 11 AM 11:02

IN THE MATTER OF APPROVING THE)
 EXCHANGE OF PROPERTY BETWEEN)
 THE WINEMA NATIONAL FOREST AND)
~~HELEN CARROLL~~)
 Hallie E. Scherer)

RESOLUTION NO- 94-032Vol M05 Page 09730

This matter coming before the Board of County Commissioners concerning the approval of an exchange of land between the U.S. Forest Service and ~~Helen Carroll~~: Hallie E. Scherer

Hallie E. Scherer

WHEREAS, the Forest Service and ~~Helen Carroll~~ have entered into an exchange of land as described on the attached Exhibits I and II; and

WHEREAS, the land lies within or adjacent to the exterior boundaries of the Winema National Forest; and

WHEREAS, the lands are primary grass lands and the exchange will contribute to the use and development of lands in Klamath County; and

Hallie E. Scherer WHEREAS, the exchange of land will benefit both the Forest Service and ~~Helen Carroll~~ by helping to solve a land boundary problem, and therefore, be beneficial to Klamath County; and

WHEREAS, the lands described on exhibits I and II are to be exchanged by ~~Helen Carroll~~ and the Forest Service:

Hallie E. Scherer

BE IT HEREBY RESOLVED that the Board of County Commissioners of Klamath County, Oregon, approves the exchange of the above cited property by the U.S. Forest Service and ~~Helen Carroll~~. Hallie E. Scherer

DATED this 4th of May, 1994

 CHAIRMAN OF THE BOARD

 COUNTY COMMISSIONER

 COUNTY COMMISSIONER

Rerecord to correct legal descriptions and name previously recorded in Journal No. M94, Page 1502. Also record in Deed records.

State of Oregon, County of Klamath
 Recorded 02/11/05 11:02 a m
 Vol M05 Pg 09730-36
 Linda Smith, County Clerk
 Fee \$ AC # of Pgs 7

Return to Commissioner's Journal

09731

1503

WINEMA NATIONAL FOREST
HELEN CARROLL
LAND EXCHANGE

LEGAL DESCRIPTION

FEDERAL LAND

T. 34 S., R. 7., W.M.
Sec. 35, ~~E1/2E1/2SE1/4SE1/4NE1/4NW1/4~~ NE $\frac{1}{4}$ SE $\frac{1}{4}$ SE $\frac{1}{4}$ NE $\frac{1}{4}$ NW $\frac{1}{4}$
Containing 0.625 acre

NON-FEDERAL LAND

T. 34 S., R. 7 E., W.M.
Sec. 35, ~~portion of NE1/4NW1/4, more particularly described as:~~

~~Beginning at the southeast corner of the NE1/4NW1/4 of said section 35;
thence south to the northerly bank of the Sprague River; thence
northwesterly along the northerly bank of said river to its intersection
with the southerly line of the NE1/4NW1/4; thence east to the point of
beginning.~~

Containing 1.21 acres, more or less.

portion of SE $\frac{1}{4}$ NW $\frac{1}{4}$, more particularly described as:

Beginning at the C-N 1/16 corner of said section 35; thence
Southerly along the N-S centerline of said section 35 to the
Northerly bank of Sprague River; thence Northwesterly along the
Northerly bank of said river to a point intersecting a line
between the NW 1/16 and C-N 1/16 corner of said section 35;
thence Easterly to the point of beginning.

United States
Department of
Agriculture

Forest
Service

Winema National Forest
2819 Dahlia Street
Klamath Falls, OR 97601

Reply To: 5430

Date: JAN 07 1994

Klamath County Commissioners
Klamath County Courthouse
305 Main Street
Klamath Falls, OR 97601

Re: Land Exchange with ~~Helen Carroll~~ Hallie E. Scherer
Winema #86

Dear Commissioners:

Hallie E. Scherer

This letter is to inform you of a proposed land exchange between the Winema National Forest and ~~Helen Carroll~~ of Medford, Oregon. This is a small exchange with both the Federal and Non-Federal lands located approximately one mile easterly of Chiloquin, Oregon.

Ms. Scherer

~~Ms. Carroll~~ has a residential lot in a rural subdivision that was developed in the late 1950's and early 1960's. In the 1970's, a property line survey conducted by the Forest Service crossed ~~Ms. Carroll's~~ property. As a result of the survey, the size of her property was reduced below the minimum Klamath County requirement of one acre for development of a residence.

Ms. Scherer

Ms. Scherer's

Earlier this year ~~Ms. Carroll~~ offered to exchange 1.21 acres of her property fronting on Sprague River to the Forest Service if the Forest Service would exchange enough land to bring her property up to minimum Klamath County requirements. The Forest has worked with the Klamath County Planning Department to arrive at an acceptable solution and has identified a square 0.625 acre parcel adjacent to ~~Ms. Carroll's~~ lot.

Ms. Scherer's

The 1.21 acre parcel of ~~Ms. Carroll's~~ is in a floodplain/wetland and cannot be developed with a residence. The 0.625 acre National Forest parcel is a grass covered upland with one large ponderosa pine.



Forest Service



09733

1505

Winema
National Forest
Pacific Northwest Region
2819 Dahlia Street
Klamath Falls, OR 97601

FAX TRANSMITTAL COVER SHEET

DATE: 5/2/94

TIME: _____

TO:

Beauville

LOCATION:

KLAMATH COUNTY COMMISSIONERSAREA
CODE

FAX NO: FTS/COMMERCIAL: 8 + () _____

LOCAL: 9 + () 883-5163

TOTAL # PAGES:

7

(Including Transmittal Sheet)

FROM:

WINEMA NATIONAL FOREST SUPERVISOR'S OFFICE

2819 Dahlia Street

Klamath Falls, OR 97601

FAX Number 503-883-6709

MESSAGE(S):

Request for copy of Resolution for
Helen Garrett Land Exchange.

Hallie E. Scherer

If you do not receive all pages, please call back as soon as possible.

(503) 883- 6799

Thank you,

Mark Stump
Signature of Sender

Winema 6200-4 (5/92)

WINEMA NATIONAL FOREST
HELEN CARROLL
LAND EXCHANGE

LEGAL DESCRIPTION

FEDERAL LAND

T. 34 S., R. 7., W.M.
Sec. 35, ~~E1/2E1/2SE1/4SE1/4NE1/4NW1/4~~ NE $\frac{1}{4}$ SE $\frac{1}{4}$ SE $\frac{1}{4}$ NE $\frac{1}{4}$ NW $\frac{1}{4}$
Containing 0.625 acre

NON-FEDERAL LAND

T. 34 S., R. 7 E., W.M.
Sec. 35, ~~portion of NE1/4NW1/4, more particularly described as:~~

~~Beginning at the southeast corner of the NE1/4NW1/4 of said section 35; thence south to the northerly bank of the Sprague River; thence northwesterly along the northerly bank of said river to its intersection with the southerly line of the NE1/4NW1/4; thence east to the point of beginning.~~

Containing 1.21 acres, more or less.

portion of SE $\frac{1}{4}$ NW $\frac{1}{4}$, more particularly described as:

Beginning at the C-N 1/16 corner of said section 35; thence Southerly along the N-S centerline of said section 35 to the Northerly bank of Sprague River; thence Northwesterly along the Northerly bank of said river to a point intersecting a line between the NW1/16 and C-N 1/16 corner of said section 35; thence Easterly to the point of beginning.

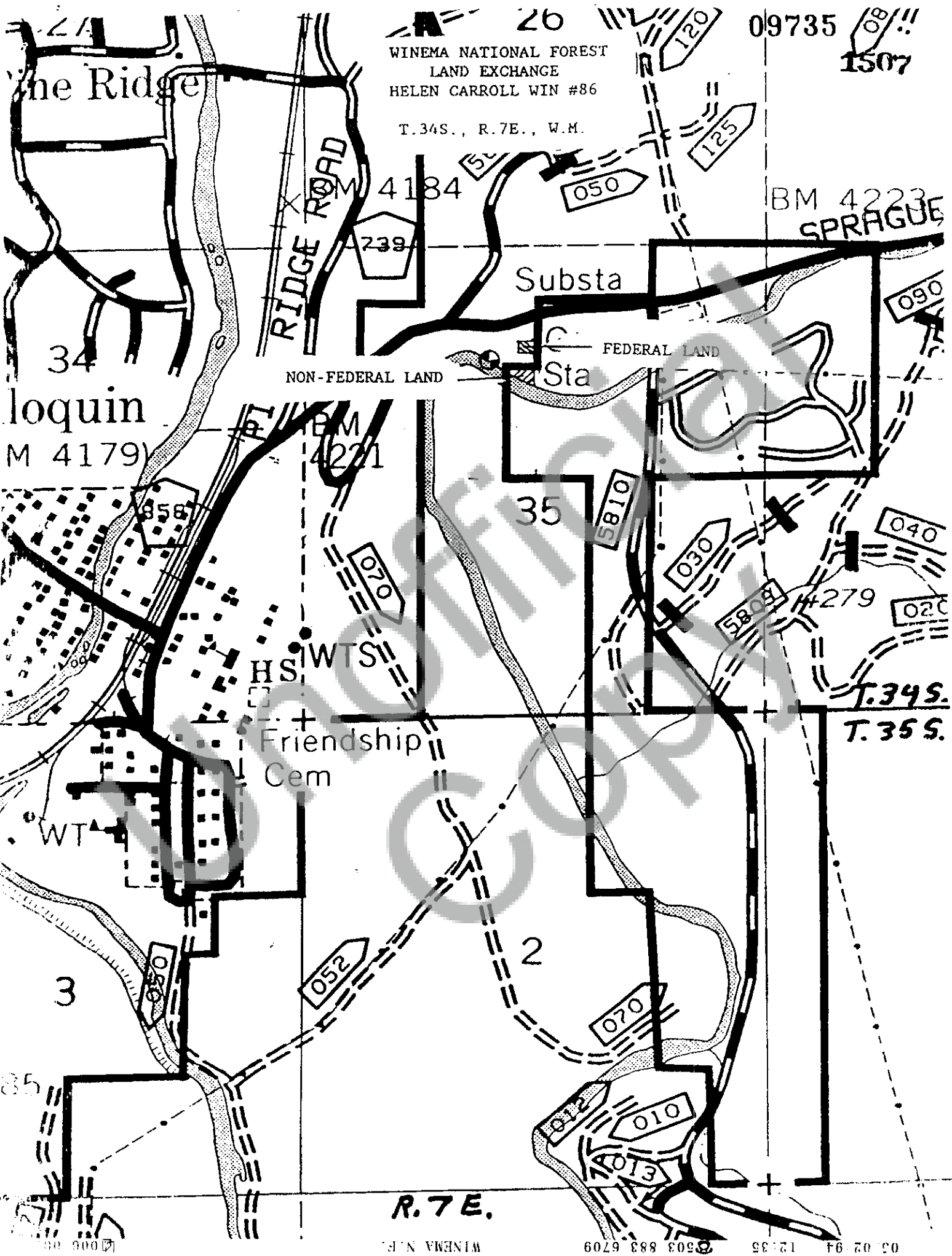

26
WINEMA NATIONAL FOREST
LAND EXCHANGE
HELEN CARROLL WIN #86
T.34S., R.7E., W.M.

09735
1507

the Ridge

RIDGE ROAD

BM 4223
SPRAGUE

34
loquin
M 4179

NON-FEDERAL LAND

Substa

Sta

FEDERAL LAND

HS WTS

Friendship
Cem

R.7E.

WINEMA N.F.

0503 883 6709

05 02 94 12:35

09736 1508



United States
Department of
Agriculture

Forest
Service

Winema National Forest
2819 Dahlia Street
Klamath Falls, OR 97601

Reply To: 5430

Date: MAR 18 1994

Klamath County Commissioners
403 Pine Street, Suite 300
Klamath Falls, OR 97601

Hallie E. Scherer
RE: Land Exchange With ~~Helen Carroll~~, Winema No. 86

Dear Commissioners:

Hallie E. Scherer
The ~~Helen Carroll~~ land exchange is nearing completion. Enclosed is our letter to you dated January 7, 1994, giving the details of this exchange.

We now need your approval to proceed with the exchange. A resolution approving the exchange is enclosed for approval.

Sincerely,

Bob Castaneda

BOB CASTANEDA
Forest Supervisor

Enclosures:

cc: Hallie E. Scherer
% Helen Carroll (w/enc)
3215 Delta Waters
Medford, OR 97504

Vicky Maggiora, R.O. (w/enc)
Marv Stump (w/enc)
Chiloquin Ranger District (w/enc)

