

RECORDING REQUESTED BY:

Grantee: Pacificorp

Grantor: Klamath Tribes

Return to:

PacifiCorp

Attn: Ed Rush

825 NE Multnomah, Suite 1000

Portland, OR 97232

M06-04216

Klamath County, Oregon

03/08/2006 09:28:19 AM

Pages 4 Fee: \$36.00

RIGHT OF WAY EASEMENT

36v

Return to: PacifiCorp Attn: Ed Rush
825 NE Multnomah, Suite 1000
Portland, OR 97232
CC#: 11176 WO#: 2628041

PARTIAL RELEASE OF EASEMENT

PACIFICORP, an Oregon Corporation, hereby disclaims and releases to The United States of America, Bureau of Indian Affairs, in trust for the Klamath Tribes, any right, title or interest it may have to that certain easement granted by The Klamath Tribes, dated January 24, 2006 and recorded February 27, 2006, as Instrument No. M06-03569, in the office of the County Recorder of Klamath County, State of Oregon, being more particularly described as follows and as more particularly described and/or shown on Exhibit A attached hereto and by this reference made a part hereof or in and to the following described real property:

A STRIP OF LAND 40 FEET IN WIDTH, LYING 20 FEET ON EACH SIDE OF THE FOLLOWING DESCRIBED CENTERLINE, SITUATED IN GOVERNMENT LOT 24 OF SECTION 17 AND GOVERNMENT LOT 26 OF SECTION 16, TOWNSHIP 35 SOUTH, RANGE 7 EAST, WILLAMETTE MERIDIAN, KLAMATH COUNTY, OREGON, SAID CENTERLINE BEING MORE PARTICULARLY DESCRIBED AS FOLLOWS:

COMMENCING AT THE ONE-QUARTER CORNER COMMON TO SECTIONS 16 AND 17 OF SAID TOWNSHIP AND RANGE; THENCE SOUTH 02°05'06" WEST, 1069.23 FEET TO THE TRUE POINT OF BEGINNING; THENCE NORTH 87°59'09" EAST, 835.58 FEET TO A POINT WHICH BEARS SOUTH 37°27'29" EAST, 1309.09 FEET FROM SAID ONE-QUARTER CORNER AND THE END OF THE CENTERLINE; SIDELINES ARE LENGTHENED OR SHORTENED TO TERMINATE PERPENDICULAR TO THE END OF THE CENTERLINE.

SAID STRIP CONTAINS 0.77 ACRES, MORE OR LESS.

BEARINGS ARE BASED UPON FOUND MONUMENTATION.

All other interests arising out of said instrument affecting other lands therein described shall remain vested in PacifiCorp, the successor company to the Pacific Power & Light Company, its successors and assigns.

DATED this 2nd day of March, 2006.

PACIFICORP, an Oregon Corporation

By Roberta Blau
Roberta Blau
Managing Director, Real Estate

REPRESENTATIVE ACKNOWLEDGMENT

STATE OF Oregon)
County of Klamath) ss.

This instrument was acknowledged before me on this 2nd day of March, 2006,
by Roberta Blau, as Managing Director, Real Estate of PacifiCorp.

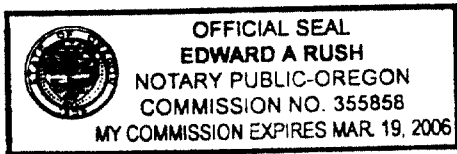

Edward A Rush
Notary Public

My commission expires: 3/19/06

NW ¼ SW ¼ of Section 16, and NE ¼ SE ¼ of Section 17, Township 35 South, Range 7 East, Willamette Meridian, Klamath County, State of Oregon.

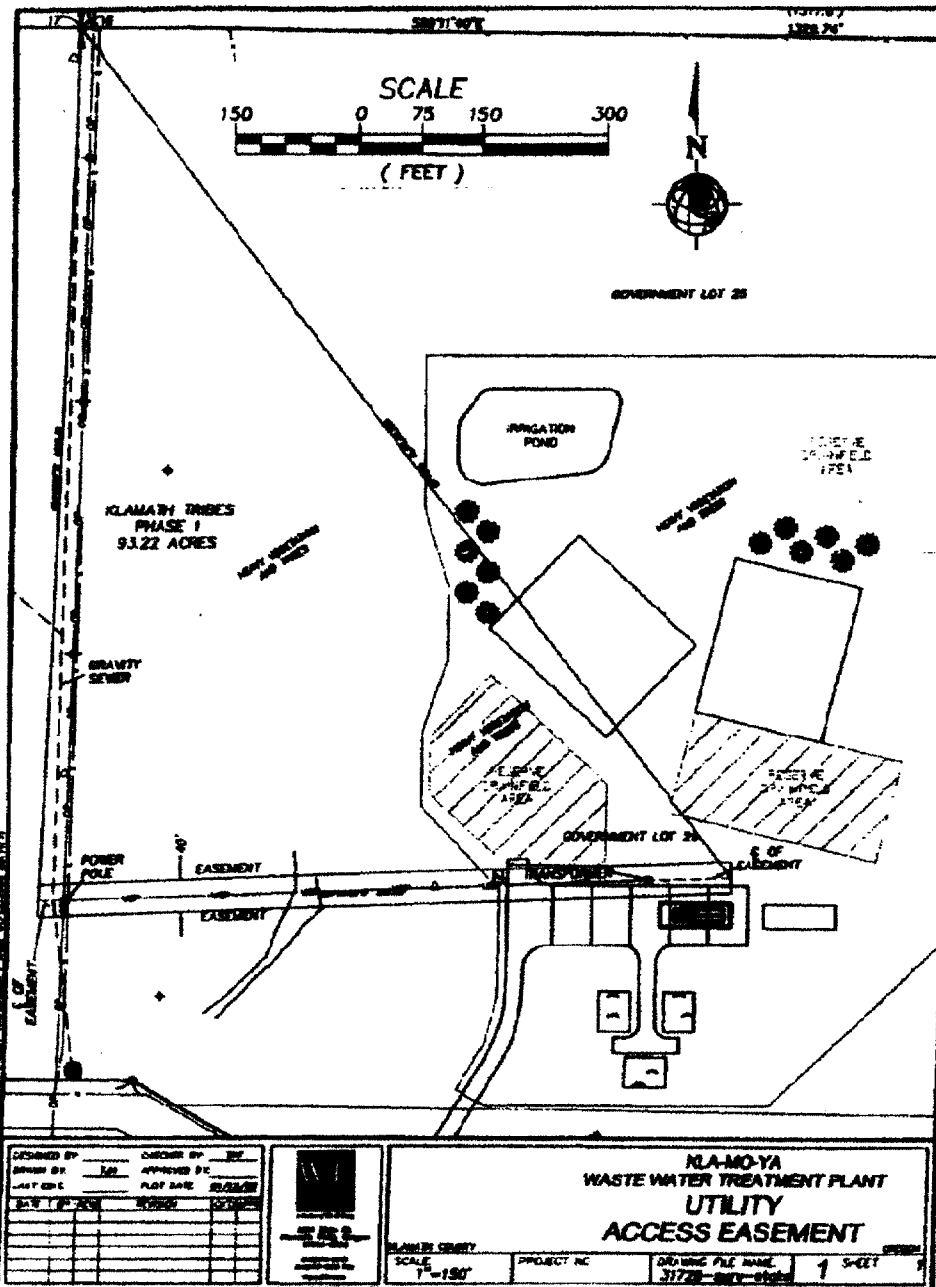

CC#: 11176 WO#: 2628041

ROW#:

Owner: BIA / Klamath Tribes



EXHIBIT A  **PACIFICORP**

This drawing should be used only as a representation of the location of the easement area. The exact location of all structures, lines and appurtenances is subject to change within the boundaries of the described easement area.