

2006-017099  
Klamath County, Oregon



08/24/2006 03:47:00 PM

Fee: \$26.00



After recording return to:  
Clinton Shirts  
1438 Gary Street  
Klamath Falls, OR 97603

Until a change is requested all tax statements  
shall be sent to the following address:  
Clinton Shirts  
1438 Gary Street  
Klamath Falls, OR 97603

File No.: 7021-854852 (DMC)  
Date: August 17, 2006

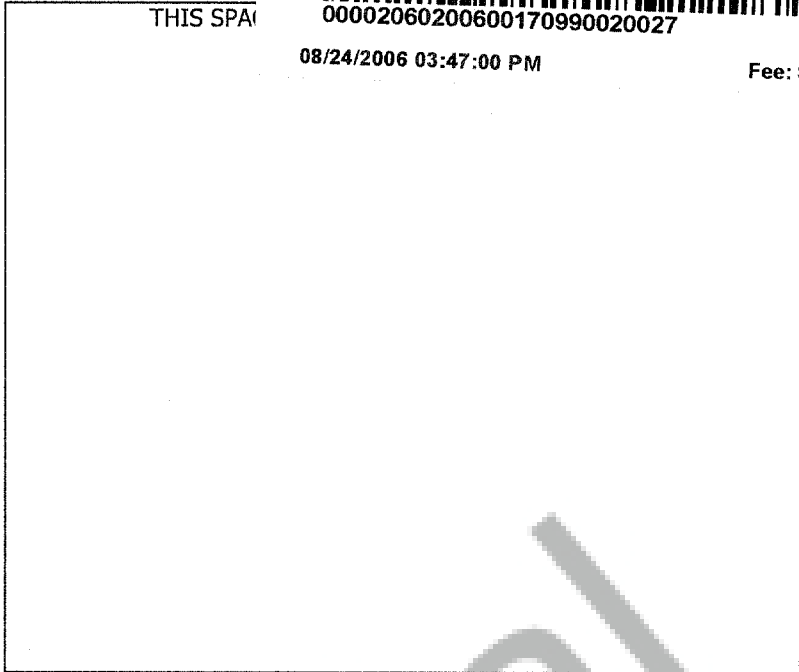

### STATUTORY WARRANTY DEED

**Charles R. Menke and Janice M. Menke as tenants by the entirety**, Grantor, conveys and warrants to **Clinton S. Shirts**, Grantee, the following described real property free of liens and encumbrances, except as specifically set forth herein:

**LOT 26 OF NEW DEAL TRACTS, ACCORDING TO THE OFFICIAL PLAT THEREOF ON FILE IN THE OFFICE OF THE COUNTY CLERK OF KLAMATH COUNTY, OREGON.**

**Subject to:**

1. The **2006-2007** Taxes, a lien not yet payable.
2. Covenants, conditions, restrictions and/or easements, if any, affecting title, which may appear in the public record, including those shown on any recorded plat or survey.

The true consideration for this conveyance is **\$175,300.00**. (Here comply with requirements of ORS 93.030)

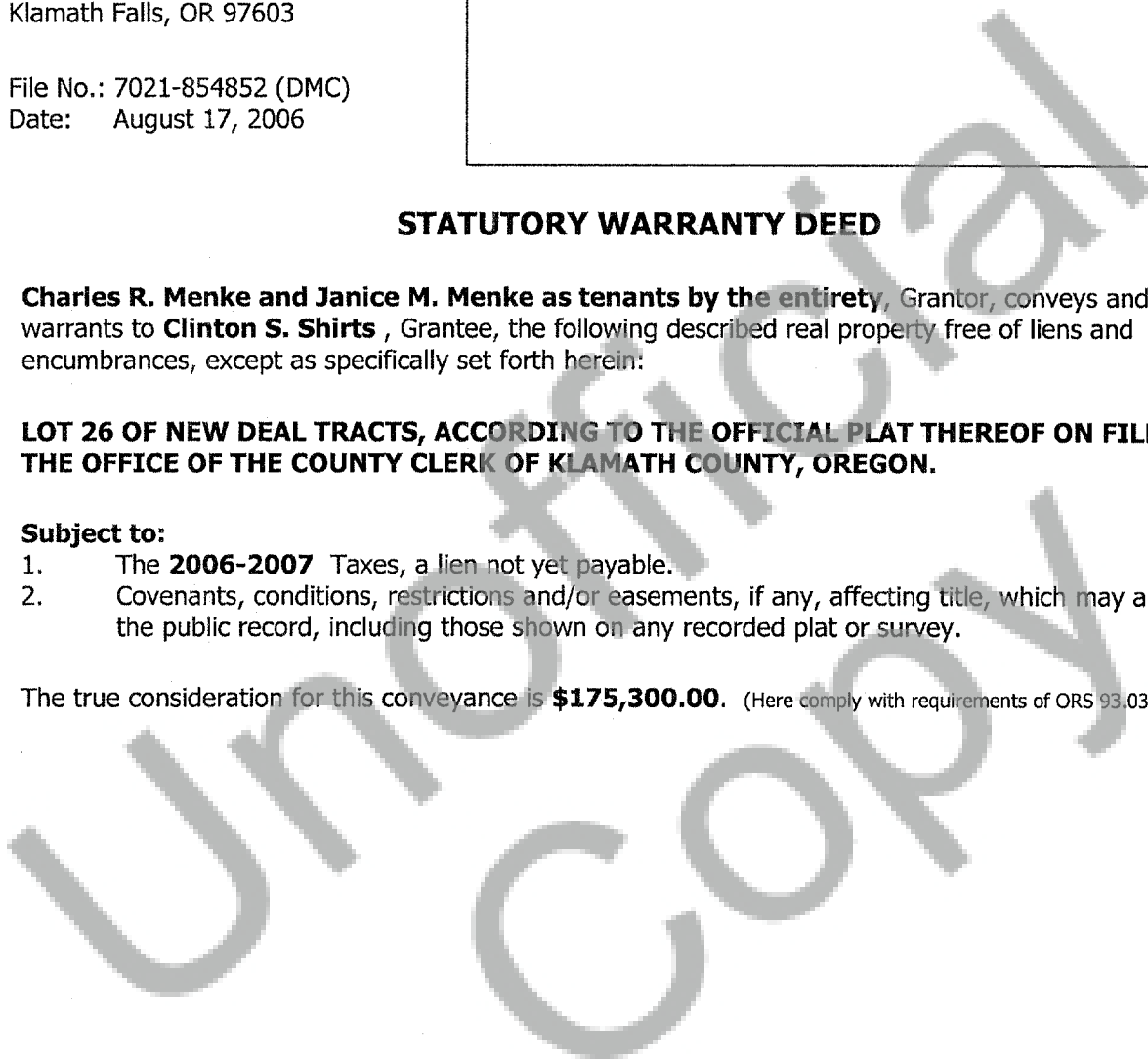

26-F

