

After Recording Return to:
Rhine-Cross Group, LLC
430 Walnut Avenue
Klamath Falls, OR 97601

2007-019967
Klamath County, Oregon



11/27/2007 10:52:10 AM

Fee: \$21.00

AFFIDAVIT OF CORRECTION

I, Keith R. Rhine, P.L.S. No. 58985, being duly sworn, depose and say that I am the surveyor who surveyed the property as depicted in Land Partition 97-06, recorded in Volume 2007-315 of the Partition Plat Book in the Klamath County Plat Records.

The following correction to said plat is necessary and is as follows:

1. Bearing and Distance from replaced gas pipe monument to NW corner of Parcel 2 should be N12°14'09"W, 1859.75'.

The present fee owner(s) of the property materially affected by this affidavit (is/are) as follows:

Jeld-Wen, Inc.

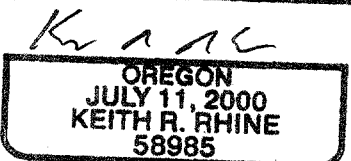
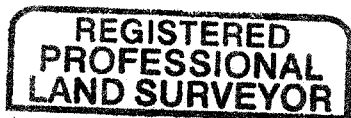

RENEWAL DATE

Renewal date: 12/31/08

NOTARY STATEMENT:

STATE OF OREGON)
COUNTY OF KLAMATH)

Subscribed and sworn to before me on this 20 day of November, 2007

Sandy Boatright

Notary Public for the State of Oregon

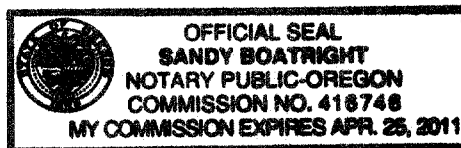

APPROVAL:

I, Mike Markus, Klamath County Surveyor, do hereby certify that said Affidavit of Correction for Land Partition Plat 97-06 has been examined by me and that it complies with requirements of ORS 92.170.

Mike Markus

Mike Markus
Klamath County Surveyor

11/27/2007
Date