

WTC 1396-10239

2010-012413
Klamath County, Oregon

AFTER RECORDING, RETURN TO:

This Sp:



00091949201000124130040043

10/20/2010 03:25:27 PM

Fee: \$52.00

Attn: Steven P. Hultberg
Ball Janik LLP
15 SW Colorado, Suite 3
Bend, Oregon 97701

UNTIL A CHANGE IS REQUESTED, ALL TAX
STATEMENTS SHALL BE SENT TO THE
FOLLOWING ADDRESS:

No Change

QUITCLAIM DEED STATUTORY FORM
WATER RIGHTS

Scott D. Chambers and Kellie L. Chambers (hereinafter collectively called "Grantor"), on behalf of themselves, their heirs, successors and assigns hereby releases and quitclaims to Cascade Timberlands (Oregon), LLC (hereinafter called "Grantee"), all right, title and interest in and to the water rights appurtenant to the real property described on the attached Exhibit A. The water rights are more particularly identified as follows:

Water Right Certificate:	13628, issued in the name of the Estate of H.P. Hoey
Use:	Irrigation, 95 Acres
Priority Date:	September 1, 1898
Place of Use:	T24S, R7E, Section 20, 30 acres in SE ¼ of the NW ¼ 34 acres in NE ¼ of the SW ¼ 31 acres in NW ¼ of the SW ¼ A portion of Tax Lot 400, identified as the "Transfer From" portion of Tax Lot 400 on Exhibit B.

In addition to the rights listed herein, the grantor releases all interest in any other water rights that may be later determined as being appurtenant to the subject lands.

The true and actual consideration paid for this transfer is \$524,875.

BEFORE SIGNING OR ACCEPTING THIS INSTRUMENT, THE PERSON TRANSFERRING FEE TITLE SHOULD INQUIRE ABOUT THE PERSON'S RIGHTS, IF ANY, UNDER SECTIONS 2, 3 AND 5 TO 22 OF ENROLLED HOUSE BILL 3540 (MEASURE 49) (2007). THIS INSTRUMENT DOES NOT ALLOW USE OF THE PROPERTY DESCRIBED IN THIS INSTRUMENT IN VIOLATION OF APPLICABLE LAND USE LAWS AND REGULATIONS. BEFORE SIGNING OR ACCEPTING THIS INSTRUMENT, THE PERSON ACQUIRING FEE TITLE TO THE PROPERTY SHOULD CHECK WITH THE APPROPRIATE CITY OR COUNTY PLANNING DEPARTMENT TO VERIFY THAT THE UNIT OF LAND BEING TRANSFERRED IS A LAWFULLY ESTABLISHED LOT OR PARCEL, AS DEFINED IN ORS 92.010 OR 215.010, TO VERIFY THE APPROVED USES OF THE

524Mf

LOT OR PARCEL, TO DETERMINE ANY LIMITS ON LAWSUITS AGAINST FARMING OR FOREST PRACTICES, AS DEFINED IN ORS 30.930, AND TO INQUIRE ABOUT THE RIGHTS OF NEIGHBORING PROPERTY OWNERS, IF ANY, UNDER SECTIONS 2, 3 AND 5 TO 22 OF ENROLLED HOUSE BILL 3540 (MEASURE 49) (2007).

Dated this 7 day of October, 2010.

Scott D. Chambers

SD Chambers

Kellie L. Chambers

Kellie Chambers

STATE OF OREGON)
County of LANE) ss.

The foregoing instrument was acknowledged before me this 7th day of Oct., 2010 by SCOTT D. CHAMBERS



Janet G. Hallyburton
Notary Public for Oregon
My Commission Expires: 10-26-12

STATE OF OREGON)
County of LANE) ss.

The foregoing instrument was acknowledged before me this 7th day of Oct., 2010 by KELLIE L. CHAMBERS

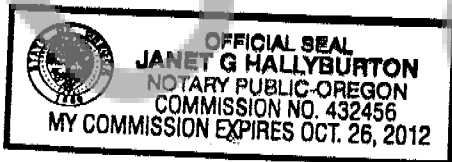

Janet G. Hallyburton
Notary Public for Oregon
My Commission Expires: 10-26-12

AMERITITLE, has recorded this instrument by request as an accomodation only, and has not examined it for regularity and sufficiency or as to its effect upon the title to any real property that may be described therein.

Exhibit A

The SE $\frac{1}{4}$ of the NW $\frac{1}{4}$, Section 20, Township 24 South, Range 7 East of the Willamette Meridian, Klamath County, Oregon

The NE $\frac{1}{4}$ of the SW $\frac{1}{4}$, Section 20, Township 24 South, Range 7 East of the Willamette Meridian, Klamath County, Oregon

The NW $\frac{1}{4}$ of the SW $\frac{1}{4}$, Section 20, Township 24 South, Range 7 East of the Willamette Meridian, Klamath County, Oregon

Unofficial
Copy

EXHIBIT B

Township 24 S Range 7 E, W.M.

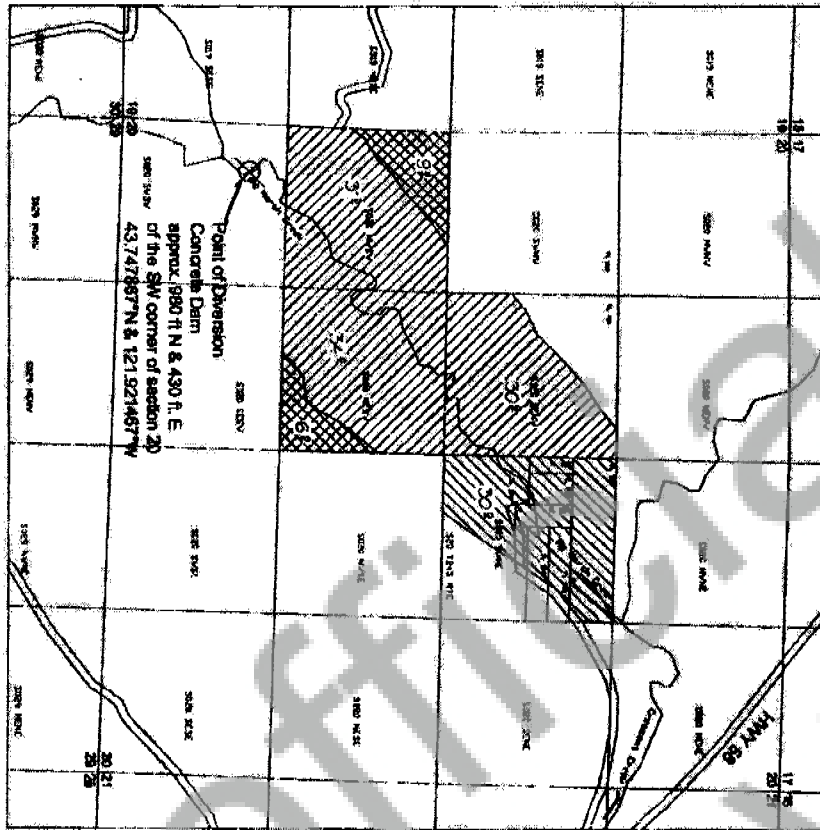

From USGS Crescent Lake Quad
Scale: 1" = 1320 ft

Portion of
Certificate
13628 to
be Conveyed

Transfer From
Certificate #13628
Describes River Decree
in the name of
Estate of H.P. Hoey



Remaining

Certificate #13628
Describes River Decree
in the name of
Estate of H.P. Hoey



Cancelled

Certificate #13628
Describes River Decree
in the name of
Estate of H.P. Hoey

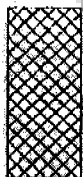

Prepared By
Walter L. Trimmer
CWRE #332
March 24, 2008
P.O.D. added Sept 29, 2008
Remaining acres added
Feb. 10, 2010
Remaining acres added and
Cancelled acres added
June 9, 2010

Trimmer Engineering Inc.

3924 NW Walnut Place
Corvallis, OR 97330
541-754-2819