

2011-001683

Klamath County, Oregon



00096800201100016830030033

02/14/2011 03:32:54 PM

Fee: \$47.00

EASEMENT AGREEMENT

As Required in OAR 340-071-0130

THIS AGREEMENT, made this 14 day of February, 2011, by and between Victoria Hernandez, grantors and Jose E. Hernandez, grantees;

WHEREAS, grantees are the owners of the following described real property in Klamath County, Oregon, to-wit:

PARCEL 41 10 02 DD 6401

SE1/4 SE1/4 SEC 2 T41S R10E W.M.

The grantors do hereby grant and convey to the grantees, their heirs, successors and assigns, a nonexclusive easement described as follows, to-wit:

TO ACCESS SAID PARCEL 41 10 02 DD 6401 TO REPAIR, MAINTAIN, CONSTRUCT OR REMOVE AN EXISTING OUT BUILDING. LOCATED ON THE MOST NORTH PROPERTY LINE OF PARCEL 41 10 02 DD 6500 AS SHOWN ON ATTACHED DRAWING.

(NOTE: Recommend attaching a survey map of the specific easement area.)

subject to liens and encumbrances of record, in and upon the following described real property of grantors in Klamath County, Oregon, to-wit:

Grantors, for themselves and their heirs, successors and assigns, covenant and agree to and with the grantees, their heirs, successors and assigns, that the above-described property of the grantors shall not be used for any conflicting use or purpose detrimental to said system or contrary to laws and rules of governmental agencies applicable or related to said system.

Owners Names Jose E Hernandez and Victoria Hernandez

IN WITNESS WHEREOF, the parties herto have executed this agreement as of the date first hereinabove written.

(Grantors)

(Grantees)

STATE OF OREGON)

County of Klamath) ss.

Feb. 14, 2011)

)

Personally appeared the above-named Jose E Hernandez and Victoria Hernandez, grantors,

and acknowledge the foregoing instrument to be their voluntary act.

Before me:

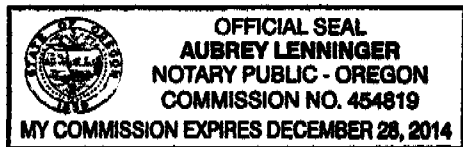

Aubrey Lenninger

NOTARY PUBLIC FOR OREGON

My Commission Expires: 12/28/14

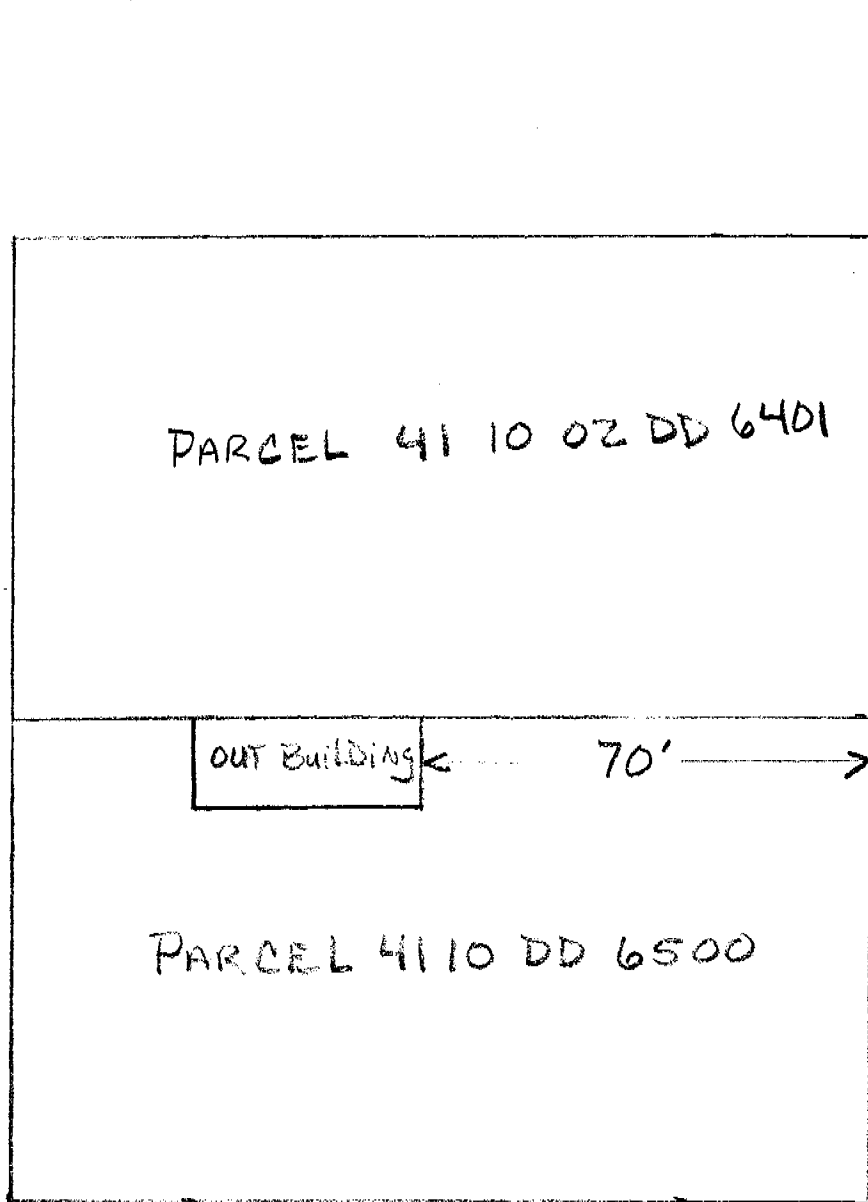

JEFFERSON ST.

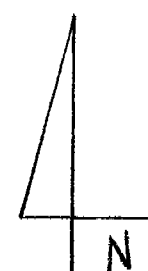

SE 1/4 SE 1/4 SEC 2
THIS RIDE W.M.
MERRILL, OR.
KLAMATH COUNTY

NO SCALE