

2013-010016

Klamath County, Oregon



00141727201300100160030037

09/03/2013 08:44:05 AM

Fee: \$47.00

NOTICE OF PENDENCY

OF AN ACTION

Pursuant to ORS 93.740, the undersigned states:

1. As plaintiff, State of Oregon, by and through its Department of Transportation, has filed an action in the Circuit Court for Klamath County, State of Oregon;
2. The defendants are: AMANDA FERN DAVIS; and CARTER-JONES COLLECTION SERVICE, INC., an Oregon corporation;
3. The object of the action is: To acquire interest(s) in the property described below by Eminent Domain;
4. The description of the real property to be affected is as set out in the Exhibit A attached hereto and by this reference made a part hereof;

Dated this 26 day of August, 2013.

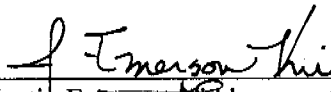
Justin Emerson Kidd
Assistant Attorney General

Name: STATE OF OREGON, by and through its
DEPARTMENT OF TRANSPORTATION, by

Justin Emerson Kidd
Assistant Attorney General

Address: 1162 Court Street NE
Salem, OR 97301

Phone No.: (503) 947-4700

STATE OF OREGON, County of Marion

The foregoing instrument was acknowledged before me this 26th day of August, 2013, by Justin Emerson Kidd.

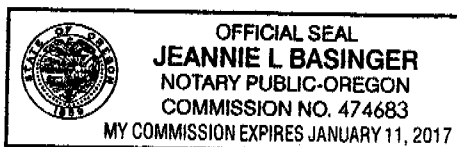

Notary Public for Oregon
My Commission Expires 1-11-17

After Recording Return To:

Oregon Department of Transportation
Right of Way Section - Condemnation Unit
4040 Fairview Industrial Dr SE, MS#2
Salem OR 97302-1142

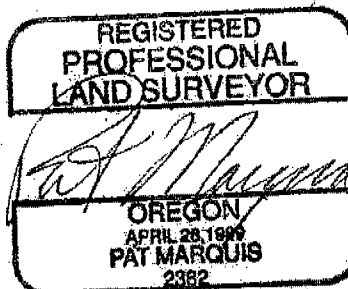

File 7561013
Drawing 11B-6-6
3/15/2012

Parcel 1 – Fee

EXPIRES 12-31-2012

A parcel of land lying in Government Lot 4 of Section 4 and Government Lot 1 of Section 5, Township 38 South, Range 11 East, W.M., Klamath County, Oregon and being a portion of that property described in that Bargain and Sale Deed to David N. Ingerson and Amanda F. Davis, recorded January 5, 2005 in Book M05, Page 00983, Klamath County Record of Deeds; the said parcel being that portion of said property included in a strip of land, variable in width, lying on the Southerly side of the center line of the relocated Klamath Falls – Lakeview Highway, which center line is described as follows:

Beginning at Engineer's center line Station 1361+24.31 P.T., said station being 4,336.33 feet South and 6,481.35 feet West of the East Quarter Corner of Section 33, Township 37 South, Range 11 East, W.M.; thence North 18° 43' 11" East 69.31 feet; thence on a spiral curve right (the long chord of which bears North 21° 35' 02" East 269.73 feet) 270.00 feet; thence on a 900.00 foot radius curve right (the long chord of which bears North 47° 08' 19" East 610.45 feet) 622.81 feet; thence on a spiral curve right (the long chord of which bears North 72° 41' 36" East 269.73 feet) 270.00 feet; thence North 75° 33' 27" East 256.70 feet; thence on a spiral curve right (the long chord of which bears North 78° 05' 14" East 219.83 feet) 220.00 feet; thence on a 830.37 foot radius curve right (the long chord of which bears South 73° 41' 32" East 653.18 feet) 671.31 feet; thence on a spiral curve right (the long chord of which bears South 45° 28' 18" East 219.83 feet) 220.00 feet; thence South 42° 56' 32" East 449.16 feet to Engineer's Station 1391+73.60 P.S. on said center line.

The width in feet of said strip of land is as follows:

Station	to	Station	Width on the Southerly Side of Center Line
1374+57.00		1375+15.00	135.00 in a straight line to 115
1375+15.00		1376+13.12	115.00
1376+13.12		1378+00.00	115.00 in a straight line to 125.00

Bearings are based upon CS 7047, Surveyed Records of Klamath County.

This parcel of land contains 4,403 square feet, more or less.

Parcel 2 – Temporary Easement for Work Area (5 years or duration of Project, whichever comes sooner)

A parcel of land lying in Government Lot 1 of Section 5, Township 38 South, Range 11 East, W.M., Klamath County, Oregon and being a portion of that property described in that Bargain and Sale Deed to David N. Ingerson and Amanda F. Davis, recorded January 5,

2005 in Book M05, Page 00983, Klamath County Record of Deeds; the said parcel being that portion of said property lying between lines at right angle to the center line of the relocated Klamath Falls – Lakeview Highway at Engineer's Stations 1375+50.00 and 1376+40.00 and included in a strip of land, 125.00 feet in width, lying on the Southerly side of said center line, which center line is described in Parcel 1.

EXCEPT therefrom Parcel 1.

This parcel of land contains 868 square feet, more or less.

Parcel 3 – Temporary Easement for Work Area (5 years or duration of Project, whichever comes sooner)

A parcel of land lying in Government Lot 1 of Section 5, Township 38 South, Range 11 East, W.M., Klamath County, Oregon and being a portion of that property described in that Bargain and Sale Deed to David N. Ingerson and Amanda F. Davis, recorded January 5, 2005 in Book M05, Page 00983, Klamath County Record of Deeds; the said parcel being that portion of said property lying Westerly of a line which begins at a point opposite and 280.00 feet Southerly of Engineer's Station 1374+50.00 on the center line of the relocated Klamath Falls – Lakeview Highway; thence Northerly in a straight line to a point opposite and 185.00 feet Southerly of Engineer's Station 1375+00.00 on said center line; thence Northerly in a straight line to a point opposite and 115.00 Southerly of Engineer's Station 1375+00.00 on said center line, which center line is described in Parcel 1.

EXCEPT therefrom Parcel 1.

This parcel of land contains 1,027 square feet, more or less.

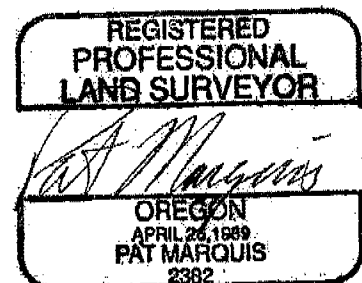

EXPIRES 12-31-2012