

2013-010095**Klamath County, Oregon****09/04/2013 11:16:46 AM****Fee: \$157.00****RECORDING COVER SHEET (Please Print or Type)**

The information on this sheet is a reflection of the attached instrument for the purpose of meeting first page recording requirements, ORS 205.234.

If this cover page is included with your document, please add \$5.00 to the total recording fees.

AFTER RECORDING RETURN TO:

Pacific Connector Gas Pipeline

832 NW Highland Street

Roseburg, OR 97470

1) TITLE(S) OF THE TRANSACTION(S) ORS 205.234(a)

Right-of-Way and Easement

AmeriTitle WAS REQUESTED TO
RECORD THIS INSTRUMENT AS
AN ACCOMMODATION. IT HAS NOT
BEEN EXAMINED FOR SUFFICIENCY
OR ITS EFFECT UPON THE TITLE.

2) DIRECT PARTY / GRANTOR(S) ORS 205.125(1)(b) and 205.160

George M. Whitlock & Hazel B. Whitlock

1122 Hwy 66

Klamath Falls, OR 97601

3) INDIRECT PARTY / GRANTEE(S) ORS 205.125(1)(a) and 205.160

Williams Pacific Connector Gas Operator LLC

PO Box 58900

Salt Lake City, UT 84158-0900

4) TRUE AND ACTUAL CONSIDERATION

ORS 93.030(5) – Amount in dollars or other

\$ 2872.26

☐ Other**5) SEND TAX STATEMENTS TO:**

No Change

6) SATISFACTION of ORDER or WARRANT

ORS 205.125(1)(e)

CHECK ONE: ☐ FULL(If applicable) ☐ PARTIAL**7) The amount of the monetary obligation imposed by the order or warrant. ORS 205.125(1)(c)**

\$

8) If this instrument is being Re-Recorded, complete the following statement, in**accordance with ORS 205.244: "RERECORDED TO CORRECT****PREVIOUSLY RECORDED IN****BOOK _____ AND PAGE _____, OR AS FEE NUMBER _____."**

AmeriTitle CRK1305

**WILLIAMS PACIFIC CONNECTOR GAS OPERATOR LLC
RIGHT-OF-WAY AND EASEMENT**

On this, the 23 day of August, 20 13, for Ten Dollars (\$10.00) and other valuable consideration,

**George M Whitlock and Hazel B Whitlock, initial Trustees of the
George and Hazel Whitlock Trust dated July 13, 2000**

(“Grantor”), whose address is 11212 Hwy 66, Klamath Falls, OR 97601, does hereby grant, sell and convey to **WILLIAMS PACIFIC CONNECTOR GAS OPERATOR LLC**, a Delaware limited liability company, P.O. Box 58900, Salt Lake City, Utah 84158-0900 (“Grantee”), its successors and assigns, an exclusive right-of-way and easement (“Easement”) to locate, survey, construct, entrench, maintain, repair, replace, protect, inspect and operate a pipeline or pipelines, cathodic equipment and/or appurtenances which may be constructed above or below ground including but not limited to valves and metering equipment; electrical and/or communications cable, underground conduit, splicing boxes; and roads (“facilities”) which may be over, under and through the land described below. Grantor warrants that it is the owner in fee simple of the land, situated in the County of Klamath, State of Oregon, to wit:

That certain parcel of land being describe as lying part of the E 1/2 of the NW 1/4 of Section 33, Township 39 South, Range 8 East of the Willamette Meridian, and being more particularly described on the attached Exhibit "A-1"

Also known by County Assessor Parcel Number(s): **R502325**
Map Tax number(s): **R-3908-033B0-02900-000**

A centerline survey description of the pipeline is described in Exhibit “A” attached and made a part of this agreement. The Easement is located approximately along the line that has or shall be designated by Grantee, on a right-of-way 50 (Fifty) feet in width being 25 (Twenty-five) feet on both sides of the centerline of the **36” pipeline** constructed hereunder and which encumbers approximately **0.256** Acres.

This Easement conveys to Grantee the right of ingress and egress to and from, and access on and within said right-of-way, with the right to use existing and future roads for the purposes of surveying, constructing, inspecting, repairing, protecting, operating and maintaining the facilities and the addition, removal or replacement of same at will, either in whole or in part, with either like or different size pipe (“work”). Grantee may use such portions of the property along and adjacent to said right-of-way as may be reasonably necessary during construction of the pipeline, and as clearly defined and shown in Exhibit “A”.

Grantee agrees that within a reasonable time following the completion of its work and subject to weather and/or soil conditions, Grantee shall, as near as practicable, restore said right-of-way to its original contour and condition. Grantee agrees to compensate Grantor adequately for damages which directly result from its work, including loss of business, timber, growing crops, pasture and livestock. Any other recognizable damages to other real or personal property that resulted from its work shall be repaired by Grantee, or the Grantor shall be compensated for such repairs. Grantee shall have the right to cut and to keep clear without payment of damages all trees, brush, native growth or foliage and other

obstructions that may, in the Grantee's opinion, endanger, hinder or conflict with the construction operation, inspection, protection, maintenance and use of said facilities.

Grantee shall possess the above-described rights and Easement, together with all rights necessary to operate, protect and maintain the facilities within the right-of-way granted to the Grantee, its successors and assigns. Grantee may assign the rights and Easement granted under this agreement, either in whole or in part, subject to the terms of this grant, with such rights and Easement deemed to be covenants running with the land and to be binding upon Grantor, its heirs, legal representatives and successors in title.

Grantee may at any time permanently abandon said right-of-way and Easement and, at its discretion, may remove or abandon in place the improvements constructed on it. Upon such abandonment action, Grantee may, at its discretion, execute and record a reconveyance and release of this Easement whereupon this right-of-way and Easement with all rights and privileges mutually granted shall be fully canceled and terminated.

Grantor reserves the right to use and enjoy said property except for the purposes granted in this Easement. Any pipeline constructed by Grantee across lands under cultivation shall, at the time of construction, be buried to a minimum of 5 (five) feet of cover from top of the pipe as not to interfere with such cultivation. Grantor shall have the right to cultivate, work, plow, harvest and use the land granted within the Easement so long as it shall not hinder, conflict or interfere with Grantee's surface or subsurface rights or disturb its ability to operate, maintain and protect its facilities. No road, reservoir, excavation, change in surface grade, obstruction or structure shall be constructed, created or maintained within the described Easement area.

Grantee shall indemnify and hold Grantor harmless from and against any and all loss, damage, or injury which may result from the construction, operation and maintenance of the facilities; provided, however, that said loss, damage, or injury does not arise out of or result from the actions of the Grantor, (his/her) agents or employees.

Grantor agrees to indemnify Grantee against any environmental liability that predates the date of this Easement or that was caused solely by the Grantor's actions or inactions.

Grantee shall have the right to discharge or redeem for Grantor, in whole or in part, any mortgage, tax or other lien on said land and shall be subrogated to such lien and rights.

It is mutually understood and agreed that this Easement and the attached exhibits, as written, cover and include all of the agreements and stipulations between the parties and that no representations or statements, verbal or written, have been made modifying, adding to or changing the terms of this agreement.

The terms, conditions and provisions of this agreement shall extend to and be binding upon the heirs, executors, administrators, personal representatives, successors and assigns of the parties.

IN WITNESS WHEREOF the parties have EXECUTED THIS CONVEYANCE AND AGREEMENT THIS 23 DAY OF August, 20 13.

GRANTOR:

Hazel B Whitlock
Hazel B Whitlock, Trustee and Guardian

GRANTOR:

Michael Whitlock
Michael Whitlock, Guardian of
George M Whitlock

**WILLIAMS PACIFIC CONNECTOR GAS
OPERATOR LLC**

(GRANTEE):

DA Randall
David Randall, Attorney in Fact

Tract #(s): KH-626.000
The rest of this page is left intentionally blank.

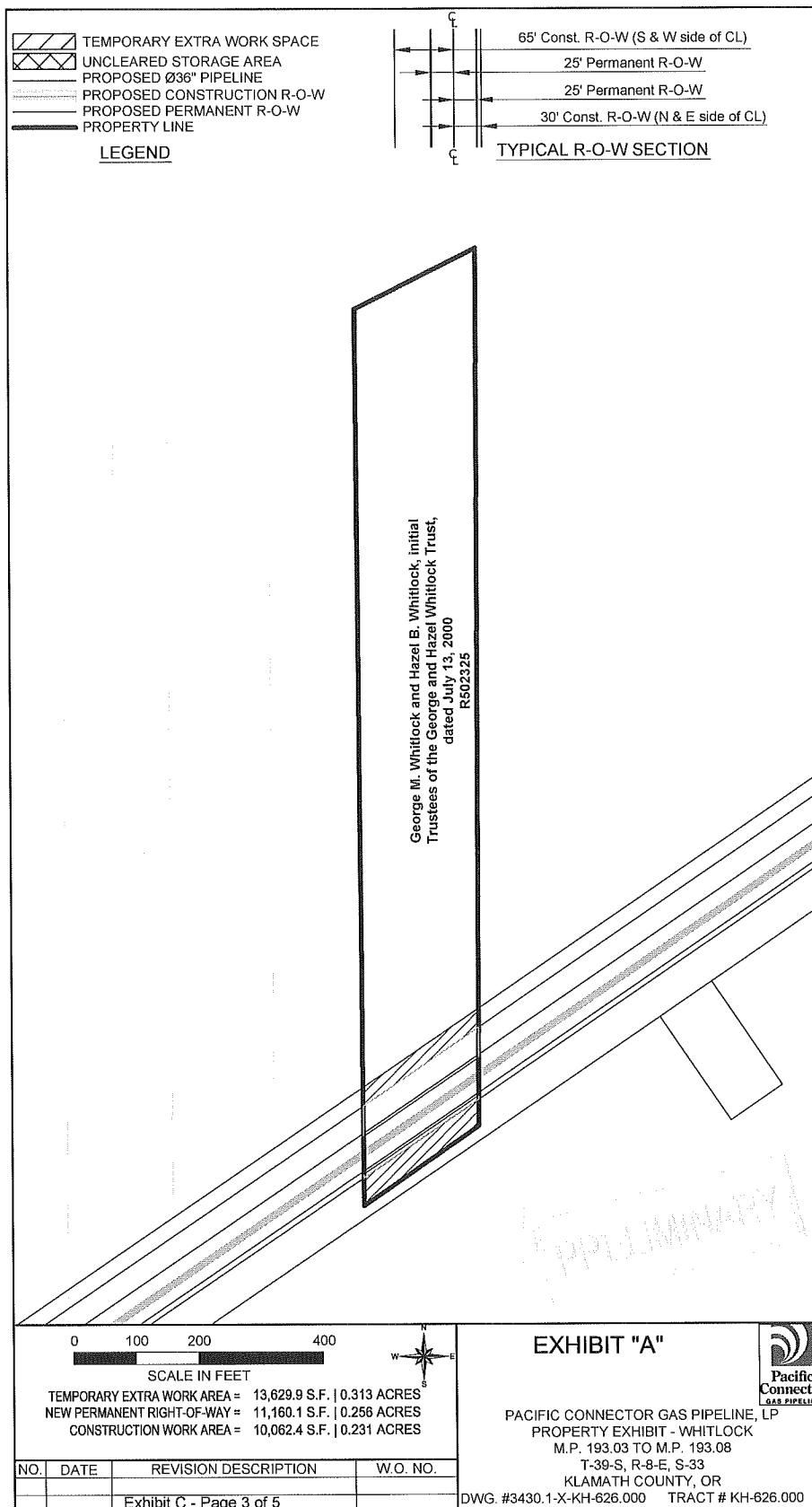

EXHIBIT "A-1"

Beginning at the Southerly line of the Klamath Falls-Ashland Highway at a point which is South 135 feet from the quarter corner common to Sections 28 and 33, Township 39 South, Range 8 East of the Willamette Meridian, in the County of Klamath, State of Oregon; thence South 61 degrees 56 minutes West 374 feet along the Southerly line of said Highway to a stake; thence South 1514.3 feet to a stake on the Northerly right-of-way line of the Weyerhaeuser Logging Railroad; thence North 54 degrees 12 minutes East 406.85 feet along said right of way line to an iron pin on the East line of said East half of Northwest quarter; thence North 1451.7 feet along said East line to the point of beginning, being in the East half of the Northwest quarter of Section 33, Township 39 South, Range 8 East of the Willamette Meridian.

SAVE AND EXCEPTING the following described tract: Beginning on the Southerly line of the Klamath Falls-Ashland Highway at a point which is South 135 feet from the quarter corner common to Sections 28 and 33 Township 39 South, Range 8 East of the Willamette Meridian; thence South 61 degrees 56 minutes West 219 feet along the Southerly line of said Highway to the TRUE POINT OF BEGINNING; thence continuing South 61 degrees 56 minutes West along the Southerly line of said Highway a distance of 155 feet; thence South 1514.30 feet to a stake on the Northerly right-of-way line of the Weyerhaeuser Logging Road; thence North 54 degrees 12' minutes East 173.85 feet along said right-of-way line to a point; thence North 0 degrees 01 minutes West 1485.53 feet to the TRUE POINT OF BEGINNING, and being on the E1/2 of the NW1/4 of Section 33, Township 39 South, Range 8 East of the Willamette Meridian.

ACKNOWLEDGMENT

State of OREGON

County Of Clatsop

This instrument was acknowledged before me on Aug 23, 2013 by Hazel B Whitlock
as trustees of The George and Hazel Whitlock Trust dated
July 13 2000

Melissa E Nichols
Notary Public

My Commission Expires:

May 28 2015

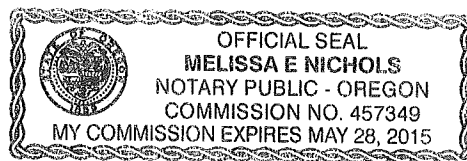

ACKNOWLEDGMENT

State of OREGON

County Of Clatsop

This instrument was acknowledged before me on Aug 23, 2013 by George M Whitlock
as TRUSTEE of The George and Hazel Whitlock Trust. Dated
July 13 2000

Melissa E Nichols
Notary Public

My Commission Expires:

May 28 2015

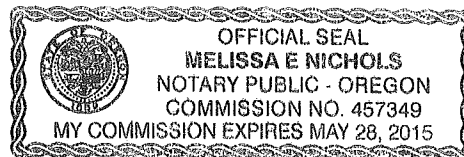

ACKNOWLEDGMENT

State of OREGON

County Of Jackson

This instrument was acknowledged before me on August 30, 2013 by David Randall
as Attorney-in-Fact of Williams Pacific Connector Gas Operator LLC.

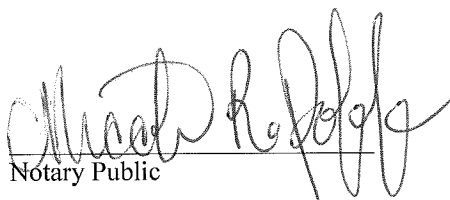
Notary Public

My Commission Expires:

6/6/2017

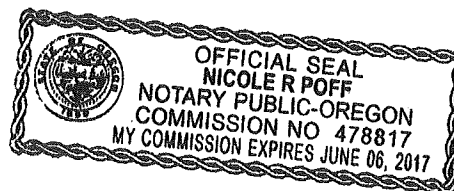

CONSTRUCTION WORKSPACE AGREEMENT

For Ten Dollars (\$10.00) and other valuable consideration,

**George M Whitlock and Hazel B Whitlock, initial Trustees of the
George and Hazel Whitlock Trust dated July 13, 2000**

Whose address is 11212 Hwy 66, Klamath Falls, OR 97601 ("Grantor") does grant to **WILLIAMS PACIFIC CONNECTOR GAS OPERATOR, LLC**, a Delaware limited liability company, located at P.O. Box 58900, Salt Lake City, Utah 84158 ("Grantee"), its agents, contractors and employees, the right and privilege of using a parcel of land for the purpose of constructing a 36" Natural Gas Pipeline ("construction workspace"), which property is situated in Klamath County, State of Oregon, and more particularly described below:

That certain parcel of land being describe as lying part of the E 1/2 of the NW 1/4 of Section 33, Township 39 South, Range 8 East of the Willamette Meridian, and being more particularly described on the attached Exhibit "A-1".

Also known by County Assessor Parcel Number(s): **R502325**

Map Tax number(s): **R-3908-033B0-02900-000**

The approximate location of the construction workspace is designated on Exhibit "A" attached hereto and made a part of this agreement.

It is understood and agreed by Grantor and Grantee that said construction workspace is to be used in connection with the construction of Grantee's natural gas pipeline facilities. Upon completion of the above described work and final restoration of the construction workspace, Grantee's interest in said land will revert to Grantor, except as provided by separate instrument.

Grantee agrees that within a reasonable time following the completion of its work and subject to weather and/or soil conditions, will as near as practicable restore said construction workspace to its original contours. Grantee will compensate Grantor for adequately documented damages, directly resulting from its work (i.e. loss of business, timber, growing crops, pasture and livestock). Damages to other real or personal property will be repaired by Grantee or the Grantor will be compensated for such repairs. Specific conditions, which will apply to the initial construction of facilities, are described in Exhibit "B" attached hereto and made a part of this agreement.

Grantee will possess the above-described rights and such rights will be binding upon Grantor, its heirs, legal representatives and successors in title.

Grantee will not be held liable for damages of any kind that arise due to the negligent acts or willful misconduct of the Grantor, its successors, assigns, permittee, agents or contractors.

WITNESS THE EXECUTION THIS _____ day of _____, 20 ____

GRANTOR:

GRANTOR:

Hazel B Whitlock, Trustee
and Guardian

Michael Whitlock, Guardian of
George M Whitlock

GRANTEE:

Williams Pacific Connector Gas
Operator LLC

David Randall, Attorney in Fact

Tract #(s): KH-626.000
The rest of this page is left intentionally blank.

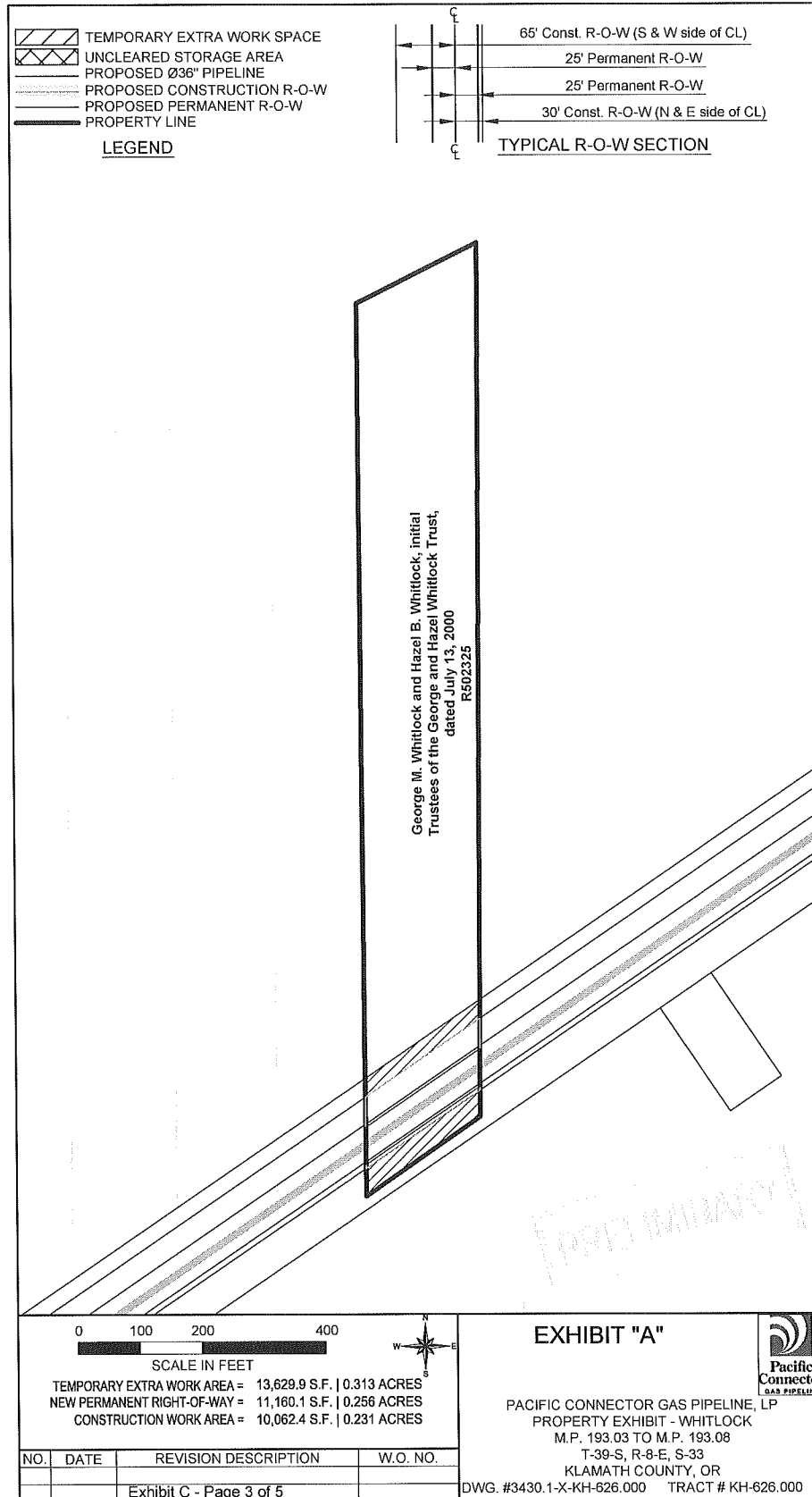

EXHIBIT "A-1"

Beginning at the Southerly line of the Klamath Falls-Ashland Highway at a point which is South 135 feet from the quarter corner common to Sections 28 and 33, Township 39 South, Range 8 East of the Willamette Meridian, in the County of Klamath, State of Oregon; thence South 61 degrees 56 minutes West 374 feet along the Southerly line of said Highway to a stake; thence South 1514.3 feet to a stake on the Northerly right-of-way line of the Weyerhaeuser Logging Railroad; thence North 54 degrees 12 minutes East 406.85 feet along said right of way line to an iron pin on the East line of said East half of Northwest quarter; thence North 1451.7 feet along said East line to the point of beginning, being in the East half of the Northwest quarter of Section 33, Township 39 South, Range 8 East of the Willamette Meridian.

SAVE AND EXCEPTING the following described tract: Beginning on the Southerly line of the Klamath Falls-Ashland Highway at a point which is South 135 feet from the quarter corner common to Sections 28 and 33 Township 39 South, Range 8 East of the Willamette Meridian; thence South 61 degrees 56 minutes West 219 feet along the Southerly line of said Highway to the TRUE POINT OF BEGINNING; thence continuing South 61 degrees 56 minutes West along the Southerly line of said Highway a distance of 155 feet; thence South 1514.30 feet to a stake on the Northerly right-of-way line of the Weyerhaeuser Logging Road; thence North 54 degrees 12' minutes East 173.85 feet along said right-of-way line to a point; thence North 0 degrees 01 minutes West 1485.53 feet to the TRUE POINT OF BEGINNING, and being on the E1/2 of the NW1/4 of Section 33, Township 39 South, Range 8 East of the Willamette Meridian.

EXHIBIT "B"

CONSTRUCTION STIPULATIONS

In accordance with the terms and conditions of the agreement, the Grantor and Grantee agree that the natural gas pipeline facilities will be constructed on Grantor's property in accordance with the following terms and conditions:

1. At least 180 days prior to any construction related activity, Grantee will begin settlement of damage and access consideration. The rights provided by this Agreement cannot be exercised until damages and access are settled. If said damages and access cannot be mutually agreed upon a third-party independent appraisal, selected by the Grantor, will determine the just compensation. Once the third-party appraisal has been identified Grantee may then exercise the rights provided by this Agreement.
2. Grantee will notify Grantor, in writing, of the construction activity ___ days prior to start of survey and via phone or in writing, at least ___ days prior to the clearing/tree removal and construction preparation of the right of way on the Grantor's land.
3. Grantee will construct its pipeline and related facilities in compliance with engineering design and safety standards of the USDOT in force at the time of construction.
4. Grantee will remove all construction waste and debris after completion of construction activities.
5. Grantee will restore the property after construction to as close to the original condition as is practical.
6. Grantee will re-seed disturbed areas along ROW with a seed mix native to the area or as specified by the Grantor.
7. Grantee will restore all access roads or driveways disturbed by construction to condition equal to or better than existed prior to construction. Restoration will include final grading where necessary.
8. Grantee will protect all survey monuments located within the ROW. In the event survey monuments are disturbed and/or destroyed, it will be the responsibility of the Grantee to re-establish and survey monuments in conformity with survey standards then currently established for the State of Oregon.

ACKNOWLEDGMENT

State of OREGON

County Of _____

This instrument was acknowledged before me on _____, 2013 by _____

as _____ of _____.

Notary Public

My Commission Expires:

ACKNOWLEDGMENT

State of OREGON

County Of _____

This instrument was acknowledged before me on _____, 2013 by _____

as _____ of _____.

Notary Public

My Commission Expires:

ACKNOWLEDGMENT

State of OREGON

County Of _____

This instrument was acknowledged before me on _____, 2013 by _____
as Attorney-in-Fact of Williams Pacific Connector Gas Operator LLC.

My Commission Expires:

Notary Public

*Certified
True Copy*

IN THE CIRCUIT COURT OF THE STATE OF OREGON
FOR THE COUNTY OF KLAMATH

In the Matter of the Guardianship and
Conservatorship of:

GEORGE MELVIN WHITLOCK,

Respondent.

Case No. 13-02801CV

**NOTICE OF PETITION TO
APPOINT TEMPORARY AND
PERMANENT GUARDIANS**

**TO: Hazel Whitlock
11212 Hwy 66
Klamath Falls, OR 97601**

This Notice serves to inform you that, on July 19, 2013, *HAZEL WHITLOCK, of 11212 Hwy 66, Klamath Falls, OR 97601, (541) 883-8415*, the wife of the Respondent, and *MICHAEL WHITLOCK, 11028 River St. of Keno, OR, 97627, (541) 884-2679*, the son of the Respondent, filed a petition to appoint temporary and permanent guardians of the above-captioned incapacitated adult. A copy of the Petition is attached hereto. On July 23, 2013, the court signed the order appointing a temporary guardians and conservators, a copy of which is attached hereto.

Any objections to the Petition must be made in writing and must be filed with the Klamath County Circuit Court, 316 Main Street, Klamath Falls, OR 97601, within twenty-one (21) days from August 19, 2013, the date this Notice is served. If you file an objection, a hearing will be held.

If you have any questions, you should see an attorney immediately. If you need help in finding an attorney, you may call the Oregon State Bar's Lawyer Referral Service at (503) 684-3763 or toll-free in Oregon at (800) 452-7636.

1 **NOTICE:** If you wish to receive copies of future filings in this case, you must
2 inform the court and the attorney for the persons named as petitioners in this Notice. You
3 must inform the court by filing a request for notice and paying any applicable fees. The
4 request for notice must be in writing, must clearly indicate that you wish to receive future
5 filings in the proceedings and must contain your name, address, and phone number. You
6 must notify the persons named as petitioners by mailing a copy of the request to
7 petitioners' attorney. Unless you take these steps, you will receive no further copies of the
8 filings in this case.
9

10 DATED this 5 day of August, 2013.

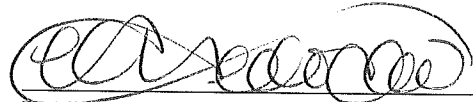

VALERIE B. HEDRICK, OSB No. 073991
Attorney for Co-Petitioners,
HAZEL WHITLOCK and
MICHAEL WHITLOCK

*Certified
True Copy*

IN THE CIRCUIT COURT OF THE STATE OF OREGON
FOR THE COUNTY OF KLAMATH

In the Matter of the Guardianship and
Conservatorship of:

Case No. 13- CV

GEORGE MEVIN WHITLOCK,
Respondent.

**PETITION FOR APPOINTMENT
OF TEMPORARY AND
PERMANENT GUARDIAN AND
CONSERVATOR**

Co-Petitioners, HAZEL WHITLOCK and MICHAEL WHITLOCK, allege:

1.

The following information required by ORS 125.055 is given with regard to the
Respondent, the Co-Petitioners, and the proposed guardians:

Respondent's Information:

Name	George Mevin Whitlock
Age	85 years
DOB	Segregated
Address	11212 Hwy 66, Klamath Falls, OR 97601

Co-Petitioner's (Proposed Co-Guardian's) Information:

Name	HAZEL WHITLOCK
DOB	Segregated
Age	82 years
Address	11212 Hwy 66, Klamath Falls, OR 97601
Interest	Proposed Co-Guardian and Co-Conservator
Relationship	Spouse

///

///

///

1	Name	MICHAEL WHITLOCK
2	DOB	Segregated
3	Age	50 years
4	Address	PO Box 94 Keno, OR 97627
	Interest	Proposed Co-Guardian and Co-Conservator
	Relationship	Son

2.

The proposed guardians have never been convicted of a crime. The proposed guardians have never filed for or received protection under the bankruptcy laws. The proposed guardians have never had a license revoked or canceled that was required by law of any state for the practice of an occupation or profession.

3.

The proposed guardians are willing and able to serve as the Respondent's guardians.

4.

The appointment of guardians and conservators is sought because the Respondent is incapacitated. The guardianship and conservatorship is necessary to promote and protect the well-being of Respondent. There is an immediate and serious danger to the life and health of Respondent and the welfare of the Respondent requires immediate action.

5.

The facts that support this request for a guardianship and conservatorship are as follows:

(a) Respondent's mental health has declined to the point where he is unable to make decisions for himself and has great memory loss.

(b) Respondent's mental health has declined to the point where he is now violent and is a danger to himself and others, is often unaware of what he is doing.

(c) Respondent's mental health has declined to the point where he can no longer take care of his basic needs, such as proper nutrition, personal hygiene, or other day-to-day tasks.

6.

The persons entitled to notice of this petition are as follows:

Name	Hazel Whitlock
Address	11212 Hwy 66, Klamath Falls, OR 97601
Current Location	11212 Hwy 66, Klamath Falls, OR 97601

Name	Michael Whitlock
Address	P.O. Box 94, Keno, OR 97627
Current Location	Keno, Oregon

7.

There has not been a fiduciary appointed for the Respondent by a court of any state. Respondent currently has a trust, of which Co-Petitioner, HAZEL WHITLOCK, is the Co-Trustee.

8.

The *Respondent's treating physician* and other care providers are:

Name	Dr. Edward Trobaugh
Address	Klamath Open Door Family Practice 2074 S 6th St, Klamath Falls, OR 97601
Telephone	(541) 851-8110

9.

The following is a list of all persons who have information that the Respondent is incapacitated:

Name	Dr. Edward Trobaugh
Address	Klamath Open Door Family Practice 2074 S 6th St, Klamath Falls, OR 97601
Telephone	(541) 851-8110

Name	Hazel Whitlock
Address	11212 Hwy 66, Klamath Falls, OR 97601
Current Location	11212 Hwy 66, Klamath Falls, OR 97601

///

Name	Michael Whitlock
Address	P.O. Box 94, Keno, OR 97627
Current Location	Keno, Oregon

Name	Julie Wood, Social Worker
Address	Tuality Geriatric Psychiatric Center 335 SE 8th Ave. Hillsboro, OR 97123
Current Location	Tuality Geriatric Psychiatric Center 335 SE 8th Ave. Hillsboro, OR 97123

10.

The proposed guardians and conservators do intend to place the Respondent in a nursing home or other residential facility.

11.

The proposed guardians are not a public or private agency or organization that provides the services in the preceding paragraph.

12.

The proposed guardians will exercise control over the Respondent's estate. The Respondent's estate consists of a single family residence, two lots of land, and checking and saving accounts with a total approximate value of \$26,500. The Respondent has no monthly income. The guardian and conservator, HAZEL WHITLOCK, will be holding money of the Respondent in the amount of approximately \$26,500.00 at the time of appointment, as all money belongs jointly to her and Respondent.

13.

Pursuant to ORS 125.055(3), a visitor must be appointed in this proceeding. Co-Petitioners propose that a visitor be appointed.

///

///

///

14.

Venue for this proceeding lies in Klamath County because the Respondent lives in this county and has lived in this county continuously for the last several years. No other court in the state of Oregon, or any other state, has acquired jurisdiction in this matter.

15.

Co-Petitioners request that no bond be required.

WHEREFORE, Co-Petitioners move for an order:

- a) Appointing a court visitor;
- b) Waiving any bond;
- c) Waiving any pre-appointment notice requirement of ORS 125.605;
- d) Appointing HAZEL WHITLOCK and MICHAEL WHITLOCK as temporary guardians for GEORGE MEVIN WHITLOCK; and,
- e) Directing letters of guardianship be issued to HAZEL WHITLOCK and MICHAEL WHITLOCK.

Dated this 18 day of July, 2013.

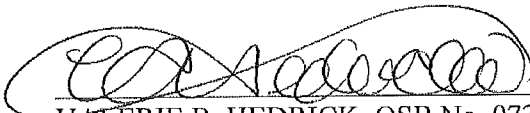
VALERIE B. HEDRICK, OSB No. 073991
Attorney for Co-Petitioners, HAZEL
WHITLOCK and MICHAEL WHITLOCK

I, HAZEL WHITLOCK, have read the foregoing Petition and the content is true and correct to the best of my knowledge.

HAZEL WHITLOCK, Co-Petitioner

I, HAZEL WHITLOCK, have read the foregoing Petition and the content is true and correct to the best of my knowledge.

MICHAEL WHITLOCK, Co-Petitioner

Guardians / Co-Petitioners:

HAZEL WHITLOCK

11212 Hwy 66

Klamath Falls, OR 97601

MICHAEL WHITLOCK

P.O. Box 94

Keno, OR 97627

Certified
True Copy

RECEIVED
JUL 23 2013
13th Judicial District

IN THE CIRCUIT COURT OF THE STATE OF OREGON
FOR THE COUNTY OF KLAMATH

In the Matter of the Guardianship and
Conservatorship of:

GEORGE MEVIN WHITLOCK,
Respondent.

Case No. 13-02801 CV

**ORDER APPOINTING
TEMPORARY GUARDIANS AND
CONSERVATORS**

This matter came before the Court on the Petition for Appointment of Temporary and Permanent Guardian and Conservator for GEORGE MEVIN WHITLOCK, and it appearing to the court from the allegations of the petition, and all other records and files herein, that:

The clear and convincing evidence shows that:

1. Venue is proper in this court, and no other court in this or any other state has acquired jurisdiction in this matter.
2. All notices required by ORS 125.060 have been given to the persons entitled to notice.
3. Respondent is an adult in need of a guardian and the appointment of a guardian and conservator is necessary as a means of providing continuing care and supervision of the Respondent. There is an immediate and serious danger to the Respondent's life or health and the Respondent's welfare requires immediate action.
4. HAZEL WHITLOCK and MICHAEL WHITLOCK are qualified and suitable persons to act as guardians and are willing to serve.

1 NOW THEREFORE, IT IS HEREBY ORDERED THAT:

- 2 1. HAZEL WHITLOCK and MICHAEL WHITLOCK are appointed as temporary
3 guardians and conservators for GEORGE MEVIN WHITLOCK, without bond;
4
5 2. Letters of temporary guardianship and conservatorship shall be issued to HAZEL
6 WHITLOCK and MICHAEL WHITLOCK; and,
7
8 3. A visitor in Hillsboro, Oregon shall be appointed.

DATED this 23 day of July, 2013.

/s/Dan Bunch

CIRCUIT COURT JUDGE

11 Respectfully Submitted By:

12 VALERIE B. HEDRICK, OSB No. 073991

13 533 Main Street • Klamath Falls, OR 97601

14 Phone: (541) 205-5501 • Fax: (541) 205-5503

15 Email: valerie@hedricklawoffice.com

16 Attorney for Co-Petitioners, HAZEL WHITLOCK and MICHAEL WHITLOCK

IN THE CIRCUIT COURT OF THE STATE OF OREGON
FOR THE COUNTY OF KLAMATH

In the Matter of the Guardianship and
Conservatorship of :

GEORGE MELVIN WHITLOCK

Respondent.

Case No. 13- 02801CV

CERTIFICATE OF SERVICE

On this 10 day of August, 2013, I certify that I served the foregoing **Notice of
Petition to Appoint Temporary and Permanent Guardian, Petition for Appointment of
Permanent Guardian and Conservator, and Order Appointing Temporary Guardians and
Conservators** by placing a certified true copy thereof in a sealed envelope, postage prepaid, and
depositing the same in the United States Mail at Klamath Falls, Oregon, addressed as follows:

**Hazel Whitlock
11212 Hwy 66
Klamath Falls, OR 97601**

DATED this 10 day of August, 2013.



MIRANDA D. LARSON, OSB #121064
Attorney at Law