

NOTICE OF PENDENCY
OF AN ACTION



11/16/2013 10:28:06 AM Fee: \$42.00

Pursuant to ORS 93.740, the undersigned states:

1. As plaintiff, State of Oregon, by and through its Department of Transportation, has filed an action in the Circuit Court for Klamath County, State of Oregon;
2. The defendants are: UNKNOWN HEIRS AND DEVISEES OF ANN B. PAYNE, DECEASED,
3. The object of the action is: To acquire interest(s) in the property described below by Eminent Domain;
4. The description of the real property to be affected is as set out in the Exhibit A attached hereto and by this reference made a part hereof;

DATED this 31 day of October, 2013.



JILL SCHNEIDER
Senior Assistant Attorney General

Name: STATE OF OREGON, by and through its
DEPARTMENT OF TRANSPORTATION, by

Jill Schneider
Senior Assistant Attorney General
Address: 1515 SW Fifth Avenue, Suite 410
Portland, OR 97201
Phone No.: (971) 673-1880

STATE OF OREGON, County of Multnomah

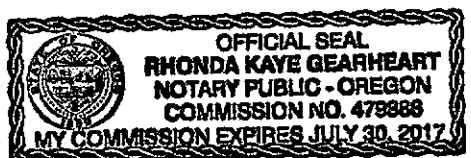
The foregoing instrument was acknowledged before me this 31st day of October, 2013, by Jill
Schneider.

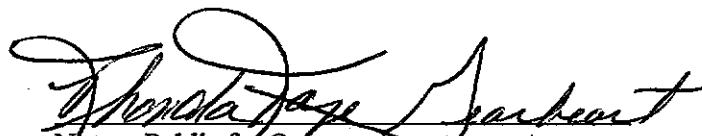

Notary Public for Oregon
My Commission Expires 7/30/17

After Recording Return To:
Oregon Department of Transportation
Right of Way Section - Condemnation Unit
4040 Fairview Industrial Dr SE, MS#2
Salem OR 97302-1142

Fee

A parcel of land lying in the W $\frac{1}{2}$ NE $\frac{1}{4}$ of Section 15, Township 37 South, Range 11 East, W.M., Klamath County, Oregon and being a portion of that property described in that Warranty Deed to Ann B. Payne, recorded June 4, 1973, in Book M73, Page 6679, Klamath County Record of Deeds; the said parcel being that portion of said property lying Southeasterly of the center line of the relocated Klamath Falls - Lakeview Highway, TOGETHER WITH that portion of said property included in a strip of land, variable in width, lying Northwesternly of said center line, which center line is described as follows:

Beginning at Engineer's center line Station 1635+00.00 P.O.T., said station being 244.49 feet South and 198.21 feet East of the North Quarter corner of Section 22, Township 37 South, Range 11 East, W.M.; thence North 11° 40' 22" East 386.31 feet; thence on a spiral curve left (the long chord of which bears North 11° 00' 22" East 159.99 feet) 160.00 feet; thence on a 2,291.83 foot radius curve left (the long chord of which bears North 5° 56' 12" East 298.67 feet) 298.89 feet; thence on a spiral curve left (the long chord of which bears North 0° 52' 02" East 159.99 feet) 160.00 feet; thence North 0° 12' 02" East 2,106.38 feet; thence on a spiral curve right (the long chord of which bears North 2° 35' 16" East 299.79 feet) 300.00 feet; thence on a 1,200.00 foot radius curve right (the long chord of which bears North 35° 10' 20" East 1,119.68 feet) 1,164.89 feet; thence on a spiral curve right (the long chord of which bears North 67° 45' 25" East 299.79 feet) 300.00 feet; thence North 70° 08' 38" East 907.65 feet to Engineer's Station 1692+84.12 P.S. on said center line.

The width in feet of said strip of land is as follows:

Station	to	Station	Width on the Northwesternly Side of Center Line
1675+00.00		1678+00.00	80.00 in a straight line to 90.00
1678+00.00		1680+76.47	90.00 in a straight line to 120.00

Bearings are based upon CS 7047, Surveyed Records of Klamath County.

This parcel of land contains 27,131 square feet, more or less.

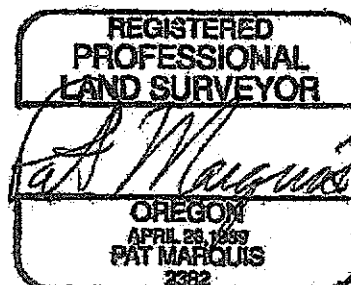

Expires 12-31-2012