

2014-000551

Klamath County, Oregon



00147560201400005510030031

01/22/2014 09:40:46 AM

Fee: \$52.00

CASE: 1204675 CV

NOTICE OF PENDENCY

OF AN ACTION

Pursuant to ORS 93.740, the undersigned states:

1. As plaintiff, State of Oregon, by and through its Department of Transportation, has filed an action in the Circuit Court for Klamath County, State of Oregon;
2. The defendants are: BRETT RICHARD STUBBS; CARTER-JONES COLLECTION SERVICE, INC., an Oregon corporation; and KLAMATH COUNTY, a political subdivision of the State of Oregon;
3. The object of the action is: To acquire interest(s) in the property described below by Eminent Domain;
4. The description of the real property to be affected is as set out in the Exhibit A attached hereto and by this reference made a part hereof;

Dated this 27 day of December, 2013.

Justin Emerson Kidd
Assistant Attorney General

Name: STATE OF OREGON, by and through its
DEPARTMENT OF TRANSPORTATION, by

Justin Emerson Kidd
Assistant Attorney General

Address: 1162 Court Street NE
Salem, OR 97301

Phone No.: (503) 947-4700

STATE OF OREGON, County of Marion

The foregoing instrument was acknowledged before me this 27th day of December, 2013, by Justin Emerson Kidd.

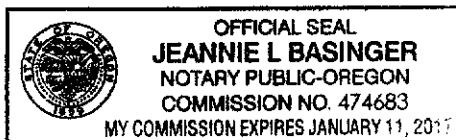

Notary Public for Oregon
My Commission Expires 1-11-17

After Recording Return To:

Oregon Department of Transportation
Right of Way Section - Condemnation Unit
4040 Fairview Industrial Dr SE, MS#2
Salem OR 97302-1142

Parcel 1 – Fee

A parcel of land lying in the SW $\frac{1}{4}$ NE $\frac{1}{4}$ of Section 4, Township 38 South, Range 11 East, W.M., Klamath County, Oregon and being a portion of that property described in that Warranty Deed to Kevin Bruce, recorded November 16, 2006 in Book 2006, Page 022974, Klamath County Record of Deeds; the said parcel being that portion of said property included in a strip of land, variable in width, lying on the Northerly side of the center line of the relocated Klamath Falls – Lakeview Highway, which center line is described as follows:

Beginning at Engineer's center line Station 1387+24.44 P.T., said station being 3,752.54 feet South and 4,407.60 feet West of the East Quarter Corner of Section 33, Township 37 South, Range 11 East, W.M.; thence South 42° 56' 32" East 449.16 feet; thence on a spiral curve right (the long chord of which bears South 42° 29' 32" East 120.00 feet) 120.00 feet; thence on a 2,546.48 foot radius curve right (the long chord of which bears South 38° 59' 56" East 230.42 feet) 230.50 feet; thence on a spiral curve right (the long chord of which bears South 35° 30' 21" East 120.00 feet) 120.00 feet; thence South 35° 03' 21" East 309.71 feet; thence on a spiral curve left (the long chord of which bears South 37° 33' 20" East 199.85 feet) 200.00 feet; thence on a 763.94 foot radius curve left (the long chord of which bears South 87° 52' 07" East 1,086.26 feet) 1,208.35 feet; thence on a spiral curve left (the long chord of which bears North 41° 49' 05" East 199.85 feet) 200.00 feet; thence North 39° 19' 06" East 9.31 feet; thence on a spiral curve right (the long chord of which bears North 41° 49' 05" East 199.85 feet) 200.00 feet; thence on a 763.94 foot radius curve right (the long chord of which bears North 73° 03' 30" East 675.53 feet) 699.73 feet; thence on a spiral curve right (the long chord of which bears South 75° 42' 05" East 199.85 feet) 200.00 feet; thence South 73° 12' 06" East 573.07 feet to Engineer's Station 1432+44.27 P.S. on said center line.

The width in feet of said strip of land is as follows:

Station	to	Station	Width on the Northerly Side of Center Line
1421+75.00		1423+00.00	100.00 in a straight line to 87.00

Bearings are based upon CS 7047, Surveyed Records of Klamath County.

This parcel of land contains 342 square feet, more or less.

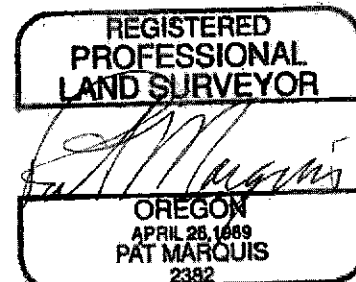

EX PARS 12-31-2012

Parcel 2 – Temporary Easement for Work Area (5 years or duration of Project, whichever comes sooner)

A parcel of land lying in the SW $\frac{1}{4}$ NE $\frac{1}{4}$ of Section 4, Township 38 South, Range 11 East, W.M., Klamath County, Oregon and being a portion of that property described in that Warranty Deed to Kevin Bruce, recorded November 16, 2006 in Book 2006, Page 022974, Klamath County Record of Deeds; the said parcel being that portion of said property included in a strip of land, variable in width, lying on the Northerly side of the center line of the relocated Klamath Falls – Lakeview Highway, which center line is described in Parcel 1.

The width in feet of said strip of land is as follows:

Station	to	Station	Width on the Northerly Side of Center Line
1421+50.00		1421+95.00	130.00 in a straight line to 135.00
1421+95.00		1422+05.00	135.00 in a straight line to 70.00

This parcel of land contains 869 square feet, more or less.

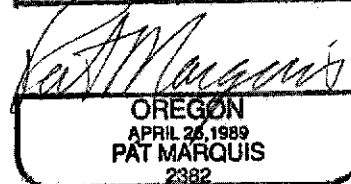

EXPIRES 4-26-2012