



BOARD OF COUNTY COMMISSIONERS
KLAMATH COUNTY, OREGON

IN THE MATTER OF AMENDING)
THE COMPREHENSIVE PLAN)
TEXT, GENERAL LAND USE)
PLAN MAP, AND LAND)
DEVELOPMENT CODE TEXT TO)
MAKE CHANGES 1-6 AS)
FOLLOWS:)
ORDINANCE 44.98

- 1. AMEND THE COMPREHENSIVE PLAN TO CREATE A NEW TRAIN PARK LAND USE DESIGNATION.
- 2. AMEND THE LAND DEVELOPMENT CODE BY ADDING A NEW TRAIN PARK ZONE.
- 3. AMEND THE LAND DEVELOPMENT CODE ARTICLE 83.030 TO ALLOW PLANNED UNIT DEVELOPMENTS IN THE TRAIN PARK ZONE.
- 4. AMEND COMPREHENSIVE PLAN, GOAL 2, POLICY 10 AS TO ALLOW A PUD IN A TRAIN PARK ZONE.
- 5. ADOPT AN EXCEPTION TO GOAL 4 (FORESTRY) AND GOAL 14 (URBANIZATION) TO CHANGE THE PLAN MAP DESIGNATION ON 129.14 ACRES FROM FORESTRY TO TRAIN PARK TO ALLOW A MINIATURE RAILROAD CONNECTED RURAL RESIDENTIAL COMMUNITY.
- 6. ADOPT AN EXCEPTION TO GOAL 4 (FORESTRY) TO CHANGE THE PLAN MAP DESIGNATION ON 39.29 ACRES FROM FORESTRY TO TRAIN PARK FOR THE TRAIN PARK SUPPORT AREA;

WHEREAS, the Klamath County Board of Commissioners has the authority and desires to amend the Comprehensive Plan, General Land Use Plan Map, and Land Development Code text; and

WHEREAS, the Klamath County Planning Department provided written notice of the public hearing as required in KC Land Development Code Article 31; and

WHEREAS, a public hearing was held on February 25, 2014, and public testimony was considered before the Klamath County Planning Commission and Board of County Commissioners; and

WHEREAS the Klamath County Planning Commission recommended that the meeting be continued until March 25, 2014, and

WHEREAS, the Klamath County Board of Commissioners voted to continue the meeting until March 25, 2014; and

WHEREAS, on March 25, 2014, based on testimony entered and in consideration of the whole record, the Klamath County Board of Commissioners voted unanimously to approve the request; and

NOW, THEREFORE, the Klamath County Board of Commissioners ordains that the amendments to the adopted Klamath County Comprehensive text and General Land Use Plan Map and Land Development Code text, as included in Applicant's Application - Exhibit "1," and incorporated herein by reference are hereby adopted.

1. ***The Klamath County Comprehensive Plan - General Land Use Plan Map is amended as shown on attached Exhibit A.***

DATED this 1st day of April, 2014.

FOR THE BOARD OF COMMISSIONERS

Chairman

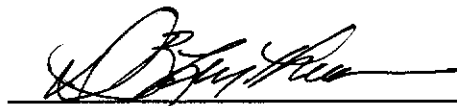
Commissioner

Commissioner

 3/31/2014
County Counsel
Approved as to form

NOTICE OF APPEAL RIGHTS

This decision may be appealed to the Oregon Land Use Board of Appeals (LUBA) within 21-days following the date of the mailing of this order. Contact LUBA for information as how to file this appeal (LUBA by phone 1-503-373-1265 or by mail at 550 Capitol Street NE, Suite 235, Salem Oregon 97301-2552). Failure to do so in a timely manner may affect your rights.



Approved Plan Map Designation - Train Park

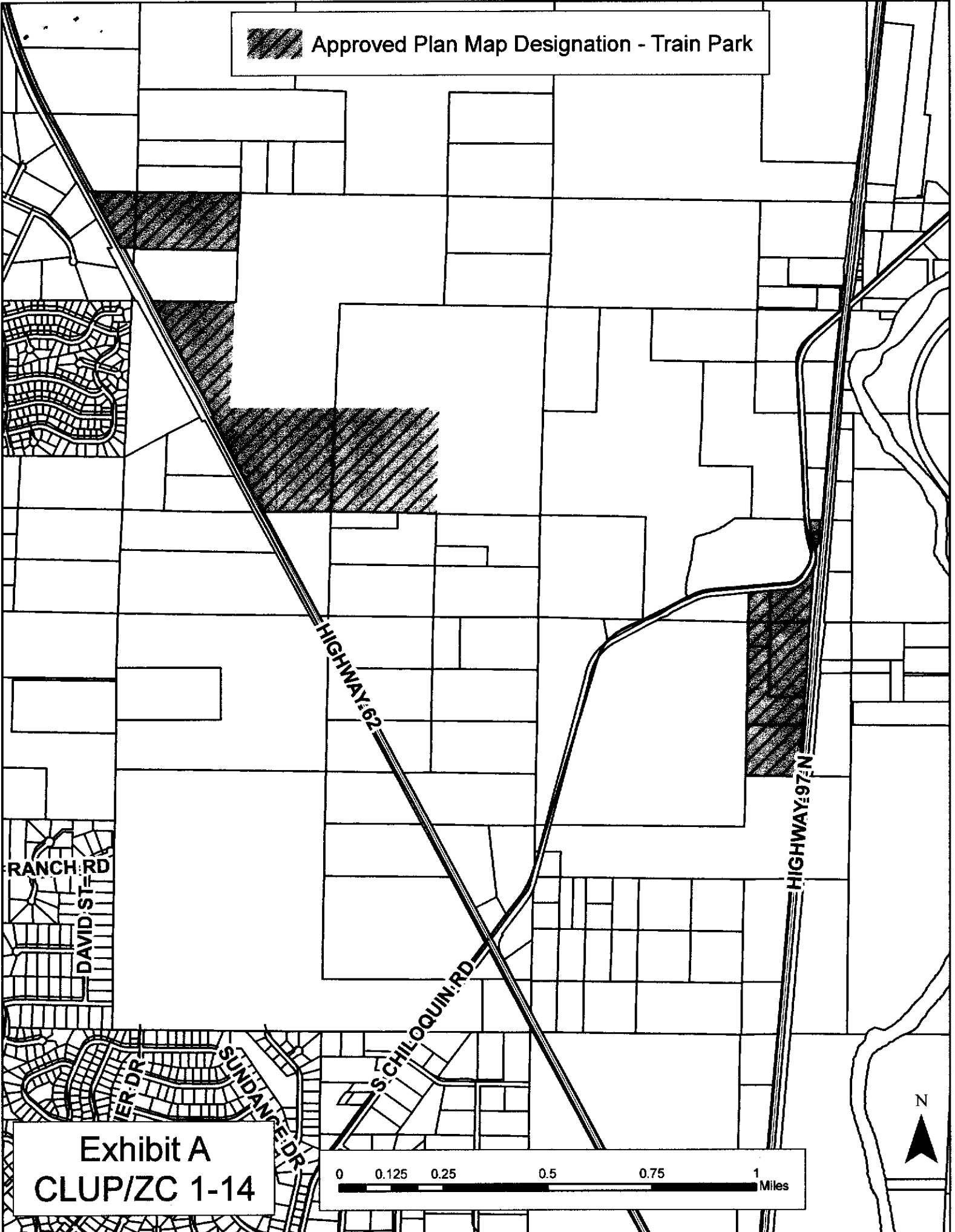

Exhibit A
CLUP/ZC 1-14

0 0.125 0.25 0.5 0.75 1 Miles

