

BLS NO PART OF ANY STEVENS-NESS FORM MAY BE REPRODUCED IN ANY FORM OR BY ANY ELECTRONIC OR MECHANICAL MEANS



2015-004996
Klamath County, Oregon



00169616201500049960010017

05/15/2015 10:42:31 AM

Fee: \$42.00

SPACE RESERVED
FOR
RECORDER'S USE

Ronald D. Briery/Sandra K. Briery
1587 Bigham-Brown Rd.
Eagle Point, OR 97524

Grantor's Name and Address

Michael Leo Moreland
15580 Hwy. 392
Greeley, CO 80631

Grantee's Name and Address

After recording, return to (Name and Address):
Michael Leo Moreland
15580 Hwy. 392
Greeley, CO 80631

Until requested otherwise, send all tax statements to (Name and Address):
Michael Leo Moreland
15580 Hwy. 392
Greeley, CO 80631

BARGAIN AND SALE DEED

KNOW ALL BY THESE PRESENTS that Ronald D. Briery and Sandra K. Briery

hereinafter called grantor, for the consideration hereinafter stated, does hereby grant, bargain, sell and convey unto Michael Leo Moreland

hereinafter called grantee, and unto grantee's heirs, successors and assigns, all of that certain real property, with the tenements, hereditaments and appurtenances thereunto belonging or in any way appertaining, situated in Klamath County, State of Oregon, described as follows (legal description of property):

Lot 23, Block 8, Fox Hollow, according to the official plat thereof on file of the County Clerk of Klamath County, Oregon. *in the office SKB*

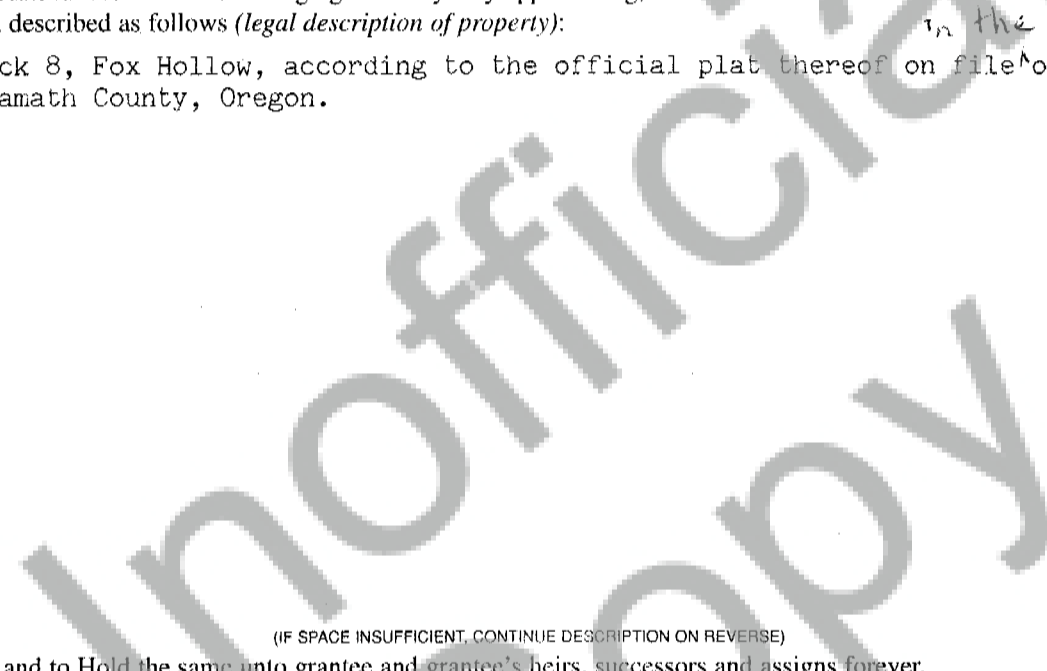

(IF SPACE INSUFFICIENT, CONTINUE DESCRIPTION ON REVERSE)

To Have and to Hold the same unto grantee and grantee's heirs, successors and assigns forever.

The true and actual consideration paid for this transfer, stated in terms of dollars, is \$ 1200.00. However, the actual consideration consists of or includes other property or value given or promised which is part of the the whole (indicate which) consideration. (The sentence between the symbols ®, if not applicable, should be deleted. See ORS 93.030.)

In construing this instrument, where the context so requires, the singular includes the plural, and all grammatical changes shall be made so that this instrument shall apply equally to businesses, other entities and to individuals.

IN WITNESS WHEREOF, grantor has executed this instrument on 15 MAY 2015; any signature on behalf of a business or other entity is made with the authority of that entity.

BEFORE SIGNING OR ACCEPTING THIS INSTRUMENT, THE PERSON TRANSFERRING FEE TITLE SHOULD INQUIRE ABOUT THE PERSON'S RIGHTS, IF ANY, UNDER ORS 195.300, 195.301 AND 195.305 TO 195.336 AND SECTIONS 5 TO 11, CHAPTER 424, OREGON LAWS 2007, SECTIONS 2 TO 9 AND 17, CHAPTER 855, OREGON LAWS 2009, AND SECTIONS 2 TO 7, CHAPTER 8, OREGON LAWS 2010. THIS INSTRUMENT DOES NOT ALLOW USE OF THE PROPERTY DESCRIBED IN THIS INSTRUMENT IN VIOLATION OF APPLICABLE LAND USE LAWS AND REGULATIONS. BEFORE SIGNING OR ACCEPTING THIS INSTRUMENT, THE PERSON ACQUIRING FEE TITLE TO THE PROPERTY SHOULD CHECK WITH THE APPROPRIATE CITY OR COUNTY PLANNING DEPARTMENT TO VERIFY THAT THE UNIT OF LAND BEING TRANSFERRED IS A LAWFULLY ESTABLISHED LOT OR PARCEL, AS DEFINED IN ORS 92.010 OR 215.010, TO VERIFY THE APPROVED USES OF THE LOT OR PARCEL, TO DETERMINE ANY LIMITS ON LAWSUITS AGAINST FARMING OR FOREST PRACTICES, AS DEFINED IN ORS 30.930, AND TO INQUIRE ABOUT THE RIGHTS OF NEIGHBORING PROPERTY OWNERS, IF ANY, UNDER ORS 195.300, 195.301 AND 195.305 TO 195.336 AND SECTIONS 5 TO 11, CHAPTER 424, OREGON LAWS 2007, SECTIONS 2 TO 9 AND 17, CHAPTER 855, OREGON LAWS 2009, AND SECTIONS 2 TO 7, CHAPTER 8, OREGON LAWS 2010.

R. D. Briery
Sandra K. Briery

STATE OF OREGON, County of Klamath ss. May 15, 2015

This instrument was acknowledged before me on May 15, 2015
by Ronald D. Briery and Sandra K. Briery

This instrument was acknowledged before me on _____
by _____
as _____
of _____

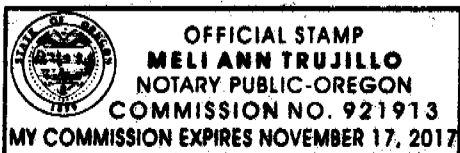

Meli Ann Trujillo
Notary Public for Oregon
My commission expires 11-17-2017