

2015-005164

Klamath County, Oregon



00169824201500051640070070

RETURN ADDRESS

WILLIAMS PACIFIC CONNECTOR GAS OPERATOR LLC
3709 CITATION WAY, SUITE 102
MEDFORD, OR 97504

05/20/2015 03:30:17 PM

Fee: \$72.00

DOCUMENT TITLE(S): RIGHT-OF-WAY AND EASEMENT

REFERENCE NUMBERS(S) OF RELATED DOCUMENTS

GRANTOR(S)

LLOYD V. HOWARD

GRANTEE(S)

WILLIAMS PACIFIC CONNECTOR GAS OPERATOR LLC, A DELAWARE LIMITED LIABILITY COMPANY ON
BEHALF OF PACIFIC CONNECTOR GAS PIPELINE L.P., A DELAWARE LIMITED PARTNERSHIP

LEGAL DESCRIPTION

THAT CERTAIN PARCEL OF LAND KNOWN AS PARCEL NO. 2 OF MINOR LAND PARTITION 32-90, LYING IN
THE E2 OF SECTION 20, TOWNSHIP 39 SOUTH, RANGE 9 EAST OF THE WILLAMETTE MERIDIAN,
KLAMATH COUNTY, OREGON, BEING MORE FULLY DESCRIBED IN THE ATTACHED EXHIBIT "A-1".

ASSESSOR'S PROPERTY TAX PARCEL/ACCOUNT NUMBER

R872807

W2015OR 12010

72-

**WILLIAMS PACIFIC CONNECTOR GAS OPERATOR LLC
RIGHT-OF-WAY AND EASEMENT**

For valuable consideration, Lloyd V. Howard ("Grantor") whose address is 7430 Tingley Ln, Klamath Falls, OR 97603 does hereby grant, sell and convey to WILLIAMS PACIFIC CONNECTOR GAS OPERATOR LLC, a Delaware limited liability company on behalf of Pacific Connector Gas Pipeline L.P., a Delaware limited partnership, P.O. Box 58900, Salt Lake City, Utah 84158-0900 ("Grantee"), its successors and assigns, a right-of-way and easement ("Easement") to locate, survey, construct, entrench, maintain, repair, replace, protect, inspect and operate a pipeline, cathodic equipment and/or appurtenances which may be constructed above or below ground, including but not limited to, valves and metering equipment; electrical and/or communications cable, underground conduit, splicing boxes; and roads ("facilities") which may be over, under and through the land described below. Grantor warrants that it is the owner in fee simple of the land situated in the County of Klamath, State of Oregon, to wit:

That certain parcel of land known as Parcel No. 2 of Minor Land Partition 32-90, lying in the E2 of Section 20, Township 39 South, Range 9 East of the Willamette Meridian, Klamath County, Oregon, being more fully described in the attached Exhibit "A-1".

Also known by County Assessor Parcel Number(s):

R872807

A centerline survey description and depiction of the pipeline is set forth in Exhibit "A" attached and made a part of this agreement. The Easement is located approximately along the line that has or shall be designated by Grantee, on a right-of-way 50 (Fifty) feet in width being 25 (Twenty-five) feet on each side of the centerline of the **36" pipeline** as constructed and which encumbers approximately 1.086 acres.

This Easement conveys to Grantee the right of ingress and egress to and from the facilities over and through the Property, and access on and within the right-of-way, with the right to use existing and future roads on the Property for the purposes of surveying, constructing, inspecting, repairing, protecting, operating and maintaining the facilities and the addition, removal or replacement of the same at will, either in whole or in part, with either like or different size pipe ("work"). Grantee may use such portions of the property along and adjacent to said right-of-way as may be reasonably necessary during construction of the facilities, and as clearly defined and shown in Exhibit "A".

Grantee agrees that within a reasonable time following the completion of its work and subject to weather and/or soil conditions, Grantee shall, as near as practicable, restore said right-of-way to its original contour and condition. Grantee will adhere to the construction stipulations as defined in the Construction Stipulation Agreement dated 5-14-2015. Grantee agrees to compensate Grantor adequately for damages that directly result from its work, including but not limited to, timber, growing crops, pasture and livestock and is more clearly defined in the Damage Agreement dated N/A. Any other recognizable damages to other real or personal property that result from its work shall be repaired by Grantee, or the Grantor shall be compensated for such repairs. Grantee shall have the right to cut and to keep clear without payment of damages all trees, brush, native growth or foliage and other obstructions that may, in the Grantee's opinion, endanger, hinder or conflict with the construction operation, inspection, protection, maintenance and use of said facilities.

Grantee shall possess the above-described rights, together with all rights necessary to operate, protect and maintain the facilities within the right-of-way granted to the Grantee, its successors and assigns. Grantee may assign the rights granted under this agreement, either in whole or in part, subject to the terms

of this agreement, with such rights deemed to be covenants running with the land and to be binding upon Grantor, its heirs, legal representatives and successors in title.

Grantee may at any time permanently abandon said Easement and, at its sole discretion, may remove or abandon in place the improvements constructed on it. Upon such abandonment action, Grantee may, at its discretion, execute and record a reconveyance and release of this Easement whereupon this Easement with all rights and privileges mutually granted shall be fully canceled and terminated.

Grantor reserves the right to use and enjoy said property except for the purposes granted in this Easement and the limitations on Grantor's use set forth herein. Any pipeline constructed by Grantee across lands under cultivation shall, at the time of construction, be buried with a minimum of 5 (five) feet of cover from top of the pipe so as not to interfere with such cultivation. Grantor shall have the right to cultivate, work, plow, harvest and use the land granted within the Easement so long as it shall not hinder, conflict or interfere with Grantee's surface or subsurface rights, including its right to cut and keep clear the Easement area as set forth above, or disturb its ability to operate, maintain and protect its facilities. No road, reservoir, excavation, change in surface grade, obstruction or structure shall be constructed, created or maintained within the described Easement area.

Grantee shall indemnify and hold Grantor harmless from and against any and all loss, damage, or injury which may result from the construction, operation and maintenance of the facilities; provided, however, that said loss, damage, or injury does not arise out of or result from the actions of the Grantor, (his/her) agents or employees.

Grantor agrees to indemnify Grantee against any environmental liability that predates the date of this Easement or that was caused solely by the Grantor's actions or inactions.

Grantee shall have the right to discharge or redeem for Grantor, in whole or in part, any mortgage, tax or other lien on said land and shall be subrogated to such lien and rights.

It is mutually understood and agreed that this Easement and the attached exhibits, as written, cover and include all of the agreements between the parties except as may otherwise be provided in a Construction Stipulation Agreement and Damage Agreement and that no representations or statements, verbal or written, have been made modifying, adding to or changing the terms of this Easement.

The terms, conditions and provisions of this agreement shall extend to and be binding upon the heirs, executors, administrators, personal representatives, successors and assigns of the parties.

IN WITNESS WHEREOF the parties have EXECUTED THIS CONVEYANCE AND AGREEMENT THIS 14th DAY OF May, 20 15.

GRANTOR:

Lloyd V. Howard
Lloyd V. Howard

GRANTEE:

**WILLIAMS PACIFIC CONNECTOR
GAS OPERATOR LLC**, on behalf of
Pacific Connector Gas Pipeline L.P.

Peggie Labrum
Peggie Labrum, Attorney in Fact

ACKNOWLEDGMENT

STATE OF OREGON)
COUNTY OF KLAMATH)ss.

BEFORE ME, the undersigned authority, on this 14th day of MAY, 2015, personally appeared Lloyd V. Howard, to me known to be the individuals described in and who executed the foregoing instrument, and acknowledged to me that they signed the said instrument as their free and voluntary act and deed for the uses and purposes therein mentioned.

WITNESS my hand and official seal hereto affixed the day and year in this certificate above written.



[Signature]
Notary Public in and for the
State of Oregon

My Commission Expires: February 23, 2019

COUNTY OF

)SS.

Donna Gay Taylor

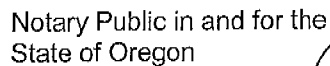

My Commission Expires:

August 10, 2018

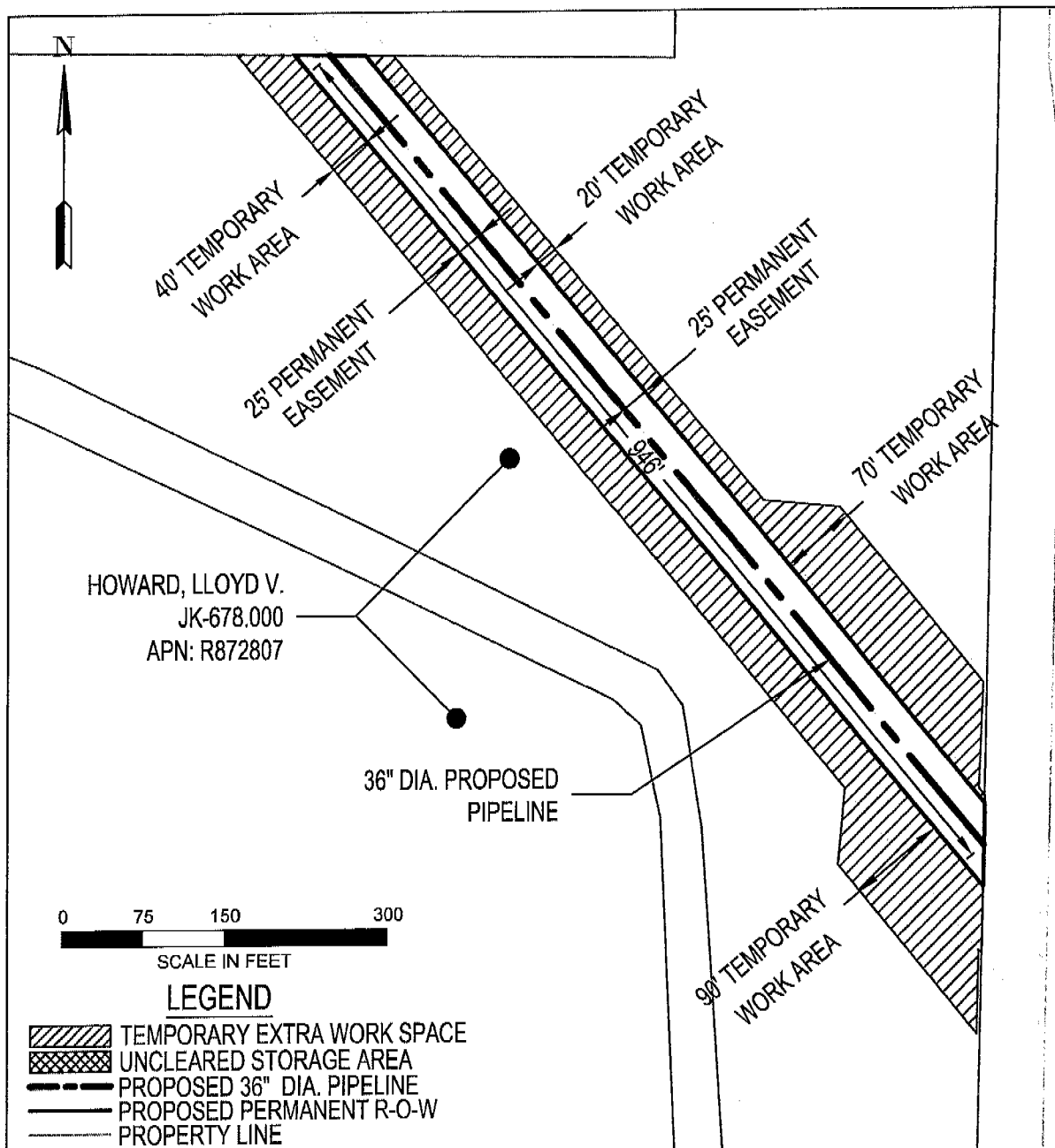

AREA TOTALS		
	SQ. FT.	ACRES.
PERM. R-O-W:	47308.95	1.086
TEMP. EXTRA WORK AREA:	81819.83	1.878
UNCLEARED STORAGE AREA:	0.0	0.0
DRAWN:TAD DATE:05-01-2015		
CHECK:GMP DATE:05-01-2015		
APPRV: DATE:		

EXHIBIT "A"

PACIFIC CONNECTOR GAS PIPELINE, LP
RIGHT-OF-WAY DETAIL

Howard, Lloyd V

M.P. 200.82 TO M.P. 200.99

T-39 S, R-9 E, S-20

KLAMATH COUNTY, OREGON

DRAWING NO: 3430.33-X-KH-678.000



EXHIBIT "A-1"

Parcel No. 2 of Minor Land Partition 32-90, said Land Partition situated in the E1/2 of Section 20, Township 39 South, Range 9 East, Willamette Meridian, in Klamath County, Oregon; EXCEPTING THEREFROM USBR C-4-E Lateral.