

2015-009343

Klamath County, Oregon



00174870201500093430100108

08/21/2015 02:21:43 PM

Fee: \$87.00

Returned at Counter

**RETURN ADDRESS**

WILLIAMS PACIFIC CONNECTOR GAS OPERATOR LLC  
3709 CITATION WAY, SUITE 102  
MEDFORD, OR 97504

**DOCUMENT TITLE(S): CONSTRUCTION STIPULATIONS AGREEMENT**

**REFERENCE NUMBERS(S) OF RELATED DOCUMENTS**

**GRANTOR(S)**

WASSER & WINTERS COMPANY, A WASHINGTON CORPORATION

**GRANTEE(S)**

WILLIAMS PACIFIC CONNECTOR GAS OPERATOR LLC, A DELAWARE LIMITED LIABILITY COMPANY ON  
BEHALF OF PACIFIC CONNECTOR GAS PIPELINE L.P., A DELAWARE LIMITED PARTNERSHIP

**LEGAL DESCRIPTION**

THAT CERTAIN PARCEL, OR PARCELS OF LAND LYING IN THE S2 NE4 AND SE4 NW4 OF SECTION 4,  
TOWNSHIP 38 SOUTH, RANGE 5 EAST, OF THE WILLAMETTE MERIDIAN, KLAMATH COUNTY, OREGON  
AND BEING MORE PARTICULARLY DESCRIBED ON THE ATTACHED EXHIBIT "A-1".

**ASSESSOR'S PROPERTY TAX PARCEL/ACCOUNT NUMBER**

R70979

W2015OR 12031

## CONSTRUCTION STIPULATIONS AGREEMENT

For valuable consideration, Wasser & Winters Company, a Washington Corporation ("Grantor") whose address is PO Box 396, Longview, WA 98632, does grant to WILLIAMS PACIFIC CONNECTOR GAS OPERATOR, LLC, a Delaware limited liability company, on behalf of Pacific Connector Gas Pipeline, L.P., a Delaware limited partnership, located at P.O. Box 58900, Salt Lake City, Utah 84158 ("Grantee"), its agents, contractors and employees, the right and privilege of using a parcel of land for the purpose of constructing a 36" Natural Gas Pipeline ("construction workspace"), which property is situated in Klamath County, State of Oregon, and more particularly described below:

That certain parcel, or parcels of land lying in the S2 NE4 and SE4 NW4 of Section 4, Township 38 South, Range 5 East, of the Willamette Meridian, Klamath County, Oregon and being more particularly described on the attached Exhibit "A-1".

Also known by County Assessor Parcel Number(s): **R70979**

The approximate location of the construction workspace is designated on Exhibit "A" attached hereto and made a part of this agreement.

It is understood and agreed by Grantor and Grantee that said construction workspace is to be used in connection with the construction of Grantee's natural gas pipeline facilities. Upon completion of the above described work and final restoration of the construction workspace, Grantee's interest in said land will revert to Grantor, except as provided by the right-of-way and easement dated August 11, 2015

Grantee agrees that within a reasonable time following the completion of its work and subject to weather and/or soil conditions, Grantee will as near as practicable restore said construction workspace to its original contours. Grantee will compensate Grantor for adequately documented damages, directly resulting from its work including timber, growing crops, pasture and livestock. Damages to other real or personal property will be repaired by Grantee or the Grantor will be compensated for such repairs. Specific conditions, which will apply only to the initial construction of facilities, are described in Exhibit "B" attached hereto and made a part of this agreement.

The term of this construction stipulation agreement begins upon execution and expires five years from that date.

Grantee will possess the above-described rights and such rights will be binding upon Grantor, its heirs, legal representatives and successors in title.

Grantee will not be held liable for damages of any kind that arise due to the negligent acts or willful misconduct of the Grantor, its successors, assigns, permittee, agents or contractors.

WITNESS THE EXECUTION THIS 11<sup>th</sup> day of Aug, 20 15

GRANTOR:

Jess Winters  
Jess Winters, President

GRANTOR:

Marsha Galloway  
Marsha Galloway, Secretary

GRANTEE:

Williams Pacific Connector Gas  
Operator LLC, on behalf of Pacific  
Connector Gas Pipeline L.P.

Peggie Labrum  
Peggie Labrum, Attorney in Fact

ACKNOWLEDGMENT

Washington  
STATE OF OREGON )  
COUNTY OF Cowlitz ) ss.

BEFORE ME, the undersigned authority, on this 11<sup>th</sup> day of August, 2015, personally appeared Jess Winters as President of Wasser & Winters Company, to me known to be the individuals described in and who executed the foregoing instrument, and acknowledged to me that they signed the said instrument as their free and voluntary act and deed for the uses and purposes therein mentioned.

WITNESS my hand and official seal hereto affixed the day and year in this certificate above written.



Joyce A. Donaldson  
Notary Public in and for the  
State of Oregon Washington  
My Commission Expires: July 17, 2017

ACKNOWLEDGMENT

STATE OF Washington )  
COUNTY OF Cowlitz ) ss.

BEFORE ME, the undersigned authority, on this 11<sup>th</sup> day of August, 2015, personally appeared Marsha Galloway as Secretary of Wasser & Winters Company, to me known to be the individuals described in and who executed the foregoing instrument, and acknowledged to me that they signed the said instrument as their free and voluntary act and deed for the uses and purposes therein mentioned.

WITNESS my hand and official seal hereto affixed the day and year in this certificate above written.



Joyce A. Donaldson  
Notary Public in and for the  
State of Oregon Washington  
My Commission Expires: July 17, 2017

ACKNOWLEDGMENT ATTORNEY-IN-FACT

STATE OF OREGON )  
COUNTY OF Jackson ) ss.

On the 17<sup>th</sup> day of August, 2015, Peggie Labrum personally appeared before me and being by me duly sworn, did say that she is the Attorney-in-Fact of Williams Pacific Connector Gas Operator LLC, on behalf of Pacific Connector Gas Pipeline L.P., and that the Agreement was signed on behalf of Williams Pacific Connector Gas Operator LLC, on behalf of Pacific Connector Gas Pipeline L.P., and said to me that as such Attorney-in-Fact she executed the same.

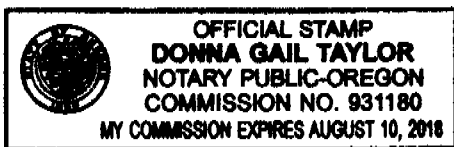

Donna Gail Taylor  
Notary Public in and for the  
State of Oregon  
My Commission Expires: August 10, 2018

## EXHIBIT "B"

### CONSTRUCTION STIPULATIONS

In accordance with the terms and conditions of this agreement, the Grantor and Grantee agree that the natural gas pipeline facilities will be constructed on Grantor's property in accordance with the following terms and conditions:

1. Grantee will notify Grantor, in writing, of the construction activity 30 days prior to start of survey and via phone or in writing, at least 30 days prior to the clearing/tree removal and construction preparation of the right of way on the Grantor's land.
2. Grantee will construct its pipeline and related facilities in compliance with engineering design and safety standards of the USDOT in force at the time of construction.
3. Grantee will remove all construction waste and debris after completion of construction activities.
4. Grantee will restore all access roads or driveways disturbed by construction to condition equal to or better than existed prior to construction. Restoration will include final grading where necessary.

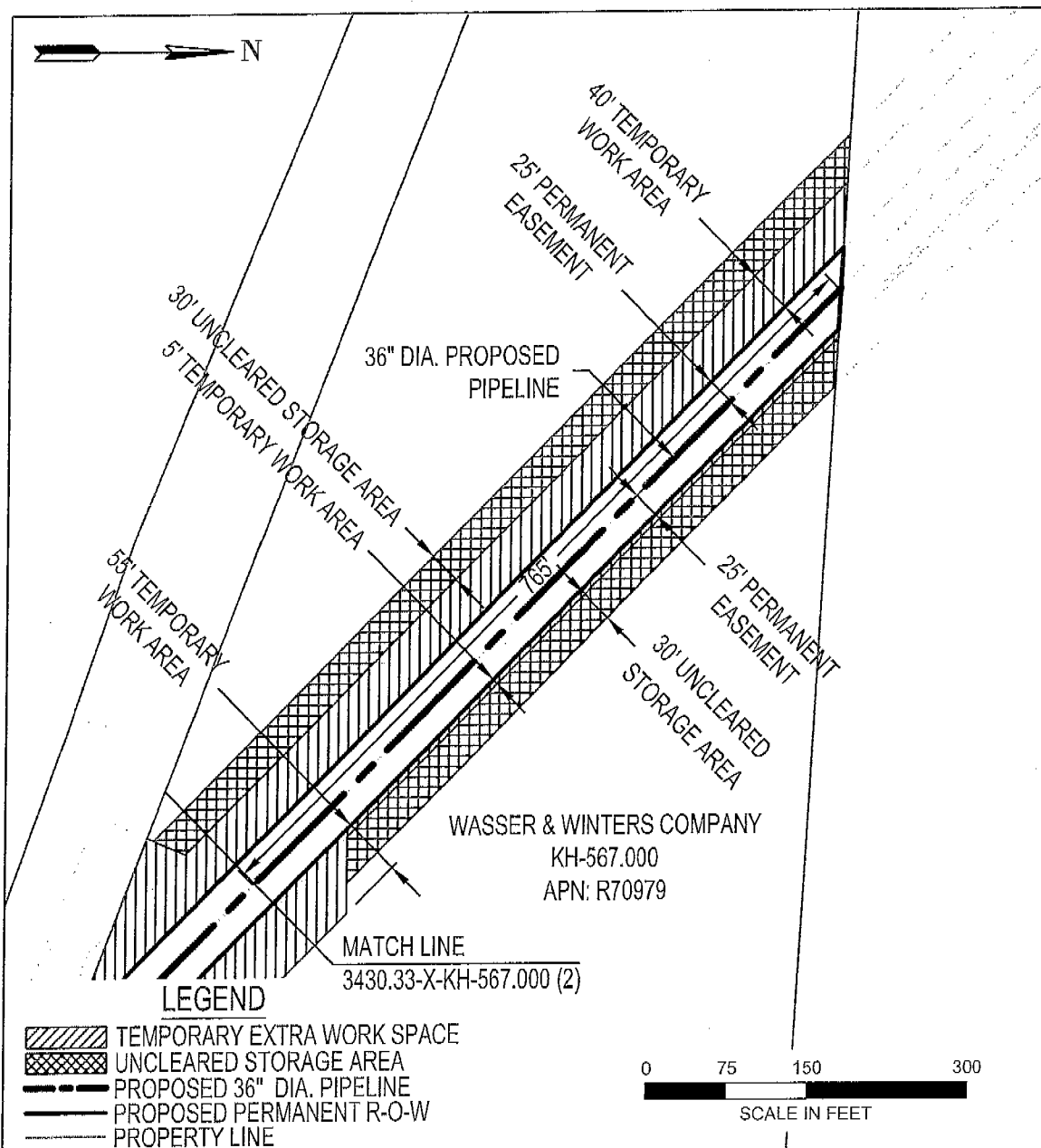

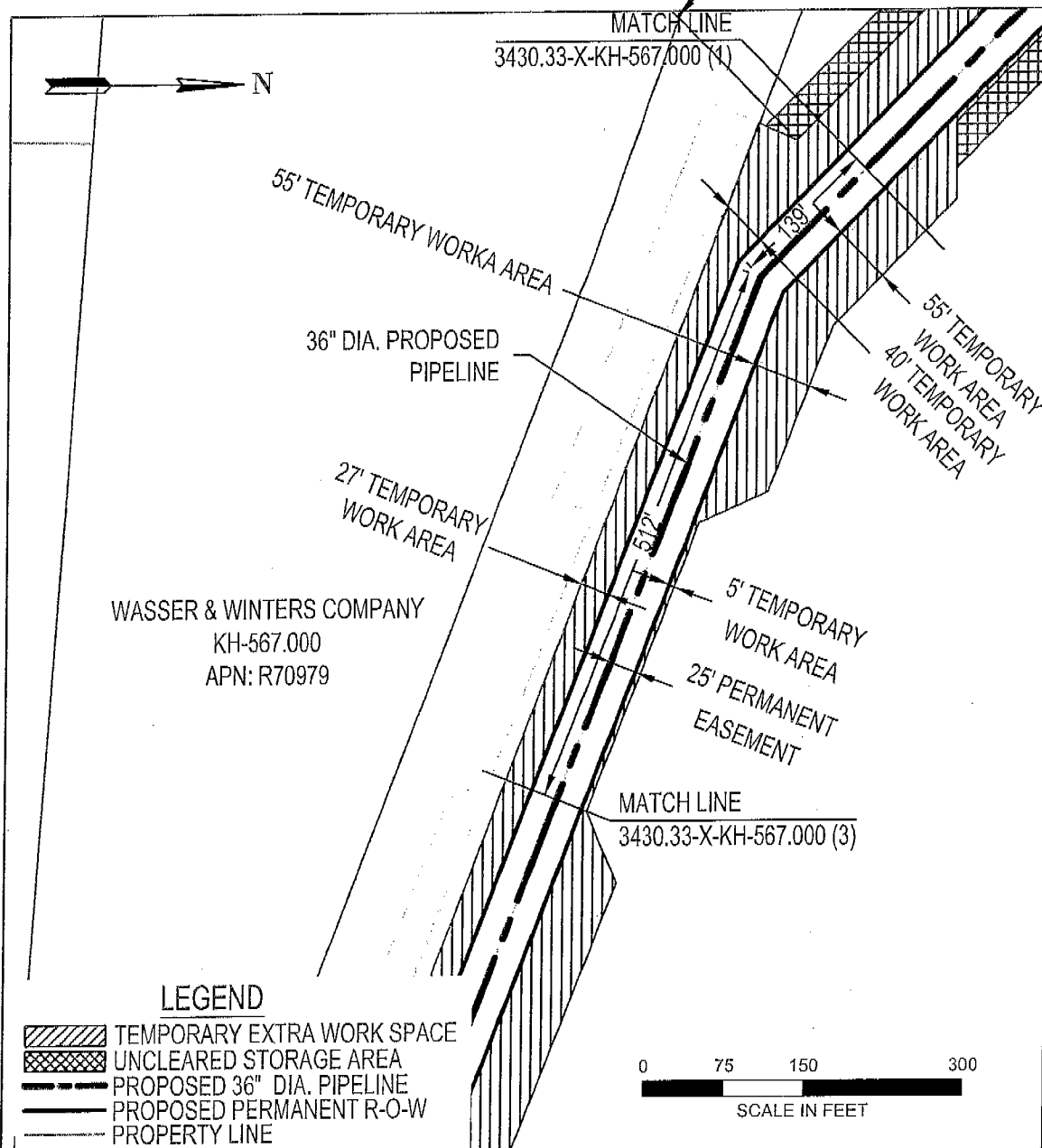

AREA TOTALS			<div>EXHIBIT "A"</div> <div><div>Pacific Connector GAS PIPELINE</div></div>
	SQ. FT.	ACRES.	
PERM. R-O-W:	148703.81	3.414	
TEMP. EXTRA WORK AREA:	161200.13	3.701	
UNCLEARED STORAGE AREA:	45798.08	1.051	
DRAWN:TAD DATE:03-03-2015			PACIFIC CONNECTOR GAS PIPELINE, LP RIGHT-OF-WAY DETAIL Wasser + Winters Company M.P. 169.36 TO M.P. 169.94 T-38 S, R-5 E, S-4 KLAMATH COUNTY, OREGON
CHECK:GMP DATE:03-13-2015			
APPRV: BAB DATE:08-06-2015			
			DRAWING NO: 3430.33-X-KH-567.000 (1)



AREA TOTALS			EXHIBIT "A"
	SQ. FT.	ACRES.	
PERM. R-O-W:	148703.81	3.414	PACIFIC CONNECTOR GAS PIPELINE, LP RIGHT-OF-WAY DETAIL Wasser + Winters Company M.P. 169.36 TO M.P. 169.94 T-38 S, R-5 E, S-4 KLAMATH COUNTY, OREGON DRAWING NO: 3430.33-X-KH-567.000 (2)
TEMP. EXTRA WORK AREA:	161200.13	3.701	
UNCLEARED STORAGE AREA:	45798.08	1.051	
DRAWN:TAD DATE:03-03-2015			
CHECK:GMP DATE:03-13-2015			
APPRV: BAB DATE:08-06-2015			

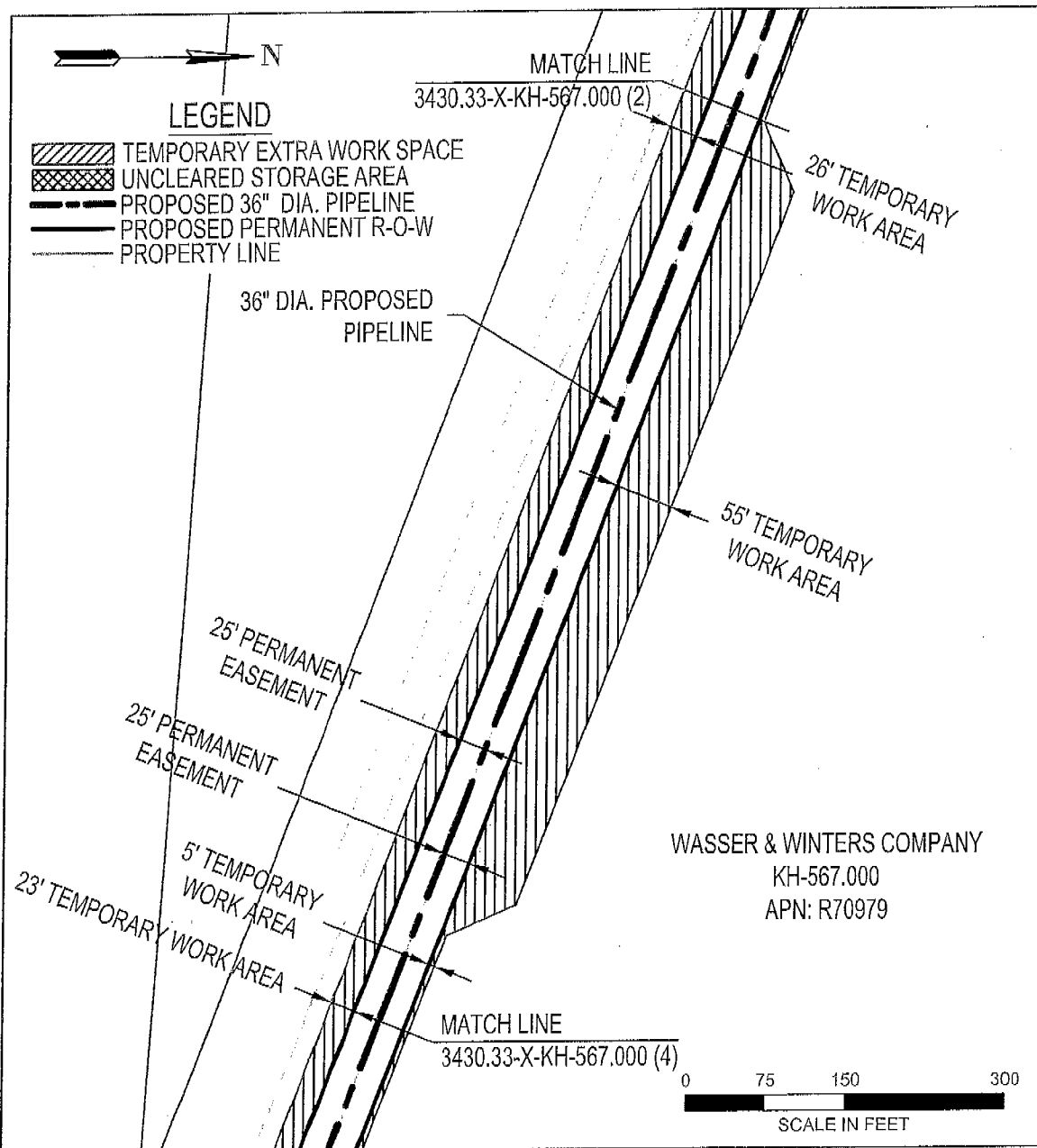





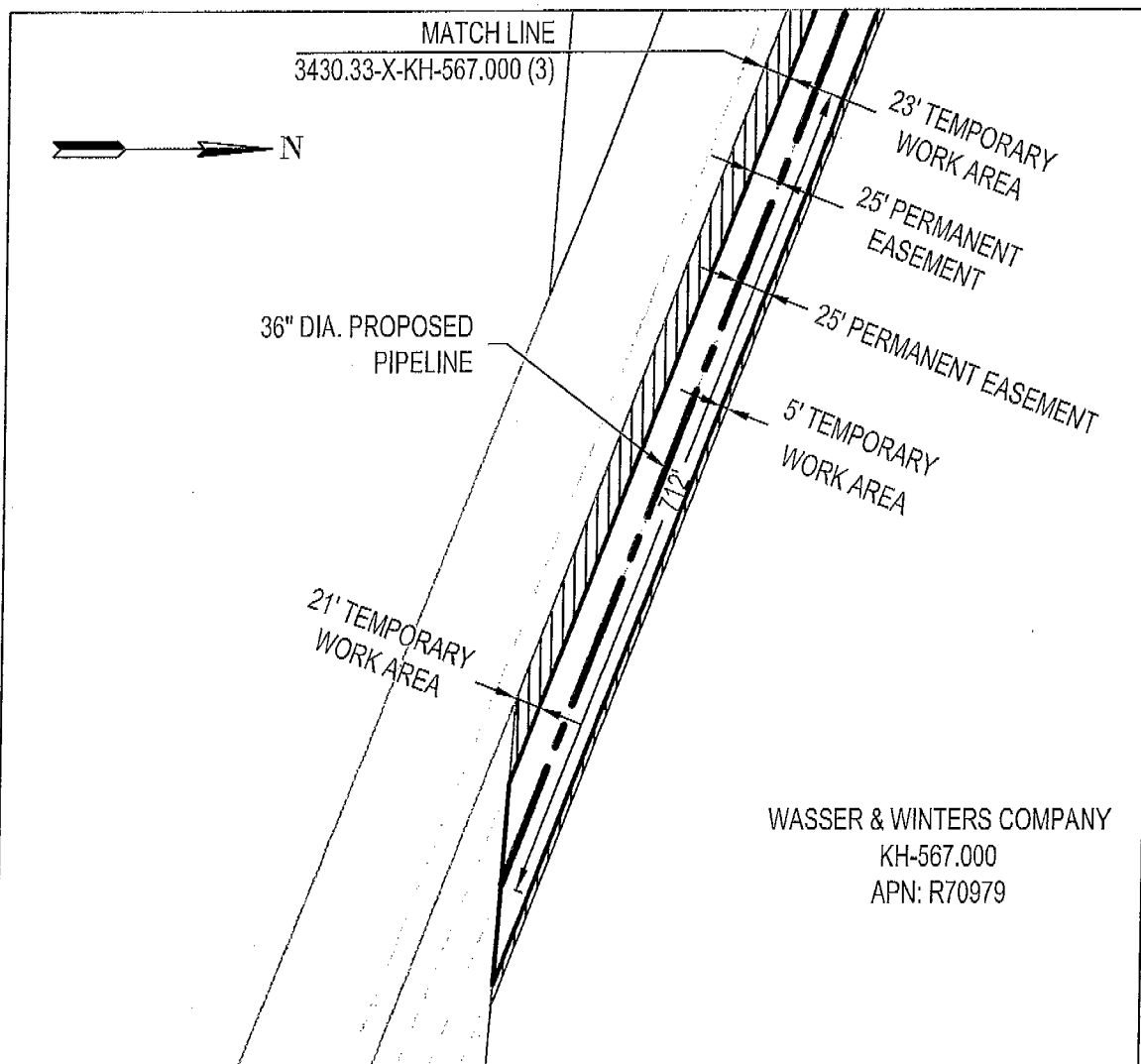

AREA TOTALS			<b>EXHIBIT "A"</b>   PACIFIC CONNECTOR GAS PIPELINE, LP RIGHT-OF-WAY DETAIL Wasser + Winters Company M.P. 169.36 TO M.P. 169.94 T-38 S, R-5 E, S-4 KLAMATH COUNTY, OREGON DRAWING NO: 3430.33-X-KH-567.000 (3)
	SQ. FT.	ACRES.	
PERM. R-O-W:	148703.81	3.414	
TEMP. EXTRA WORK AREA:	161200.13	3.701	
UNCLEARED STORAGE AREA:	45798.08	1.051	
DRAWN:TAD DATE:03-03-2015			
CHECK:GMP DATE:03-13-2015			
APPRV: BAB DATE:08-06-2015			





### LEGEND

-  TEMPORARY EXTRA WORK SPACE
-  UNCLEARED STORAGE AREA
-  PROPOSED 36" DIA. PIPELINE
-  PROPOSED PERMANENT R-O-W
-  PROPERTY LINE

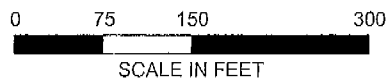

AREA TOTALS			<b>EXHIBIT "A"</b>   PACIFIC CONNECTOR GAS PIPELINE, LP RIGHT-OF-WAY DETAIL Wasser + Winters Company M.P. 169.36 TO M.P. 169.94 T-38 S, R-5 E, S-4 KLAMATH COUNTY, OREGON DRAWING NO: 3430.33-X-KH-567.000 (4)
	SQ. FT.	ACRES.	
PERM. R-O-W:	148703.81	3.414	
TEMP. EXTRA WORK AREA:	161200.13	3.701	
UNCLEARED STORAGE AREA:	45798.08	1.051	
DRAWN: TAD DATE: 03-03-2015			
CHECK: GMP DATE: 03-13-2015			
APPRV: BAB DATE: 08-06-2015			

EXHIBIT "A-1"

In Township 38 South, Range 5 East of the Willamette Meridian, Klamath County, Oregon:

Section 4:      S1/2 NE1/4; SE1/4 NW1/4; EXCEPTING THEREFROM any portion lying within Clover  
Creek Road