

**Exhibit B**

**Memorandum of Option**

After recording return to:  
OR Solar 8, LLC.  
C/O Origis Energy USA, Inc.  
Attn: President  
1200 Brickell Ave., Suite 1800  
Miami, FL, 33131

**2015-012390**

**Klamath County, Oregon**



00178578201500123900040041

11/12/2015 03:53:49 PM

Fee: \$57.00

**MEMORANDUM OF OPTION AGREEMENT**

**LARRY A. MITCHELL**, Trustees of the **Larry L. Mitchell Loving Trust** ("Owner"), and **OR SOLAR 8, LLC**. ("Company"), have entered into an Option Agreement dated May 4th, 2015 (the "**Option Agreement**"), wherein Owner has granted to Company the sole and exclusive option to purchase the property described in Exhibit A. The term of the option will expire at 11:59 p.m. on December 31, 2015.

This Memorandum is being executed and recorded in the Official Records of Klamath County, Oregon, to give notice of the provisions of the Option Agreement and will not be deemed or construed to define, limit, or modify the Option Agreement in any manner.

[Signature Pages Follow]

Executed as of May 4<sup>th</sup>, 2015.

OWNER:

Larry L. Mitchell, Trustee of the Larry L.  
Mitchell Loving Trust

COMPANY:

OR SOLAR 8, LLC.

By:  SAMIR VERSTYN

Its: SECRETARY

STATE OF OREGON )  
COUNTY OF KLAMATH )

Signed and sworn to (or affirmed) before me on this 4<sup>th</sup> day of May, 2015 by Larry Mitchell, Trustee of the Larry L. Mitchell Loving Trust.

NOTARY PUBLIC FOR OREGON  
My Commission Expires:

STATE OF FLORIDA )  
COUNTY OF MIAMI-DADE )

Signed and sworn to (or affirmed) before me on this 6 day of May, 2015 by Samir Verstyn,  
in their capacity as a duly authorized representative and on behalf of OR SOLAR 8, LLC.

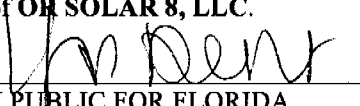
  
NOTARY PUBLIC FOR FLORIDA  
My Commission Expires:



OWNER:

Larry L. Mitchell  
Larry L. Mitchell, Trustee of the Larry L.  
Mitchell Loving Trust

COMPANY:

OR SOLAR 8, LLC.

By: \_\_\_\_\_

Its: \_\_\_\_\_

STATE OF OREGON )  
COUNTY OF KLAMATH )

Signed and sworn to (or affirmed) before me on this 4<sup>th</sup> day of May, 2015 by Larry Mitchell, Trustee of  
the Larry L. Mitchell Loving Trust.



Linzi Rose Kerr  
NOTARY PUBLIC FOR OREGON  
My Commission Expires: March 16, 2018

STATE OF FLORIDA )  
COUNTY OF MIAMI-DADE )

Signed and sworn to (or affirmed) before me on this \_\_\_\_ day of May, 2015 by \_\_\_\_\_,  
in their capacity as a duly authorized representative and on behalf of OR SOLAR 8, LLC.

\_\_\_\_\_  
NOTARY PUBLIC FOR FLORIDA  
My Commission Expires: \_\_\_\_\_

**Description of Property**

**1050 Mitchell Road, Dairy, OR, 97625**

**"The NE 1/4 of Section 25, Township 38 South, Range 10 East  
of the Willamette Meridian, Klamath County, Oregon".**

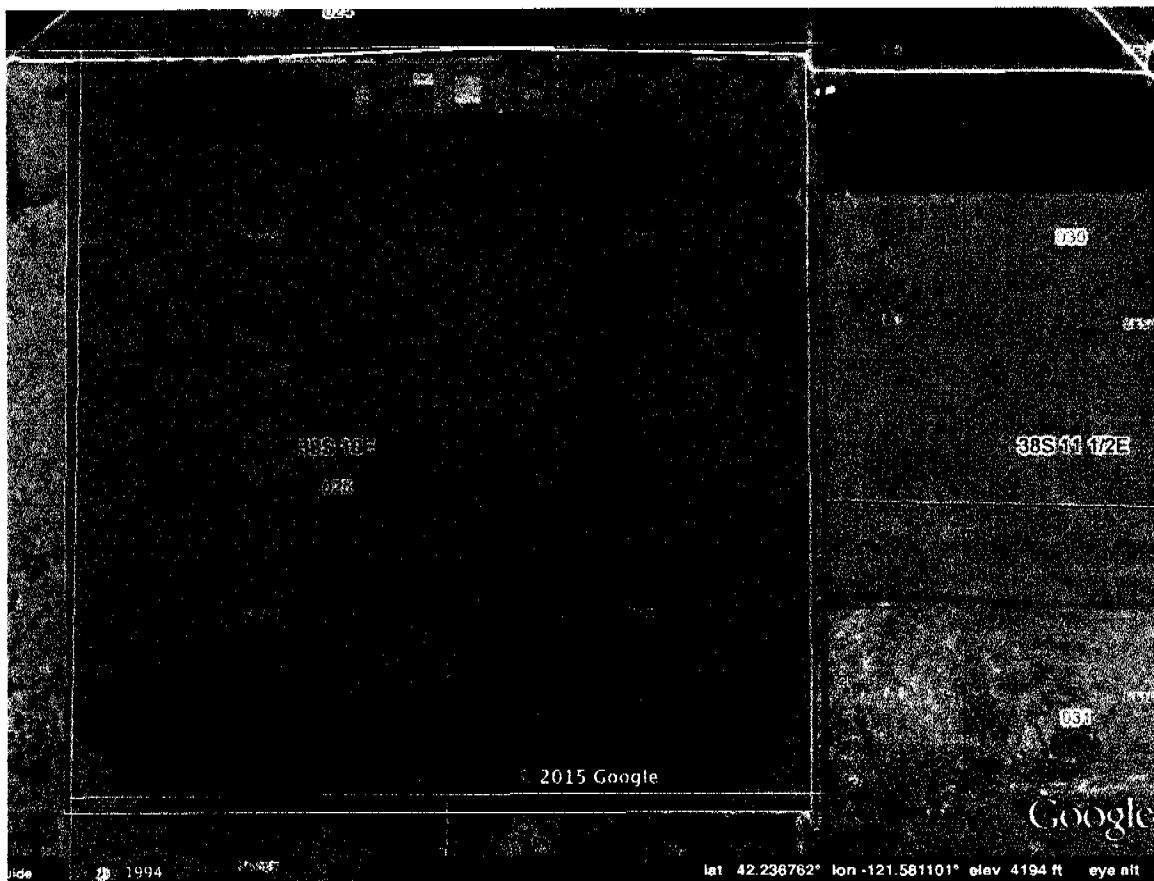

**Property to include irrigation pivot and all pumps currently on property.**