



00180132201500137200030036

12/22/2015 03:29:00 PM

Fee: NO FEE

**BEFORE THE BOARD OF COUNTY COMMISSIONERS
FOR KLAMATH COUNTY, OREGON**

IN THE MATTER OF VACATION OF A)
 PARCEL LINE BETWEEN LOTS 1 AND 2)
 OF LAND PARTITION 74-05 SITUATED IN)
 SECTION 6, TOWNSHIP 40 SOUTH, RANGE)
 8 EAST OF THE WILLAMETTE MERIDIAN,)
 KLAMATH COUNTY, OREGON.)

FINAL ORDER

No. 2016-027

WHEREAS in accordance with the provisions of ORS 368.351, a petition containing the acknowledged signatures of 100% of the owners of the property (Charles and Sharon Horner) identified in Exhibit "A" attached where the parcel line to be vacated has been submitted and accepted by the Board of County Commissioners; and

WHEREAS the Board of County Commissioners directed the Planning Director to submit a report regarding the petition for the parcel line vacation; and

WHEREAS the Planning Director filed with the Board of County Commissioners a report regarding the petition for the parcel line vacation which was accepted; and

WHEREAS after duly considering the report and other documentation presented, the Board of County Commissioners finds that the vacation of the parcel line of Land Partition 74-05 identified in Exhibit "A" is acceptable and should be granted;

NOW, THEREFORE IT IS ORDERED that the petition is hereby granted and the identified parcel line of Land Partition 74-05 is vacated.

DONE AND DATED THIS 22nd day of December, 2015.

Tom Mallam
Chairman

Kellee Mung
Commissioner

Jana Bell
Commissioner

EXHIBIT "A"

Vacation of the parcel line between Lots 1 and 2 of Land Partition 74-05 located in Klamath County, Oregon.

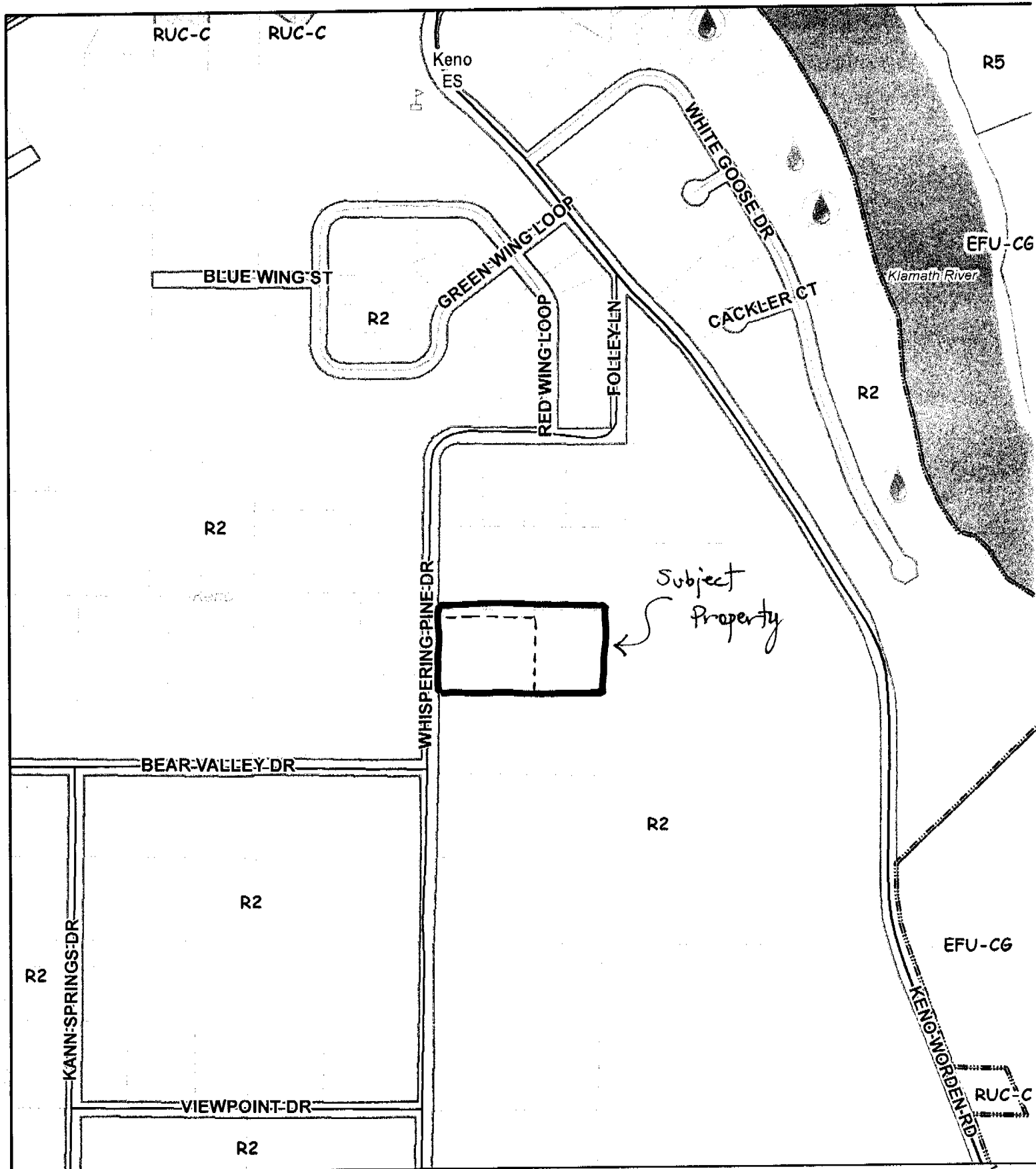

Klamath County

Vicinity -

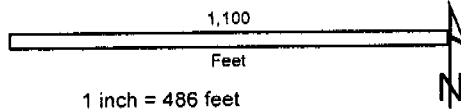

Date Printed: 11-16-15

This map is for planning purposes only. This map has been prepared for internal use by Klamath County only. Accuracy and completeness is not guaranteed to any other agency, public or private.