

2016-001373

Klamath County, Oregon



00182140201600013730030033

02/11/2016 10:59:07 AM

Fee: NO FEE

**BEFORE THE BOARD OF COUNTY COMMISSIONERS
FOR KLAMATH COUNTY, OREGON**

IN THE MATTER OF VACATION OF LOTS)
203 AND 204 OF THE RUNNING Y, PHASE)
3 SUBDIVISION SITUATED IN SECTION 9,)
TOWNSHIP 38 SOUTH, RANGE 8 EAST OF)
THE WILLAMETTE MERIDIAN, KLAMATH)
COUNTY, OREGON.)

FINAL ORDER

No. 2016-044

WHEREAS in accordance with the provisions of ORS 368.351, a petition containing the acknowledged signatures of 100% of the owners of the property (Scott and Gina Alder) identified in Exhibit "A" attached where the lots to be vacated have been submitted and accepted by the Board of County Commissioners; and

WHEREAS the Board of County Commissioners directed the Planning Director to submit a report regarding the petition for vacation of the two lots; and

WHEREAS the Planning Director filed with the Board of County Commissioners a report regarding the petition for vacation of the lots which was accepted; and

WHEREAS after duly considering the report and other documentation presented, the Board of County Commissioners finds that vacation of the lots within the property identified in Exhibit "A" is acceptable and should be granted;

NOW, THEREFORE IT IS ORDERED that the petition is hereby granted and the identified lots are vacated.

DONE AND DATED THIS 9th day of February, 2016.

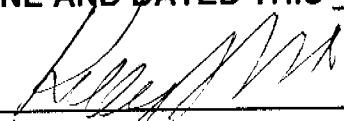
Chairman



Commissioner

Commissioner

EXHIBIT "A"

Vacation of Lots 203 and 204 of the Running Y, Phase 3 Subdivision located in Klamath County, Oregon.

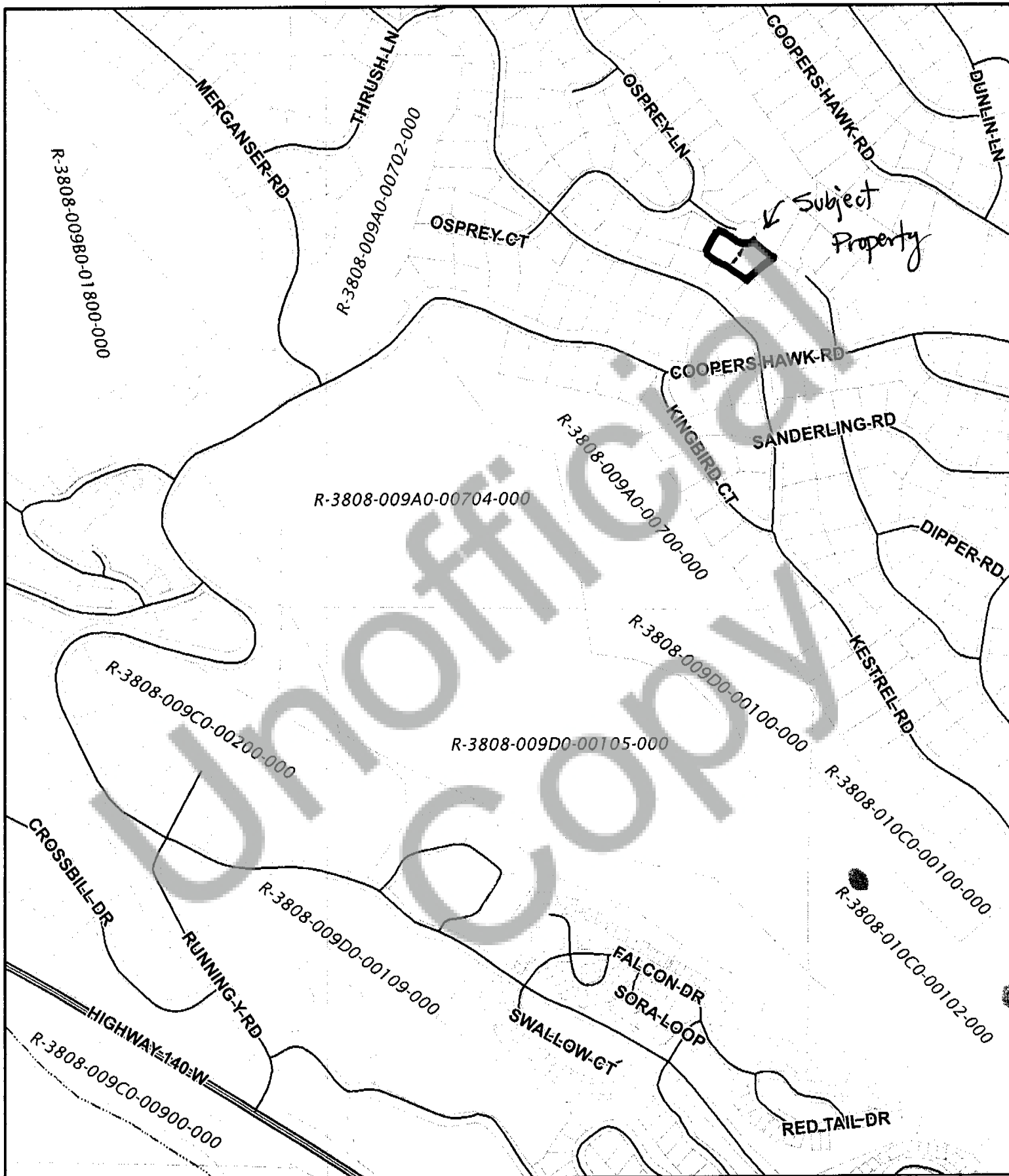
Unofficial
Copy



Klamath County

Vicinity -

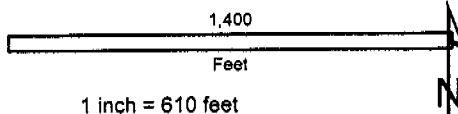

Date Printed: 1-14-15

This map is for planning purposes only. This map has been prepared for internal use by Klamath County only. Accuracy and completeness is not guaranteed to any other agency, public or private.