

2016-003117

Klamath County, Oregon

03/24/2016 02:24:16 PM

Fee: \$72.00

RECORDING COVER SHEET (Please Print or Type)

The information on this sheet is a reflection of the attached instrument for the purpose of meeting first page recording requirements, ORS 205.234.

If this cover page is included with your document, please add \$5.00 to the total recording fees.

AFTER RECORDING RETURN TO:

Pacific Connector Gas Pipeline

832 NW Highland Street

Roseburg, OR 97470

1) TITLE(S) OF THE TRANSACTION(S) ORS 205.234(a)

Construction Stipulations Agreement

2) DIRECT PARTY / GRANTOR(S) ORS 205.125(1)(b) and 205.160

Carl & Adrienne Morrow

15677 Homestead Ln

Klamath Falls, OR 97601

3) INDIRECT PARTY / GRANTEE(S) ORS 205.125(1)(a) and 205.160

Williams Pacific Connector Gas Operator LLC

PO Box 58900

Salt Lake City, UT 84158-0900

4) TRUE AND ACTUAL CONSIDERATION

ORS 93.030(5) – Amount in dollars or other

\$ _____ ☒ Other**5) SEND TAX STATEMENTS TO:**

No Change

6) SATISFACTION of ORDER or WARRANT

ORS 205.125(1)(e)

CHECK ONE: ☐ FULL
(If applicable) ☐ PARTIAL**7) The amount of the monetary obligation imposed by the order or warrant. ORS 205.125(1)(c)**

\$ _____

8) If this instrument is being Re-Recorded, complete the following statement, in

accordance with ORS 205.244: "RERECORDED TO CORRECT _____
PREVIOUSLY RECORDED IN
BOOK _____ AND PAGE _____, OR AS FEE NUMBER _____."

ADRIENNE MORROW WAS REQUESTED TO
 RECORD THIS INSTRUMENT AS
 AN ACCOMMODATION. IT HAS NOT
 BEEN EXAMINED FOR SUFFICIENCY
 OR ITS EFFECT UPON THE TITLE.

ADRIENNE MORROW
 ADRIENNE MORROW
 ADRIENNE MORROW

CONSTRUCTION STIPULATIONS AGREEMENT

For valuable consideration, Carl Morrow and Adrienne Morrow, as Tenants by the Entirety ("Grantor") whose address is 15677 Homestead Lane, Klamath Falls, OR 97601, does grant to WILLIAMS PACIFIC CONNECTOR GAS OPERATOR, LLC, a Delaware limited liability company, on behalf of Pacific Connector Gas Pipeline, L.P., a Delaware limited partnership, located at P.O. Box 58900, Salt Lake City, Utah 84158 ("Grantee"), its agents, contractors and employees, the right and privilege of using a parcel of land for the purpose of constructing a 36" Natural Gas Pipeline ("construction workspace"), which property is situated in Klamath County, State of Oregon, and more particularly described below:

That certain parcel, or parcels, of land lying Section 19, Township 39 South, Range 8 East of the Willamette Meridian; Klamath County, Oregon, being more fully described in the attached "Exhibit A-1".

Also known by County Assessor Parcel Number(s): **R491676**

The approximate location of the construction workspace is designated on Exhibit "A" attached hereto and made a part of this agreement.

It is understood and agreed by Grantor and Grantee that said construction workspace is to be used in connection with the construction of Grantee's natural gas pipeline facilities. Upon completion of the above described work and final restoration of the construction workspace, Grantee's interest in said land will revert to Grantor, except as provided by the right-of-way and easement dated 3-7-2016

Grantee agrees that within a reasonable time following the completion of its work and subject to weather and/or soil conditions, Grantee will as near as practicable restore said construction workspace to its original contours. Grantee will compensate Grantor for adequately documented damages, directly resulting from its work including timber, growing crops, pasture and livestock. Damages to other real or personal property will be repaired by Grantee or the Grantor will be compensated for such repairs. Specific conditions, which will apply only to the initial construction of facilities, are described in Exhibit "B" attached hereto and made a part of this agreement.

The term of this construction stipulation agreement begins upon execution and expires five years from that date.

Grantee will possess the above-described rights and such rights will be binding upon Grantor, its heirs, legal representatives and successors in title.

Grantee will not be held liable for damages of any kind that arise due to the negligent acts or willful misconduct of the Grantor, its successors, assigns, permittee, agents or contractors.

W2016OR12079

A
Amertitle WAS REQUESTED TO
RECORD THIS INSTRUMENT AS
AN ACCOMMODATION. IT HAS NOT
BEEN EXAMINED FOR SUFFICIENCY
OR ITS EFFECT UPON THE TITLE.

WITNESS THE EXECUTION THIS 16th day of march, 20 16

GRANTOR:

Carl Morrow
Carl Morrow

GRANTOR:

Adrienne Morrow
Adrienne Morrow

GRANTEE:

**Williams Pacific Connector Gas
Operator LLC**, on behalf of Pacific
Connector Gas Pipeline L.P.

Peggy Labrum
Peggy Labrum, Attorney in Fact

ACKNOWLEDGMENT

STATE OF OREGON)
COUNTY OF Klamath) ss.

BEFORE ME, the undersigned authority, on this 16th day of march, 2016, personally appeared Carl & Adrienne Morrow, to me known to be the individuals described in and who executed the foregoing instrument, and acknowledged to me that they signed the said instrument as their free and voluntary act and deed for the uses and purposes therein mentioned.

WITNESS my hand and official seal hereto affixed the day and year in this certificate above written.

Christopher Lee Reneau

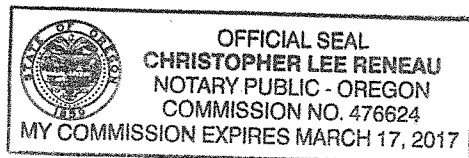

Notary Public in and for the
State of Oregon

My Commission Expires: march 17, 2017

ACKNOWLEDGMENT

STATE OF OREGON)
COUNTY OF Klamath)ss.

BEFORE ME, the undersigned authority, on this 16th day of March, 2016, personally appeared Carl & Adrienne Morrow, to me known to be the individuals described in and who executed the foregoing instrument, and acknowledged to me that they signed the said instrument as their free and voluntary act and deed for the uses and purposes therein mentioned.

WITNESS my hand and official seal hereto affixed the day and year in this certificate above written.

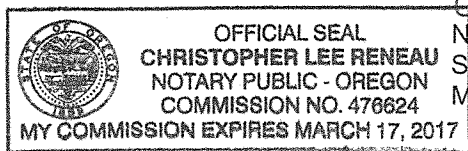

Christopher Lee Reneau
Notary Public in and for the
State of Oregon

My Commission Expires: March 17, 2017

ACKNOWLEDGMENT ATTORNEY-IN-FACT

STATE OF OREGON)
COUNTY OF Jackson)ss.

On the 22nd day of March, 2016, Peggie Labrum personally appeared before me and being by me duly sworn, did say that she is the Attorney-in-Fact of Williams Pacific Connector Gas Operator LLC, on behalf of Pacific Connector Gas Pipeline L.P., and that the Agreement was signed on behalf of Williams Pacific Connector Gas Operator LLC, on behalf of Pacific Connector Gas Pipeline, L.P., and said to me that as such Attorney-in-Fact she executed the same.



Donna Gail Taylor
Notary Public in and for the
State of Oregon

My Commission Expires: August 10, 2018

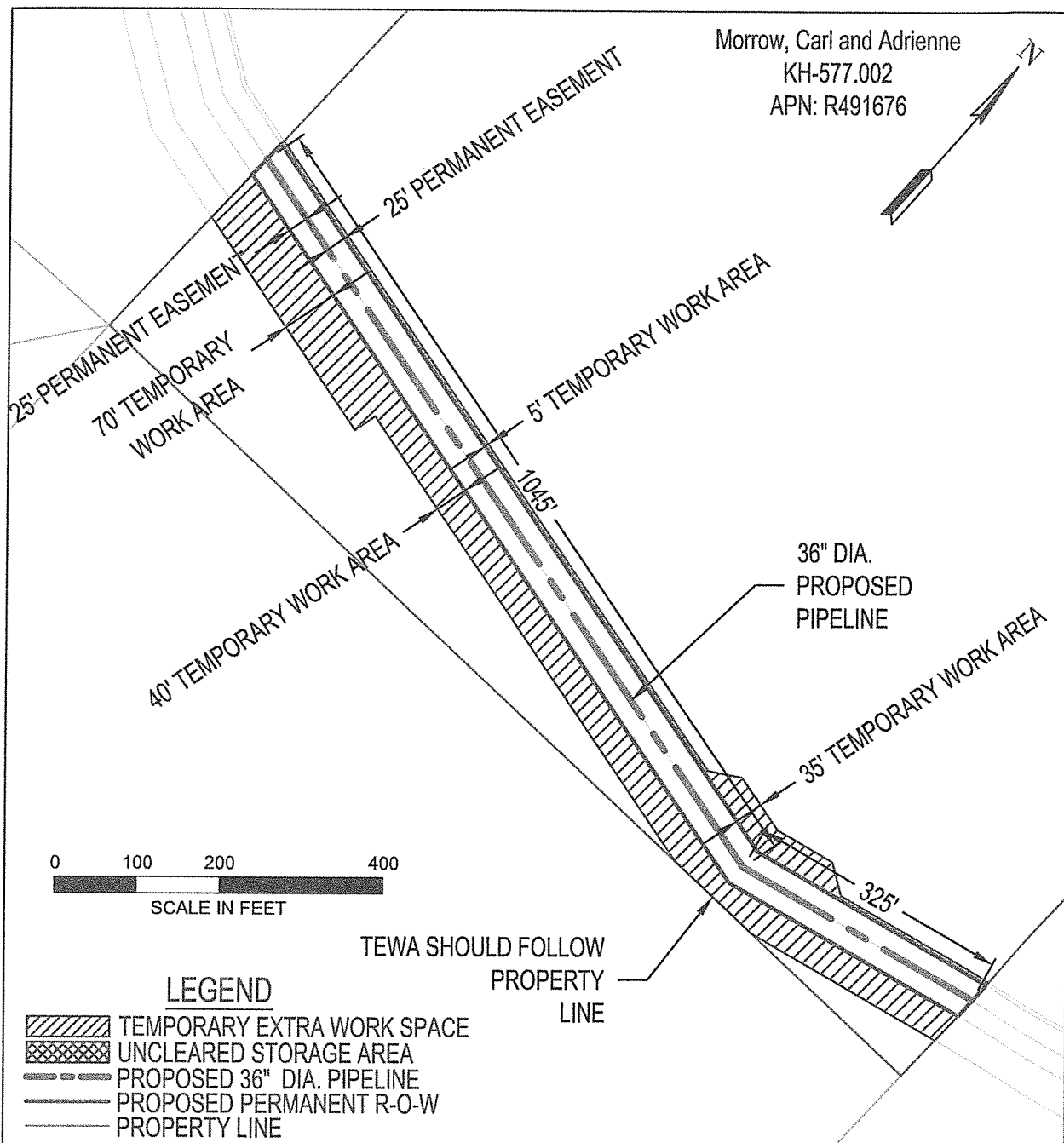

| AREA TOTALS | | | REV 1 | EXHIBIT "A" |  |
|-----------------------------|----------|--------|---|-------------|---|
| | SQ. FT. | ACRES. | | | |
| PERM. R-O-W: | 68491.86 | 1.572 | PACIFIC CONNECTOR GAS PIPELINE, LP RIGHT-OF-WAY DETAIL Morrow, Carl and Adrienne M.P. 188.94 TO M.P. 189.15 T-39 S, R-8 E, S-19 KLAMATH COUNTY, OREGON | | |
| TEMP. EXTRA WORK AREA: | 75978.94 | 1.744 | | | |
| UNCLEARED STORAGE AREA: | 0.00 | 0.000 | | | |
| DRAWN: VGH DATE: 06-08-2015 | | | DRAWING NO: 3430.33-X-KH-577.002 | | |
| CHECK: GMP DATE: 06-12-2015 | | | | | |
| APPRV: BAB DATE: 01-06-2016 | | | | | |

EXHIBIT "A-1"

The W1/2 of the SW 1/4 of Section 19, Township 39 South, Range 8 East of the Willamette Meridian; Klamath County, Oregon.

EXCEPTING that portion deeded to Weyerhaeuser Timber Company by deed Volume 91, page 321, Deed Records of Klamath County, Oregon

EXHIBIT "B"

CONSTRUCTION STIPULATIONS

In accordance with the terms and conditions of this agreement, the Grantor and Grantee agree that the natural gas pipeline facilities will be constructed on Grantor's property in accordance with the following terms and conditions:

1. Grantee will notify Grantor, in writing, of the construction activity 10 days prior to start of survey and via phone or in writing, at least 30 days prior to the clearing/tree removal and construction preparation of the right of way on the Grantor's land.
2. Grantee will construct its pipeline and related facilities in compliance with engineering design and safety standards of the USDOT in force at the time of construction.
3. Grantee will remove all construction waste and debris after completion of construction activities.
4. Grantee will restore all access roads or driveways disturbed by construction to condition equal to or better than existed prior to construction. Restoration will include final grading where necessary.