

2016-004468

Klamath County, Oregon

05/03/2016 09:16:33 AM

Fee: \$72.00

RECORDING COVER SHEET (Please Print or Type)

The information on this sheet is a reflection of the attached instrument for the purpose of meeting first page recording requirements, ORS 205.234.

If this cover page is included with your document, please add \$5.00 to the total recording fees.

AFTER RECORDING RETURN TO:

Pacific Connector Gas Pipeline

832 NW Highland Street

Roseburg, OR 97470

1) TITLE(S) OF THE TRANSACTION(S) ORS 205.234(a)

Construction Stipulations Agreement

2) DIRECT PARTY / GRANTOR(S) ORS 205.125(1)(b) and 205.160

Charla J. House

5160 U11660 Hwy 66

Klamath Falls, OR 97601

3) INDIRECT PARTY / GRANTEE(S) ORS 205.125(1)(a) and 205.160

Williams Pacific Connector Gas Operator LLC

PO Box 58900

Salt Lake City, UT 84158-0900

4) TRUE AND ACTUAL CONSIDERATION

ORS 93.030(5) – Amount in dollars or other

\$ _____ ☒ Other

5) SEND TAX STATEMENTS TO:

No Change

6) SATISFACTION of ORDER or WARRANT

ORS 205.125(1)(e)

CHECK ONE: ☐ FULL
(If applicable) ☐ PARTIAL

7) The amount of the monetary obligation imposed by the order or warrant. ORS 205.125(1)(c)

\$ _____

8) If this instrument is being Re-Recorded, complete the following statement, in accordance with ORS 205.244: "RERECORDED TO CORRECT _____

PREVIOUSLY RECORDED IN BOOK _____ AND PAGE _____, OR AS FEE NUMBER _____."

Amertite CLK16008

Amertite WAS REQUESTED TO RECORD THIS INSTRUMENT AS AN ACCOMMODATION. IT HAS NOT BEEN EXAMINED FOR SUFFICIENCY OR ITS EFFECT UPON THE TITLE.

CONSTRUCTION STIPULATIONS AGREEMENT

For valuable consideration, Charla J. House ("Grantor") whose address is 11660 Hwy 66, Klamath Falls, OR 97601, does grant to WILLIAMS PACIFIC CONNECTOR GAS OPERATOR, LLC, a Delaware limited liability company, on behalf of Pacific Connector Gas Pipeline, L.P., a Delaware limited partnership, located at P.O. Box 58900, Salt Lake City, Utah 84158 ("Grantee"), its agents, contractors and employees, the right and privilege of using a parcel of land for the purpose of constructing a 36" Natural Gas Pipeline ("construction workspace"), which property is situated in Klamath County, State of Oregon, and more particularly described below:

That certain parcel, of land lying in Section 33, Township 39 South, Range 8 East of the Willamette Meridian, Klamath County, Oregon being more fully described in the attached Exhibit "A-1".

Also known by County Assessor Parcel Number(s): **R502236**

The approximate location of the construction workspace is designated on Exhibit "A" attached hereto and made a part of this agreement.

It is understood and agreed by Grantor and Grantee that said construction workspace is to be used in connection with the construction of Grantee's natural gas pipeline facilities. Upon completion of the above described work and final restoration of the construction workspace, Grantee's interest in said land will revert to Grantor, except as provided by the right-of-way and easement dated

4-19-2016 CWR

Grantee agrees that within a reasonable time following the completion of its work and subject to weather and/or soil conditions, Grantee will as near as practicable restore said construction workspace to its original contours. Grantee will compensate Grantor for adequately documented damages, directly resulting from its work including timber, growing crops, pasture and livestock and is more clearly defined in the Damage Agreement dated 4-19-16 CWR. Damages to other real or personal property will be repaired by Grantee or the Grantor will be compensated for such repairs. Specific conditions, which will apply only to the initial construction of facilities, are described in Exhibit "B" attached hereto and made a part of this agreement.

The term of this construction stipulation agreement begins upon execution and expires five years from that date.

Grantee will possess the above-described rights and such rights will be binding upon Grantor, its heirs, legal representatives and successors in title.

Grantee will not be held liable for damages of any kind that arise due to the negligent acts or willful misconduct of the Grantor, its successors, assigns, permittee, agents or contractors.

W 2016 OR 12085

WITNESS THE EXECUTION THIS 15 day of April, 2016

GRANTOR:

Charla J. House
Charla J. House

GRANTEE:

**Williams Pacific Connector Gas
Operator LLC**, on behalf of Pacific
Connector Gas Pipeline L.P.

Peggie Labrum
Peggie Labrum, Attorney in Fact

ACKNOWLEDGMENT

STATE OF OREGON)
)ss.
COUNTY OF KLAMATH)

BEFORE ME, the undersigned authority, on this 15 day of APRIL, 2016, personally appeared CHARLA J. HOUSE, to me known to be the individuals described in and who executed the foregoing instrument, and acknowledged to me that they signed the said instrument as their free and voluntary act and deed for the uses and purposes therein mentioned.

WITNESS my hand and official seal hereto affixed the day and year in this certificate above written.

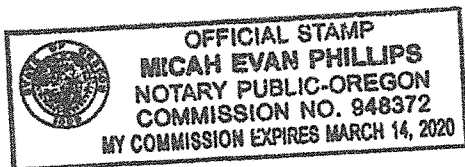

[Signature]
Notary Public in and for the
State of Oregon
My Commission Expires: 3/14/2020

ACKNOWLEDGMENT ATTORNEY-IN-FACT

STATE OF OREGON)
COUNTY OF Jackson) ss.

On the 19th day of April, 2016, Peggie Labrum personally appeared before me and being by me duly sworn, did say that she is the Attorney-in-Fact of Williams Pacific Connector Gas Operator LLC, on behalf of Pacific Connector Gas Pipeline L.P., and that the Agreement was signed on behalf of Williams Pacific Connector Gas Operator LLC, on behalf of Pacific Connector Gas Pipeline, L.P., and said to me that as such Attorney-in-Fact she executed the same.

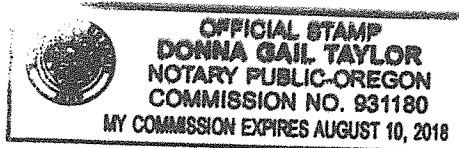

Donna Gail Taylor
Notary Public in and for the
State of Oregon
My Commission Expires: August 10, 2018

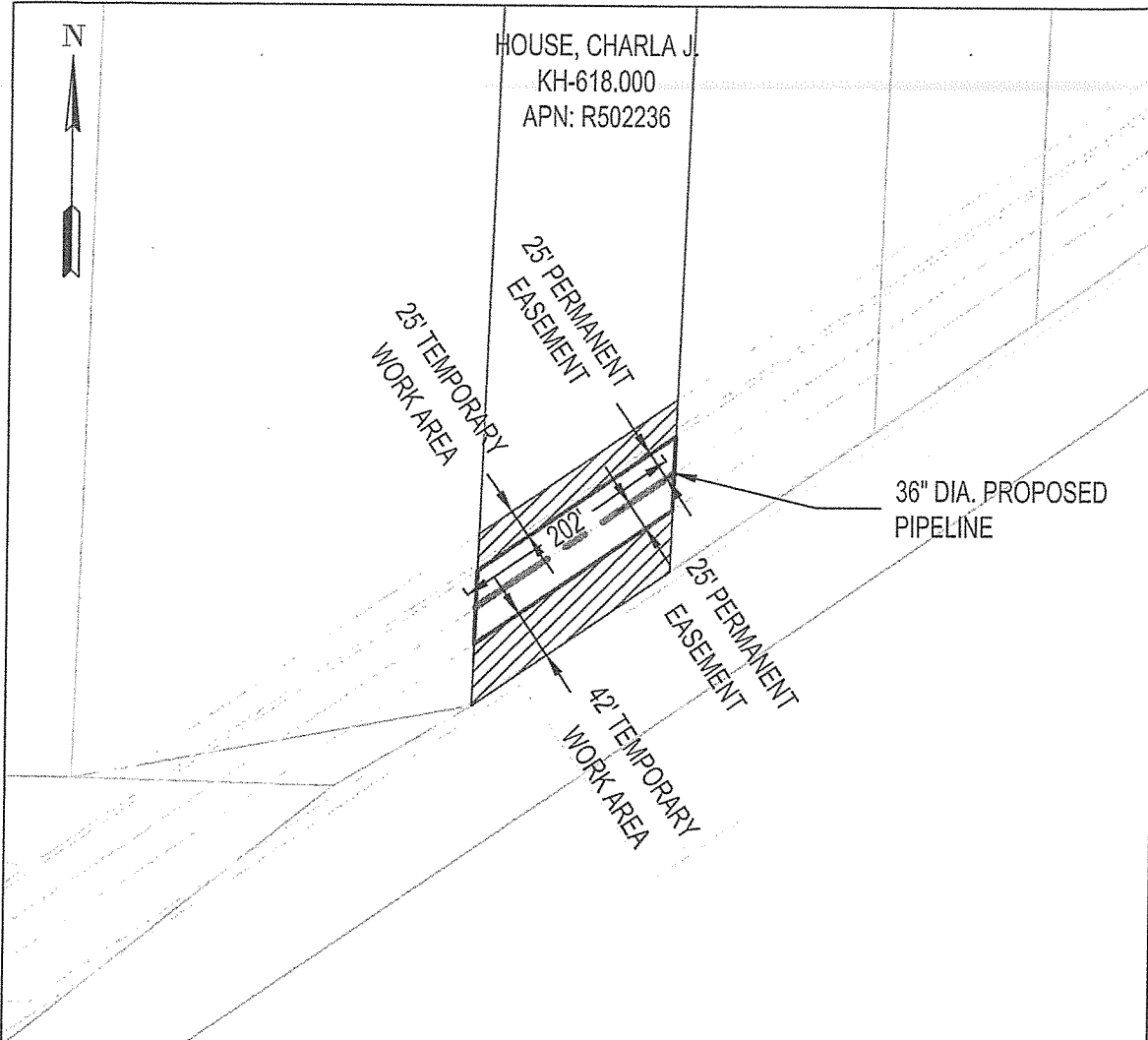

LEGEND

- TEMPORARY EXTRA WORK SPACE
- UNCLEARED STORAGE AREA
- PROPOSED 36" DIA. PIPELINE
- PROPOSED PERMANENT R-O-W
- PROPERTY LINE

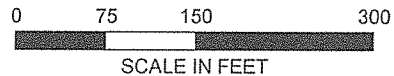

AREA TOTALS			REV 0	EXHIBIT "A"	
	SQ. FT.	ACRES.			
PERM. R-O-W:	10103.96	0.232	PACIFIC CONNECTOR GAS PIPELINE, LP RIGHT-OF-WAY DETAIL House, Charla J. M.P. 192.76 TO M.P. 192.80 T-39 S, R-8 E, S-33 KLAMATH COUNTY, OREGON DRAWING NO: 3430.33-X-KH-618.000		
TEMP. EXTRA WORK AREA:	13531.48	0.311			
UNCLEARED STORAGE AREA:	0	0			
DRAWN:KDS DATE:6-8-2015					
CHECK:GMP DATE:06-12-2015					
APPRV: BAB DATE:12-21-2015					

EXHIBIT "A-1"

The W1/2 of the following described property:

Beginning on the Southerly line of the Klamath Falls - Ashland or Greensprings Highway at a stake which in South 135 feet and South $66^{\circ} 22-1/2''$ West 1122 feet from the quarter ~~corner~~^{corner} common to Sections 28 and 33, Township 39 South, Range 8 East of the Willamette Meridian; thence South $62^{\circ} 22-1/2''$ West 374 feet along the Southerly line of said Highway to an iron pin; thence South parallel with the West line of said Section 33 a distance of 1658.6 feet to a stake on the Northerly right of way line of the Weyerhaeuser Logging railroad; thence Northeasterly along the North line of said right of way 406.85 feet to a stake; thence North 1639.5 feet to the place of beginning, being in the E1/2 of the NW1/4 of Section 33, Township 39 South, Range 8 East of the Willamette Meridian, Klamath County, Oregon.

EXHIBIT "B"

CONSTRUCTION STIPULATIONS

In accordance with the terms and conditions of this agreement, the Grantor and Grantee agree that the natural gas pipeline facilities will be constructed on Grantor's property in accordance with the following terms and conditions:

1. Grantee will notify Grantor, in writing, of the construction activity 10 days prior to start of survey and via phone or in writing, at least 30 days prior to the clearing/tree removal and construction preparation of the right of way on the Grantor's land.
2. Grantee will construct its pipeline and related facilities in compliance with engineering design and safety standards of the USDOT in force at the time of construction.
3. Grantee will remove all construction waste and debris after completion of construction activities.
4. Grantee will restore all access roads or driveways disturbed by construction to condition equal to or better than existed prior to construction. Restoration will include final grading where necessary.