



THIS SPACE RESERVED FOR

<p>2018-006825 Klamath County, Oregon 06/05/2018 01:36:00 PM Fee: \$87.00</p>
--

After recording return to:
Koreta Gabriel
10121 Wright Ave
Klamath Falls, OR 97603

Until a change is requested all tax statements shall be sent to the following address:

Koreta Gabriel
10121 Wright Ave
Klamath Falls, OR 97603
File No. 230309AM

STATUTORY WARRANTY DEED

Valrey Kinsley,

Grantor(s), hereby convey and warrant to

Koreta Gabriel,

Grantee(s), the following described real property in the County of Klamath and State of Oregon free of encumbrances except as specifically set forth herein:

Unit 10121 (Wright Avenue), TRACT 1365, FALCON HEIGHTS CONDOMINIUMS STAGE 2, according to the official plat thereof on file in the office of the County Clerk of Klamath County, Oregon.

The true and actual consideration for this conveyance is \$115,000.00.

The above-described property is free of encumbrances except all those items of record, if any, as of the date of this deed and those shown below, if any:

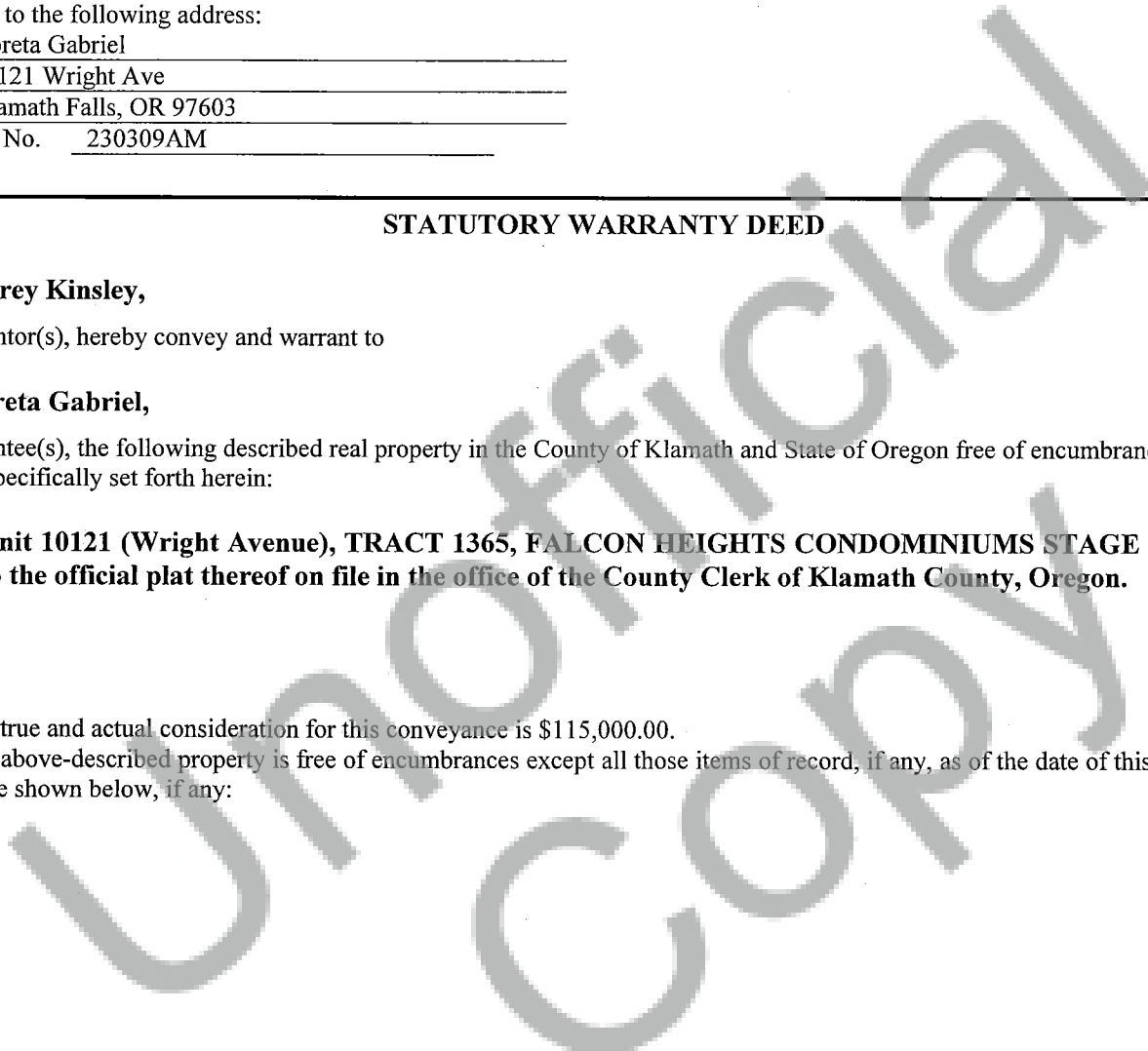

87

BEFORE SIGNING OR ACCEPTING THIS INSTRUMENT, THE PERSON TRANSFERRING FEE TITLE SHOULD INQUIRE ABOUT THE PERSON'S RIGHTS, IF ANY, UNDER ORS 195.300, 195.301 AND 195.305 TO 195.336 AND SECTIONS 5 TO 11, CHAPTER 424, OREGON LAWS 2007, SECTIONS 2 TO 9 AND 17, CHAPTER 855, OREGON LAWS 2009, AND SECTIONS 2 TO 7, CHAPTER 8, OREGON LAWS 2010. THIS INSTRUMENT DOES NOT ALLOW USE OF THE PROPERTY DESCRIBED IN THIS INSTRUMENT IN VIOLATION OF APPLICABLE LAND USE LAWS AND REGULATIONS. BEFORE SIGNING OR ACCEPTING THIS INSTRUMENT, THE PERSON ACQUIRING FEE TITLE TO THE PROPERTY SHOULD CHECK WITH THE APPROPRIATE CITY OR COUNTY PLANNING DEPARTMENT TO VERIFY THAT THE UNIT OF LAND BEING TRANSFERRED IS A LAWFULLY ESTABLISHED LOT OR PARCEL, AS DEFINED IN ORS 92.010 OR 215.010, TO VERIFY THE APPROVED USES OF THE LOT OR PARCEL, TO DETERMINE ANY LIMITS ON LAWSUITS AGAINST FARMING OR FOREST PRACTICES, AS DEFINED IN ORS 30.930, AND TO INQUIRE ABOUT THE RIGHTS OF NEIGHBORING PROPERTY OWNERS, IF ANY, UNDER ORS 195.300, 195.301 AND 195.305 TO 195.336 AND SECTIONS 5 TO 11, CHAPTER 424, OREGON LAWS 2007, SECTIONS 2 TO 9 AND 17, CHAPTER 855, OREGON LAWS 2009, AND SECTIONS 2 TO 7, CHAPTER 8, OREGON LAWS 2010.

Dated this 5th day of June, 2018

Valrey Kinsley
Valrey Kinsley

State of Oregon } ss
County of Klamath }

On this 5th day of June, 2018, before me, Jenny Annette Brazil, a Notary Public in and for said state, personally appeared **Valrey Kinsley**, known or identified to me to be the person(s) whose name(s) is/are subscribed to the within Instrument and acknowledged to me that he/she/they executed same.
IN WITNESS WHEREOF, I have hereunto set my hand and affixed my official seal the day and year in this certificate first above written.

Jenny Annette Brazil
Notary Public for the State of Oregon
Residing at: Klamath County
Commission Expires: 12/3/2018

