

Returned at Counter

Grantor's Name & Address

Jason A. Hunter &
Christina A. Hunter
16940 Hwy 140 E
Dairy, Oregon 97625

2021-010642
Klamath County, Oregon



07/08/2021 01:14:45 PM

Fee: \$87.00

Trustee Name & Address

Neal G. Buchanan, Attorney
435 Oak Avenue
Klamath Falls, Oregon 97601

Beneficiary's Name & Address

Jerald S. Rogers and Carol A. Rogers, Trustees
JERALD AND CAROL ROGERS 2007 TRUST
2801 Bristol
Klamath Falls, Oregon 97603

After recording return to:

Jason A. Hunter &
Christina A. Hunter
16940 Hwy 140 E
Dairy, Oregon 97625

**Until requested otherwise
send all tax statements to:**

Jason A. Hunter &
Christina A. Hunter
16940 Hwy 140 E
Dairy, Oregon 97625

DEED OF RECONVEYANCE

KNOW ALL MEN BY THESE PRESENTS, that the undersigned Trustee under that certain Trust Deed dated **August 24, 2020** executed and delivered by **Jason A. Hunter & Christina A. Hunter**, husband and wife as grantors and recorded on **August 25, 2020** in the records of Klamath County, Oregon at 2020-010632 conveying real property situated in said county described on Exhibit A, attached hereto and incorporated herein by reference as though fully set forth.

Having received from the beneficiary under said Trust Deed a written request to reconvey, reciting that all sums and other obligation secured by the Trust Deed have been fully paid or satisfied; hereby does grant, bargain, sell and convey, but without any covenant or warranty, express or implied, to the person or persons legally entitled thereto, all of the estate held by the undersigned in and to said described premises by virtue of said Trust Deed.

In construing this instrument and whenever the context hereof so requires, the singular includes the plural.

DATED the 8th day of July, 2021.

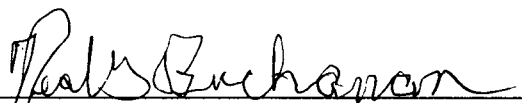
Neal G. Buchanan, Attorney at
Law, Trustee

STATE OF OREGON, County of Klamath) ss.

This instrument was acknowledged before me on July 8, 2021 by **Neal G. Buchanan**, Attorney at Law, as Trustee.

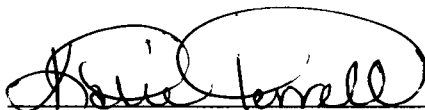

Notary Public for Oregon
My commission expires 4-7-23



LEGAL DESCRIPTION

A portion of Section 25, Township 38 South, Range 10 East, Willamette Meridian situate in the County Klamath, State of Oregon, and being more particularly described as follows:

The Northwest One-Quarter of the Southeast One-Quarter and the Northeast One-Quarter of the Southwest One-Quarter.

EXCEPTING THEREFROM:

A portion of said sections north of the southerly right-of-way of the Klamath Falls – Lakeview Highway State Highway 140. Said Highway created prior to September 29, 1991.

EXCEPTING THEREFROM:

A portion of said section south of the northerly right-of-way of the Oregon California & Eastern Railroad (OC&E) conveyed in deeds Volume 47 Page 379 and Volume 47 Page 579 of Klamath County Records.

EXCEPTING THEREFROM:

A portion of said section shown on Land Partition 49-05 also known as County Survey 7515.

Containing a total of 17.3 acres, more or less.

Date: October 3, 2019
MSM Project # 1060-18

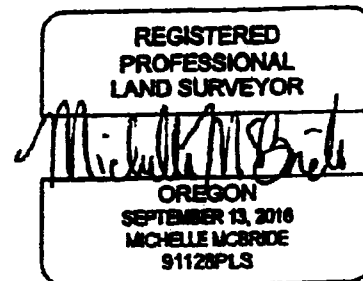

EXPIRATION DATE: 12/31/26