

Recording Requested By:
Land Equities Inc.
711 Medford Center #108
Medford, Oregon 97504

2026-003497 Klamath County, Oregon 04/21/2026 09:42:02 AM Fee: \$97.00
--

When Recorded Mail Document
And Tax Statements To:
Marilyn Williams
355 Marfield Circle
Hampton, Virginia 23669

Special Warranty Deed

APN: R348047

Previous Doc. No.: 2017-006369

For good and valuable consideration, the receipt and sufficiency of which is hereby acknowledged, **LAND EQUITIES INC.** (Grantor), an Oregon corporation, does hereby convey to **MARILYN WILLIAMS** (Grantee), the following described real property situated in the County of Klamath, State of Oregon:

Nimrod River Park 7th Addition, Block 75, Lot 27

SUBJECT TO all conditions, covenants, reservations, restrictions, easement, rights and rights of way of record, official records of said county and state.

The true consideration for this conveyance is \$16,844.00 (Here comply with the requirements of ORS 93.030)

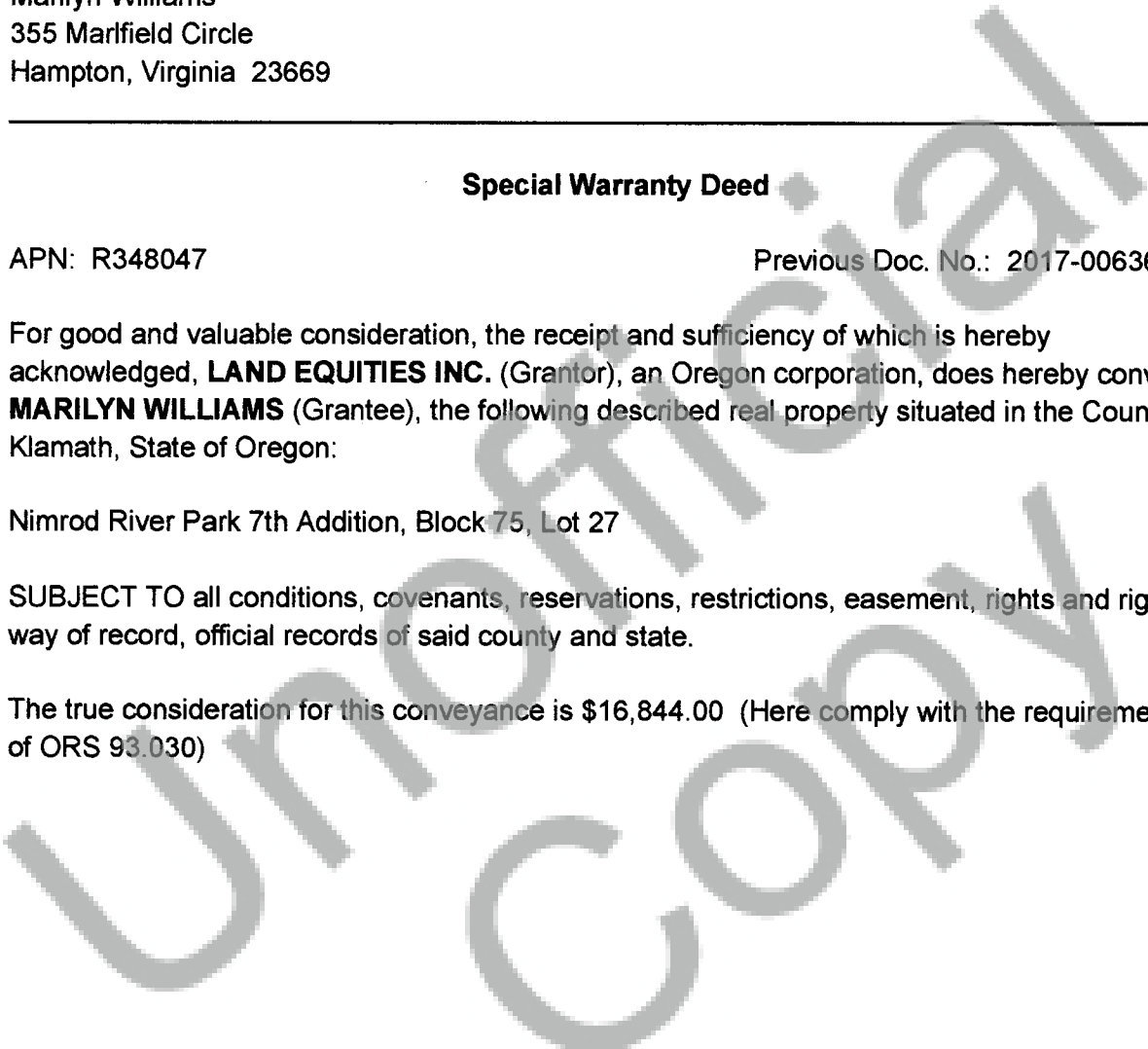

BEFORE SIGNING OR ACCEPTING THIS INSTRUMENT, THE PERSON TRANSFERRING FEE TITLE SHOULD INQUIRE ABOUT THE PERSON'S RIGHTS, IF ANY, UNDER ORS 195.300 (Definitions for ORS 195.300 to 195.336), 195.301 (Legislative findings) AND 195.305 (Compensation for restriction of use of real property due to land use regulation) TO 195.336 (Compensation and Conservation Fund) AND SECTIONS 5 TO 11, CHAPTER 424, OREGON LAWS 2007, SECTIONS 2 TO 9 AND 17, CHAPTER 855, OREGON LAWS 2009, AND SECTIONS 2 TO 7, CHAPTER 8, OREGON LAWS 2010. THIS INSTRUMENT DOES NOT ALLOW USE OF THE PROPERTY DESCRIBED IN THIS INSTRUMENT IN VIOLATION OF APPLICABLE LAND USE LAWS AND REGULATIONS. BEFORE SIGNING OR ACCEPTING THIS INSTRUMENT, THE PERSON ACQUIRING FEE TITLE TO THE PROPERTY SHOULD CHECK WITH THE APPROPRIATE CITY OR COUNTY PLANNING DEPARTMENT TO VERIFY THAT THE UNIT OF LAND BEING TRANSFERRED IS A LAWFULLY ESTABLISHED LOT OR PARCEL, AS DEFINED IN ORS 92.010 (Definitions for ORS 92.010 to 92.192) OR 215.010 (Definitions), TO VERIFY THE APPROVED USES OF THE LOT OR PARCEL, TO DETERMINE ANY LIMITS ON LAWSUITS AGAINST FARMING OR FOREST PRACTICES, AS DEFINED IN ORS 30.930 (Definitions for ORS 30.930 to 30.947), AND TO INQUIRE ABOUT THE RIGHTS OF NEIGHBORING PROPERTY OWNERS, IF ANY, UNDER ORS 195.300 (Definitions for ORS 195.300 to 195.336), 195.301 (Legislative findings) AND 195.305 (Compensation for restriction of use of real property due to land use regulation) TO 195.336 (Compensation and Conservation Fund) AND SECTIONS 5 TO 11, CHAPTER 424, OREGON LAWS 2007, SECTIONS 2 TO 9 AND 17, CHAPTER 855, OREGON LAWS 2009, AND SECTIONS 2 TO 7, CHAPTER 8, OREGON LAWS 2010.

Signature Page to Follow

Unofficial
Copy

DATED: April 20, 2026

Land Equities Inc., an Oregon corporation



Elizabeth M. Therault, Secretary

STATE OF OREGON)

) ss.

COUNTY OF JACKSON)

On April 20, 2026, before me, the undersigned Notary Public, personally appeared Elizabeth M. Therault, personally known to me (or proved to me on the basis of satisfactory evidence) to be the person(s) whose name(s) is/are subscribed to the within instrument and acknowledged to me that he/she/they executed the same in his/her/their authorized capacity(ies), and that by his/her/their signature(s) on the instrument the person(s) or the entity upon behalf of which the person(s) acted, executed the instrument.

WITNESS my hand and official seal.



Notary Public

My Commission Expires: 10/16/2027

